

NOTES: (UNLESS OTHERWISE SPECIFIED)

- 1. REMOVE ALL BURRS AND BREAK SHARP EDGES 0.01 max.
- 2. ALL MACHINED DIAMETERS TO BE CONCENTRIC W/IN 0.0015 TIR max.
- 3. ALL MACHINED SURFACES TO BE 64Ra max.
- 4. CNC PROG. #

REVISIONS				
ZONE	REV.	DESCRIPTION	DATE	APPROVED

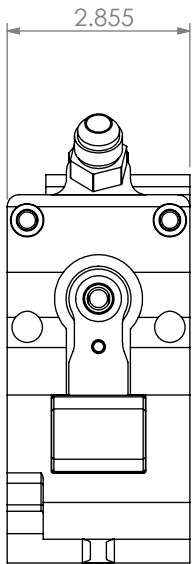
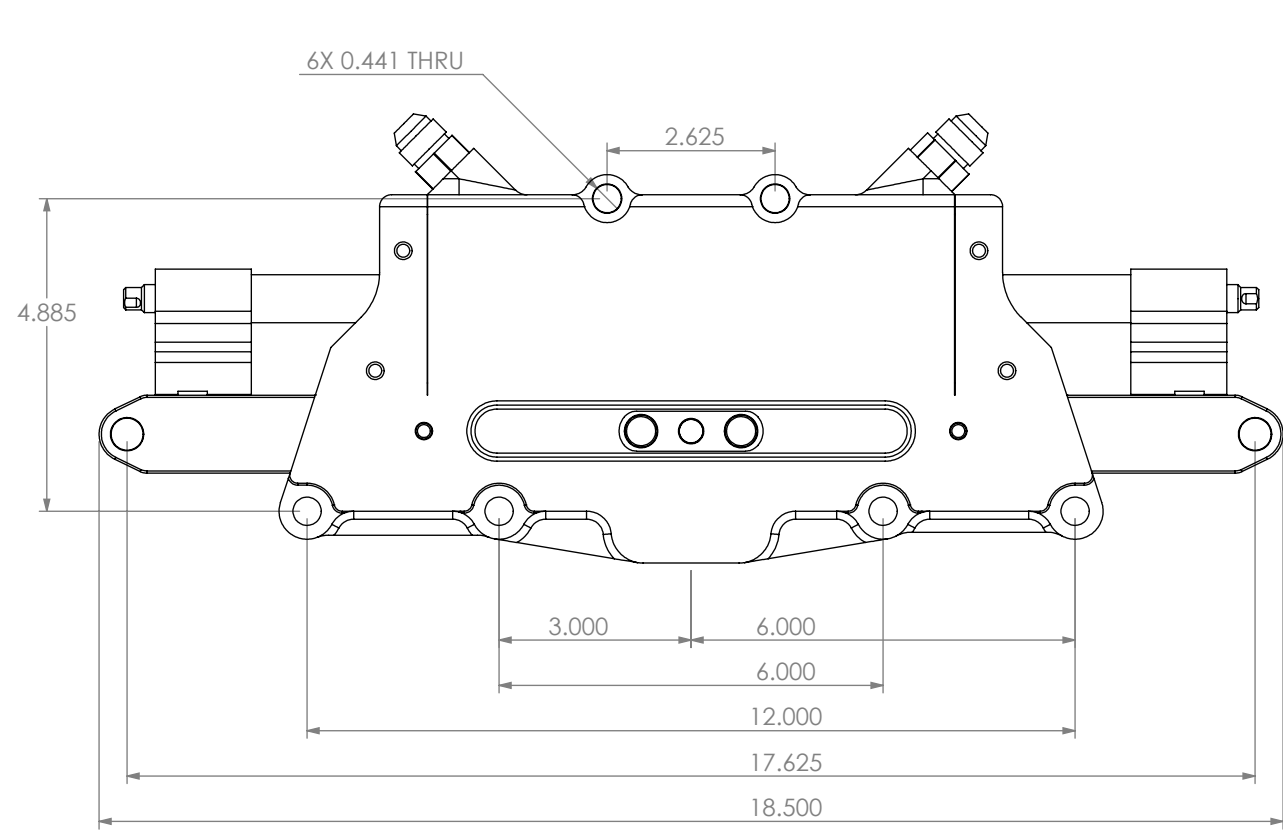

**PROPRIETARY AND CONFIDENTIAL**  
THE INFORMATION CONTAINED IN THIS DRAWING IS THE SOLE PROPERTY OF Pro-Am Racing Products. ANY REPRODUCTION IN PART OR AS A WHOLE WITHOUT THE WRITTEN PERMISSION OF Pro-Am Racing Products IS PROHIBITED.

		UNLESS OTHERWISE SPECIFIED:		NAME	DATE
		DIMENSIONS ARE IN INCHES	DRAWN		
		TOLERANCES:	CHECKED		
		FRACTIONAL 1/64	ENG APPR.		
		ANGULAR: .5 DEG.	MFG APPR.		
		.XX .01			
		.XXX .005			
		.XXXX .001			
		INTERPRET GEOMETRIC	Q.A.		
		TOLERANCING PER:	COMMENTS:		
		MATERIAL			
NEXT ASSY	USED ON	FINISH			
APPLICATION		DO NOT SCALE DRAWING			

**Pro-Am Racing Products**  
TITLE:  
PRM-RPR4501 MOUNT DIMENSIONS

SIZE	DWG. NO.	REV
<b>A</b>		
SCALE: 1:3		SHEET 1 OF 1