

RUNDLE

RUNDLE BASKET INSTRUCTION MANUAL

GENERAL NOTES & WARNINGS

PAGE 2

INSTALLING POLE CAPS

PAGE 3

INSTALLING BASKETS

PAGE 4

REMOVING BASKETS

PAGE 5

REMOVING POLE CAPS

PAGE 6

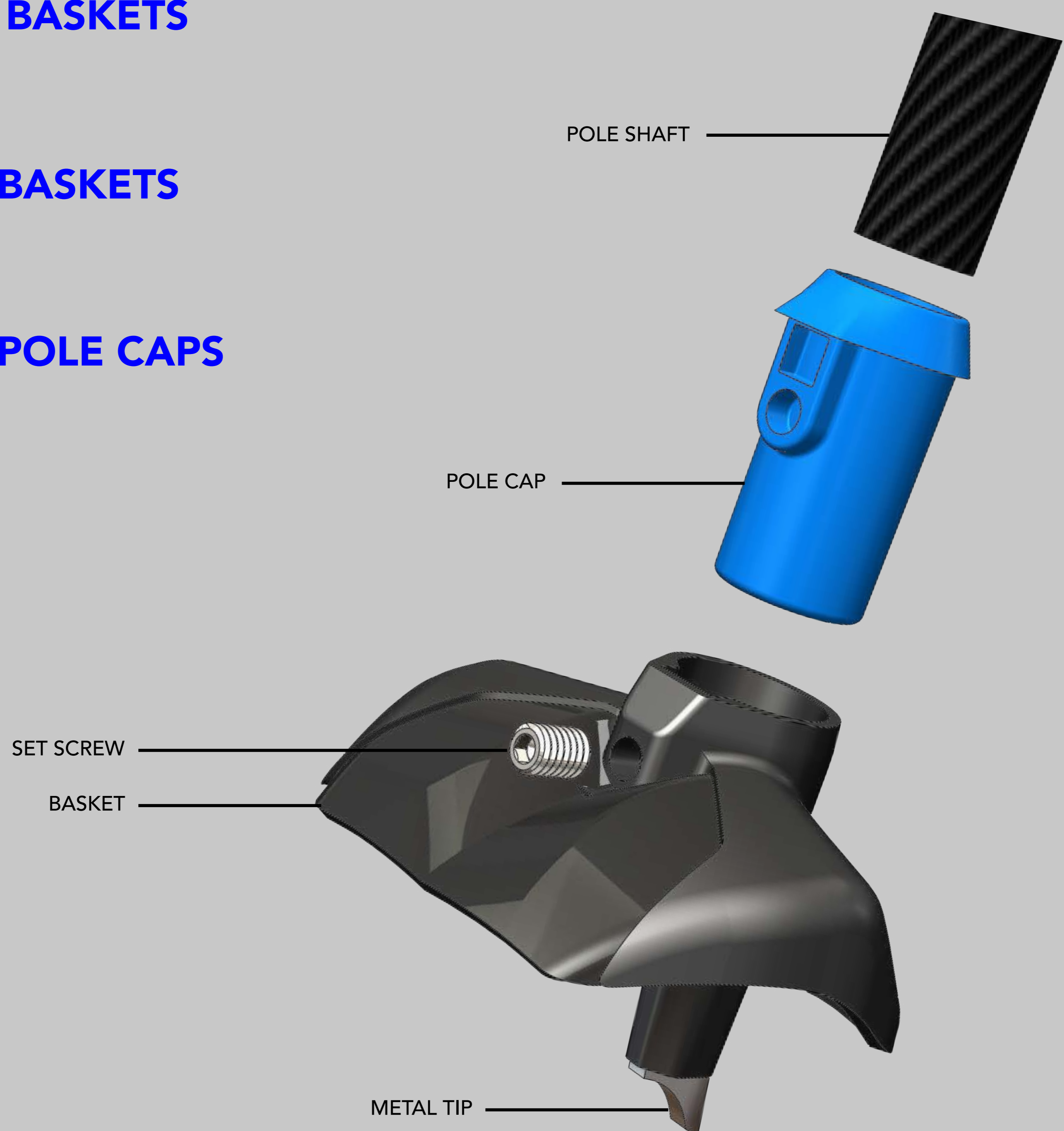

RUNDLE

GENERAL NOTES & WARNINGS



DO NOT USE SNOW BASKETS FOR ROLLER SKIING

Rundle snow baskets are not designed for roller skiing. Rundle roller ski baskets can be purchased separately through Rundle's webstore or your local Rundle dealer.



DO NOT OVERTIGHTEN THE SET SCREW

Overtightening the set screw is the most common error when installing Rundle baskets. Overtightening the set screw reduces the reliability of the system and may damage pole components. See basket installation instructions on page 4.



BASKET TIPS ARE SHARP

The metal tips on Rundle baskets are sharp and may cause injury in rare circumstances. Avoid contact between Rundle baskets and other skiers.



CONTACT US

If you have a question about Rundle's basket system, please contact us through Rundle's website or by calling 416-559-5309.

INSTALLING POLE CAPS

1

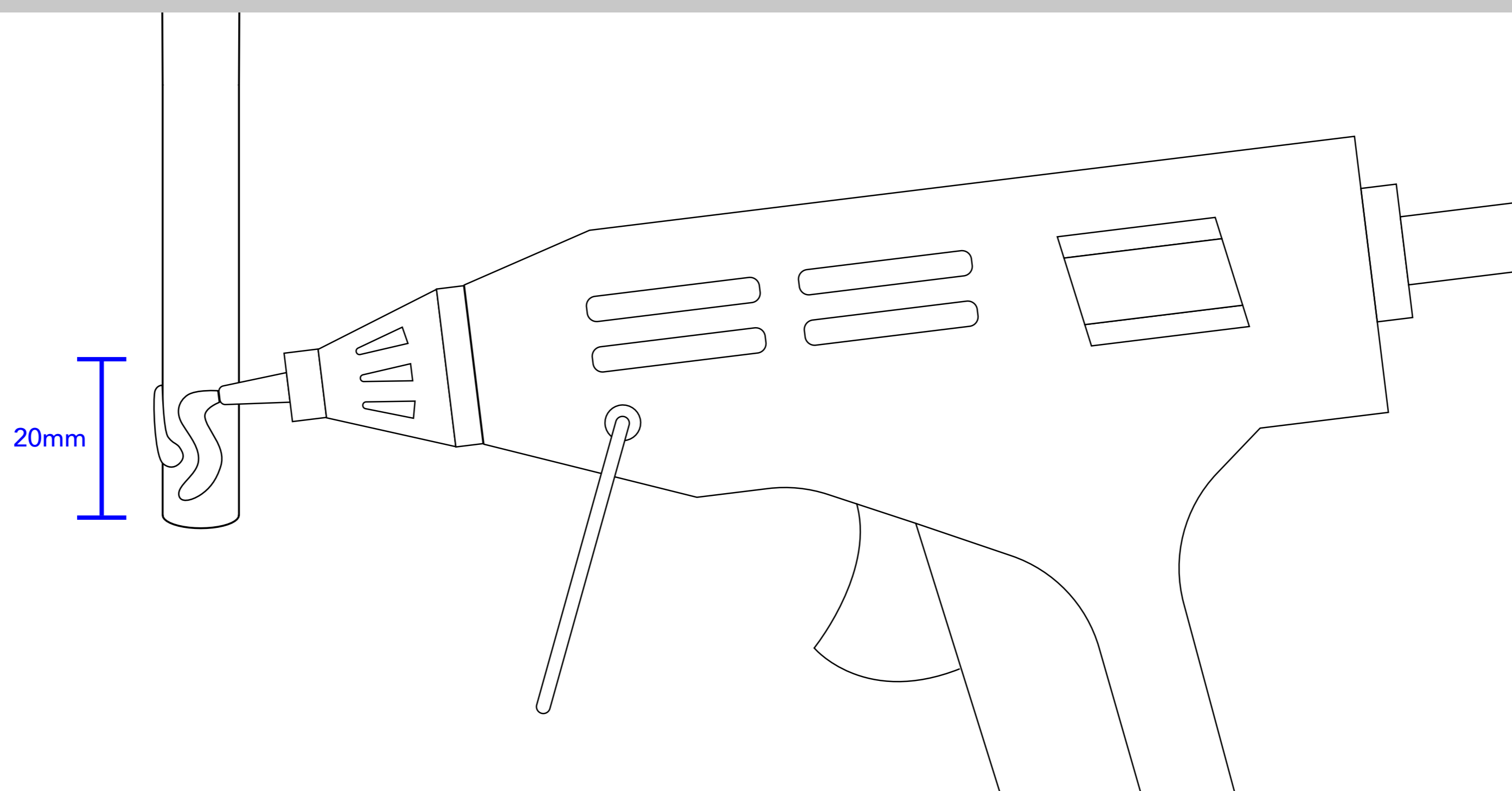

STEP 1: APPLY HOT GLUE TO BOTTOM OF POLE SHAFT

Apply hot glue to the bottom of the pole shaft using a hot glue gun, or by melting a glue stick. Glue should be applied to multiple areas around the circumference of the pole shaft.

⚠ Hot glue can burn skin, apply with care. Gloves and/or other heat protection is recommended.

⚠ Do not apply glue more than 20mm above the bottom of the pole shaft.

2

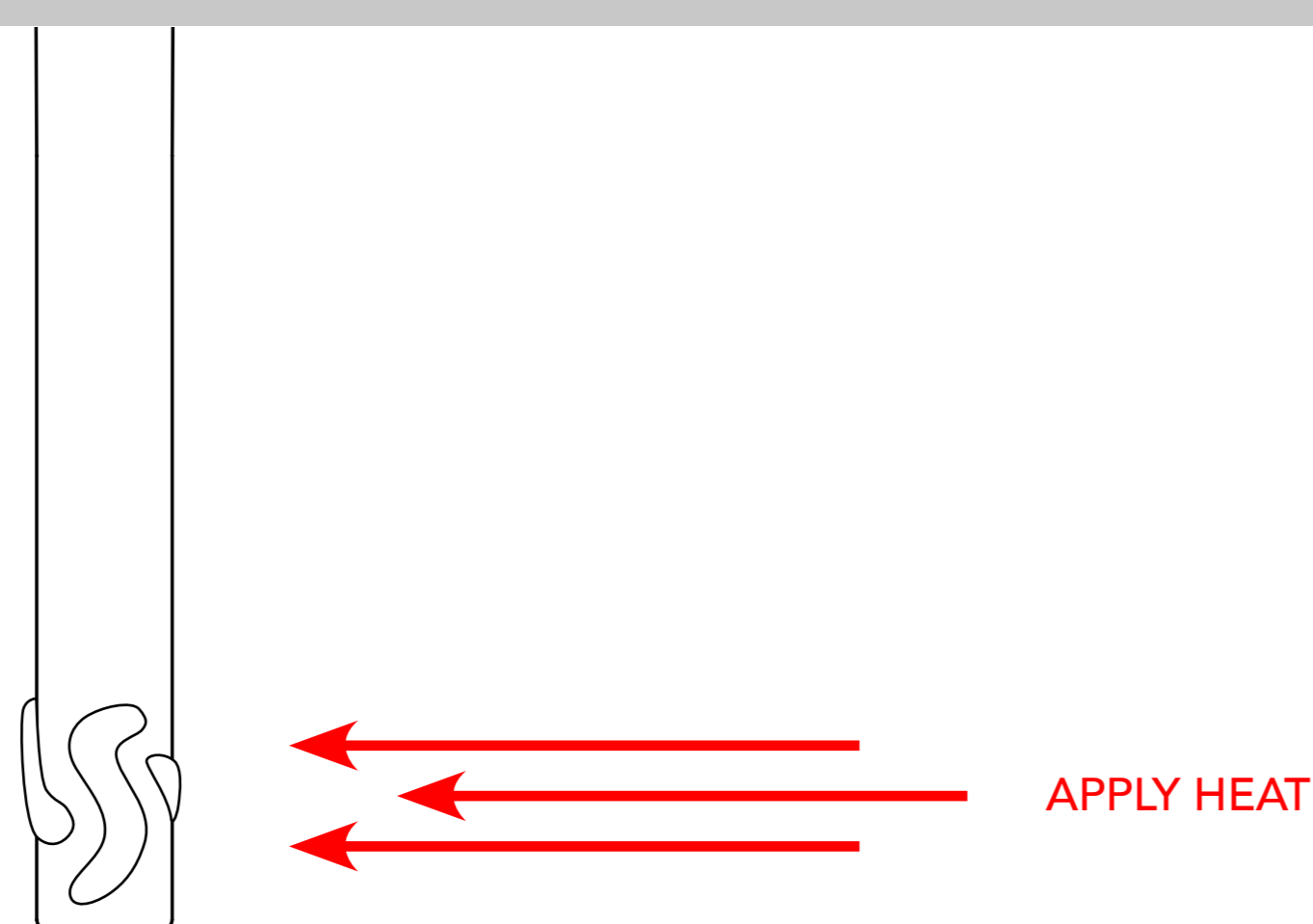

STEP 2: HEAT BOTTOM OF POLE SHAFT

Heat the bottom of the shaft using a heat gun or boiling water. Heating the pole shaft helps keep the glue in liquid form for a longer period time to ease installation of the pole cap.

⚠ Do not heat the shaft above 100°C / 212°F.

⚠ Steps 3, 4, and 5 should follow step 2 as quickly as possible. If steps 3, 4, and 5 take too long the glue may harden before the pole cap can be installed properly.

3

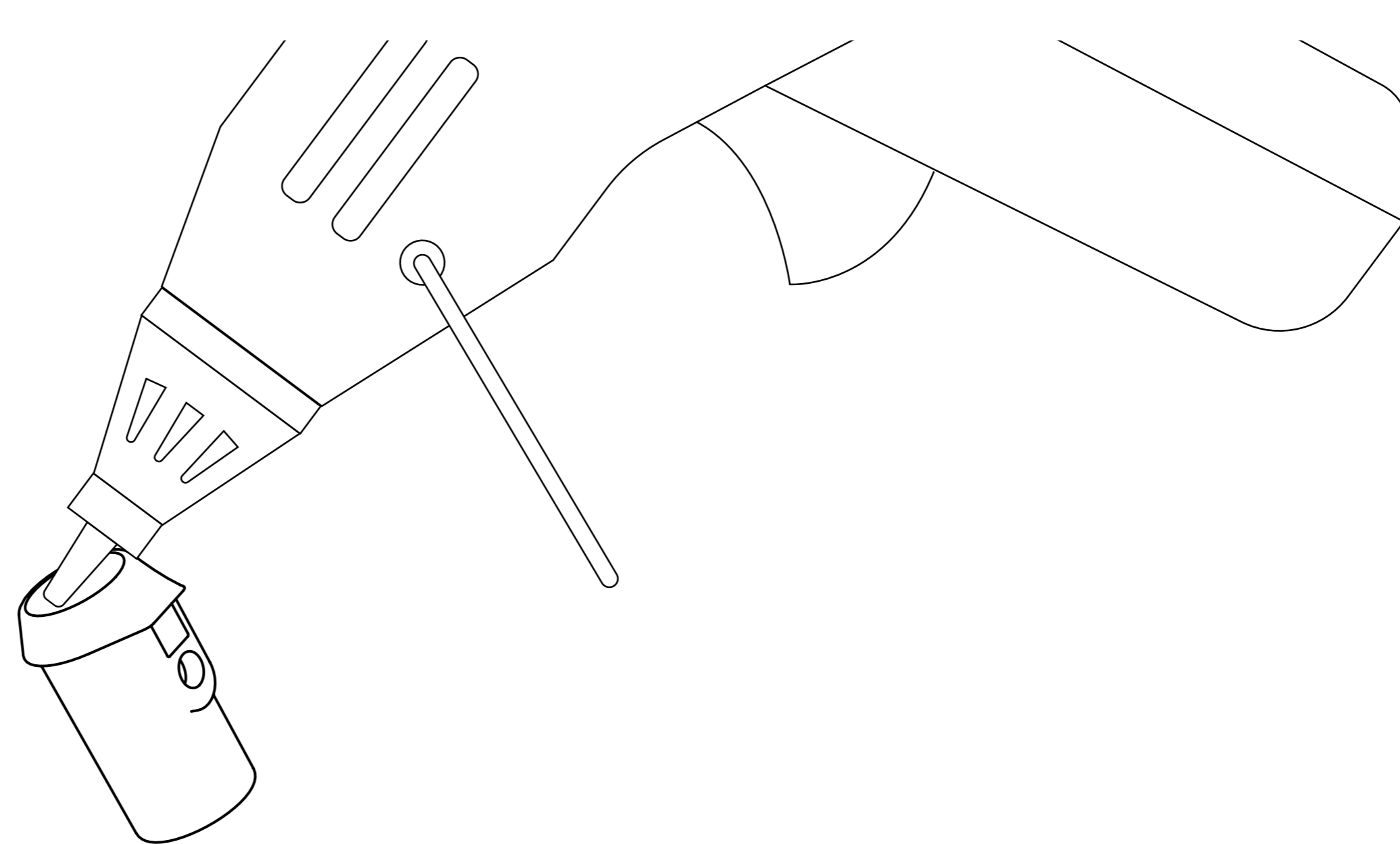

STEP 3: APPLY GLUE INSIDE POLE CAP

Apply hot glue to the inside of the pole cap using a hot glue gun, or by melting a glue stick. Glue should be applied to multiple areas around the inside circumference of the pole cap.

⚠ Hot glue can burn skin. Apply hot glue with care. Gloves and/or other heat protection is recommended.

4

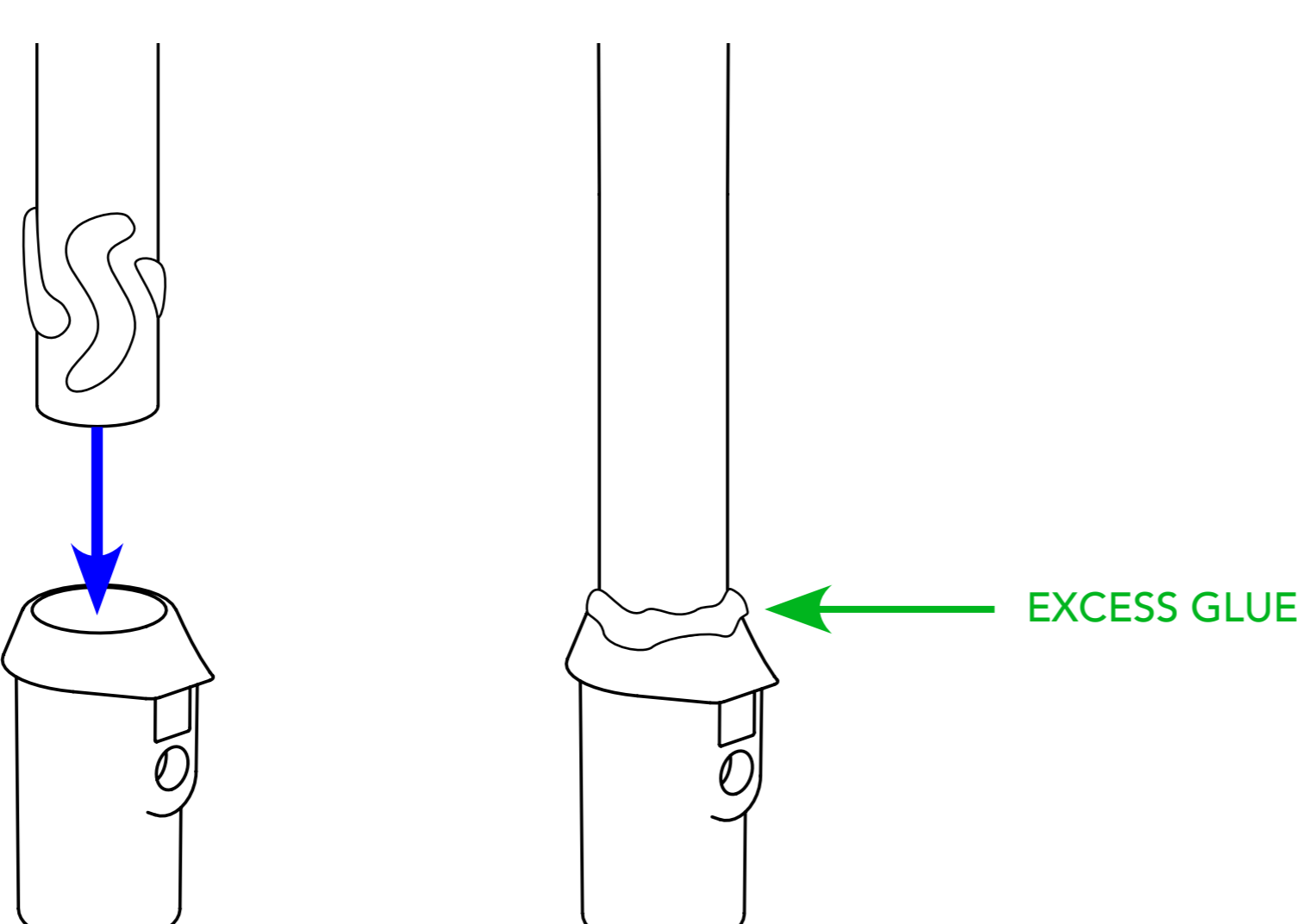

STEP 4: INSTALL POLE CAP

Insert the pole shaft into the pole cap. Make sure to insert the pole shaft completely so there is no gap between the bottom of the pole shaft and the bottom of the pole cap.

⚠ Glue and pole components will be hot during this step. Gloves and/or other heat protection is recommended.

5

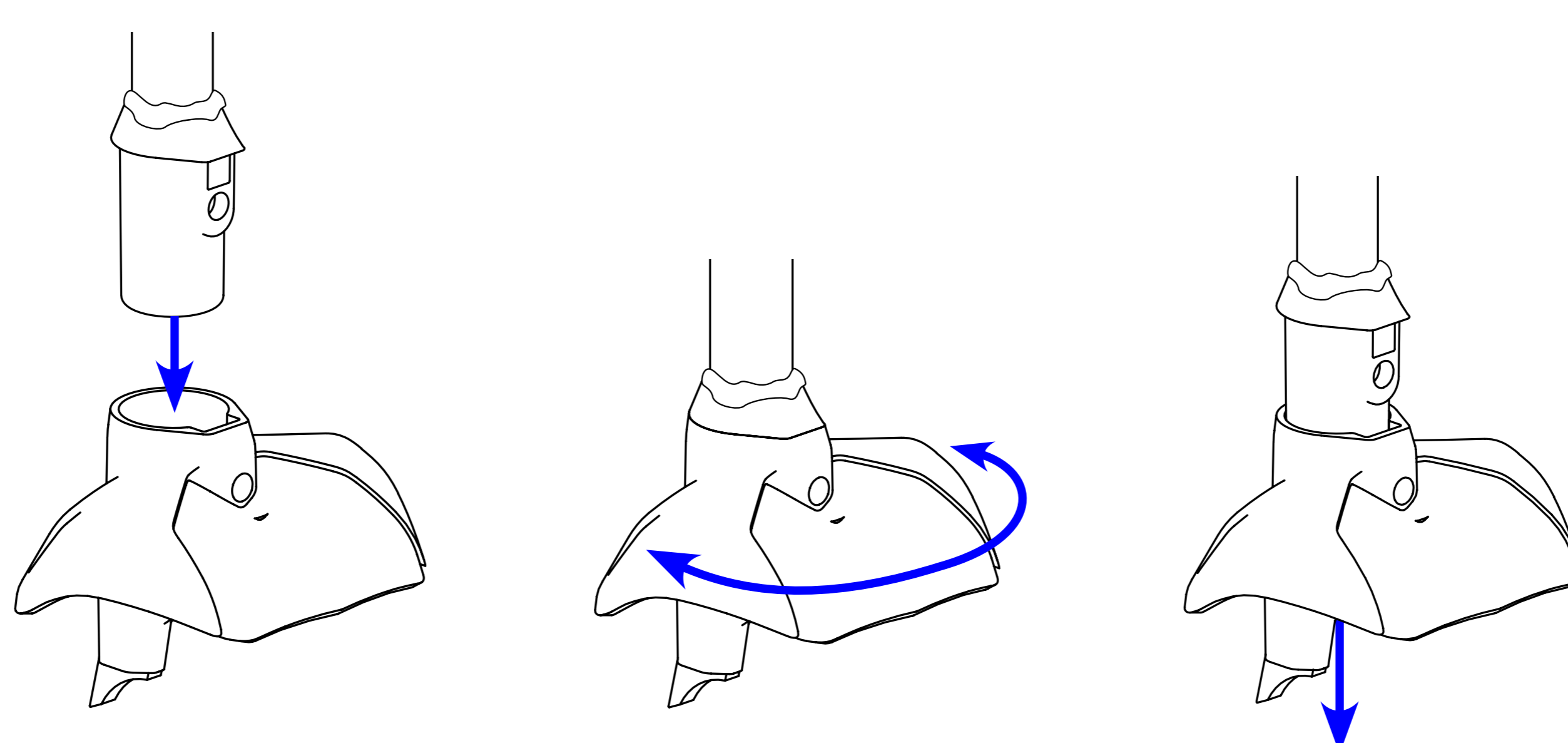

STEP 5: ALIGN POLE CAP

While the glue is still hot, slide a basket onto the pole cap and use the basket to align the pole cap. Twist the basket until it is in line with the pole handle. Remove the basket once the glue has cooled.

⚠ Glue and pole components will be hot during this step. Gloves and/or other heat protection is recommended.

6

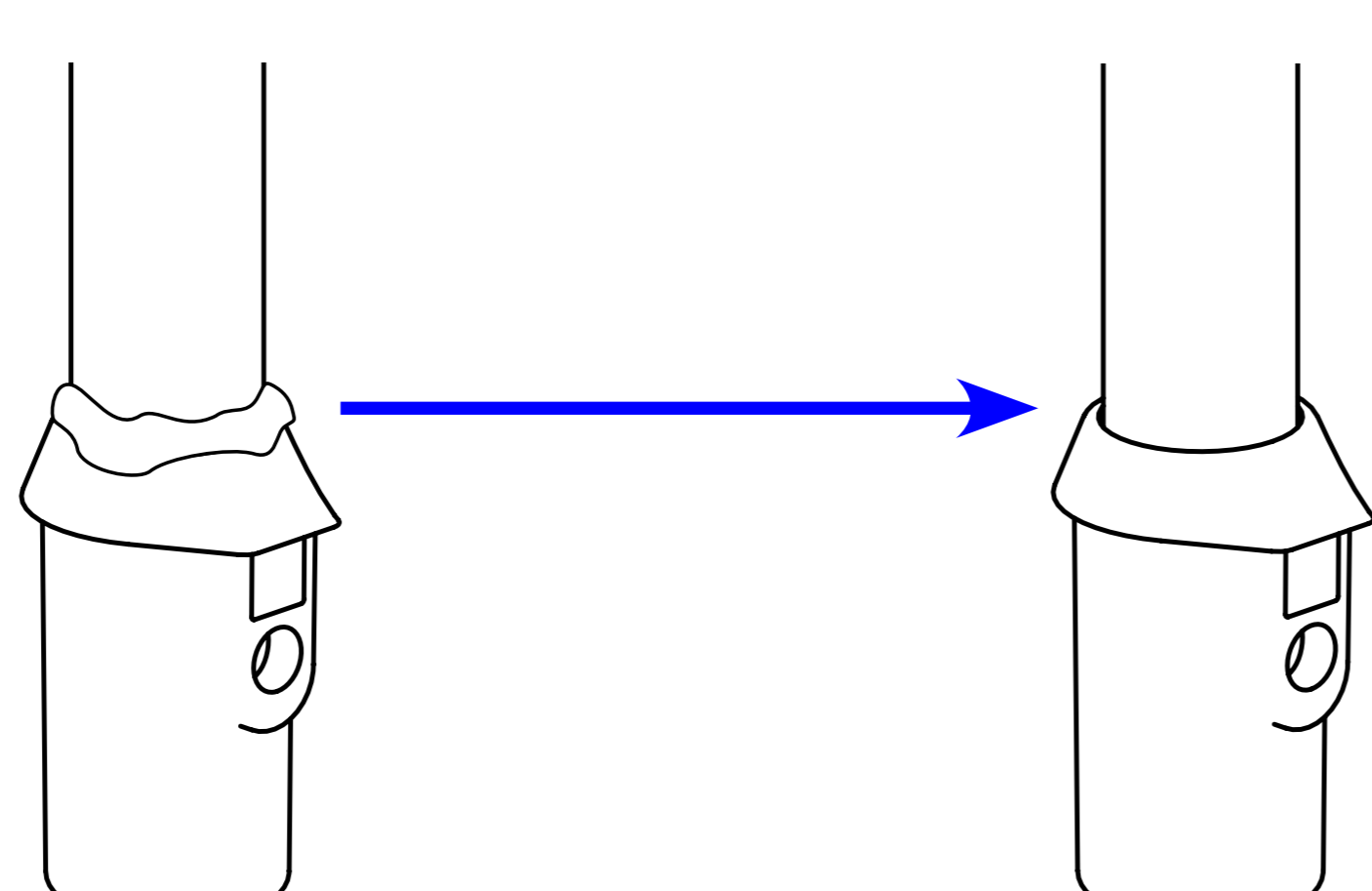

STEP 6: REMOVE EXCESS GLUE

Remove excess glue once the glue has cooled and the pole cap is secure. Excess glue can be removed by wiping if the glue is still semi-soft, or peeling if the glue has fully hardened.

RUNDLE

INSTALLING BASKETS

1

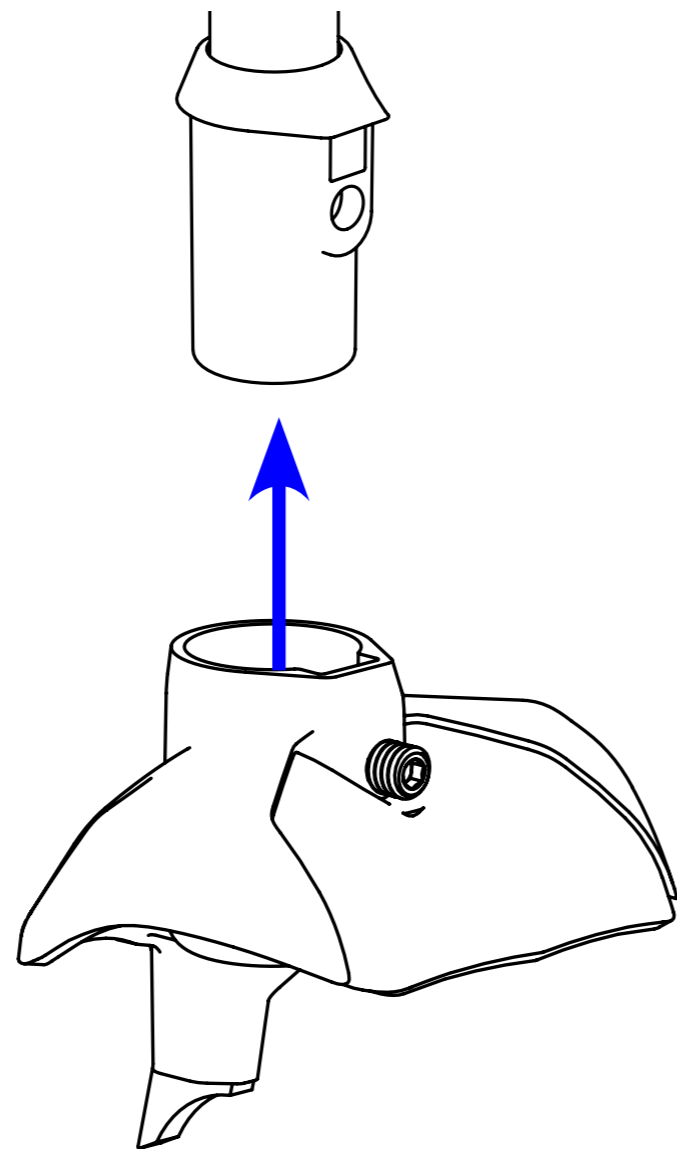

STEP 1: SLIDE BASKET ONTO POLE CAP

Slide the basket onto the pole cap.

2

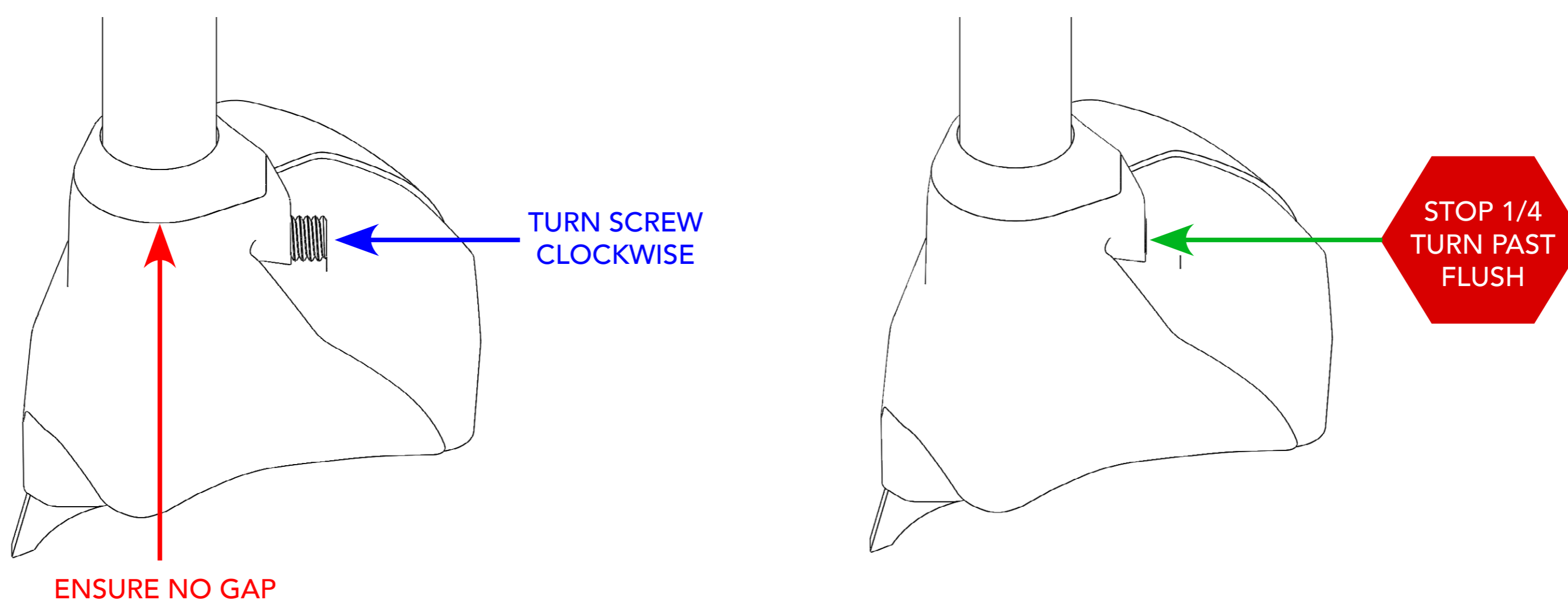

STEP 2: TIGHTEN THE SCREW

Hold the basket in place so that there is no gap between the top of the basket and the rim of the pole cap. Using a 2mm hex key, turn the screw clockwise. Once the screw is flush with the hole, turn the screw clockwise an additional 1/4 rotation.

 Do not tighten the screw more than 1/4 rotation past flush.

REMOVING BASKETS

1

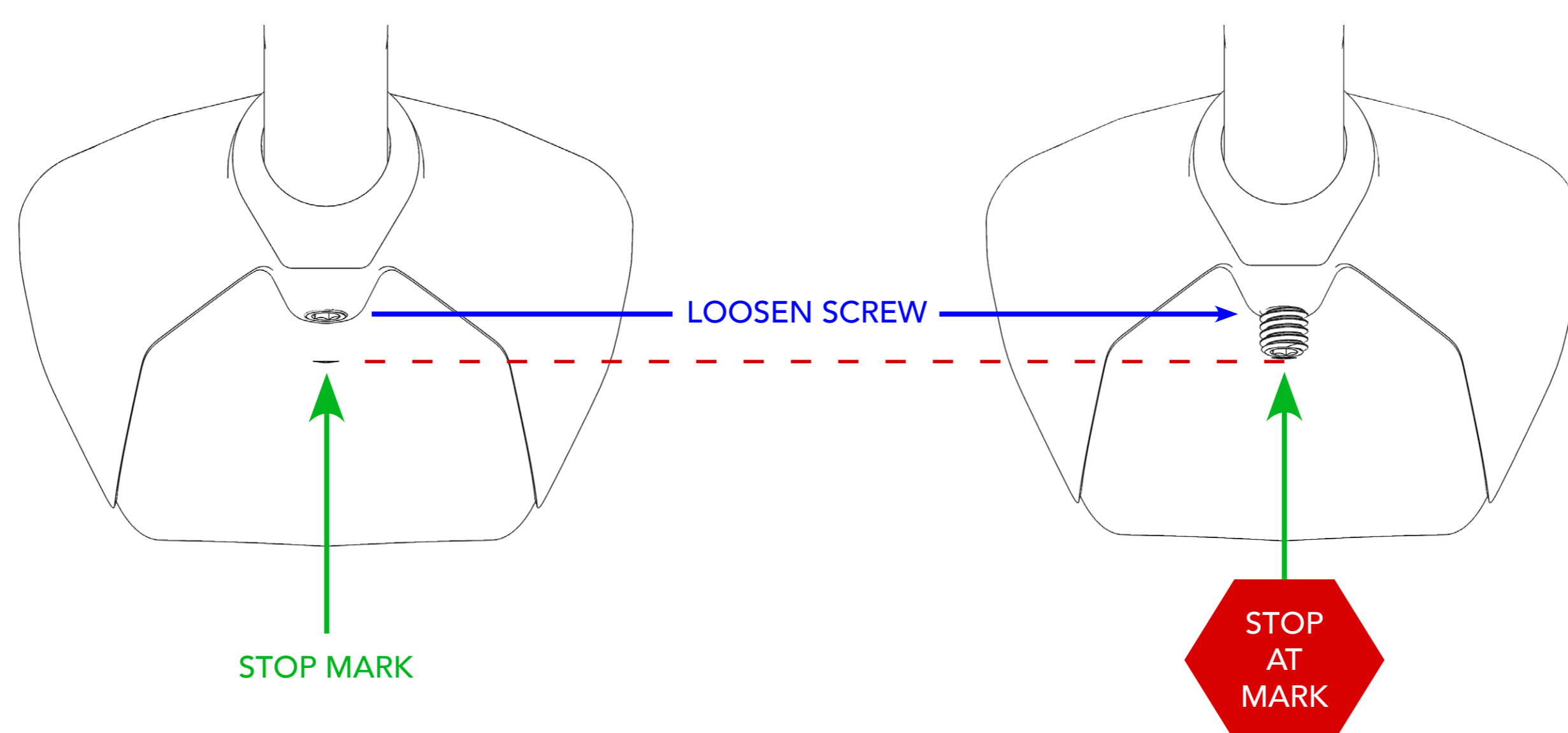

STEP 1: LOOSEN THE SCREW

Loosen the screw counter clockwise using a 2mm hex key. Stop loosening the screw once it is in line with the stop mark on the basket.

 Do not loosen the screw past the stop mark on the basket.

2

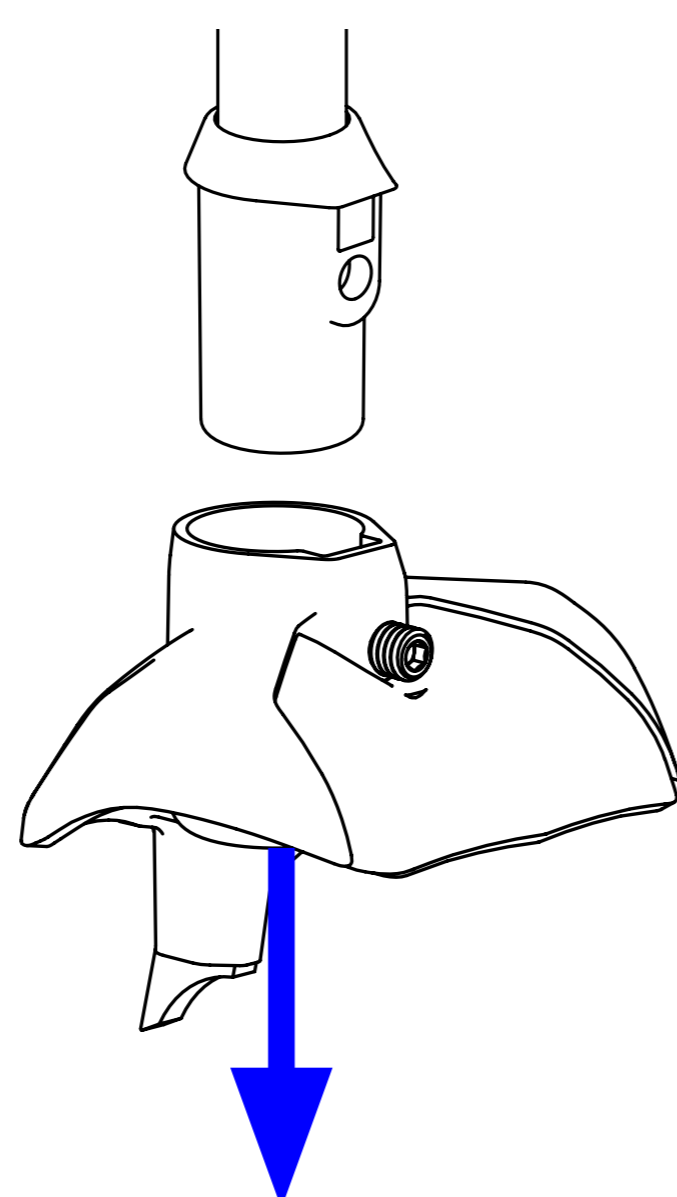

STEP 2: REMOVE THE BASKET

Remove the basket by sliding it off the end of the pole cap.

REMOVING POLE CAPS

1

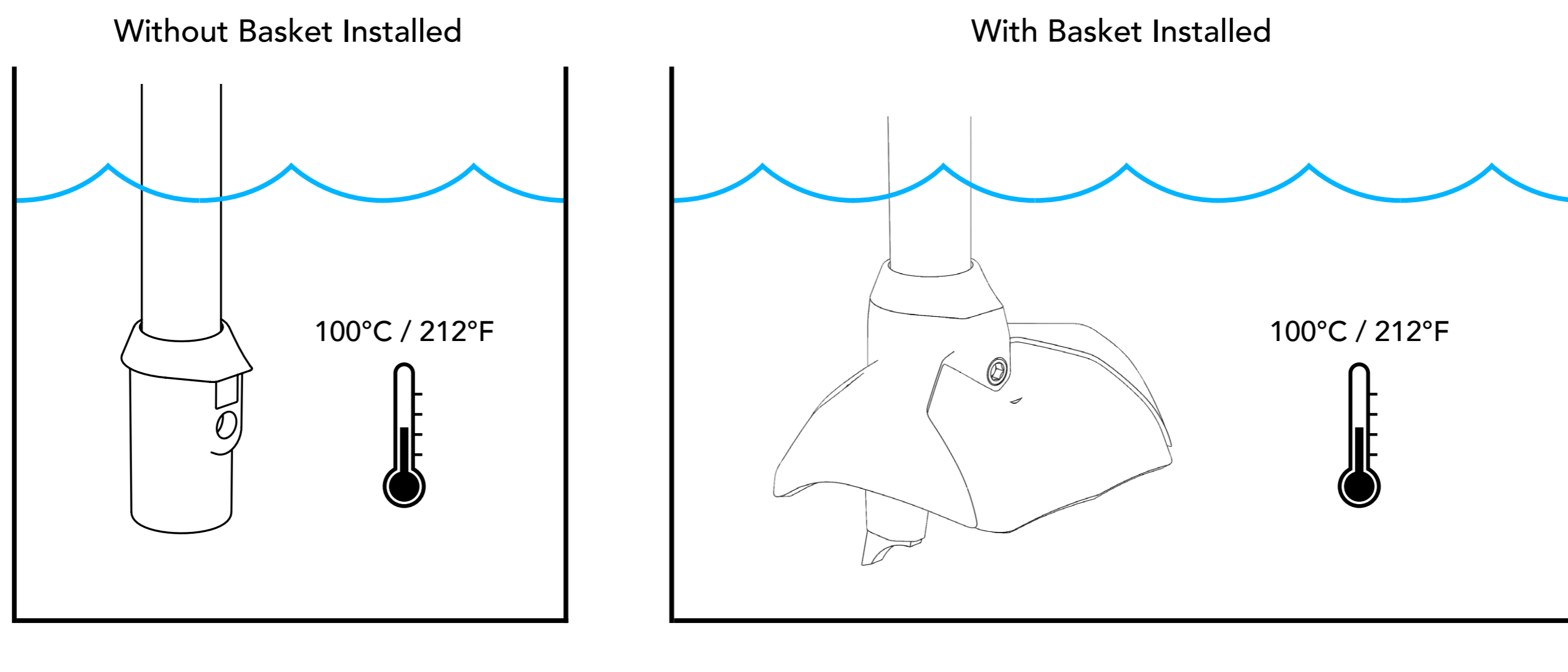

STEP 1: HEAT POLE CAP / BASKET

Put the end of the pole into boiling water, making sure to completely submerge the pole cap / basket. A heat gun can be used instead of boiling water, but only if the basket is not installed.

- ⚠ Do not use a heat gun if the basket is installed.
- ⚠ Be carefull not to overheat the pole cap if using a heat gun.

2

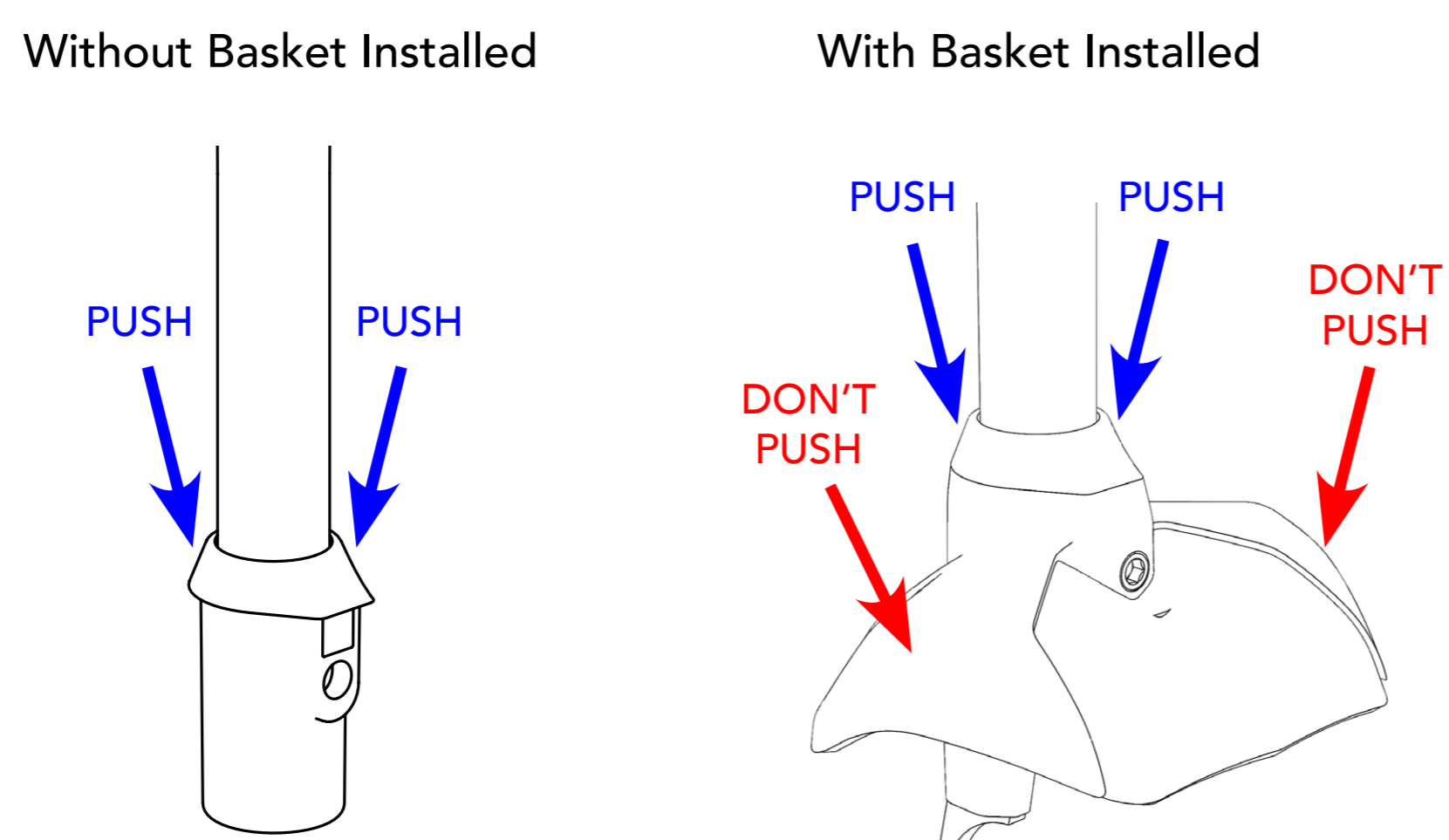

STEP 2: REMOVE POLE CAP

Remove the pole cap from the pole shaft by pushing down on the rim of the pole cap.

- ⚠ Do not push down on the basket. Only push down on the rim of the pole cap.