

RUNDLE

RUNDLE BASKET INSTRUCTION MANUAL

INSTALLING RUNDLE POLE CAPS

PAGE 2

INSTALLING BASKETS (SCREWS NOT PRE-INSTALLED)

PAGE 3

INSTALLING BASKETS (SCREWS PRE-INSTALLED)

PAGE 4

REMOVING BASKETS

PAGE 5

REMOVING RUNDLE POLE CAPS

PAGE 6

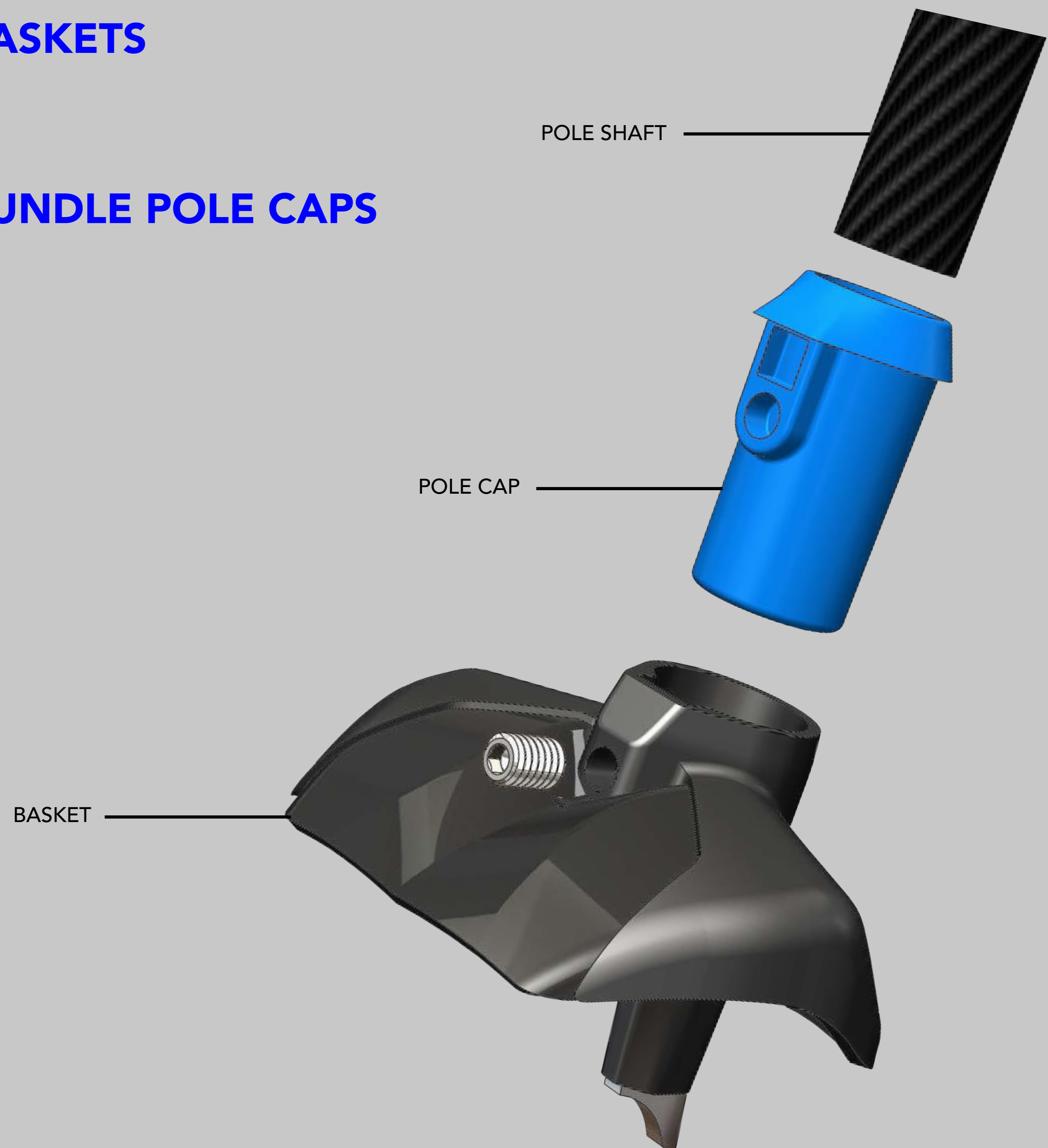

INSTALLING RUNDLE POLE CAPS

1

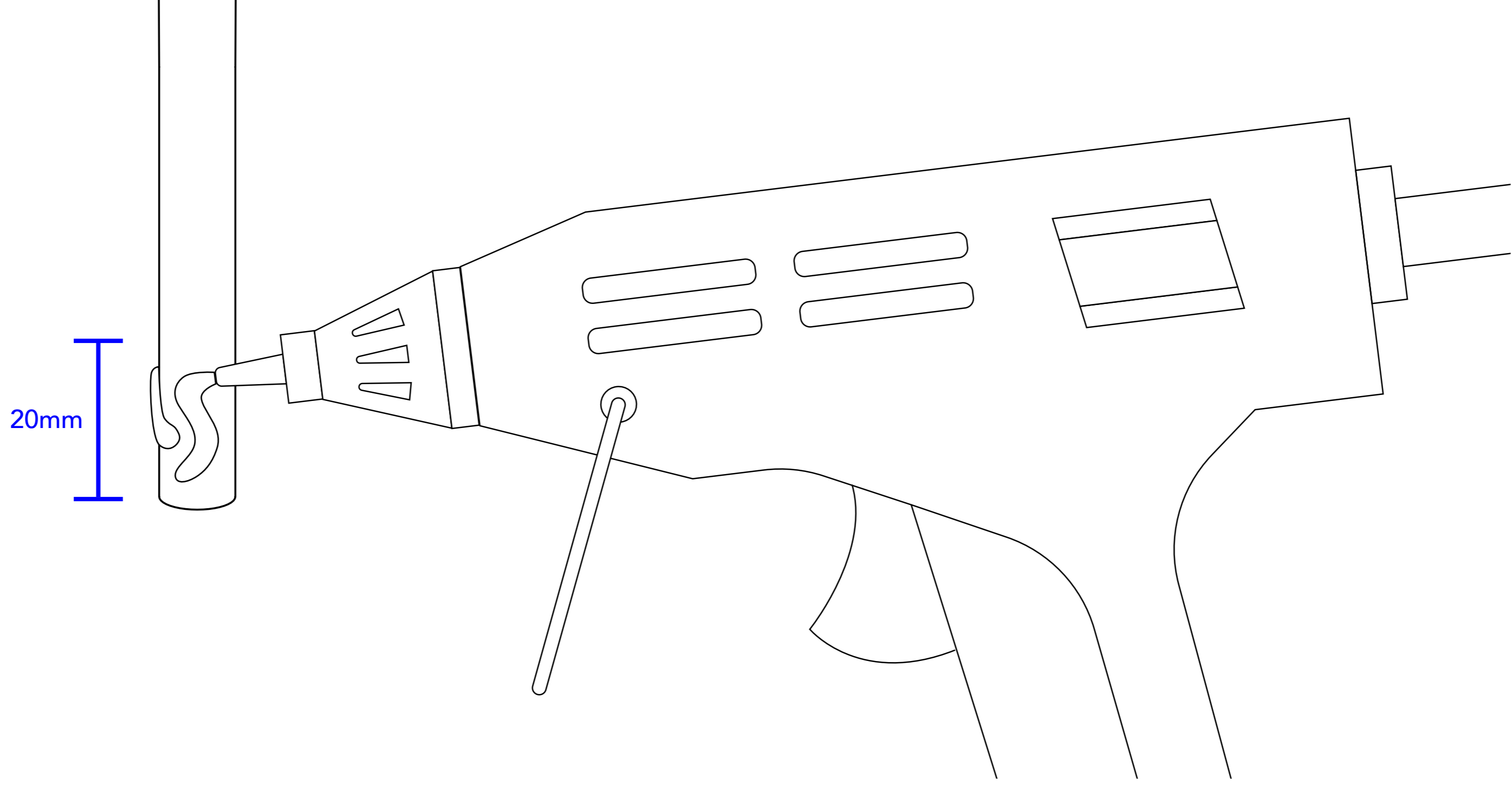

STEP 1: APPLY HOT GLUE TO BOTTOM OF POLE SHAFT

Apply hot glue to the bottom of the pole shaft using a hot glue gun, or by melting a glue stick using a different heat source. Glue should be applied to multiple areas around the circumference of the pole shaft.

- ⚠ Hot glue can burn skin, apply with care. Gloves and/or other heat protection is recommended.
- ⚠ Do not apply glue more than 20mm above the bottom of the pole shaft.

2

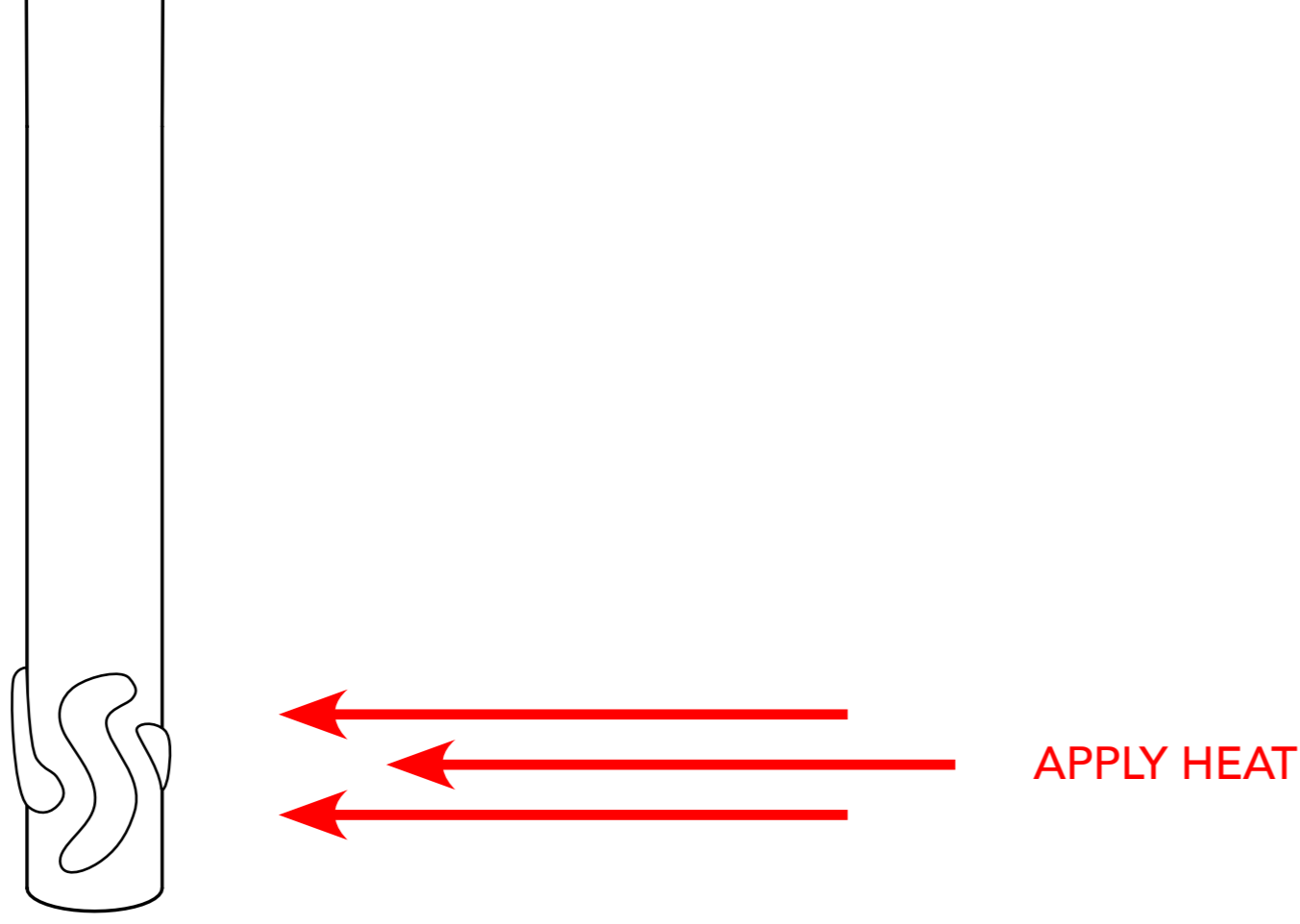

STEP 2: HEAT BOTTOM OF POLE SHAFT

Heat the bottom of the shaft using a heat gun or boiling water. Heating the pole shaft helps keep the glue in liquid form for a longer period time to ease installation of the pole cap.

- ⚠ Do not heat the shaft above 100°C / 212°F.
- ⚠ Steps 3, 4, and 5 should follow step 2 as quickly as possible. If steps 3, 4, and 5 take too long the glue may harden before the pole cap can be installed properly.

3

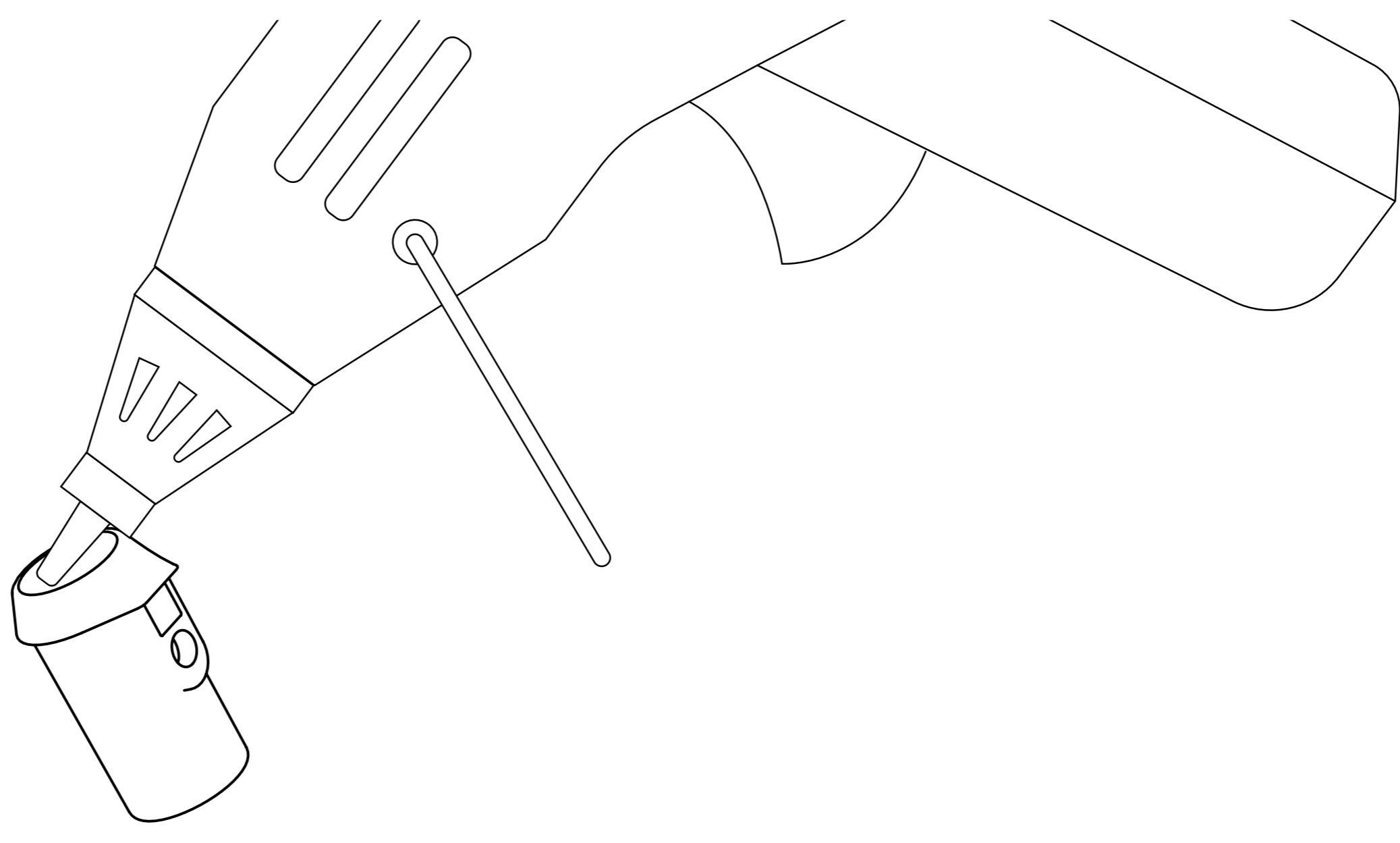

STEP 3: APPLY GLUE INSIDE POLE CAP

Apply hot glue to the inside of the pole cap using a hot glue gun, or by melting a glue stick using a different heat source. Glue should be applied to multiple areas around the inside circumference of the pole cap.

- ⚠ Hot glue can burn skin. Apply hot glue with care. Gloves and/or other heat protection is recommended.

4

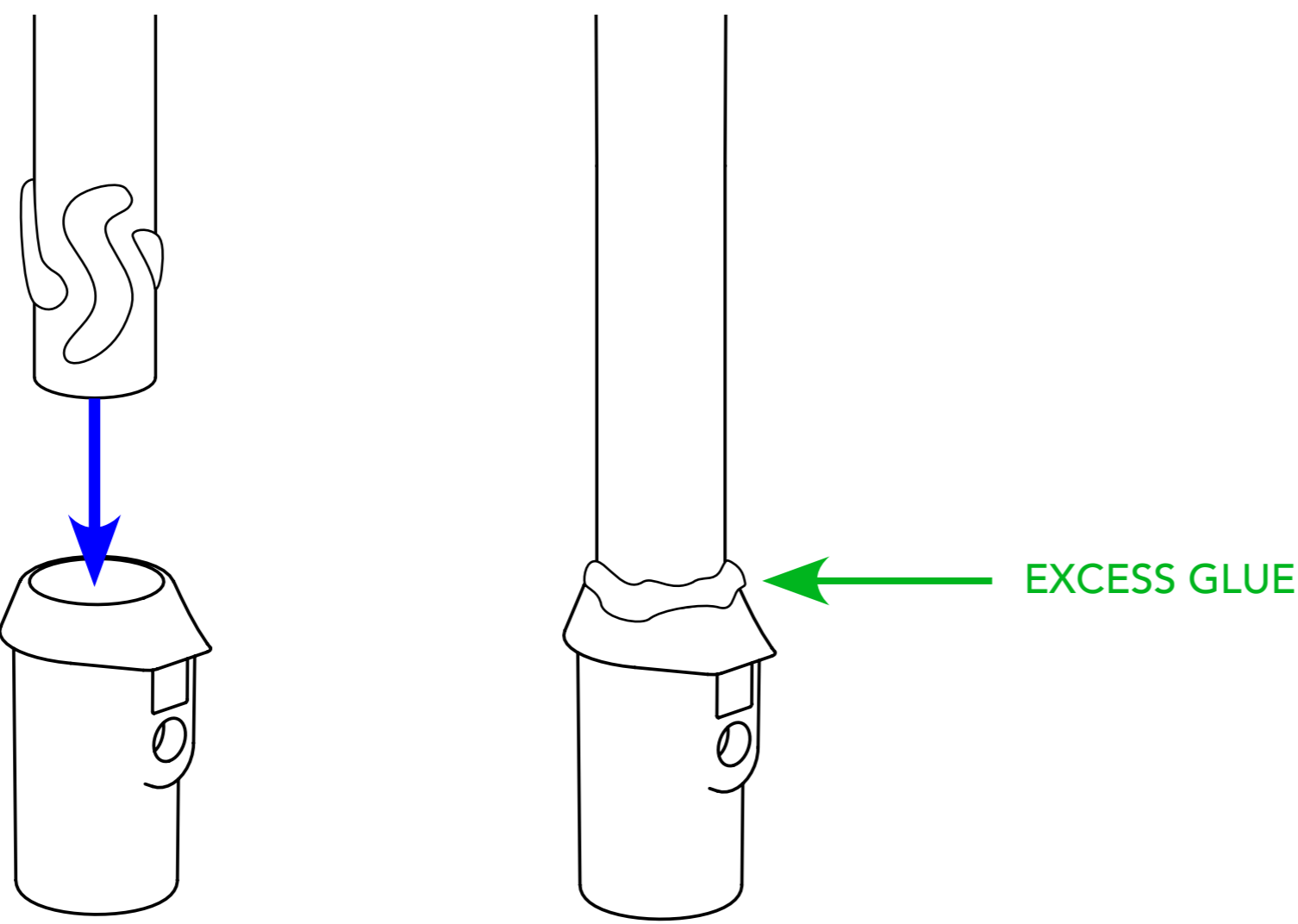

STEP 4: INSTALL POLE CAP

Insert the pole shaft into the pole cap. Make sure to insert the pole shaft completely so there is no gap between the bottom of the pole shaft and the bottom of the pole cap.

- ⚠ Glue and pole components will be hot during this step. Gloves and/or other heat protection is recommended.

5

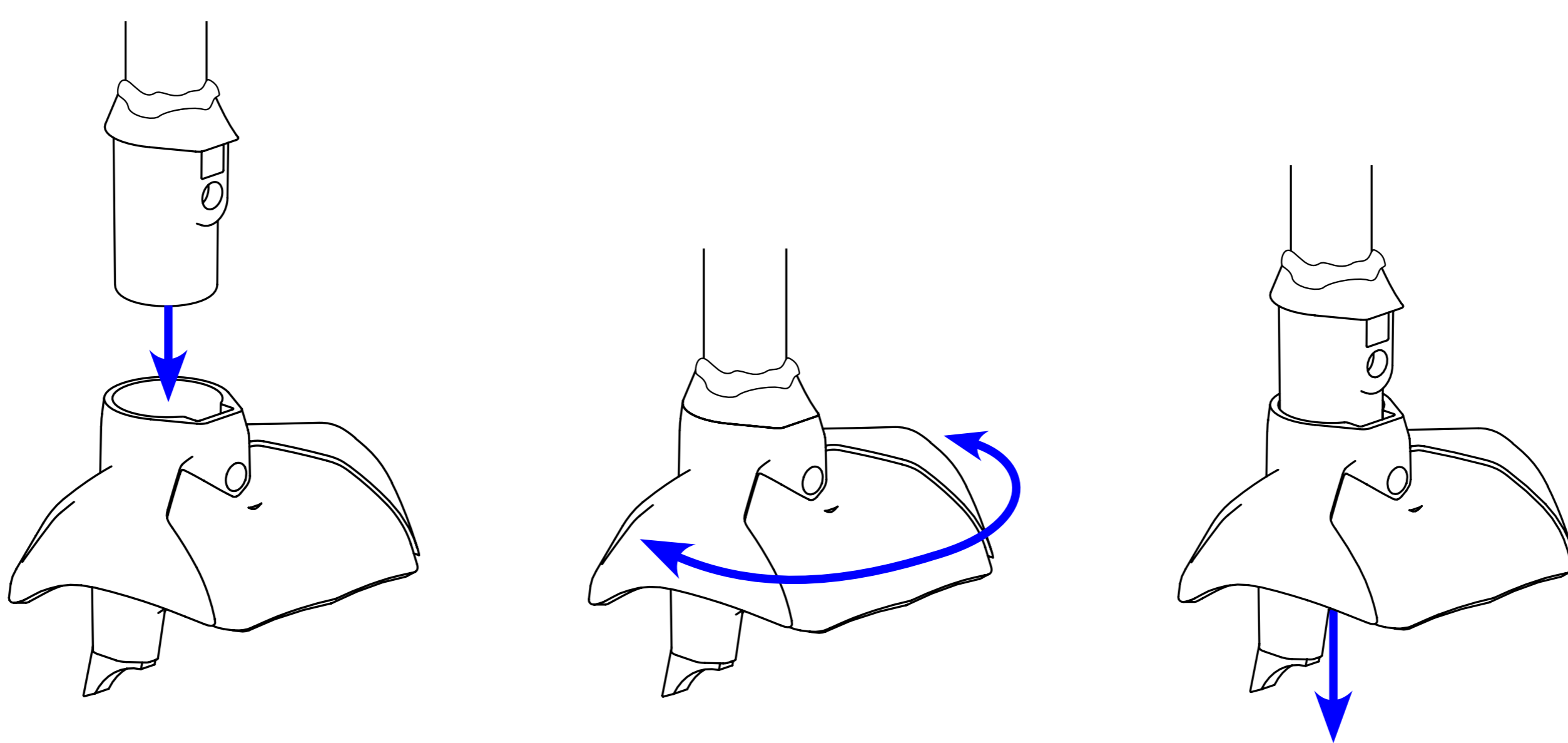

STEP 5: ALIGN POLE CAP

While the glue is still hot, slide a basket onto the pole and use the basket to align the pole cap. Twist the basket until it is in line with the handle and shaft logo, then gently slide the basket off.

- ⚠ Glue and pole components will be hot during this step. Gloves and/or other heat protection is recommended.

6

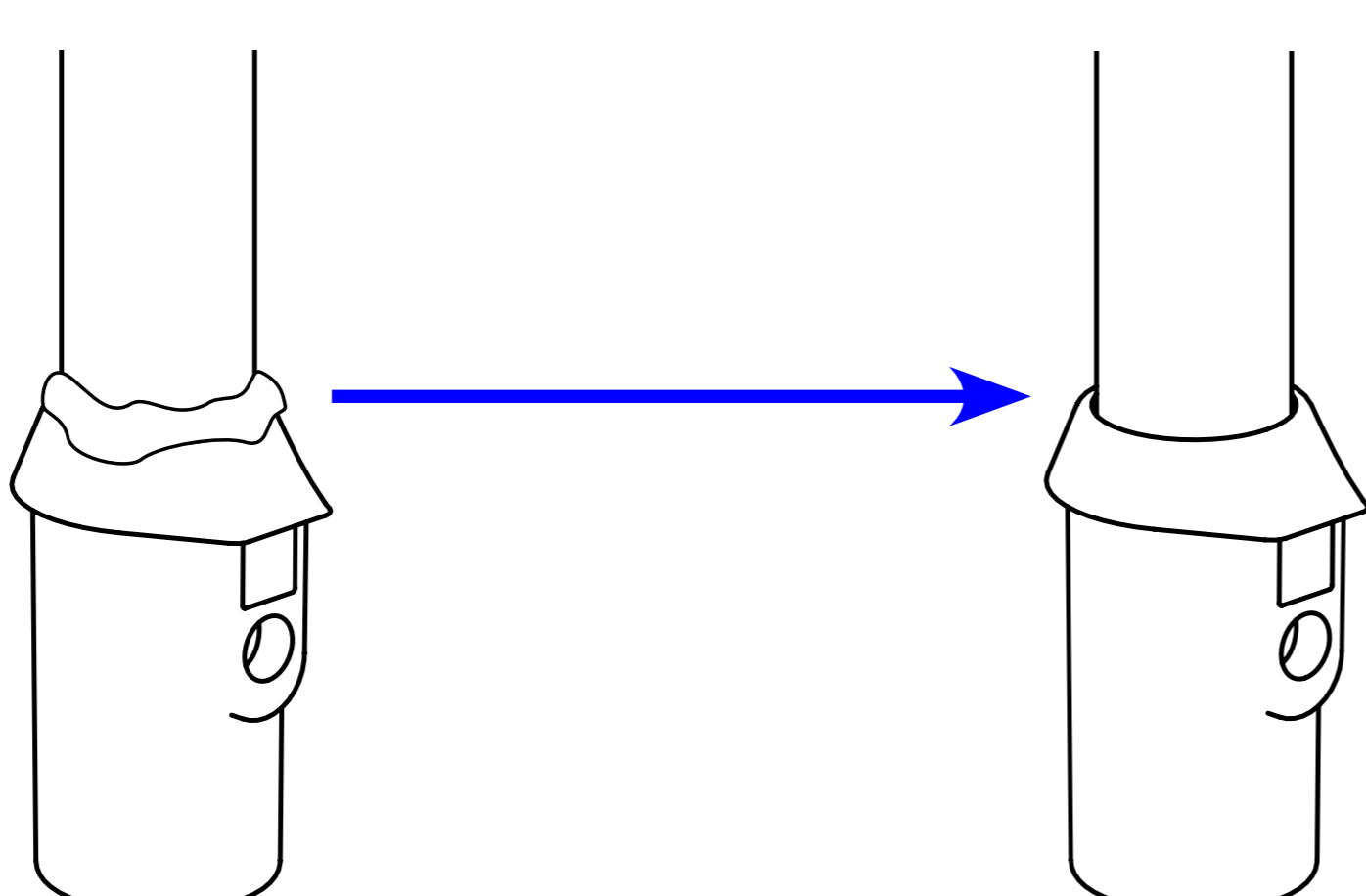

STEP 6: REMOVE EXCESS GLUE

Remove excess glue once the glue has hardened enough that the pole cap is securely fastened. Excess glue can be removed by wiping if the glue is still soft, or peeling if the glue has hardened.

RUNDLE

INSTALLING BASKETS (SCREWS NOT PRE-INSTALLED)

1

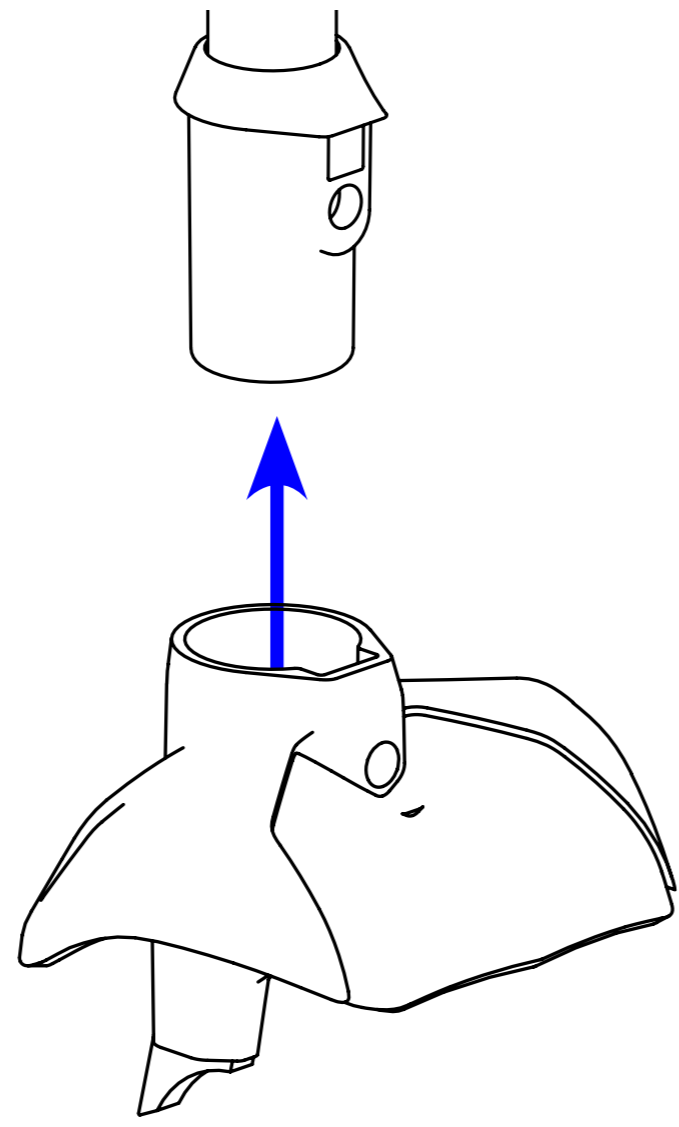

STEP 1: SLIDE BASKET ONTO POLE CAP

Slide the basket onto the pole cap.

2

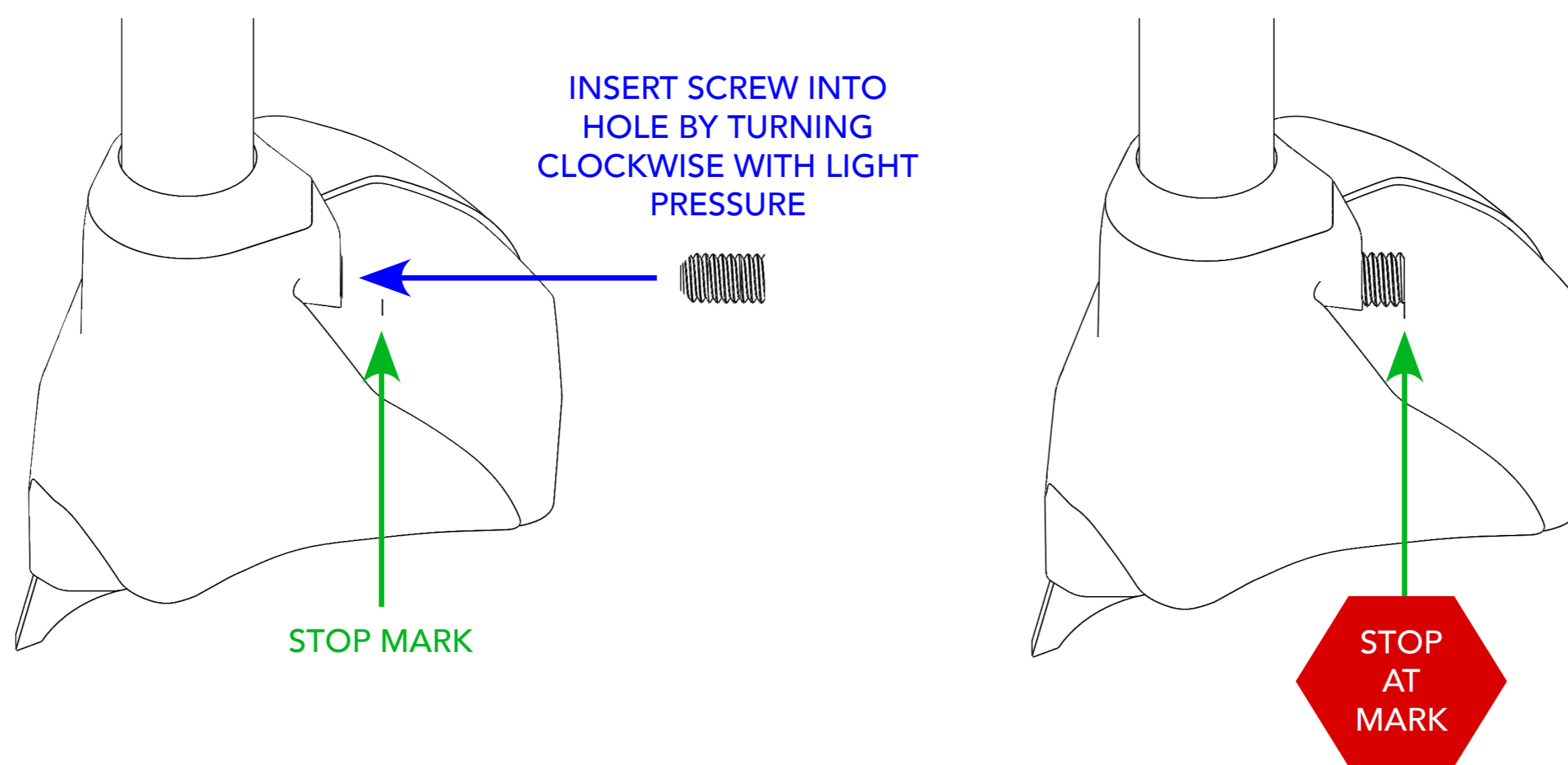

STEP 2: INSTALL THE SCREW

Using a 2mm hex key, apply light pressure to the screw and begin turning it clockwise into the hole. The screw will begin creating threads in the plastic and will start pulling itself into the basket as it is rotated. If the screw does not begin pulling itself into the basket, apply more pressure and continue rotating clockwise. Stop rotating once the screw is in line with the stop mark on the basket.

- ⚠ Install the screw into the hole as straight as possible. If the screw is installed off-angle either vertically or horizontally it may affect basket reliability. Take your time with this step and be precise.
- ⚠ Installing screws is easiest when the basket is at room temperature.

3

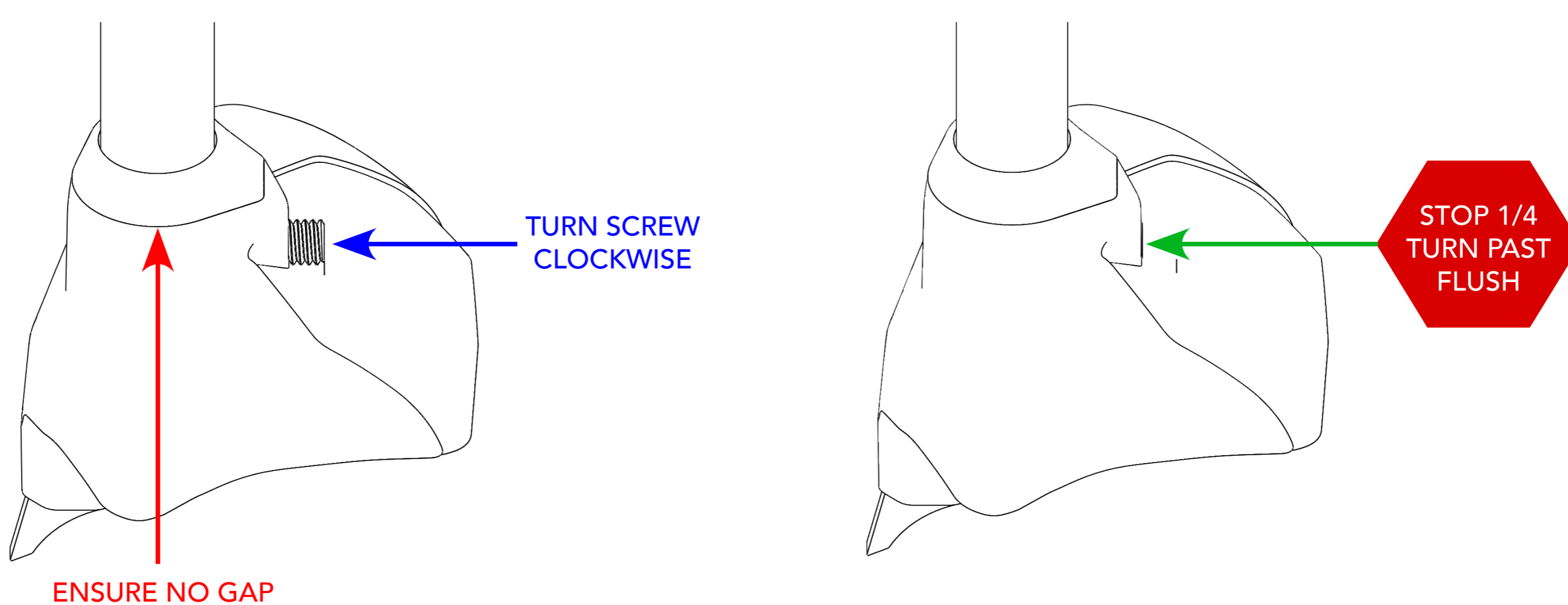

STEP 3: TIGHTEN THE SCREW

Hold the basket in place so that there is no gap between the top of the basket and the rim of the pole cap. Using a 2mm hex key, turn the screw clockwise. Once the screw is flush with the hole, turn the screw clockwise an additional 1/4 rotation.

- ⚠ Do not tighten the screw more than 1/2 rotation past flush.

RUNDLE

INSTALLING BASKETS (SCREWS PRE-INSTALLED)

1

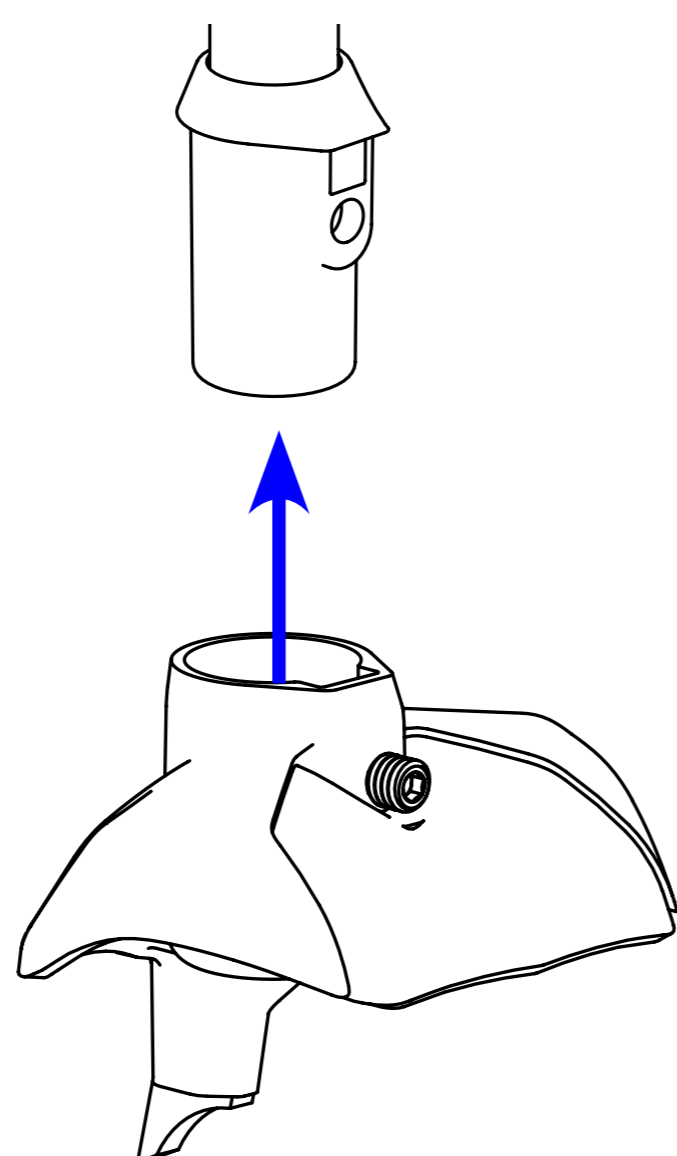

STEP 1: SLIDE BASKET ONTO POLE CAP

Slide the basket onto the pole cap.

2

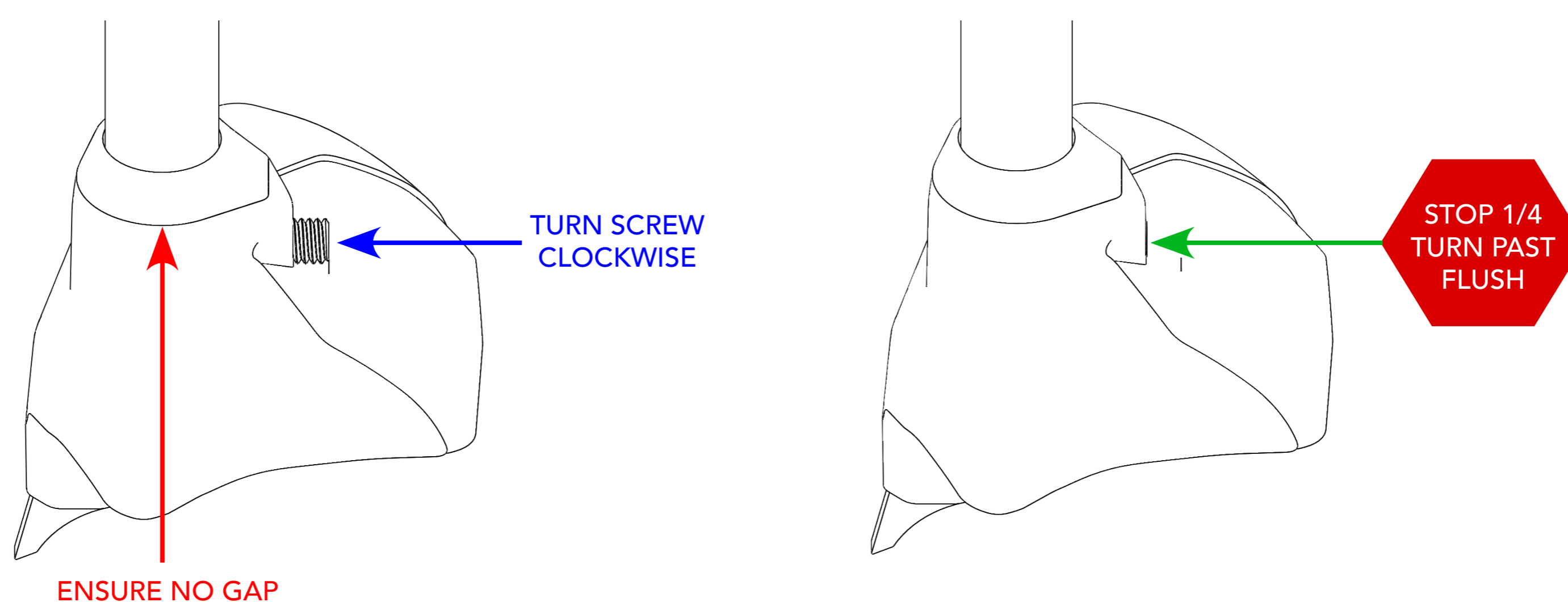

STEP 2: TIGHTEN THE SCREW

Hold the basket in place so that there is no gap between the top of the basket and the rim of the pole cap. Using a 2mm hex key, turn the screw clockwise. Once the screw is flush with the hole, turn the screw clockwise an additional 1/4 rotation.

 Do not tighten the screw more than 1/2 rotation past flush.

REMOVING BASKETS

1

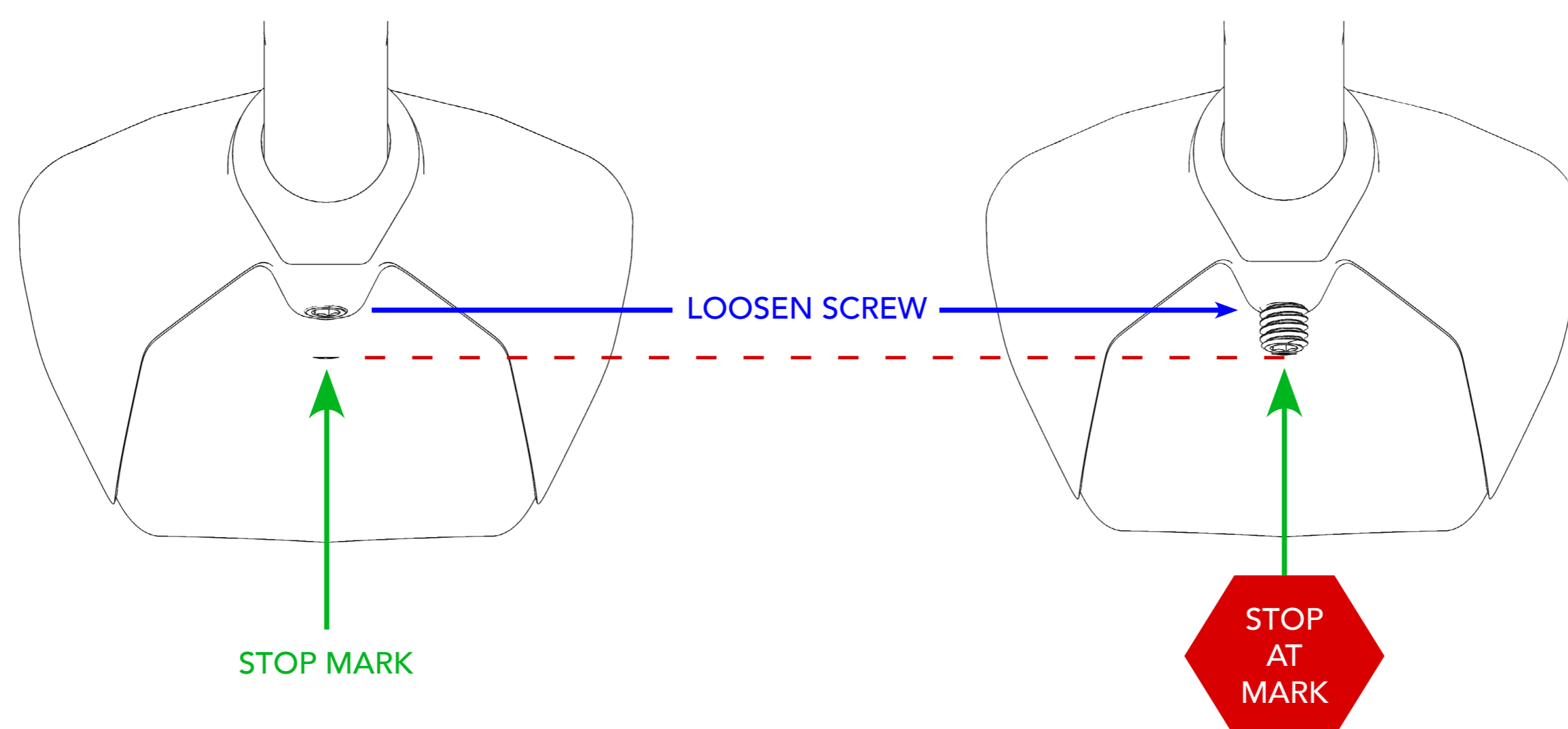

STEP 1: LOOSEN THE SCREW

Loosen the screw counter clockwise using a 2mm hex key. Stop loosening the screw once it is in line with the stop mark on the basket.

 Do not loosen the screw past the stop mark on the basket.

2

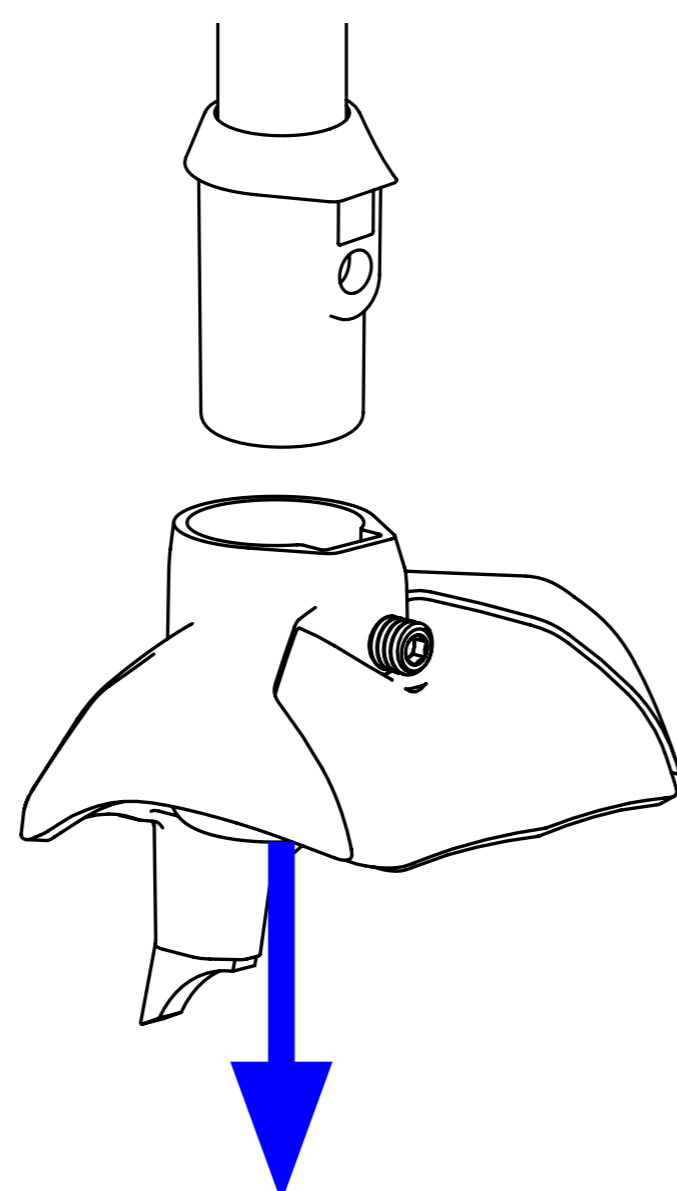

STEP 2: REMOVE THE BASKET

Slide the basket down off the end of the pole to remove it.

RUNDLE

REMOVING RUNDLE POLE CAPS

1

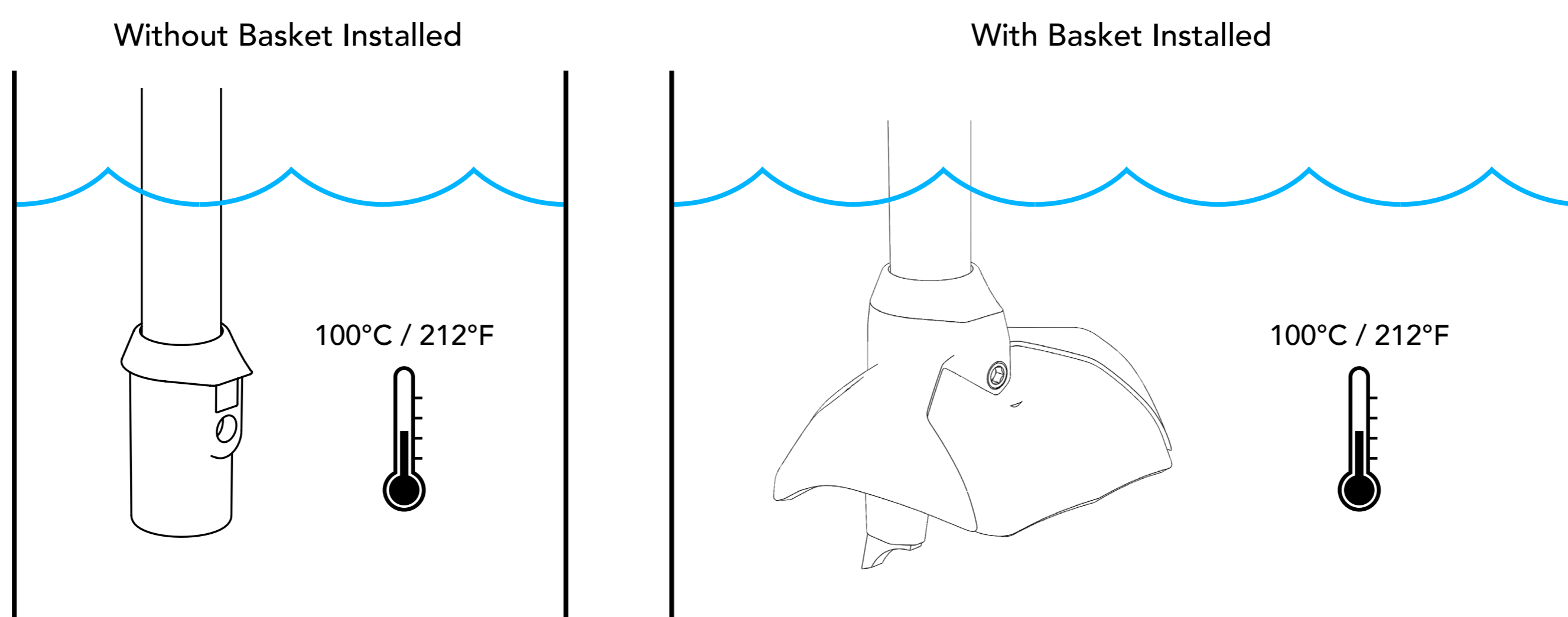

STEP 1: HEAT POLE CAP / BASKET

Put the end of the pole into boiling water, making sure to completely submerge the pole cap / basket. A heat gun can be used instead of boiling water, but only if the basket is not installed.

⚠ If the basket is installed, do not use a heat gun.

2

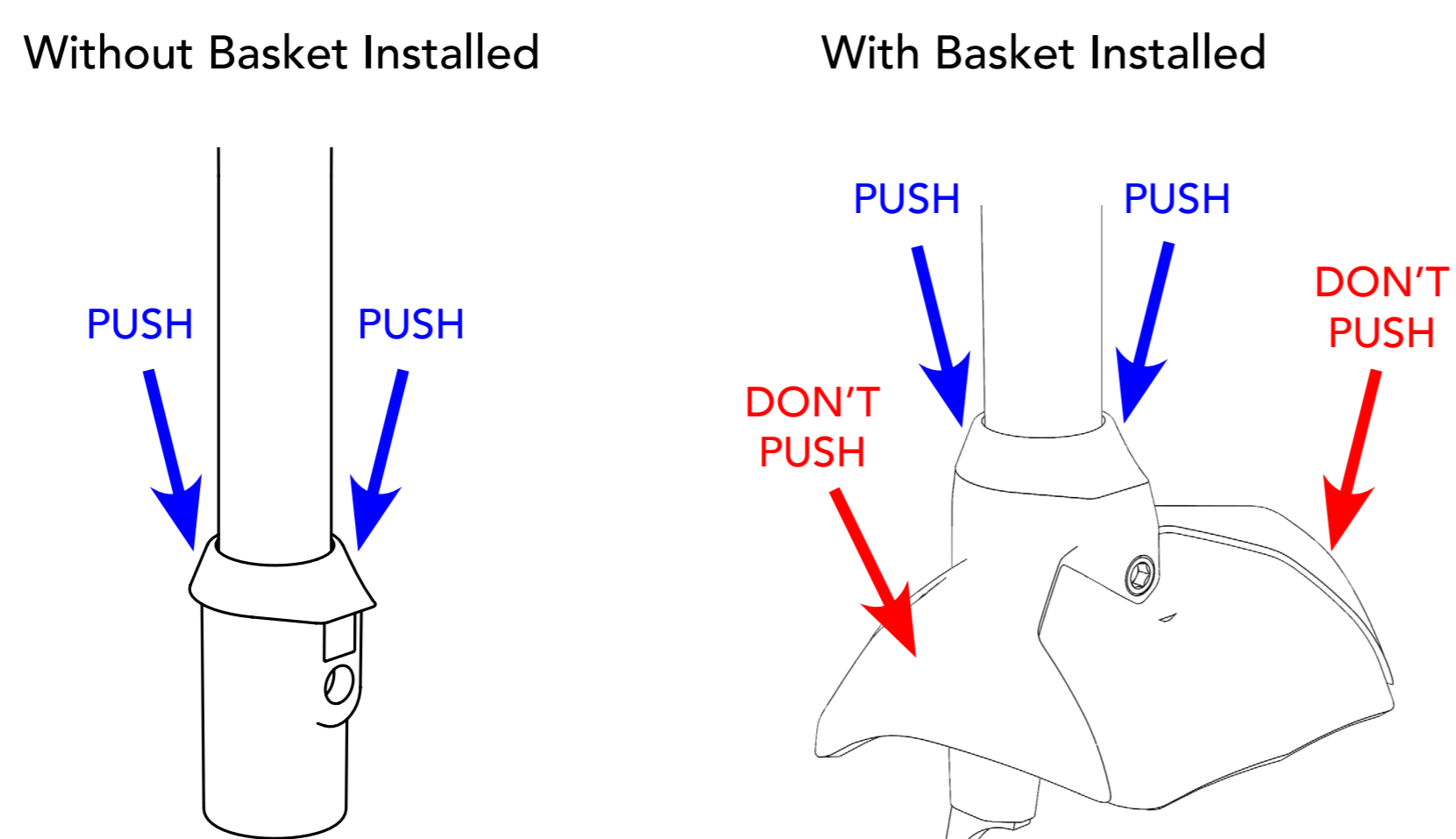

STEP 2: REMOVE POLE CAP

Remove the pole cap from the pole shaft by pushing down on the rim of the pole cap.

⚠ Do not push down on the basket. Only push down on the rim of the pole cap.