



- BAY -
SPORTS

FLAP
PEDAL
DRIVE





PEDAL ADJUSTMENT DECAL



01 PEDAL PAD KIT

- 011 PEDAL/CRANK ASSY. (R)
- 012 PEDAL/CRANK ASSY. (L)
- 013 PEDAL ONLY (R)
- 014 PEDAL ONLY (L)
- 015 PEDAL STRAP (R)
- 016 PEDAL STRAP (L)
- 017 CAP - PEDAL
- 018 NUT
- 019 WASHER

02 PEDAL ADJ ASSY INCLUDES:

- 021 PLASTIC HANDLE
- 022 PIN
- 023 SCREW
- 024 SPRING
- 025 ALLEN WRENCH



- 031 OUTHAUL BLO
- 032 CLEVIS PIN
- 033 LOCK RING

- 034 SPROCKET GUARD FWD
- 035 SCREW



041 SPINE
NEW 2019

051 SPROCKET S1 THREADED (W/ FWD GUARD)



042 SPROCKET SHAFT
043 SET SCREW

061
STANDARD FIN



- 052 MAST S1 THREADED
- 053 MAST / ST TURBO S1 THREADED
- 054 LOC-TITE .5ML

**UPDATE KIT - S1 SPROCKET
(2 S1 SPROCKETS AND 2 S1 MASTS)
0511 S1 STANDARD MAST KIT
0512 S1 TURBO MAST KIT**

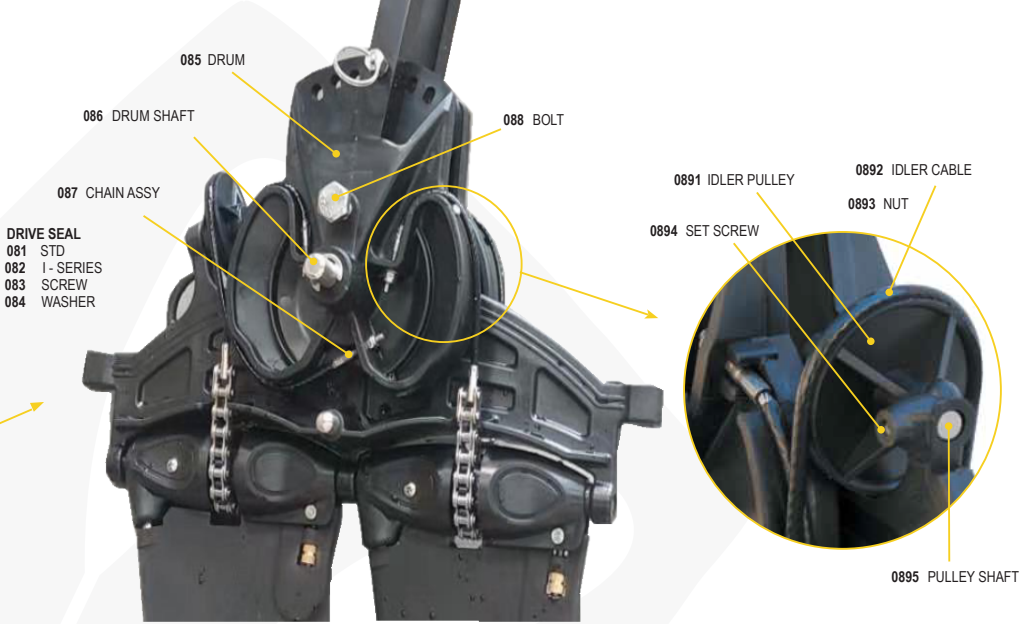

Maintenance & Care:
[Click here to view our maintenance & care information](#)

Spare parts includes
 2 x fins + 1 x grub screw

The pedal drive unit is constructed of aluminium whilst the mast and chain are stainless steel construction

THANK YOU

OUR SUPPORT



support.baysports.com.au

VISIT US



baysports.com.au



View our Locations

baysports.com.au/pages/contact-us

SHARE YOUR EXPERIENCE



[@BaySportsCo](https://www.facebook.com/BaySportsCo)



[@BaySports_Co](https://www.instagram.com/BaySports_Co)

