

- BAY -
SPORTS

PEDAL PRO FISH



INSTRUCTIONS



TABLE OF CONTENTS

WELCOME	4
PARTS	5
ASSEMBLY	6
WARRANTY & LIABILITY	8

WELCOME

Thank you for purchasing a Pedal Pro Fish. We hope you thoroughly enjoy this product. Please take time to read the content in this manual in order to optimise your satisfaction of this product. We believe that a Bay Sports kayak offers incomparable value.

Visit our website at any time for more information.

www.baysports.com.au

PARTS

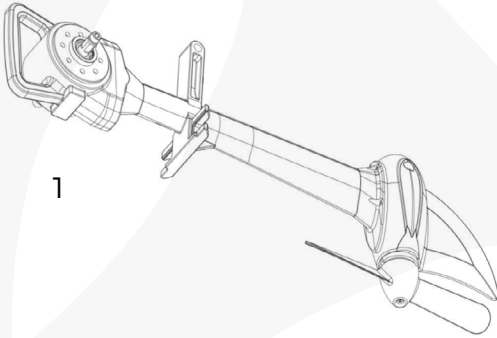

1

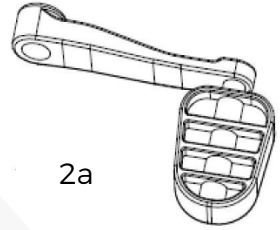

2a

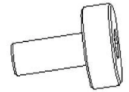

2b

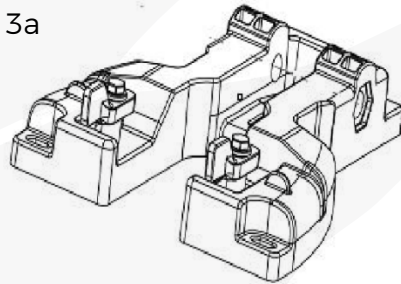

3a

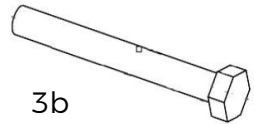

3b

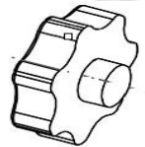

3c

1. Pedal Body - Qty: 1

2a. Foot Pedal - Qty: 2

2b. With ring & screws - Qty: 2

3a. Connector/locker for pedal & kayak body - Qty: 1

3b. Qty: 1

3c. Qty: 1

TOOL REQUIRED:

Included 4x Allen Wrench



M3 Screwdriver - M8 Screwdriver - M4
Screwdriver and M5 Screwdriver required.

EXTRA PARTS

FOR WARRANTY:

Locker: x2

Seal Ring: x6

Grease Seal: x2

ASSEMBLY

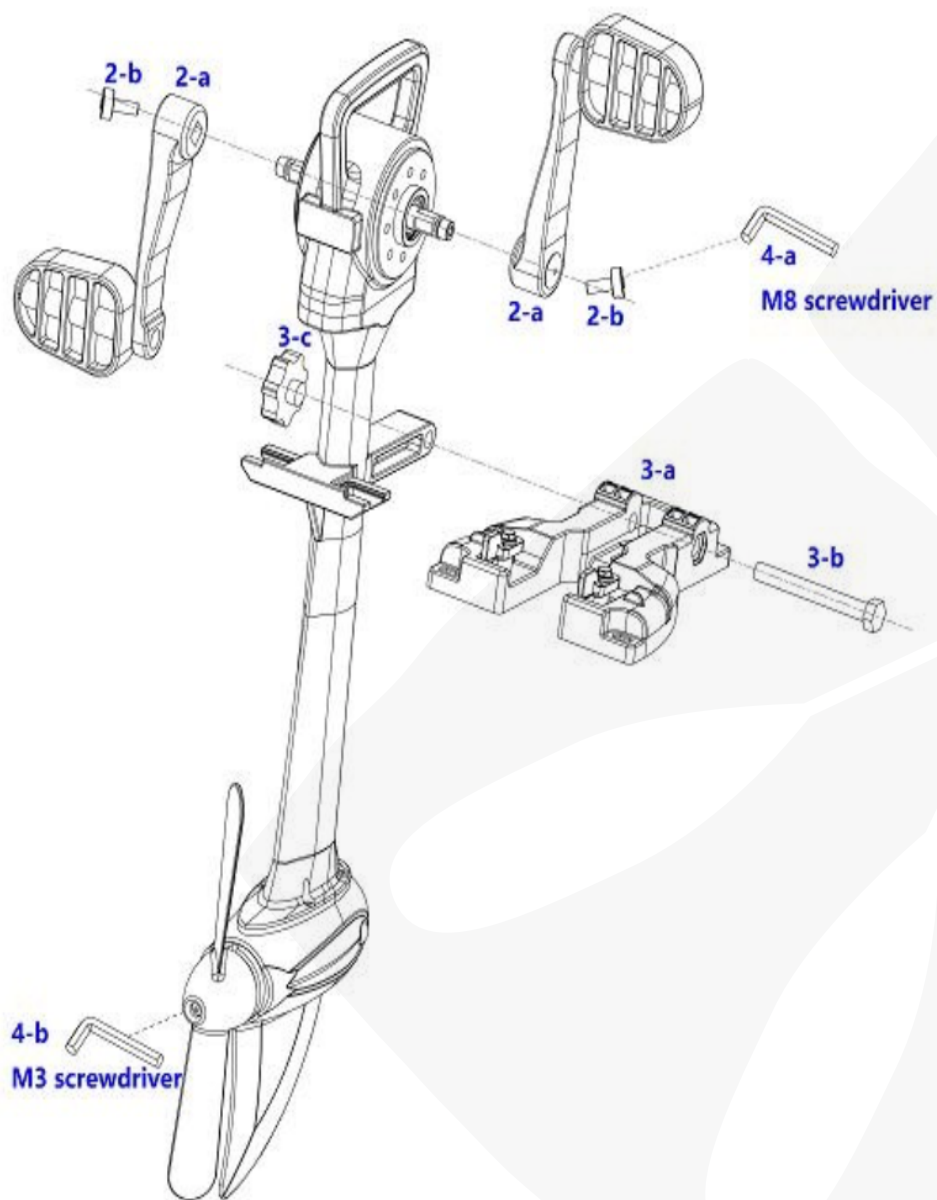

STEP 1

Connect 2x foot pedal kit by 4-a M8 screwdriver. (Please note right and left side).

STEP 2

Screw the base (3-a) on the kayak.(If already screwed, ignore this step).

STEP 3

Connect pedal body and the base (3-a) through 3-b and 3-c by hand.

STEP 4

To pivot the pedal drive system into/out of the water, rotate both locker arms anti-clockwise first, then push the pedal drive system away from you to pivot it up and out of the water.

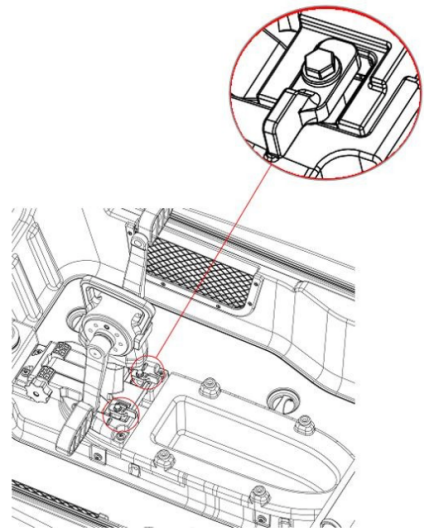
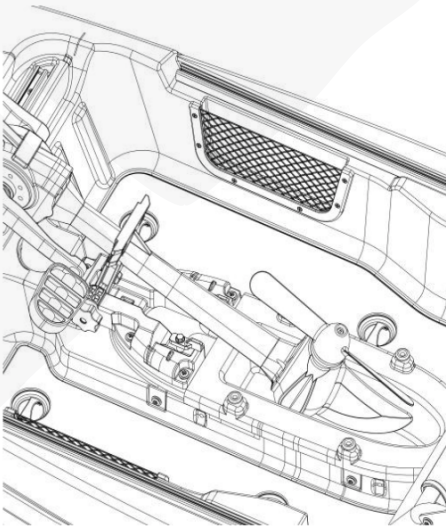

PRODUCT WARRANTY AND LIABILITY

GENERAL PRODUCT WARRANTY

Products purchased from the Authorized Dealer (original place of purchase) or Merchant (“Dealer”) will be free of defects in material and workmanship at the time of receipt, and will meet the specifications stated at the place of purchase transaction or online at the Dealer’s website, under normal use and service when correctly installed, operated and maintained.

This product warranty is effective for the period of time stated below, unless otherwise stated in the product instructions or depicted in the product advertisement. All Authorized Dealer warranties are NON-TRANSFERABLE and cover only the original end purchaser. This limited warranty does not cover products purchased through non-authorized dealers. Non-authorized dealer receipts are not accepted for warranty verification.

Warranty claims must be made directly to the original place of purchase.

WARRANTY PERIOD

This warranty remains in force for two years from the date of the product’s accepted delivery. The Authorized Dealer offers a two years manufacturer’s warranty for most products unless otherwise specified on the product advertisement.

WARRANTY SERVICE

The Authorized Dealer will replace any defective or malfunctioning part at no charge, including payment of the shipping costs of parts or replacement product to and from the manufacturer. The purchaser is responsible for labor charges. If the product does not meet specifications as depicted in the advertisement, the Authorized Dealer will refund the full purchase price of the product. Questions regarding the warranty on a specific product and warranty claims should be directed to the Authorized Dealer with whom the purchase transaction was made.

WARRANTY LIMITATIONS

The above warranty does not apply to products that are repaired, modified or altered by any party other than the Authorised Dealer; are subjected to unusual physical stress or conditions (such as overloaded ramps or corrosion), natural disaster, governmental actions, wars, strikes, labor disputes, riots, theft, vandalism, terrorism or any reason beyond reasonable control; are damaged due to improper installation, misuse, abuse, accident or negligence in use, storage, transportation or handling, or tampering; or to products that are considered consumable items or items requiring repair or replacement due to normal wear and tear. Product should be inspected prior to signing for delivery. Product damage incurred during shipping, unless noted on the Bill of Lading at the time of delivery, renders this warranty void.

LIMITED LIABILITY

In no event shall THE AUTHORISED DEALER be liable to the purchaser or any third party for any indirect, incidental, consequential, special, exemplary or punitive damages arising out of the use of the product, including, without limitation, property damage, loss of value of the product or any third party products that are used in or with the product, or loss of use of the product or any third party products that are used in or with the product.

THANK YOU

OUR SUPPORT



support.baysports.com.au

VISIT US



baysports.com.au



6 Woods Close,
Huntingwood NSW 2148

SHARE YOUR EXPERIENCE



[@BaySportsCo](https://www.facebook.com/BaySportsCo)



[@BaySports_Co](https://www.instagram.com/BaySports_Co)

