



MODELS	CAPACITY
SL-926-100	100 lb x 0.01 lb
SL-926-250	250 lb x 0.02 lb
SL-926-500	500 lb x 0.05 lb
SL-926-1K	1,000 lb x 0.1 lb
SL-926-2K	2,000 lb x 0.2 lb
SL-926-3K	3,000 lb x 0.5 lb
SL-926-5K	5,000 lb x 0.5 lb
SL-926-10K	10,000 lb x 1 lb
SL-926-20K	20,000 lb x 2 lb

FEATURES

- General weighing for many applications
- Selectable weighing units: lb, kg
- Includes SL-7516 LED or LCD indicator with rechargeable battery
- Standard indicator functions include Tare, Print, and Peak Hold
- 19' load cell cable (longer cables available)
- Eyebolts included
- Indicator upgrade to NEMA 4 stainless steel for washdown applications
- RS232 port for printer or computer

OPTIONAL ACCESSORIES

- Indicator Upgrade
- Waterproof hard case
- Scoreboard
- Indicator stand
- Software

DIMENSIONS

100 lbs to 20,000 lbs

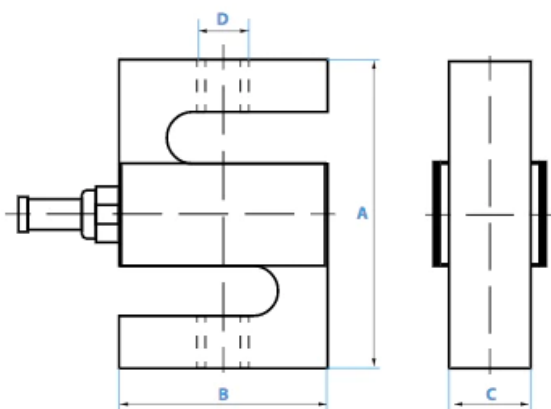

RATED CAPACITY	DIMENSIONS			
	A	B	C	D
LB/INCHES				
100 - 200 lbs	2.50	2.00	0.50	1/4-28UNF-2B
250 - 300 lbs	2.50	2.00	0.50	3/8-24UNF-2B
500 - 1,000 lbs	2.50	2.00	0.75	1/2-20UNF-2B
2K - 3K lbs	3.00	2.00	1.00	1/2-20UNF-2B
5K - 10K lbs	4.25	3.00	1.00	3/4-16UNF-2B
15K lbs	5.50	4.00	1.25	1-12UNF-2B
20K lbs	7.00	5.00	2.00	1 1/4-12UNF-2B
KG/MM				
25 kgs	63.50	50.80	12.70	M6
50 - 70 kgs	63.50	50.80	12.70	M6
100 - 700 kgs	63.50	50.80	19.05	M12
1,000 - 1,500 kgs	76.20	50.80	25.40	M12
2,000 - 5,000 kgs	107.95	76.20	25.40	M20x1.5
7,000 kgs	139.70	101.60	31.75	M20x1.5
10,000 kgs	177.80	127.00	50.80	M30x2