



### FEATURES

- Durable cast aluminum housing, ideal for harsh environments and all your overhead weighing needs
- Features an easy to read, backlit LED or LCD display
- Measured values in either pounds (lb) or kilograms (kg)
- Powered using a rechargeable battery pack (up to 80hrs)
- The wireless remote control allows users to change units, clear measurements, zero and tare out weight
- The remote control can capture peak weight at a distance of up to 100 feet (30m)
- Octagonal shape for capacities 3k - 20k
- Rectangular shape for capacity 40k
- 5-years warranty

#### LED DISPLAY

MODELS	CAPACITY
SL-925A-3K	3000 lb x .5 lb
SL-925A-6K	6000 lb x .5 lb
SL-925A-10K	10000 lb x .5 lb
SL-925A-20K	20000 lb x .5 lb
SL-925A-40K	40000 lb x .5 lb

#### LCD DISPLAY

MODELS	CAPACITY
SL-925B-3K	3000 lb x .5 lb
SL-925B-6K	6000 lb x .5 lb
SL-925B-10K	10000 lb x .5 lb
SL-925B-20K	20000 lb x .5 lb
SL-925B-40K	40000 lb x .5 lb

### 6K, 10K, 20K ▼

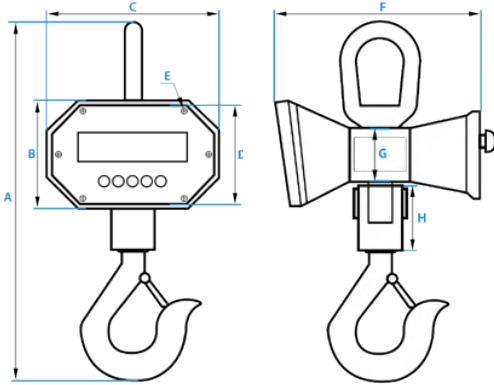

EXTERIOR DIMS. 6K, 10K, 20K			
A	B	C	D
18"; 26"; 29"	6.14"	9.83"	5.65"
E	F	G	H
0.28"	11.2"	2.97"	3.5";6.5";8.5"

### Up to 10K lbs ▼

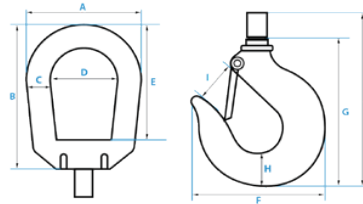

### 20K lbs ▼

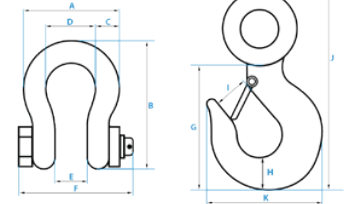

HOOK DIMENSIONS						
CAPACITY	A	B	C	D	E	F
6,000 lbs	4.52"	5.91"	0.95"	3.58"	4.72"	4.54"
10,000 lbs	5.40"	7"	1.25"	2.95"	1.92"	6.50"
20,000 lbs	6"	8"	1.40"	3.21"	2.21"	7.25"
CAPACITY	G	H	I	J	K	
6,000 lbs	5.36"	1.45"	1.45"	6.06"	•	
10,000 lbs	6.40"	1.91"	1.65"	9.50"	6"	
20,000 lbs	8.00"	2.40"	2.00"	12.20"	7.00"	

### 40,000 lbs ▼

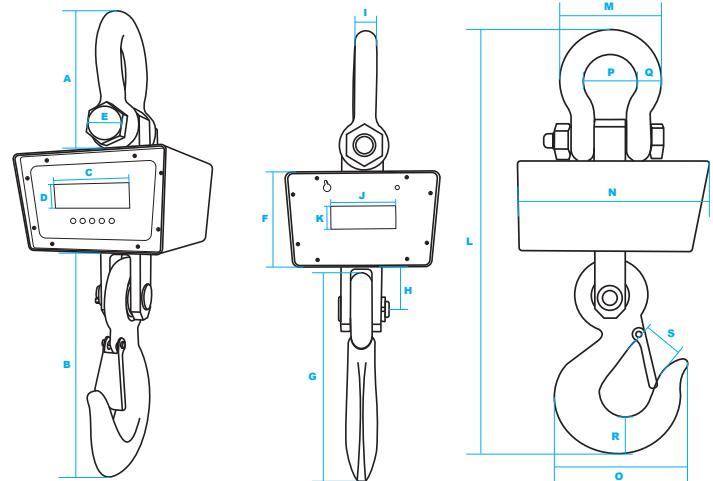

### 60K-100K lbs ▼

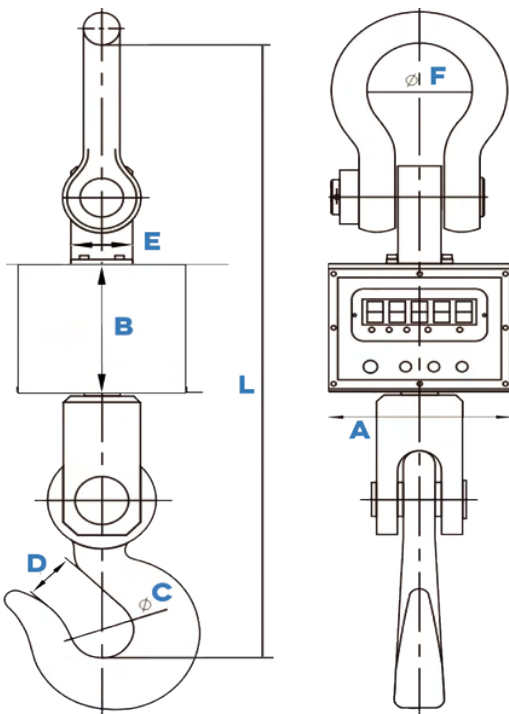

40K LB CAPACITY DIMENSIONS										
A	B	C	D	E	F	G	H	I	J	
5.5"	20"	6"	1.2"	2.9"	7.5"	17"	4.5"	1.95"	5"	
K	L	M	N	O	P	Q	R	S		
1.6"	40"	9.25"	15.75"	13.25"	5"	2.25"	4"	3.4"	•	

### 60K-100K lbs ▼

60K-100K LB CAPACITY DIMENSIONS							
CAPACITY	A	B	C	D	E	F	L
60,000 lbs	9.29"	6.25"	5.11"	4.72"	8.34"	5.90"	39.05"
80,000 lbs	11.81"	8.46"	5.90"	5.11"	11.81"	8.42"	47.75"
100,000 lbs	11.81"	8.46"	5.90"	5.11"	11.81"	8.42"	47.75"