

# SL-818-SS Single-Ended Beam, Stainless Steel | IP67

## NTEP 1:5,000 Class III Multiple Cell

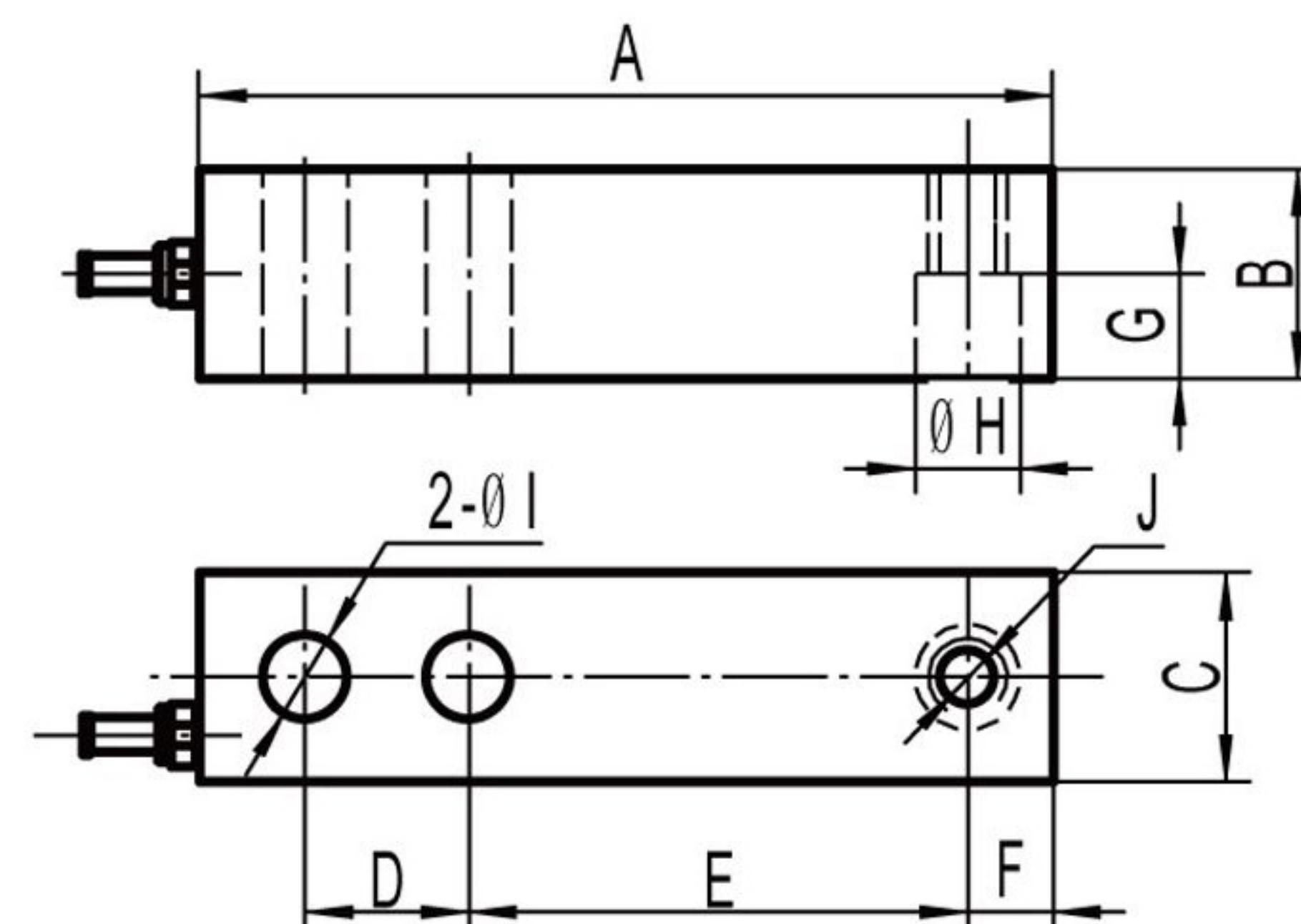

### Interchangeable Products

- ◆ Transcell **SBS**
- ◆ Artech **SS30310**
- ◆ Revere **9123**
- ◆ Sensortronics **65023S**
- ◆ Celtron **SQB SS**
- ◆ HBM **B35 RLWS**
- ◆ Rice Lake **RL35023S**
- ◆ Rice Lake **RL39123**
- ◆ Coti Global Sensors **CG-23-SS**

RATED CAPACITY	DIMENSIONS									
	A	B	C	D	E	F	G	H	I	J
<b>lb/inches</b>										
100-5K lb	5.12	1.25	1.25	1.00	3.00	0.50	0.62	0.53	0.53	1/2-20UNF
5K LE-10K lb	6.75	1.50	1.50	1.50	3.75	0.75	0.75	0.78	0.78	3/4-16UNF
15K-20K lb	8.88	2.00	2.00	2.00	4.88	1.00	1.00	1.03	1.03	1-14UNF
<b>kg/mm</b>										
45-2,268 kg	130.05	31.75	31.75	25.40	76.20	12.70	15.75	13.46	13.46	1/2-20UNF
2,268 LE-4,536 kg	171.45	38.10	38.10	38.10	95.25	19.05	19.05	19.81	19.81	3/4-16UNF
6,804-9,072 kg	225.55	50.80	50.80	50.80	123.95	25.40	25.40	26.16	26.16	1-14UNF
<b>kg/mm</b>										
50-2,500 kg	130.05	31.75	31.75	25.40	76.20	12.70	15.75	13.46	13.46	M12
3,000-5,000 kg	171.45	38.10	38.10	38.10	95.25	19.05	19.05	19.81	19.81	M20
7,000-10,000 kg	225.55	50.80	50.80	50.80	123.95	25.40	25.40	26.16	26.16	M24X2
<b>lb/inches</b>										
110-5.5K lb	5.12	1.25	1.25	1.00	3.00	0.50	0.62	0.53	0.53	M12
6.6K-11K lb	6.75	1.50	1.50	1.50	3.75	0.75	0.75	0.78	0.78	M20
15.4K-22K lb	8.88	2.00	2.00	2.00	4.88	1.00	1.00	1.03	1.03	M24X2

Note: LE: Large envelope .

**Rated Capacity:**

100/250/500/750/1K  
/1.5K/2K/2.5K/4K/5K  
/5K LE/10K/15K/20K lb  
50/100/200/300/500/1,000  
1,500/2,000/2,500/3,000/5,000  
/7,000/10,000 kg

**Rated Output:**

3.0mV/V

**Non-linearity:**

±0.03% F.S.

**Hysteresis:**

±0.03% F.S.

**Repeatability:**

±0.02% F.S.

**Creep(30 minutes):**

±0.02% F.S.

**Temperature Effect on Span:**

±0.0015% F.S./°C

**Temperature Effect on Zero:**

±0.0027% F.S./°C

**Zero Balance:**

±1.00% F.S.

**Insulation Resistance:**

> 5000 MEGOHMS

**Input Impedance:**

385±20Ω

**Output Impedance:**

350±3Ω

**Safe Overload:**

150% F.S.

**Destructive Load:**

300% F.S.

**Excitation Recommended:**

10-15V AC/DC

**Material/Finish:**

Stainless Steel

**Operation Temperature:**

-10°C - +40°C (14°F - 104°F)

**Cable Length:**

Standard Cable

20ft/6m

**Load Cell Wiring:**

Red.....+Excitation

Black.....-Excitation

Green .....+Signal

White .....-Signal