



ORACLE LIGHTING

BRONCO LED DASH KIT

ORACLE PART # 4237-333

INSTALLATION GUIDE

TOOLS NEEDED:
TRIM PANEL TOOL
T-30 TORX BIT
7MM NUT DRIVER/SOCKET
PHILIPS SCREWDRIVER
CUTTING TOOL



1
REMOVE T-30 TORX SCREWS ON DRIVER AND PASSENGER SIDE DOOR HANDLE (8) TOTAL

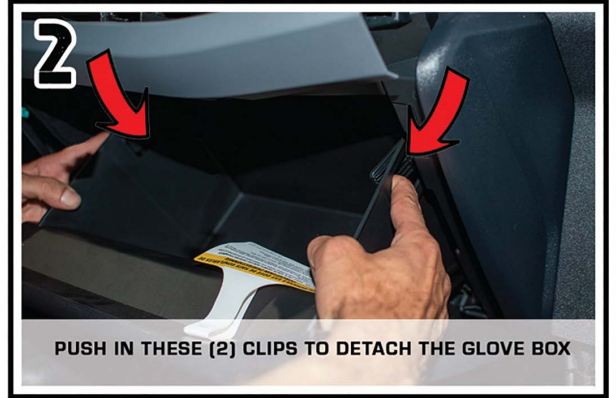

2
PUSH IN THESE (2) CLIPS TO DETACH THE GLOVE BOX

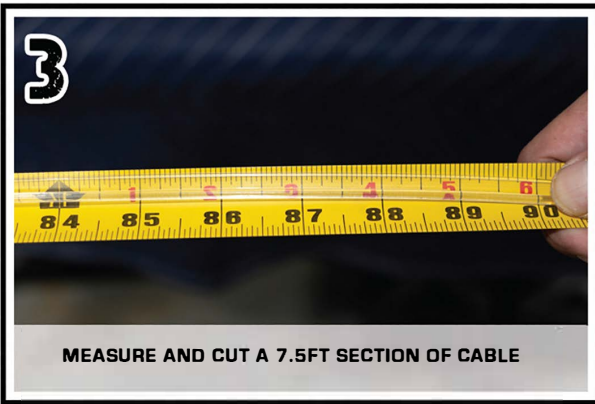

3
MEASURE AND CUT A 7.5FT SECTION OF CABLE

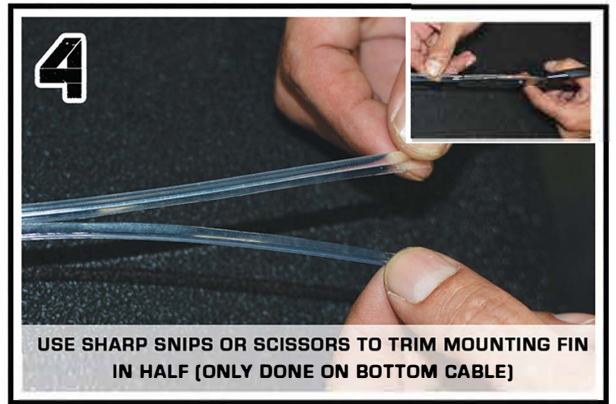

4
USE SHARP SNIPS OR SCISSORS TO TRIM MOUNTING FIN IN HALF (ONLY DONE ON BOTTOM CABLE)



5
ROUTE CABLE THROUGH DASH LEAVING APPROX. 8IN. OF EXCESS CABLE IN GLOVE BOX AREA

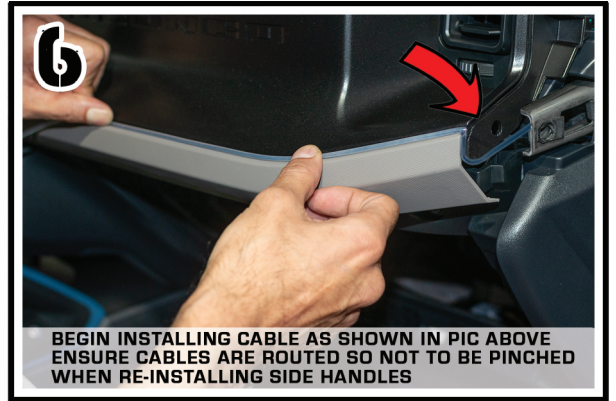

6
BEGIN INSTALLING CABLE AS SHOWN IN PIC ABOVE ENSURE CABLES ARE ROUTED SO NOT TO BE PINCHED WHEN RE-INSTALLING SIDE HANDLES



7
CONTINUE INSTALLING CABLE ALONG DASH



8
BEND CABLE AROUND CORNER WHILE INSTALLING (SLIGHTLY PULLING THIS PANEL OUTWARD HELPS)

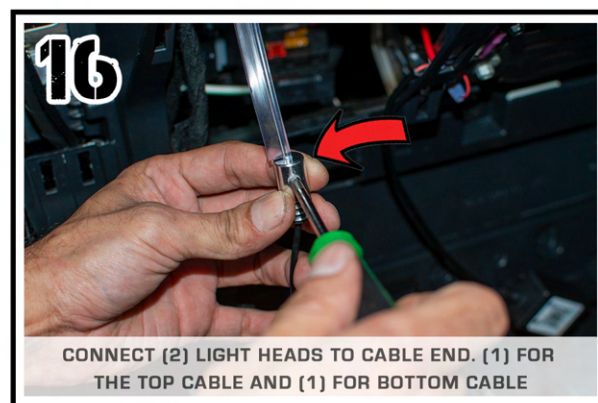
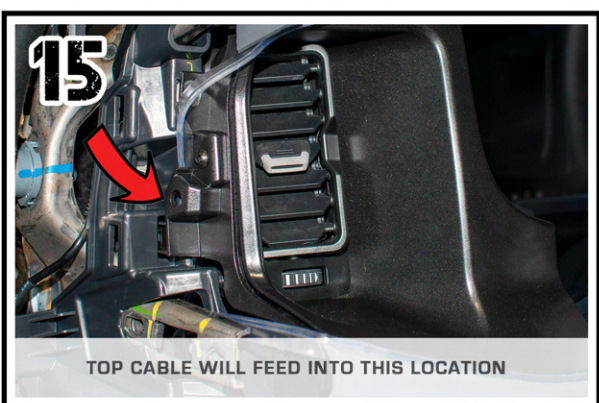
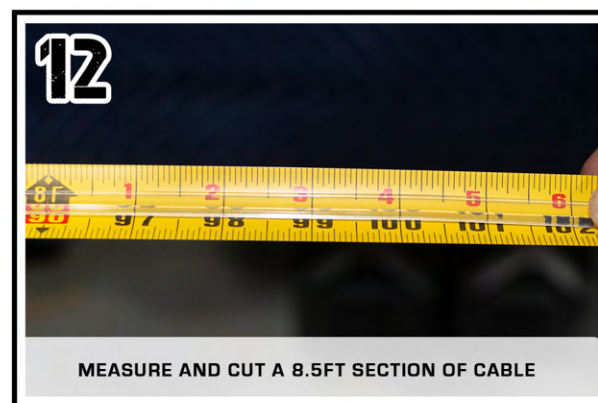
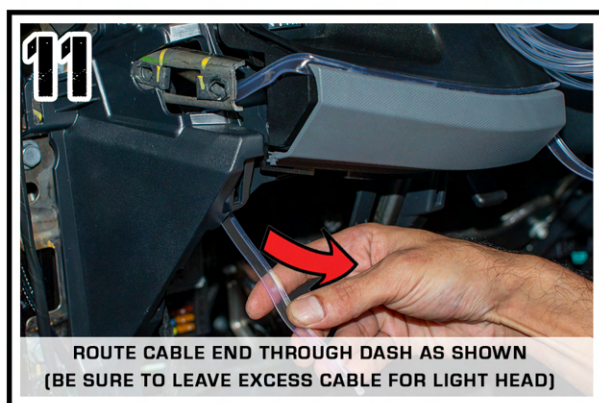

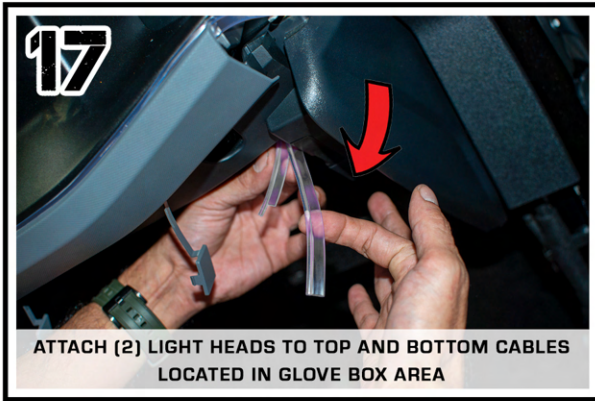

ATTACH (2) LIGHT HEADS TO TOP AND BOTTOM CABLES LOCATED IN GLOVE BOX AREA



FEED CABLES INTO AREA BEHIND CENTER CONSOLE. RE-INSTALL ALL TRIM/PANEL PIECES



FEED CABLES INTO AREA BEHIND CENTER CONSOLE

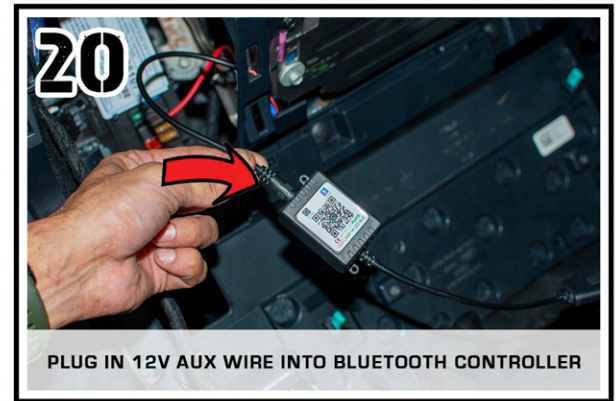

PLUG IN 12V AUX WIRE INTO BLUETOOTH CONTROLLER

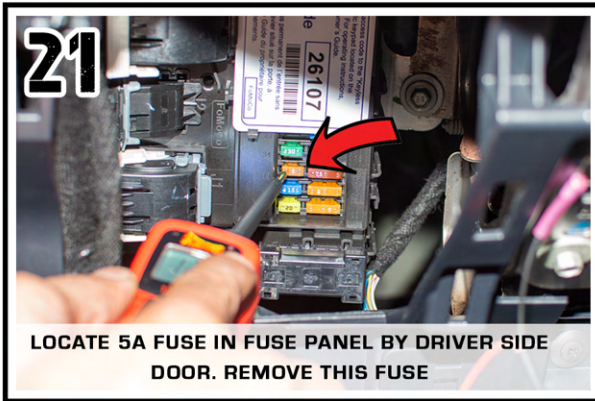

LOCATE 5A FUSE IN FUSE PANEL BY DRIVER SIDE DOOR. REMOVE THIS FUSE

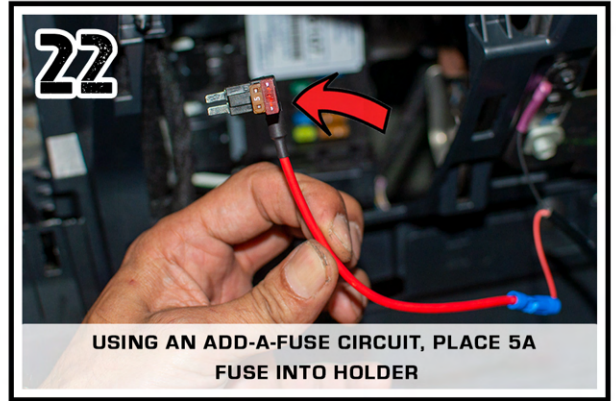

USING AN ADD-A-FUSE CIRCUIT, PLACE 5A FUSE INTO HOLDER

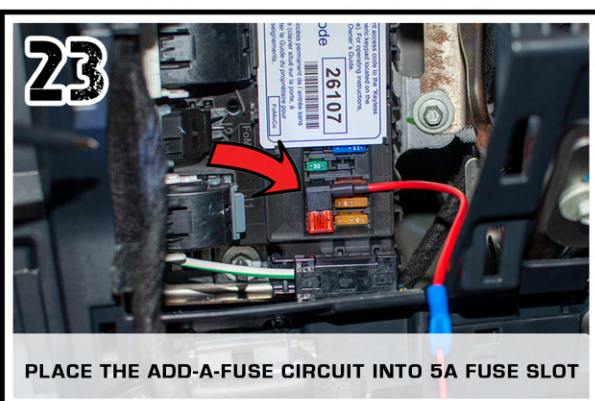

PLACE THE ADD-A-FUSE CIRCUIT INTO 5A FUSE SLOT

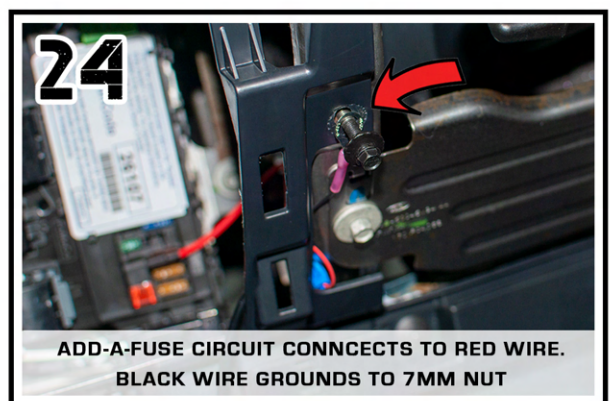

ADD-A-FUSE CIRCUIT CONNECTS TO RED WIRE. BLACK WIRE GROUNDS TO 7MM NUT