

# VECTOR GRILL

## INSTALLATION GUIDE

### TOOLS NEEDED:

- Flat-head Screwdriver
- T-15 Torx Screwdriver
- 15mm Deep Socket

### Step 1:

#### INSTALLATION VIDEOS:

DIY TUTORIAL



[vimeo.com/243023048](https://vimeo.com/243023048)

OPEN BOX



[vimeo.com/253869166](https://vimeo.com/253869166)

#### PAINTING YOUR GRILL?

WATCH THIS FIRST: [vimeo.com/253869166](https://vimeo.com/253869166)

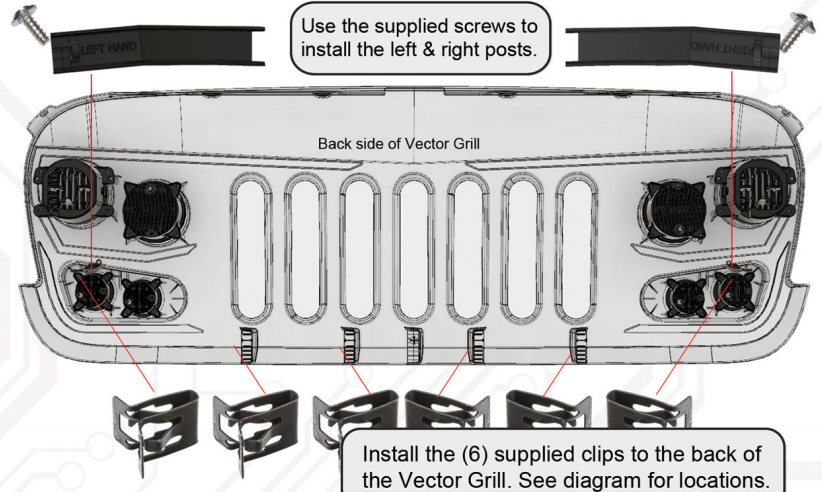

**2** Use a flat head screwdriver or panel tool to remove the 6 clips holding the OEM grill in place.



**3** Twist and unplug the turn signal sockets from the OEM grill. Remove the turn signal bulbs.



**4** Start from the bottom and pull back on the OEM grill to release it from its fasteners.



**5** Once the OEM grill is removed, use a T15 torx to remove the headlight adjuster.

QUESTIONS? [www.OracleLights.com/VectorFAQ](http://www.OracleLights.com/VectorFAQ)



**6** Once the adjuster is removed, the headlight and bracket can now be separated from the vehicle.



**7** Unplug the OEM headlight adapter from the factory wiring harness.

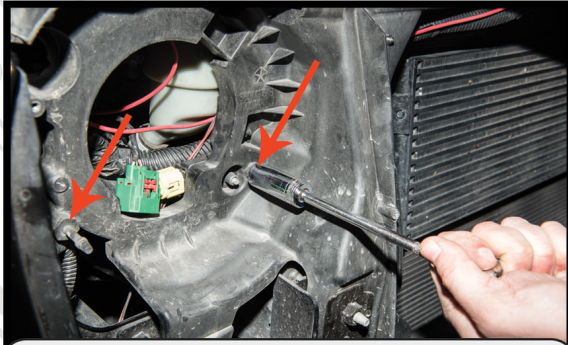

**8** Use a 15mm Socket to remove the two headlight posts. Refer to picture above for the locations.

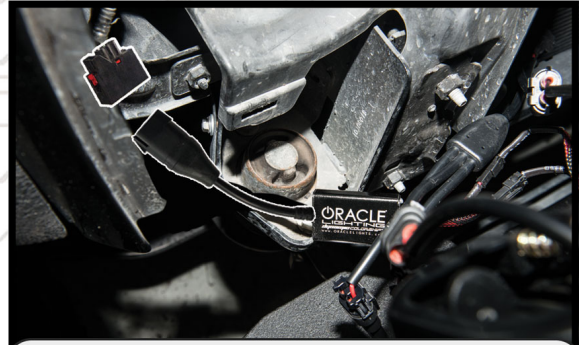

**9** Remove the bulb socket and plug the LED Driver into the OEM turn signal socket connector.

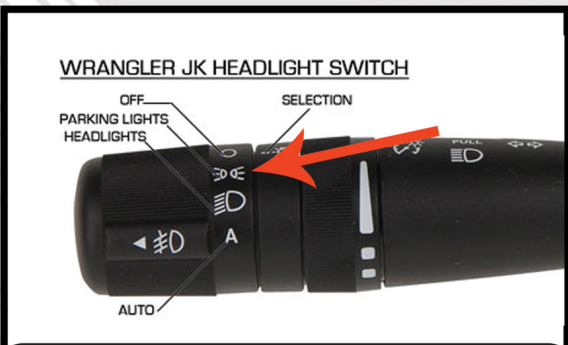

**10** Now switch on the Parking Lights and CHECK to be sure the DRL Turns on if not unplug Step 9 and reverses the plug direction and test again.



**10** Locate the H13 headlight socket, and plug the Vector Grill headlight adapter into the socket. Check your connector: <https://bit.ly/2xaSeNN>



**11** There is a pin in the center of the grill. Make sure that is lined up first, then apply pressure to the bottom of the grill to snap in place.



**12** Once the Vector Grill snaps in place, re-install the 6 clips on the top of the grill. Apply the rubber gasket across the top of the Grill and enjoy!

**QUESTIONS?** [www.OracleLights.com/VectorFAQ](http://www.OracleLights.com/VectorFAQ)