

System Diagram

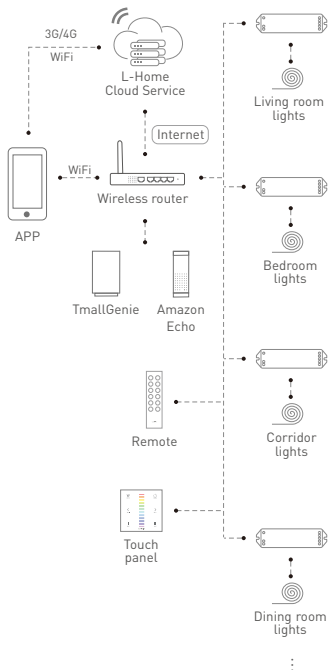

Model: HV9105-WIFI-102-RGBW



Operating Instruction

Product Parameters

WiFi LED controller can be connected with lamps directly, support remote control via intelligent device, smart speaker, mobile phone, remote and touch panel etc.

Model	HV9105-WiFi-102-RGBW
Product Name	WiFi LED Controller
Input Voltage	12 ~ 24Vdc
Out Control	RGBW LED lights
Current Load	3A x 4CH Max. 12A
Output Power	[0~36...72W]x4CH
Network Type	WiFi 2.4GHz , IEEE 802.11b/g/n
RF Frequency	2.4GHz
Working Temp.	-30°C ~ +55°C
Dimension	L125 x W33 x H20(mm)
Packing	L127 x W35 x H24(mm)
Gross Weight	70g



Product Structure

DC power supply socket
(ϕ 5.5mm x ϕ 2.5mm)

12~24Vdc
power input

Setting key
Long press 6s to
default setting

Power indicator

The running light



LED lamp
connection socket

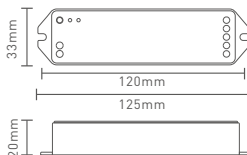

Operating Guidance



2 After installation, the strip flashes within 30s when powered on and then the controller is ready to the configuration status accordingly.

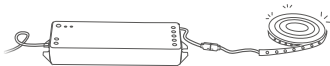

LED strip

Load power below 240W, use this round adapter socket for connection.

- 3 Open the APP, click ⊕ icon in the top right corner.

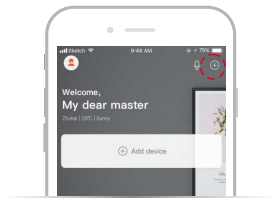

- 4 Enter the interface "Add Device", choose "Color light" or "CT light" and follow the prompts to connect, once successfully that will immediately open intelligent life and realize long-distance control via mobile phone.

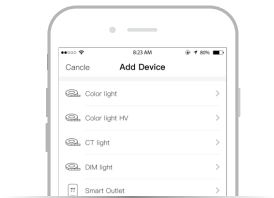

- 5 Match code between panel / remote & WiFi LED controller:

After WiFi LED controller matched with the router, enter the main control interface, click "Add" in the top right corner, choose "add panel" or "add remote", and operate according to the prompt.

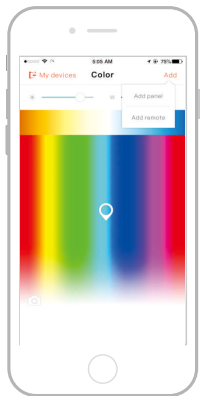

6 Smart speaker & WiFi LED controller work together:

Please click "Smart speaker" in the "setting" interface, choose TmallGenie or Amazon Echo and connect according to the prompt.

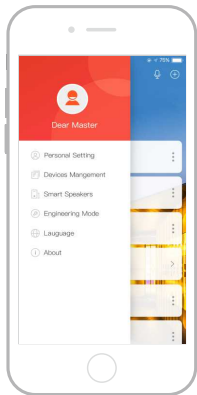

Attention

- 1.The product shall be installed and serviced by the qualified person.
- 2.This product is non-waterproof. Please avoid the sun and rain. When installed outdoors, please ensure it is mounted in a water proof enclosure.
- 3.Good heat dissipation will prolong the life time of the controller. Please ensure good ventilation.
- 4.Please check if the output voltage of the LED power supply used comply with the working voltage of the product.
5. Please make sure the diameter of the wire must be sufficient to load the connected LED lights with firm wire connection.
- 6.Ensure all wire connections and polarities are correct before connecting with power to avoid any damages to the LED lights.
- 7.If errors caused, please do not attempt to fix this product by yourself, please contact the supplier.

No further notice if any changes in the manual. Product function depends on the goods. Please feel free to contact your supplier if any question.