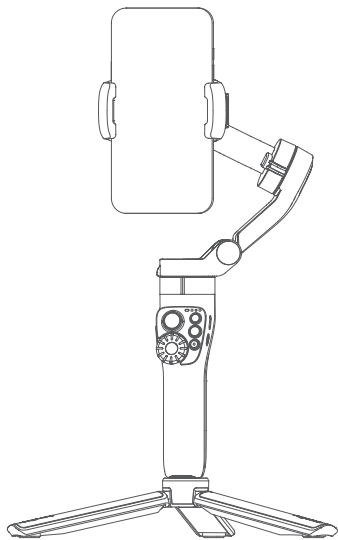




# VIMBLE 3SE

3-Axis Handheld Gimbal for Smartphone  
Manual ENV 1.0



## Contents

1. Overview .....	2
2. Quick Experience .....	3
3. Charging .....	4
4. Landscape & Portrait Mode Switching .....	4
5. Tripod .....	5
6. Connection .....	5
7. Common Operation .....	9
8. Function Operation .....	12
9. Operation mode .....	13
10. Indicator .....	14
11. Protection mechanism .....	15
12. Gimbal Initialization.....	16
13. Specifications .....	16

Vimble 3SE is a three-axis handheld gimbal suitable for smartphone with extendable bar. The gimbal supports landscape and portrait shooting, which can also control phone shooting.

### Suggestion

Feiyu Vimble 3SE includes below information, please read the information before using the gimbal:

1. Quick start guide
2. Online instruction

### Tutorial

· The tutorial videos can be watched at FeiyuTech official website or scan the QR code below.

<https://www.feiyu-tech.com/play/>

· Watch tutorials in video skill page on Feiyu ON.



### Download the Feiyu ON App

Scan the QR code to download the app, or search for "Feiyu ON" in the App Store or Google Play.

\* Requires iOS 9.0 or above, Android 6.0 or above.

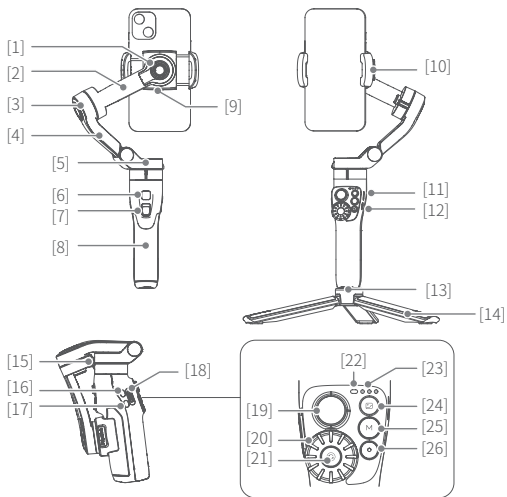


iOS



Android

# 1. Overview

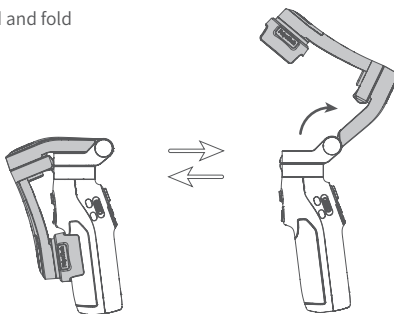


- |   |                           |                                     |
|---|---------------------------|-------------------------------------|
| [1] Roll axis   | [10] Smartphone holder    | [20] Dial                           |
| [2] Cross arm   | [11] USB-C port           | [21] Dial function switching button |
| [3] Tilt axis   | [12] Power button         | [22] Status indicator               |
| [4] Vertical arm                                      | [13] 1/4 inch thread hole | [23] Battery indicator              |
| [5] Pan axis  | [14] Tripod               | [24] Album button                   |
| [6] Upper trigger button<br>(Custom functions in APP) | [15] Limitation           | [25] Mode button                    |
| [7] Lower trigger button                              | [16] A button             | [26] Shutter button                 |
| [8] Handle (Built-in battery)                         | [17] B button             |                                     |
| [9] USB-C port for accessories                        | [18] Zoom button          |                                     |
|   | [19] Joystick             |                                     |

\* This product dose NOT include smartphone.

## 2. Quick Experience

Step1: Unfold and fold



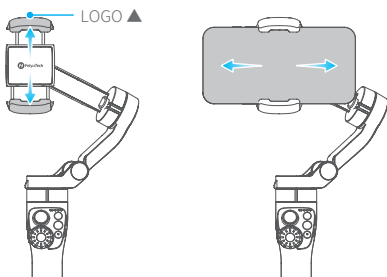
Step2: Smartphone Installation



Please power off the gimbal before install smartphone.  
It is recommended to remove the smartphone case before installation.

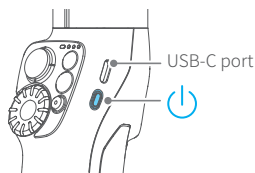
Keep the logo of the smartphone holder upward. Keep the smartphone holder in center.

If the smartphone tilted, please move the smartphone left or right to make it horizontal.



### Step3: Power ON/OFF

Long press the power button and release it when you hear the tone.



### 3. Charging



Please fully charge the battery before power on the gimbal for the first time.

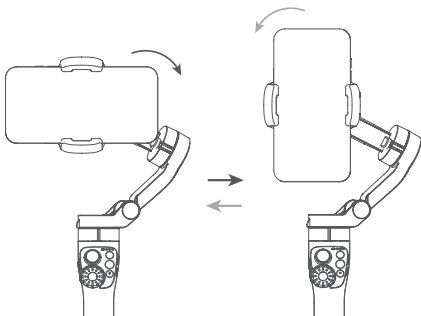
If the battery is too low, red light will flash fast, please charge the gimbal immediately.

Connect the USB-C cable to charge. The indicator light is red while charging, and turn green after charging complete.

### 4. Landscape & Portrait Mode Switching

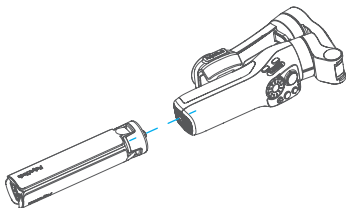
Double click the mode button or manually rotate the smartphone holder to switch between landscape and portrait mode.

Do not make anti-clockwise rotation in landscape mode, Do not make clockwise rotation in portrait mode.



## 5. Tripod

The tripod is attached to the bottom of the gimbal in a rotating manner. According to the needs of shooting, choose whether to install it.



## 6. Connection

### 6.1 Bluetooth Connection

Turn on the gimbal.

Method 1: Download and install Feiyu ON App, run the App, follow the prompts to turn on and connect with the Bluetooth.

Method 2: Turn on the smartphone Bluetooth, connect the gimbal Bluetooth in the setting of phone, e.g. FY\_Vimble3\_xx.

(If the Bluetooth can't be found, please turn off Feiyu ON App in the background.)

### 6.2 App Connection

#### 6.2.1 Download the Feiyu ON App



Feiyu ON

Photo / Video	Free panorama	Ultra -wide angle
180° panora	360° panorama	Overlapping image
Light rail mode	Quick panorama	Static timelapse
Track timelapse	Dolly Zoom	Light rail Video
Video editing	Firmware Upgrade	.....

Scan the QR code to download the app, or search for "Feiyu ON" in the App Store or Google Play.

\* Requires iOS 9.0 or above, Android 6.0 or above.



iOS



Android

## 6.2.2 Operation of App

Steps:

(1) Enable Bluetooth on the smartphone ( Smartphone-Setting-Bluetooth). (Please refer to chapter 7.1)

(2) Log in Feiyu ON App (Register for the first time).

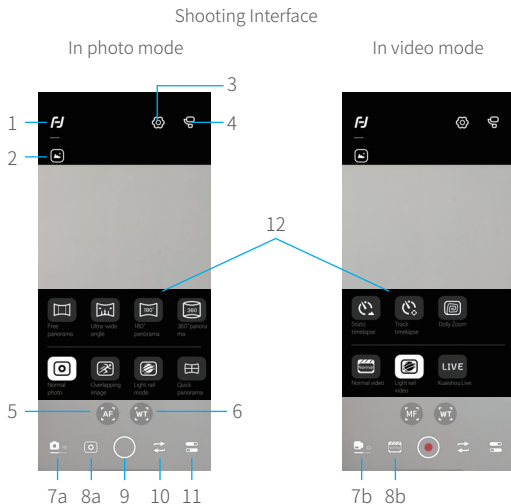
(3) Install smartphone on gimbal, then turn on gimbal.

(4) Search gimbal on App, and tap "FY\_Vimble3\_xx" to connect, it will show "connection succeed" after a while.

(5) You can control the gimbal via App, including remote control the gimbal to move, switch follow modes and set parameters, etc.

If the connection timeout or fail, please check the Bluetooth connection. Or try to exit and log in the App again.

### a. Shooting Interface / Control Interface

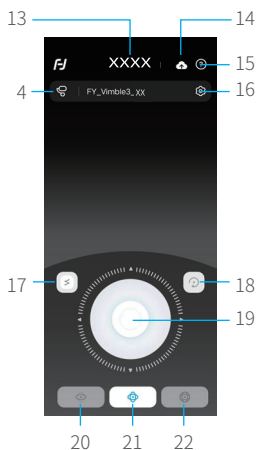




1. Homepage
2. Album
3. Setting - Advanced settings
4. Gimbal information
5. Follow focus
6. Zoom
- 7a. Photo mode, tap to switch to video mode
- 7b. Video mode, tap to switch to photo mode

- 8a. Sub-mode of photo mode, tap to expand submenu
- 8b. Sub-mode of photo mode, tap to expand submenu
9. Shutter
10. Switch between front and rear camera
11. Camera setting
12. Submenu

### Control Interface



4. Gimbal information
13. Remote Control
14. Upgrade
15. Tutorial
16. Settings
17. Set waypoints for timelapse
18. Reset
19. Virtual Joystick
20. Pan mode
21. Follow Mode
22. All follow Mode

## b. Firmware Upgrade

Upgrade type introductions:

Keyboard firmware update	Fix/update or newly add button/touch screen/ interaction functions.
Bluetooth firmware update	Fix/update or newly add Bluetooth functions.
Gimbal firmware update	Fix/update or newly add gimbal control/ function/ parameter and etc.

### How to update:

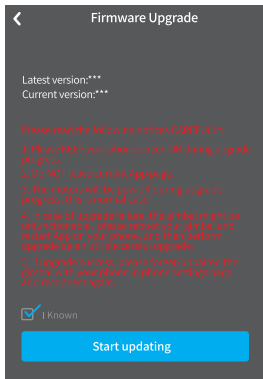
- Before starting an update, make sure that the battery level at least medium level.
- Connect Vimble 3SE with Feiyu ON App, you will be prompted if a new firmware is available. Please follow the steps below to update it.

(1) Tap upgrade ICON  on App.

(2) Select upgrade type.

(3) Follow the prompts to upgrade the firmware.

- Do not exit Feiyu ON or run it in the background while updating the firmware. Pay attention to on-screen prompts.



### Noted:

Gimbal has an update protection function. When the update fails, restart the gimbal, it will return to the previous firmware. Connect the app and update again to resolve the problem. In addition, parts of the new functions require updating two or more firmwares to take effect. It is recommended to update regularly to keep the firmwares of the gimbal as the latest version.

## 7. Common Operation

- ① **Basic** : Vimble 3SE can achieve those functions after balanced gimbal.  
 ② **Bluetooth** : New available function which achieved after connected smartphone via Bluetooth with the functions in condition ① still available.  
 ③ **APP** : New available function which achieved via Feiyu ON APP with the functions in condition ① , ② still available.


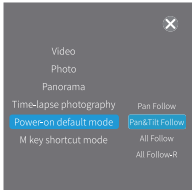
Diagram	Button	Condition	Function
	<p><b>Power button</b></p>	<p><b>Basic</b></p>	<p>Power off:</p> <ul style="list-style-type: none"> <li>· Long press: power on</li> <li>· Single tap: check battery level (while charging)</li> </ul>
		<p><b>Basic</b></p>	<p>Power on:</p> <ul style="list-style-type: none"> <li>· Long press: power off</li> <li>· Double tap: standby mode (single tap at standby mode to wake up the gimbal)</li> </ul>
		<p><b>APP</b></p>	<p>Power on:</p> <p>Single tap: enter/exit shortcut menu in APP</p> <p>Can choose video, photo, panorama, time-lapse modes, can set poweron default mode, M key shortcut mode ( power-on default mode and M key shortcut mode cannot be set as the same mode ), the factory setting of power-on default mode is follow mode, M key shortcut mode is pan mode, single tap function button to switch between these two modes.</p>
			



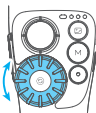


Diagram	Button	Condition	Function
	Joystick	Basic	Control the movement of the tilt and pan axes
		APP	<ul style="list-style-type: none"> <li>· Select setting option</li> <li>· After enter album: move to left to choose previous photo/video; move to right to choose next photo/video; move upward to play/pause; move downward to play/pause</li> </ul>
	Dial function switching button	Basic	Switch the control object of dial: <ul style="list-style-type: none"> <li>· Single tap: Switch to control focus when controlling zoom; In other cases, switch to control zoom</li> <li>· Long press: switch to control roll axis/zoom</li> </ul>
	Dial	Basic	After long press dial function switching button to switch the control object of dial to roll axis. <ul style="list-style-type: none"> <li>· Rotate: control roll axis to rotate</li> </ul>
		APP	<ul style="list-style-type: none"> <li>· Rotate: control zoom(default)/focus/ Roll axis</li> </ul>
	Album button	APP	Single tap: enter/exit album
	Mode button	Basic	<ul style="list-style-type: none"> <li>· Single tap: switch among follow mode, pan follow, all follow mode cyclically (default to be follow mode)</li> <li>· Double tap: landscape and portrait mode switching</li> </ul>


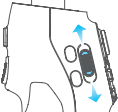



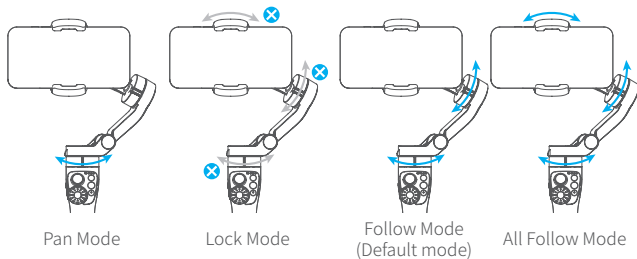
Diagram	Button	Condition	Function
	Shutter button	Bluetooth	When original camera APP is in photo/video mode: · Single tap: take photo, start/stop recording
		APP	· Press halfway: focus · Single tap: take photo, start/stop recording · Long press: switch between photo/video
	Zoom button	Bluetooth	Slide up and down to adjust focus. · Slide up (T direction): zoom in · Slide down (W direction): zoom out
		A/B button	After long press dial function switching button to switch the control object of dial to roll axis. · Long press: mark the current axes position as A/B(while dial is controlling roll axis) · Single tap: return to the position A/B that you have marked
	Upper trigger button	Basic	Long press: enter flash mode (release it to exit)
		APP	Can be customized as: switch front/rear camera, etc

Diagram	Button	Condition	Function
	Lower trigger button	Basic	<ul style="list-style-type: none"> <li>Long press: enter lock mode (release it to exit)</li> <li>Double tap: recenter</li> </ul>
		APP	Triple tap: Switch front/rear camera

## 8. Function Operation

Mode	Description
Pan Mode	The roll and tilt direction are fixed, and the smartphone moves according to the left-right movements of the user's hand.
Lock Mode	The orientation of the camera is fixed.
Follow Mode (Default mode)	The roll direction is fixed, and the smartphone moves according to the left-right movements, up-down movements of the user's hand.
All Follow Mode	The camera moves according to the user's hand.
Reset	Return to panning mode, three axes return to default position.
Manual Lock	Slide the tilt axis to one position for shooting.
Landscape and Portrait Shot	Assist landscape or portrait shooting

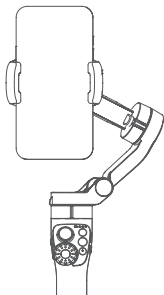


## 9. Operation mode

The figures below depict the operation modes when using Vimble 3SE in portrait mode. The same operation modes apply when used in landscape mode.

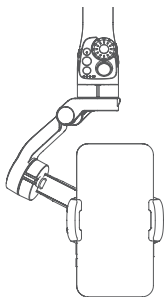
### Standard mode (Default):

Double tap trigger button to recenter smartphone.



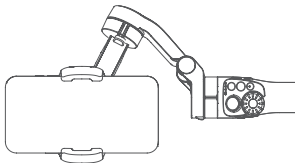
### Underslung mode:

Hold gimbal upside down to enter underslung mode. (In which the smartphone can easily capture images from a lower position. User can also hold the tripod to help shooting)

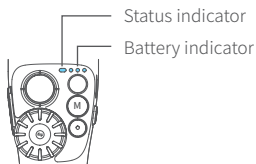


### Side grip mode:

Rotate Vimble 3SE to the right or left by 90° to make smartphone be horizontal to the ground.



## 10. Indicator







### 10.1 Status indicator

Status indicator	Status
Constant Blue light	Bluetooth connected
Blue light flash	Bluetooth disconnected
Blue light keeps flashing	Unpairing Bluetooth
Green light stays on	Charging completed
Green light flash	Initializing
Breathing light (green)	Standby mode
Red light stays on	Charging
Red light flash	Low power, will auto power off



## 10.2 Battery indicator

Battery indicator	Battery
	Fully charged
	Medium level of battery
	Low power
	(Flashing) Please charge the gimbal

## 11. Protection mechanism

State	Status
Battery is too low	Gimbal power off after alarm sound
Temperature is too high	Gimbal enter standby mode after alarm sound, and send message to App
Power on gimbal without load	
Overload	
Software conflict	Gimbal power off after alarm sound, and send message to App
Remove smartphone after powered on gimbal	Gimbal enter standby mode with green breathing light, and after leaving gimbal in standby mode for 10 minutes, it will auto power off
Power on gimbal when lie it down	
Others	Gimbal power off after alarm sound, and send message to App

## 12. Gimbal Initialization

Initialization the gimbal when:

- (1) The camera is not in level.
- (2) Not use for a long period of time.
- (3) The ambient temperature changes abruptly.

Method:

Method 1: Initialize via App (Reset gimbal parameters).

Method 2: Press album button and mode button together for 1 second;

Please refer to the form in [chapter 10.1 in P14](#) to check the indicator status.

Note: if the initialization is unsuccessful for a long time, please restart the gimbal and retry.

## 13. Specifications

Product name: Feiyu Vimble 3SE 3-Axis Handheld Gimbal for Smartphone

Product model: FYVimble3SE

Max. Tilt Range:  $-35^{\circ} \sim +35^{\circ}$

Max. Roll Range:  $-50^{\circ} \sim +50^{\circ}$

Max. Pan Range:  $-80^{\circ} \sim +174^{\circ}$

Size: About  $115 \times 176 \times 65$ mm (folded)

Net gimbal Weight: About 352g (not including tripod)

Battery: 1300mAh

Charging time: About 2.5h

Theoretical Battery Life: About 10h (for different smartphone you installed, it's slightly different)

Payload Capability:  $\leq 260$ g (after balanced)

Adapter smartphones: iPhone and Android phones (the width of the phone  $\leq 88$ mm)

### Packing List

Vimble 3SE  $\times 1$ , Tripod  $\times 1$ , USB-C cable  $\times 1$ , Portable bag  $\times 1$ , Manual  $\times 1$

### **Notice:**

1. Make sure motor spinning is not blocked by external force when the product is power on.
2. The product DO NOT contact water or other liquid if the product is not mark waterproof or splash-proof. Waterproof and splash-proof product DO NOT contact sea water or other corrosive liquid.
3. DO NOT disassembly the product except marked detachable. It need send to FeiyuTech after-sales or authorized service center to fix it if you accidently disassembly and cause abnormal work. The relevant costs are borne by user.
4. Prolonged continuous operation may cause the product surface temperature to rise, please operate carefully.
5. DO NOT drop or strike the product. If the product is abnormal, contact FeiyuTech after-sales support.

### **Storage and Maintenance:**

1. Keep the product out of the reach of children and pets.
2. DO NOT leave the product near heat sources such as a furnace or heater. DO NOT leave the product inside of a vehicle on hot days.
3. Please storage the product in dry environment.
4. DO NOT overcharge or overuse the battery, otherwise it will cause damage to the battery core.
5. Never use the product when the temperature is too high or too low.

### **Official Social Media**



Website



Facebook



Youtube



Twitter



Instagram



Guilin Feiyu Technology Incorporated Company  
[www.feiyu-tech.cn](http://www.feiyu-tech.cn) | [support@feiyu-tech.com](mailto:support@feiyu-tech.com) | +86 773-2320865

This document is subject to change without notice.