

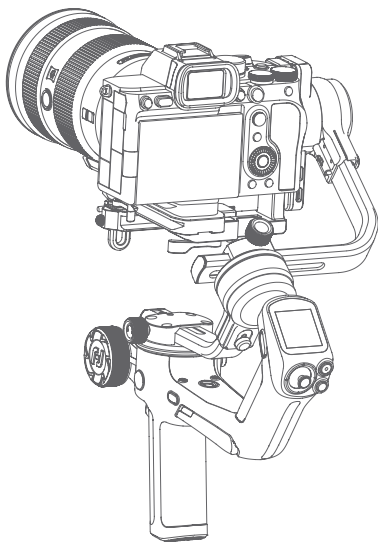

SCORP 2

Instructions V1.0



Tutorial Videos



Catalogue

1. Overview	1
2. Getting started	2
2.1 Charging	2
2.2 Adjust the gimbal to gimbal balancing position	2
2.3 Using support stand	3
3. Mounting the Camera	3
3.1 Attach the quick release plate and camera backing base(Optional)	3
3.2 Install lens holder (Optional)	4
3.3 Mount camera on gimbal	4
4. Gimbal Balancing	5
4.1 Balancing the tilt axis	5
4.2 Balancing the roll axis	6
4.3 Balancing the pan axis	7
4.4 Using the memory slider	8
5. Power ON/ OFF& Wake up	8
5.1 Power ON/ OFF	8
5.2 Lock/Unlock screen	9
5.3 Sleep/Wake up	9
6. Function/Modes introduction	9
6.1 Follow modes introduction	10
6.2 Other function introduction	10
7. App Connecting	11
7.1 Connect with Feiyu SCORP App	11
7.2 Function introduction of App	11
8. Operation	15
8.1 Button operation	15
8.2 Touch screen operation	18
8.3 Function operation	21
8.4 Control ports	27
9. Specifications	28

Tutorial

· The tutorial videos can be watched at FeiyuTech official website or scan the QR code.
<https://www.feiyu-tech.com/play/>



Download the App

Scan the QR code to download the app, or search for "**Feiyu SCORP**" in the App Store or Google Play.

* Requires iOS 9.0 or above, Android 6.0 or above.



iOS



Android

1. Overview

* Not include camera.

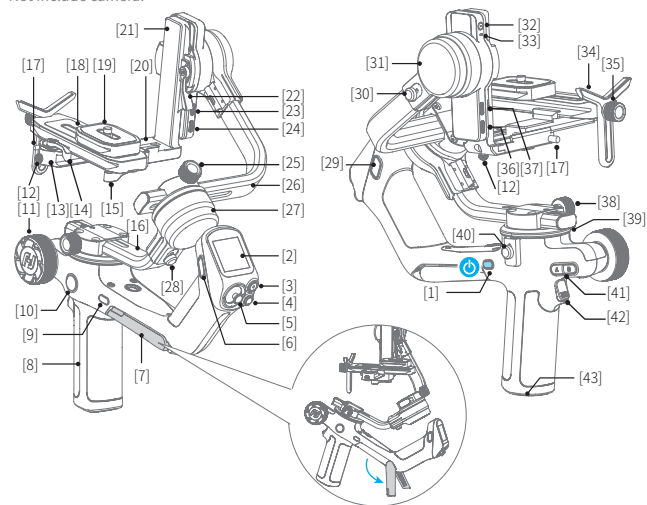

- [1] Power button
- [2] Touch screen
- [3] Shutter button
- [4] Mode button
- [5] Joystick
- [6] F1 button
- [7] Kickstand
- [8] Handle
- [9] FPV button
- [10] Knob function switching button
- [11] Multifunction knob
- [12] Anti-drop lock for slider
- [13] Slider
- [14] Quick release plate lock
- [15] Slider lock

- [16] Vertical arm
- [17] Anti-drop lock
- [18] Quick release plate
- [19] Camera backing base
- [20] Slider
- [21] Slider lock
- [22] Image transmission port
- [23] Extension port 1
- [24] Coss arm lock knob
- [25] Cross arm
- [26] Trigger button
- [27] Roll lock
- [28] Versatile arm
- [29] F2 button
- [30] Tilt lock
- [31] Tilt axis

- [32] Camera for tracking module
- [33] Indicator light for tracking module
- [34] Lens holder
- [35] Lens holder screw
- [36] Extension port 2
- [37] Camera control port/USB-C power output port^①
- [38] Vertical arm lock knob
- [39] Pan axis
- [40] Pan lock
- [41] A/B button
- [42] Trigger button
- [43] 1/4 inch thread hole

^① Supports charging for shooting devices compatible with the USB power supply protocol.

2. Getting started

2.1 Charging

Please fully charge the battery before power on the gimbal for the first time.
Charging with USB-C cable, supports quick charge which charging power $\leq 18W$.

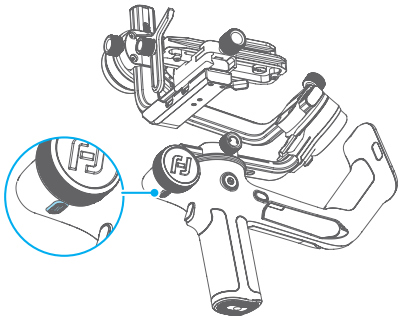

2.2 Adjust the gimbal to gimbal balancing position

The gimbal is folded by default, please unlock all the three axes and adjust the gimbal to **gimbal balancing position**, and then lock the three axes.

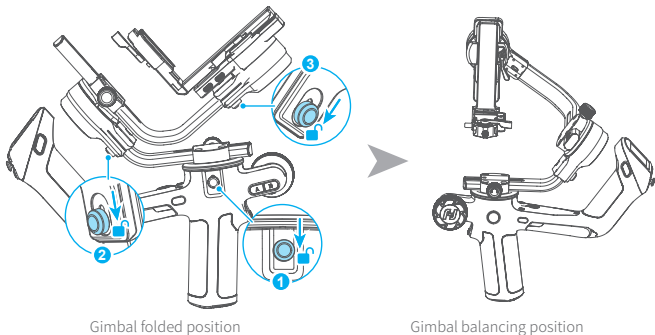

Gimbal folded position

Gimbal balancing position

2.3 Using support stand

Users can unfold the built-in kickstand or install tripod to place the gimbal on a flat surface.

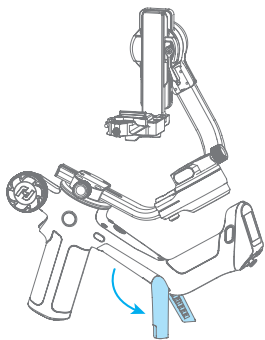

Unfold the built-in kickstand

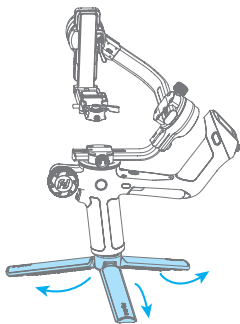

Unfold the tripod

3. Mounting the Camera

Before mounting the camera, make sure the camera is ready for shooting (Install the camera lens, and the lens cover should be removed, the memory card and battery needs to be inserted to the camera, and battery is fully charged) , complete all the steps which mentioned in chapter "2. Getting started" and the gimbal is adjusted to **gimbal balancing position**. Make sure the gimbal is powered off or in sleep mode before mounting the camera.

3.1 Attach the quick release plate and camera backing base(Optional)

Attach the quick release plate to camera by tightening the screw.

User can choose to attach the camera backing base if needed (For example, when using a long or heavy lens). Attach the camera backing base to camera, then attach it to quick release plate by tightening 2 screws.

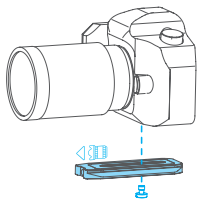

Attach with quick release plate only

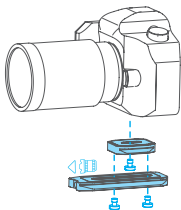

Attach with camera backing base and quick release plate

3.2 Install lens holder (Optional)

Install the lens holder on the quick release plate if needed, the rubber of the lens holder must be directly under the lens. It is recommended to use the lens holder when using a long or heavy lens.

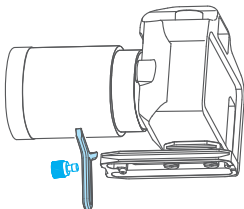

3.3 Mount camera on gimbal

Unlock ①, slide ② into the slot, lock ①, loosen ③, slide ④ into the slot as indicated, adjust the camera forward and backward until roughly balanced, then tighten ③.

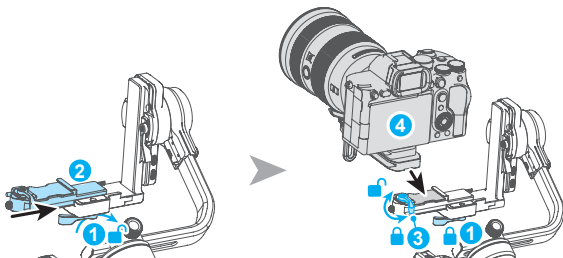

It is recommended to push the camera against the tilt axis. Unlock ① to move the camera left or right according to camera's width to adjust, then lock ①.

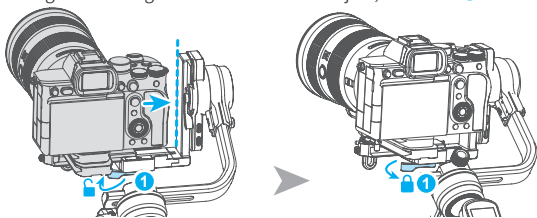

4. Gimbal Balancing

Please balance the gimbal before shooting. Make sure the camera and lens are ready for shooting, and the gimbal is powered off or in sleep mode before balancing. **It is recommended to hold up the camera first, then move the slide arm, cross arm and vertical arm.**



Tutorial Videos

4.1 Balancing the tilt axis

4.1.1 Balancing the vertical tilt

- Unlock the tilt lock ①, and loosen the slide arm lock ②.
- Rotate the tilt axis so that the camera lens is pointing upward. Check the direction

which the lens tilts to.

- c. If the lens tilts to one side, then the camera is that side heavy, move the slide arm ③ to the opposite direction, until the camera is steady pointing upward.
- d. Tighten the slide arm lock ② while holding the camera.

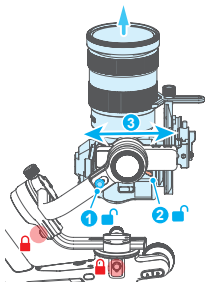

4.1.2 Adjust depth for the tilt axis

- a. Rotate the tilt axis so that the camera lens is pointing forward. Check the direction which the lens tilts to.
 - b. If the lens tilts to one side, then the camera is that side heavy, unlock the quick release plate lock ① and then move the quick release plate to the opposite direction, until the camera is steady pointing forward.
 - c. Lock the quick release plate lock ① while holding the camera.
- The tilt axis is balanced when the camera is steady while tilted up or down by 45° .

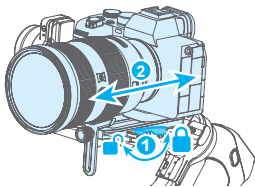

4.2 Balancing the roll axis

- a. Unlock the roll lock ① , check the direction which the camera tilts to.

b. If the camera tilts to one side, then the camera is that side heavy, loosen the cross arm lock knob ② and then move the cross arm to the opposite direction, until the camera can stay still and horizontal to the ground.

c. Tighten the cross arm lock knob ② .

The roll axis is balanced when the camera can stay still and horizontal to the ground.

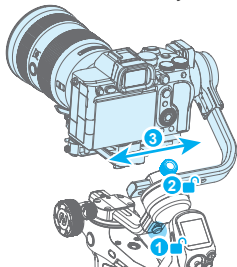

4.3 Balancing the pan axis

a. Unlock the pan lock ① . Hold the tripod, and tilt the gimbal forward until it is horizontal to the ground.

b. If the camera tilts to one side, then the camera is that side heavy, loosen the vertical arm lock knob ② and then move the vertical arm ③ to the opposite direction, until the camera can stay still and horizontal to the ground.

c. Tighten the vertical arm lock knob ② .

The pan axis is balanced when the camera can stay still and horizontal to the ground.

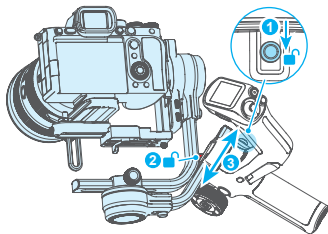

4.4 Using the memory slider

Feiyu SCORP come with the memory slider which can make balancing easier. After balancing the gimbal, move the memory slider to the hole in axis, and make the red dot on the memory slider exposing from the hole, in order to mark the current position.

Next time, If the objects which users mount on are the same, users can just move the axis to the position which can make the red dot exposing from the hole to make the gimbal balanced.

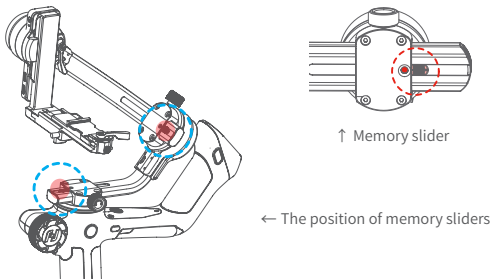

5. Power ON/ OFF& Wake up

5.1 Power ON/ OFF



- (1) Before power on the gimbal, make sure you have balanced gimbal, and unlocked all the three axes.
- (2) If you haven't unlocked all the 3 axes, gimbal will enter sleep mode to protect itself. Please single tap power button to wake up gimbal after unlocked all the 3 axes.

! Please set motor power first after powering on gimbal for the first time or after changing a new camera/lens. (Please refer to chapter 8.3.1)

Long press the power button and release it when you hear the beep sound to power on/ off.

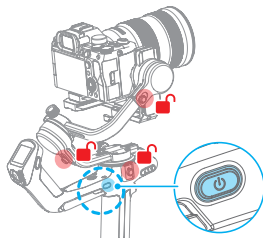

5.2 Lock/Unlock screen

Lock screen: Single tap F2 button to lock screen.

Unlock screen: Single tap F2 button again to unlock the screen.

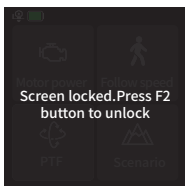

Lock screen

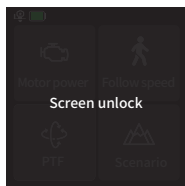

Unlock screen

5.3 Sleep/Wake up

Sleep: Double tap power button to enter sleep mode.

Wake up: Single tap power button or tap the  icon on the screen in sleep mode to wake up gimbal.

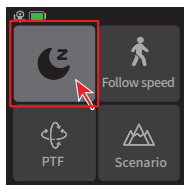

6. Function/Modes introduction

6.1 Follow modes introduction

① **PF** (Default mode)

Pan follow, only the pan axis follows the movement of user's hand.

② **PTF**

Pan and tilt follow, where both the pan and tilt axes follow the movement of user's hand, but roll axis does not.

③ **FPV**

Pan, tilt and roll follow, where all 3 axes follow the movement of user's hand.

④ **Lock**

All 3 axes do not follow the movement of user's hand, gimbal keeps the direction of the camera fixed.

⑤ **FFW**

Flash follow, where all 3 axes follow the movement of user's hand in high follow speed.

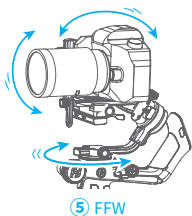
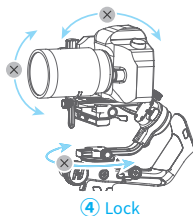
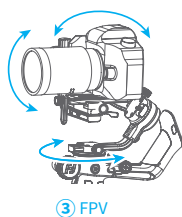
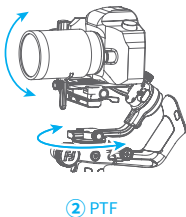
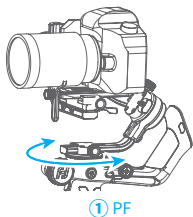

6.2 Other function introduction

Auto rotation (Please refer to chapter 8.3.5)

Camera will auto rotate to shoot according to the rotation speed and direction that set by users. It can be used to achieve the image rotating scene which been used frequently in movie Inception.

Portrait mode (Please refer to chapter 8.3.7)

Enter portrait mode for recording portrait video or live streaming.

Selfie mode (Please refer to chapter 8.3.9)

The camera turns 180° horizontally, selfie shooting is available.

Track video

Record track video according to the waypoints which has been set.

Manual lock

Manually move camera to desired position, and hold for half a second. New tilt /pan positions are automatically saved.

7. App Connecting

7.1 Connect with Feiyu SCORP App

(1) Turn on the gimbal

(2) Turn on the smartphone Bluetooth, run Feiyu SCORP App, tap the top of the home page to connect gimbal.

After the connection succeed, it's easy to control gimbal via App, including control the pan and tilt axis angle with the virtual joystick, switch modes, set motor power/camera parameters/follow speed, set other functions, parameters, and update firmware.

7.2 Function introduction of App

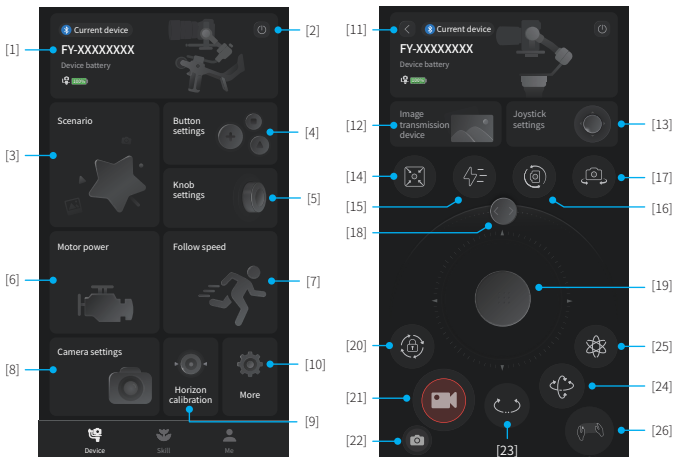

[1] Gimbal control access

Display the product name and device battery of current connecting gimbal, tap to enter gimbal operation interface, which allows user to use virtual joystick to control gimbal, switch follow modes, recenter gimbal, adjust horizontal angle manually. When not connected to gimbal, prompt user to connect with gimbal.

[2] Disconnect device

Tap to disconnect current connecting device.

[3] Scenarios

Provide auto rotation (can be used to achieve the image rotating scene which been used frequently in movie Inception), panorama, timelapse (Motionlapse/Static timelapse/Hyperlapse) , track video and other usage scenarios for user.

[4] Button settings

Set the function when press and hold the trigger button.
Set auto focus time, attitude change time for A/B button.

[5] Knob settings

Set the control object for multifunction knob, can be set as control axes, control electronic focus, control focus motor.

Set damp, speed, smooth and sound for multifunction knob in "More".

[6] Motor power settings

Adjust tilt, roll, pan axes motor power manually or use auto tune function to tune the motor power automatically (Recommended).



Please set motor power first after power on gimbal for the first time or after change a new camera/lens.

[7] Follow speed

Select different preset gimbal follow speed profiles: Slow/Med/Fast, or custom follow speed and dead zone.

[8] Camera settings

Can set camera aperture, shutter speed and ISO parameters after connecting with camera.

[9] Horizon calibration

Calibrate the gimbal with the auto calibration function(Recommended) or adjust it manually (When not in FPV or FFW mode).

[10] More

Set boot silent, disable selfie, manual lock, check firmware information and update firmware, restore the default settings.

[11] Back

Tap to return to home page.

[12] Connect with image transmission device

Tap to connect image transmission device.

[13] Joystick settings

Can set the joystick speed for controlling pan/tilt axis, and joystick as pan axis/tilt

axis inverted.

[14] Recenter

Tap to recenter the gimbal.

[15] Flash follow (FFW)

Tap to enter Flash follow.

[16] Portrait mode

Tap to enter portrait mode.

[17] Selfie mode

Tap to enter selfie mode.

[18] Adjust horizontal angle

Slide the slider to control roll axis to adjust the current horizontal angle.

[19] Virtual joystick

Use virtual joystick to control pan and tilt axis.

[20] Lock mode

Tap to enter lock mode.

[21] Shutter

Tap to take photo in photo mode.

Tap to start/stop recording in video mode.

[22] Switch between photo/video mode

Tap to switch between switch between photo/video mode

[23] Pan follow (PF)

Tap to enter pan follow (PF) mode.

[24] Pan and tilt follow (PTF)

Tap to enter pan and tilt follow (PTF) mode.

[25] FPV

Tap to enter FPV mode.

[26] Motion sensing mode

Tap to enter motion sensing mode which can control the pan and tilt axis to follow the movement of smartphone, can not switch follow modes in motion sensing mode (PF/PTF/FPV/Lock).

8. Operation

8.1 Button operation

8.1.1 Power button

Long press: Power on/off

Single tap: Wake up (In sleep mode)/Battery level display (When powered off)

Double tap: Enter sleep mode

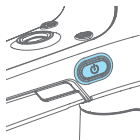

8.1.2 Mode button

Single tap: PF mode(Default) /PTF/FPV (Switch in turn)

Tap five times: Horizon calibration

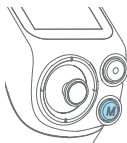

8.1.3 Trigger button

Double tap: Recenter

Triple tap: Enter/Exit selfie mode (Pan axis turn 180°)

Press and hold: PTF (Release to exit)

You can custom the function via App

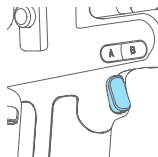

8.1.4 Joystick

Push: Control the movement of the tilt and pan axes.



8.1.5 Shutter button*

Press half way: Focus

Single tap (Fully): Start/stop recording

Long press (Fully): Take photo

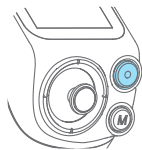

8.1.6 FPV button

Single tap: Enter/Exit FPV mode



8.1.7 F1 button

Double tap: Enter/Exit portrait mode

Triple Tap: AI power on/off

Long Press: Enter/Exit AI Tracking (With AI Power enabled)

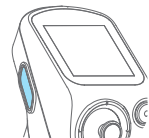

8.1.8 F2 button (Home button)

Single tap:

- (1) Lock/Unlock screen (In home page)
- (2) Return to home page (In other pages)

Double tap: Enter FFW mode

Long Press: Enter motor power auto tuning



8.1.9 A/B button

Long press: Mark the current position as A/B

Single tap: Return to the position A/B that you have marked

Can be used to mark axes/focus position.

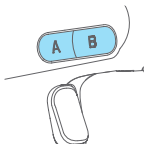

8.1.10 Knob function switching button

Single tap:(1) Switch the control object while controlling the movement of the 3 axes (Tilt/Pan/Roll)

(2) When in electronic focus/zoom control state, single tap to switch between electronic focus and electronic zoom

Long press:Switch the control options of Multifunction knob in turn (The movement of the 3 axes/Electronic focus/Focus motor)



8.1.11 Multifunction knob

Turn:

- (1) Control the movement of the roll, tilt and pan axes.
- (2) Control focus/zoom.
- (3) Control focus motor.
- (4) Adjust the parameter in the touch screen.

Set current control option as option (1) or (2) or (3) through long press the knob function switching button or swipe up in home page.

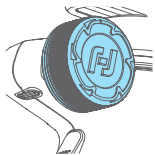

8.1.12 Key Combinations

Long press F1 button + F2 button: Clear Bluetooth

*(1) Some features may require specific camera support. You can visit the official website to check the list of compatible devices: <https://www.feiyu-tech.com/feiyu-scorp-2/>

(2) We recommend using this product in conjunction with the Feiyu SCORP App.

8.2 Touch screen operation

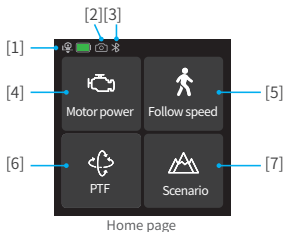

[1] **Current battery level**

Show the current battery level of gimbal.

[2] **Camera connection**

Icon appears after camera connect to the gimbal successfully. The icon won't be shown if camera doesn't connect to gimbal.

[3] **Bluetooth connection**

Icon appears after Bluetooth is connecting. And the icon won't be shown if Bluetooth disconnect.

[4] **Motor power**

Use auto tune to adjust the motor power automatically, or adjust motor power for each axis manually.



[5] Follow speed

Users can select different gimbal follow speed profiles, or customize follow speed.



[6] Follow mode

Select gimbal follow mode.



PF: Pan follow, only the pan axis follows the movement of user's hand.



PTF: Pan and tilt follow, where both the pan and tilt axes follow the movement of user's hand, but roll axis does not.



FPV: Pan, tilt and roll follow, where all 3 axes follow the movement of user's hand.



Lock: All 3 axes do not follow the movement of user's hand, gimbal keeps the direction of the camera fixed.



FFW: Flash follow, where all 3 axes follow the movement of user's hand in high follow speed.



[7] Scenario

Select gimbal usage scenario (timelapse, auto rotation, panorama, portrait mode, selfie mode, track video, etc.)

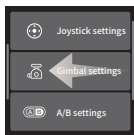

Swipe from right to left

Joystick, gimbal and more settings

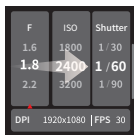

Swipe from left to right

Shooting parameters settings



Swipe up

Multifunction knob settings

- Return to previous menu: Swipe to right

Swipe from right to left

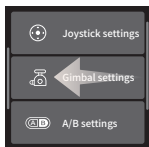

- Joystick settings

Set the joystick speed for controlling pan/tilt axis, provide joystick direction switch.

- Gimbal settings

Including disable selfie, manual lock, and horizon calibration settings.

- A/B settings

Set auto focus time and attitude change time.

- More

Silent switch, select language, restore the default settings, check version information.

Swipe from left to right

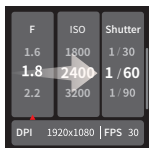

- Camera settings

Set aperture, ISO, shutter speed and show current resolution, fps after connecting with camera.

Swipe up



- Knob settings

Set the control object for multifunction knob, can be set as control axes, control electronic focus, control focus motor.

Set damp, speed, smooth and sound for multifunction knob in "Knob settings".

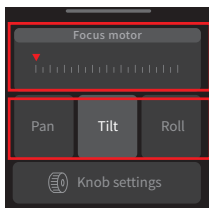

Electronic focus/focus motor control pane

Axes control panel

Set parameters for multifunction knob

8.3 Function operation

8.3.1 Motor power settings

⚠ Please set motor power first after powering on gimbal for the first time or after changing a new camera/lens.

Auto tune: Gimbal auto tune the motor power according to the load.

Adjust motor power manually: Adjust the motor power for each axis manually according to the load.

Tips: If the gimbal is vibrating in high frequency, it means the motor power is too strong. If the gimbal is shaking in low frequency and large amplitude, it means the motor power is too weak.

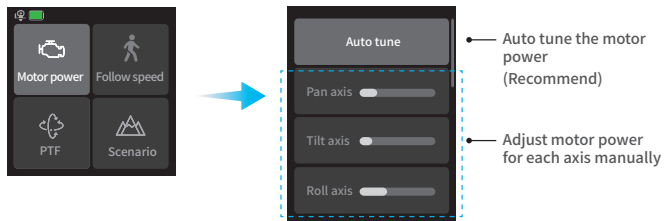

8.3.2 Follow speed settings

Tap "Follow speed" in home page, and select different preset gimbal follow speed profiles: Slow/Med/Fast, or custom follow speed and dead zone.

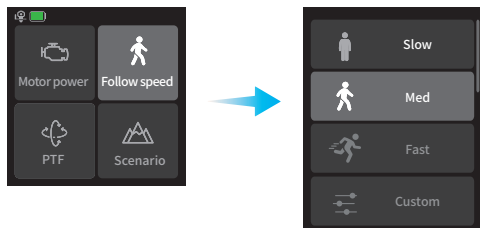

8.3.3 Follow mode settings

Tap the lower left icon in home page to select follow modes.

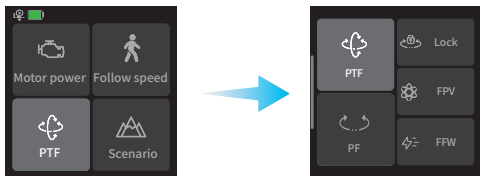

Follow mode

- PF: Pan follow, only the pan axis follows the movement of user's hand.
- PTF: Pan and tilt follow, where both the pan and tilt axes follow the movement of user's hand, but roll axis does not.
- FPV: Pan, tilt and roll follow, where all 3 axes follow the movement of user's hand.
- Lock: All 3 axes do not follow the movement of user's hand, gimbal keeps the direction of the camera fixed.
- FFW: Flash follow, where all 3 axes follow the movement of user's hand in high follow speed.

8.3.4 Timelapse

Select “Scenario” in home page, then select “Timelapse” . Select motionlapse/ static timelapse/hyperlapse according to what you need, and follow the tips to set the parameters to start shooting.

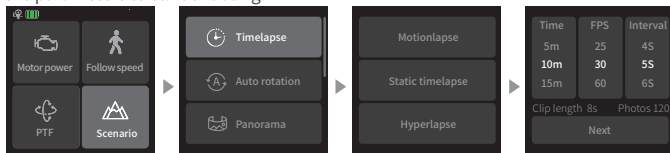

Motionlapse: Shoot timelapse photography according to the waypoints which has been set.

Static timelapse: Shoot timelapse photography with a fixed shooting angle.

Hyperlapse: Shoot timelapse photography while moving.

8.3.5 Auto rotation

Can be used to achieve the image rotating scene which been used frequently in movie Inception.

Select “Scenario” in home page, then select “Auto rotation” . The tilt axis will rotate 90° counterclockwise to make the camera pointing upward. Gimbal start to rotate after setting the rotation speed, direction, and rotational number.

Exit: Swipe from left to right to return to previous menu to exit auto rotation mode.

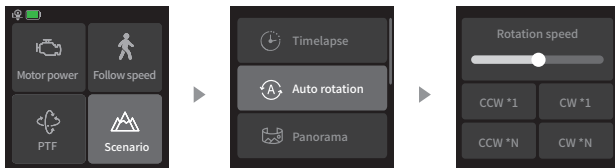

8.3.6 Panorama

Select “Scenario” in home page, then select “Panorama” . Choose a panorama mode to start shooting a series of interconnecting still images. Users can then generate a panorama using image processing software.

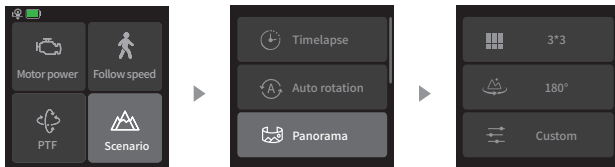

3*3: Take 3 images above in every three layers (9 images in total).

180° : Take 4 lateral images.

Custom: Custom the shooting angle for pan/tilt axis, focal length, overlap and interval parameters to take panorama photos.

8.3.7 Portrait mode

Select “Scenario” in home page, then select “Portrait mode” . The tilt and pan axis will rotate 90° counterclockwise to make the camera pointing upward.

Hold the handle to make the lens horizontal to the ground to shoot in portrait mode.

Exit: Tap the icon at the bottom of the screen to exit.

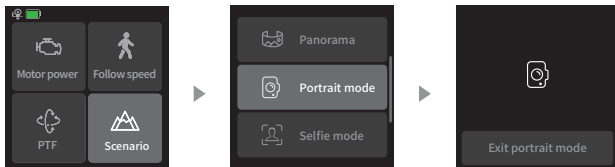

8.3.8 Selfie mode

Select “Scenario” in home page, then select “Selfie mode” . Gimbal turn 180° horizontally so that the camera faces you.

Exit: Tap the icon at the bottom of the screen to exit.

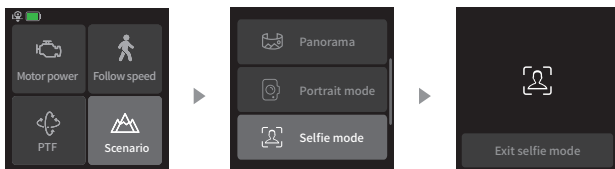

Disable selfie: Swipe from left to right in home page, then select “Gimbal settings” , enable the disable selfie switch, then the selfie mode will not be entered if the trigger button is tapped three times.

8.3.9 Track video

Select “Scenario” in home page, then select “Track video”, capture video with up to 10 waypoints.

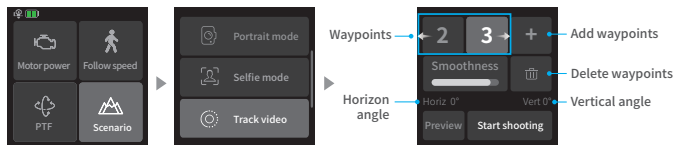

Use joystick or manually move camera to desired position, tap “+” icon to confirm the waypoint, repeat to add another waypoint. Track video is designed to capture video with up to 10 waypoints.

Select a waypoint number to check the position for this waypoint quickly, and tap “” icon to delete it.

After setting up the smoothness, tap “Start shooting” to start shooting.

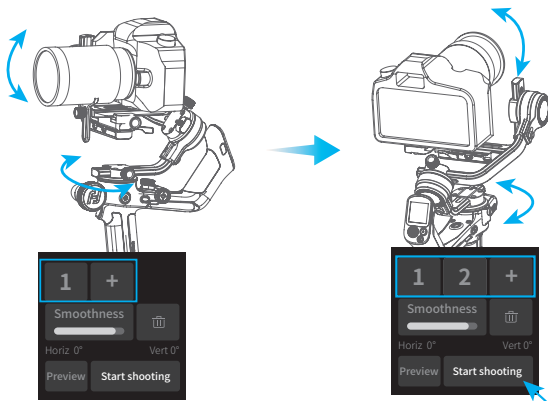

The shooting progress will show up on the screen, if need to stop it midway, tap “Stop shooting” to stop it.

After the shooting complete, tap “Confirm and return” to exit.

8.3.10 AI Tracking

Under AI Power-On State, the following controls are available:

AI Gesture Control



OK gesture (Left or right hand): Start tracking/Stop tracking

Start tracking with the green light stays on. Repeat this gesture, stop tracking, enter standby mode with the red light stays on. Two gestures must be separated by 3 seconds



Thumbs opposite direction: Stop tracking

Stop tracking, enter standby mode with the red light stays on.



Spread palm (Left or right hand): Shutter

When the smartphone is in photo/video mode:
Take photo or start recording after a 3-second countdown with beep sound.
After started the recording, do the gesture again to stop recording



Double L-Shaped gestures: Custom framing

Start framing, green light blinks fast. When the subject moves to the desired position, perform this gesture again to complete framing, and the green light stays on.

Button control

Long press F1 button: Start tracking/Stop tracking

Triple tap F1 button: AI power on/off

8.4 Control ports

There is a camera control port, an image transmission port, and 2 extension ports on the fixed plate, to connect focus motor and other extension devices.

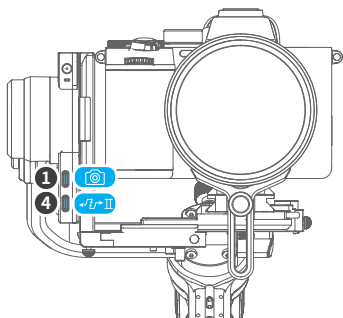

- ① Camera control port
- ② Image transmission port

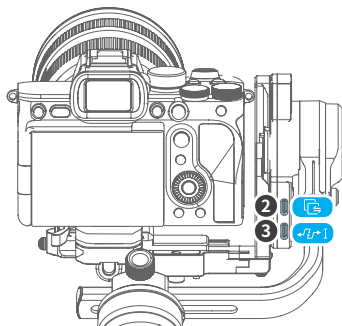

- ③ Extension port 1/Focus motor port 1
- ④ Extension port 2/Focus motor port 2

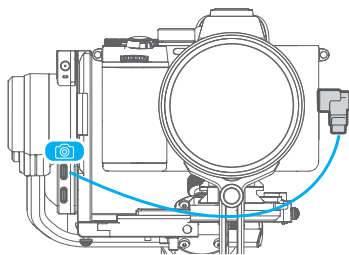

Connect camera with shutter cable

9. Specifications

Product name	Feiyu SCORP 3-Axis Camera Handheld Stabilizer
Product model	Feiyu F2
	Tilt: +200° ~ -120°
Rotatable Range	Roll: +245° ~ -75°
	Pan: 360°

Controllable Range	Tilt: +180° ~ -51°	
	Roll: +36° ~ -36°	
	Pan: 360°	
Size (Main body)	Gimbal folded: 250*152*306mm	Gimbal folded: 257*71*260mm
Weight (Main body)	About 1070g	
Payload Capability	About 2500g (Well-balanced)	
Battery life	13 Hours	
Battery	2500mAh	
Operating Voltage	6.8V-8.4V	
Compatible Cameras	Sony, Canon, Nikon, Panasonic camera etc. (Please download the detailed manual for the specific compatible camera and lens)	

Accessories

[1] USB 2.0 to USB-C Charging Cable x1	[9] Tripod x1
[2] USB-C to Micro Camera Control Cable x1	[10] Fixed plate x1
[3] USB-C to USB-C Camera Control Cable x1	[11] Slider x1
[4] USB-C to TRS2.5 Camera Control Cable x1	[12] Quick release plate x1
[5] USB-C to Multi Camera Control Cable x1	[13] Camera backing base x1
[6] USB-C to 2.5mm Camera Control Cable (DC2.5mm) x1	[14] Lens holder x1
[7] USB-C to TRS3.5 Camera Control Cable x1	[15] Lens holder screw x1
[8] USB-C to Mini Camera Control Cable x1	[16] Camera fixed screw x3

Notice

1. Make sure motor spinning is not blocked by external force when the product is power on.
2. The product DO NOT contact water or other liquid if the product is not mark waterproof or splash-proof. Waterproof and splash-proof product DO NOT contact sea water or other corrosive liquid.
3. DO NOT disassembly the product except marked detachable. It need send to FeiyuTech after-sales or authorized service center to fix it if you accidently disassembly and cause abnormal work. The relevant costs are borne by user.
4. Prolonged continuous operation may cause the product surface temperature to rise, please operate carefully.
5. DO NOT drop or strike the product. If the product is abnormal, contact Feiyu After-sales support.

Storage and Maintenance

1. Keep the product out of the reach of children and pets.
2. DO NOT leave the product near heat sources such as a furnace or heater. DO NOT leave the product

inside of a vehicle on hot days.

3. Please storage the product in dry environment.

4. DO NOT overcharge or overuse the battery, otherwise it will cause damage to the battery core. If does not use the product for a long time, please charge it at least once within one month.

5. Never use the product when the temperature is too high or too low.

FCC regulatory conformance:

This device complies with Part 15 of the FCC Rules. Operation is subject to the following two conditions:

(1) This device may not cause harmful interference.

(2) This device must accept any interference received, including interference that may cause undesired operation.

NOTE

This equipment has been tested and found to comply with the limits for a Class B digital device, pursuant to part 15 of the FCC Rules. These limits are designed to provide reasonable protection against harmful interference in a residential installation.

This equipment generates uses and can radiate radio frequency energy and, if not installed and used in accordance with the instructions, may cause harmful interference to radio communications. However, there is no guarantee that interference will not occur in a particular installation. If this equipment does cause harmful interference to radio or television reception, which can be determined by turning the equipment off and on, the user is encouraged to try to correct the interference by one or more of the following measures:

- Reorient or relocate the receiving antenna.

- Increase the separation between the equipment and receiver.

- Connect the equipment into an outlet on a circuit different from that to which the receiver is connected.

- Consult the dealer or an experienced radio/TV technician for help.

NOTE

The manufacturer is not responsible for any radio or TV interference caused by unauthorized modifications to this equipment. Such modifications could void the user's authority to operate the equipment.

RF Exposure

This equipment complies with FCC radiation exposure limits set forth for an uncontrolled environment.



Website



Facebook



Youtube



Tik Tok



Instagram

Manufactured by: Guilin Feiyu Technology Incorporated Company
Website: www.feiyu-tech.com
E-mail: support@feiyu-tech.com
Tel: +86 773-2320865

