

**Model :** E086115

Designed By: **JOAN LAO** | SPAIN

- Features :**
- 1 soft-close door with Grass brand hardware
  - 4 fixed wood shelves with stainless steel rails: Drift Gray (E58) wood paired with Antique Bronze (QB); Ebo Gray (E60) wood paired with Brushed Nickel (BN)
  - Door finger pull
  - Door opens from left to right
  - Fully finished interiors
  - Solid wood construction (no MDF)
  - Multi-step polyurethane finish resists moisture and scratches
  - Wall hung hardware included

All Ronbow cabinets are made of solid hardwood or hardwood plywood and meet strict CARB II Standards. No particle board or Micro-Density Fiberboard (MDF) are used.

**Available Finish :** Drift Gray (E58)  
Ebo Gray (E60)

Top

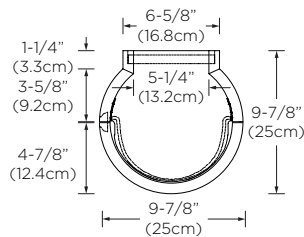

Front

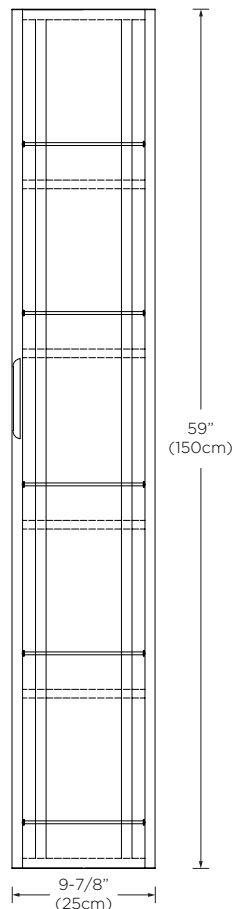

Side

