

Model : E027013-L

Designed By: DANELONMERONI | UNITED KINGDOM

- Features :**
- 2 fixed glass shelves
 - Can stack two, 33" Tall Brit Wall Cabinets on top of each other for additional storage
 - Cabinets have finished top panel
 - 1 soft-close door with Hettich brand hardware
 - Door opens from left to right; can be inverted so door opens from right to left
 - Door finger pull
 - Fully finished interiors
 - Solid wood construction (no MDF)
 - Multi-step polyurethane finish resists moisture and scratches
 - Wall hung hardware included

All Ronbow cabinets are made of solid hardwood or hardwood plywood and meet strict CARB II Standards. No particle board or Micro-Density Fiberboard (MDF) are used.

Available Finish : Bristol Beige (E40)

Top

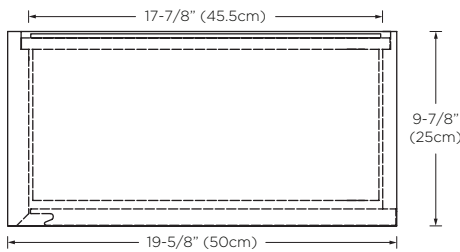

Front

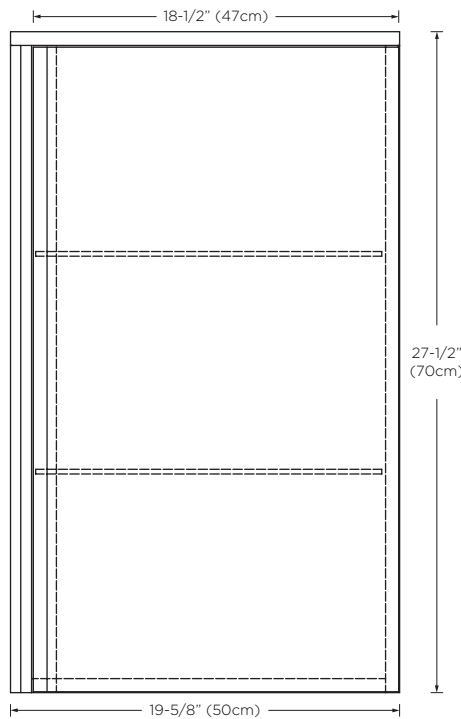

Side

