

## Warranty/Return Policy

If at any time in the first 14 days you wish to return your non-electric ionizer, we will give you a full refund, less a 20% restocking fee of purchase price, as long as your non-electric ionizer is returned in "as new" condition and in its original packaging. The warranty is for 3 years and begins on the original purchase date. The warranty covers all parts and 100% of labor costs due to manufacturing defects only. Customer is responsible for shipping costs both ways unless the unit is defective out of the box. The warranty expressly excludes damage caused by environmental damage including but not limited to: mineral buildup due to hardwater, high levels of iron, or poor source water quality. For complete warranty information see:

[alkaviva.com/alkaviva-return-policy](http://alkaviva.com/alkaviva-return-policy)

Thank you for choosing AlkaViva and it's array of health and wellness products. We hope you are as thrilled with the taste, flavor and health benefits provided as much as we are.

**ALKAVIVA**  
Hydrogen Enhanced Living

**ALKAVIVA**  
Hydrogen Enhanced Living

## Installation Instructions



For complete installation instructions,  
watch the following video:

[vimeo.com/146316970](https://vimeo.com/146316970)

## Congratulations on your new purchase!

You are on the way to a healthier lifestyle with AlkaViva's unique and powerful H<sub>2</sub> Infused Water.

Before installation, we need to cover a few **IMPORTANT TIPS** and tricks to keep your system up and running for a long time.

### Important Instructions

- Never run hot water through your *elita* US-700 as this can damage your filter.
- Wash with warm, soapy water and a soft cloth or sponge. **Using harsh materials may result in scratches to the finish!**
- Protect your *elita* and water lines from freezing temperatures.
- Make sure to use your *elita* only with potable water which is suitable for human consumption.
- For the best pH and ORP results, allow the filter to soak inside of the housing overnight to activate the media inside. (The water is safe to drink immediately after flushing and will be clean and contaminant free, but will need to soak for optimal results.)
- Do not close, bend, pinch, press or otherwise obstruct output port or hose.
- If you plan on not using your *elita* for an extended period (more than 3 weeks), remove the filter, let it drain, and then store it in a plastic bag in your refrigerator.

For any issues: contact Technical Support by filling out the online form at [alkaviva.com/repairs](http://alkaviva.com/repairs)

**To make sure your *elita* US-700 is installed properly and to protect your warranty, we recommend using a licensed plumber.**

## Operating instructions

### Filter Life Indicator

When water flows through the *elita*, the LED display ring will blink using green, orange or red to indicate the remaining filter capacity as follows:

Remaining capacity	LED color	Number of times LED will blink
31%-100%	31% -100% Green	5x
1% - 30%	1% - 30% Orange	5x
0%	0% Red	5x with audible sound



31—100% Capacity  
Green



1 – 30% Capacity  
Orange



0% Capacity + Alarm  
Replace Immediately!  
Red

### Filter life expiration alert

When the filter capacity in your *elita* reaches zero, the LED Display Ring will flash red every three seconds, and the buzzer will generate an audio alert.

### Resetting the filter counter

After replacing the filter cartridge, press the reset button on the *elita* DigiFlow meter under the sink for 6 seconds. There will be a long audio sound, and the LED will flash red for two seconds, then flash red and green several times, before finally flashing green and then turning off. The counter has now been reset to 100% capacity remaining. For complete filter replacement instructions please see our video. [vimeo.com/146421839](https://vimeo.com/146421839)

### Power-off memorization

Your *elita* will memorize the last remaining capacity when the batteries go dead, and restore the last remaining capacity when you install new batteries.



### Step 1 - Faucet Location

Use an existing soap dispenser hole or drill a 1/2" hole in the sink or countertop where you plan on installing your faucet.

### Step 2 - Install the Faucet (Above the Counter)

1. Pass the threaded mounting shaft of the faucet through the hole of the LED Display Ring.
2. Pass the black cable from the LED Display Ring through the 1/2" hole at the sink.
3. Insert the threaded mounting shaft of the faucet through the 1/2" hole at the sink. (Faucet is now resting in the 1/2" hole.)

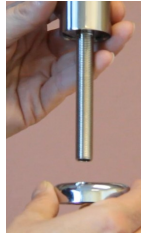

### Step 3 - Secure Faucet to Sink (Under the Counter)



1. From under the counter, install the black Cable Spacer with the concave side up onto the threaded mounting shaft. Make sure the black cable is not pinched by the black Cable Spacer.
2. Install the Locating Washer onto the threaded mounting shaft with the raised side up. Make sure the black cable is not pinched.
3. Thread the Star Washer onto the threaded mounting shaft.
4. Thread the Lock Nut onto the threaded mounting shaft and tighten to secure the faucet to the sink.

### Step 4 - Install the T-Valve or Angle Stop Adaptor to Cold Water Line

*We recommend using a professional plumber for this step.*

1. For complete installation instructions, refer to the following video: [vimeo.com/146316970](https://vimeo.com/146316970)
2. Turn off cold water, install T-valve. Make sure T-Valve is turned to "Off" position. Leave cold water off until installation is complete.



### Step 5 - Install Filter in elita Housing.

1. Using the Filter Wrench loosen the canister and remove the lid.
2. After removing the plastic wrapper, install the elita filter into the canister. (Filter does not have a top or bottom. Make sure the filter is centered in the canister.)
3. Replace the lid.
4. Tighten the canister using the Filter Wrench. (It is very important to make sure the lid is screwed on tightly, otherwise the pressure combined with a loose lid could cause leaking.)

### Step 6 - Install Tubing from elita Housing to T-Valve

1. Using a sharp knife and the 1/4" tubing provided, cut a length of tubing to the proper length to connect the T-Valve to the elita canister. Insert one end of the tubing into the Quick Connect Fitting (QCF) on the T-Valve and the other end into the QCF labeled "IN" on the elita housing lid.



### Step 7 - Mount the elita DigiFlow Meter

1. Before mounting the elita DigiFlow Meter, connect the cable from the elita DigiFlow meter to the cable from the Faucet.
2. Insert the 2 AAA batteries provided. When you install the batteries, you will hear a long audio sound and see a green light on the LED Display Unit. Then you will see a series of LED lights blinking red and green for a few seconds. The power up is complete when the LED Display Unit stops flashing. To test the batteries and the unit, press (without holding) the button on the elita DigiFlow meter. You will see a blinking green light if everything is installed properly.
3. Decide on location to mount the elita DigiFlow meter and mount using Velcro tape.

### Step 8- Install Tubing from elita Housing to elita DigiFlow meter

1. Using the 1/4" tubing provided, cut a length of tubing to the proper length to connect the elita Housing to the elita DigiFlow meter. Insert one end of the tubing into the Quick Connect Fitting on the elita Housing lid labeled "OUT" and the other end into the QCF on either side of the elita DigiFlow meter.

### Step 9 - Connect *elita* DigiFlow meter to the Faucet

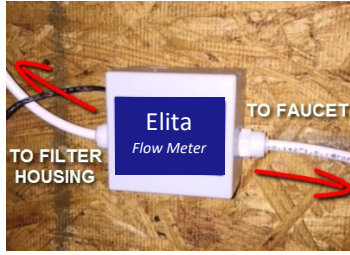

1. Using the 1/4" tubing provided, cut a length of tubing to the proper length to connect from the other side of the *elita* DigiFlow meter to the threaded Mounting Shaft of the Faucet.
2. Insert one end of the 1/4" tubing into the other side of the *elita* DigiFlow meter.
3. To prepare to attach the tubing to the Faucet,

pass the tubing through the smaller sized hole on the Compression Nut .

4. Pass the tubing through the Ferrule.
5. Insert the 3/8" Tube Insert into the top of the 1/4" tubing.
6. Insert the tubing all the way into the hole in the threaded Mounting Shaft of the Faucet. Thread the Compression Nut on to the threaded Mounting Shaft and tighten all the way.

### Step 10 - Testing the *elita* US-700 and flushing the Filters

1. Turn on the source water.
2. Open the blue valve on the T-Valve or Angle Stop Adapter.
3. Turn on the Faucet and allow water to run for 1-2 minutes to flush the filter or until water runs clear. During this time, check all connections for leaks.

#### *elita* US-700 FULLY INSTALLED

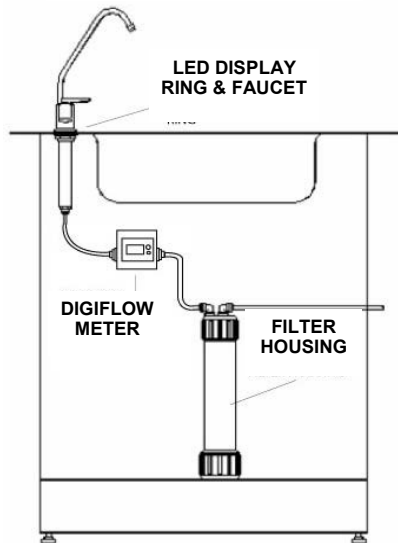

#### Optional, Mounting of the Canister

Mounting the canister can save space, but makes changing the filter more difficult. Using the attached mounting bracket, the canister can be hung on the cabinet wall, or the mounting bracket can be removed and the *elita* US- 700 unit can stand on floor of the cabinet on the canister's lid for more stability.

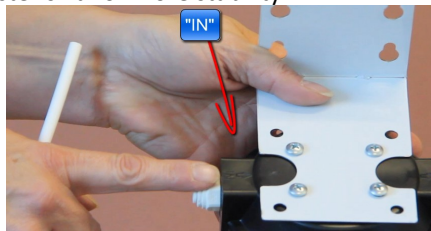

**Enjoy your water!**

## Let's take a tour of your new *elita* US-700 Non-Electric Ionizer!

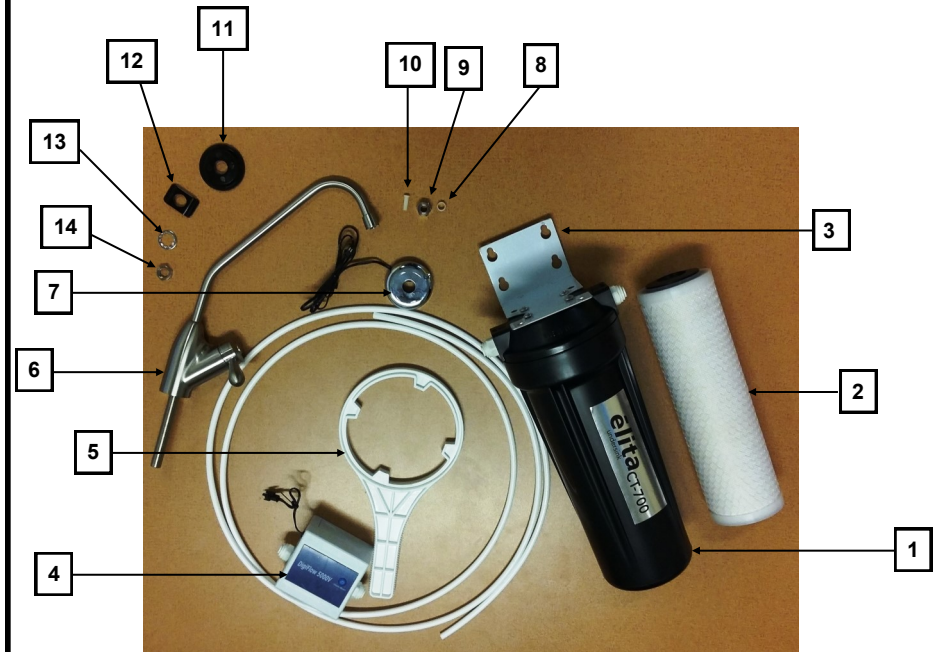

- |                               |                   |
|-------------------------------|-------------------|
| 1 Filter Housing              | 8 Ferrule         |
| 2 UltraWater Filter           | 9 Compression Nut |
| 3 Wall Mount                  | 10 Tube Insert    |
| 4 <i>elita</i> DigiFlow Meter | 11 Locating Ring  |
| 5 Housing Wrench              | 12 Cable Spacer   |
| 6 Faucet                      | 13 Star Washer    |
| 7 LED Display Ring            | 14 Lock Nut       |