

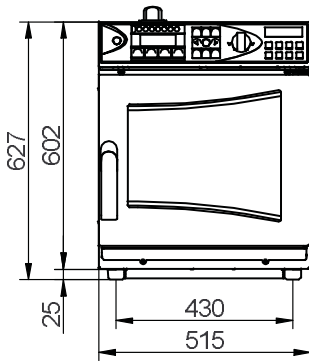

Dimensions and weights			
Width			
Including packaging	[mm]	580	
Excluding packaging	[mm]	515	
Depth			
Including packaging	[mm]	910	
Excluding packaging	[mm]	777	
Height			
Including packaging	[mm]	830	
Excluding packaging	[mm]	627	
Weight			
Including packaging	[kg]	67	
Excluding packaging	[kg]	54	
Safety clearances			
Rear	[mm]	50	
Right	[mm]	50	
Left (larger gap recommended for servicing)	[mm]	50	
Top (for ventilation)	[mm]	500	
<b>Height with easyTOUCH panel</b>			
Appliances with an easyTOUCH panel are 20 mm higher than the specified value.			
<b>Electrical connected load ratings</b>			
3N~ 400V 50/60Hz (3/N/PE)			
Rated power consumption	[kW]	7,1	
Convection power	[kW]	6,8	
Motor power	[kW]	0,25	
Rated current	[A]	14,8	
Fuse	[A]	16	
Recommended conductor cross-section for wires laid uncovered in air up to 5 m in length.	[mm <sup>2</sup> ]	5G2.5	
3~ 230V 50/60Hz (3/PE)			
Rated power consumption	[kW]	7,1	
Convection power	[kW]	6,8	
Motor power	[kW]	0,25	
Rated current	[A]	28,5	
Fuse	[A]	35	
Recommended conductor cross-section for wires laid uncovered in air up to 5 m in length.	[mm <sup>2</sup> ]	4G4	
3~ 200V 50/60Hz (3/PE)			
Rated power consumption	[kW]	7,1	
Convection power	[kW]	6,8	
Motor power	[kW]	0,25	
Rated current	[A]	21,1	
Fuse	[A]	25	
Recommended conductor cross-section for wires laid uncovered in air up to 5 m in length.	[mm <sup>2</sup> ]	4G4	
<b>Heat output</b>			
Heat output			
Latent heat	[kJ/h]	1330	(0.37 kW)
Sensible heat	[kJ/h]	1450	(0.40 kW)

Water connection		
Water supply (cold only)		
Shut-off valve		With EA (verifiable) check valve and dirt filter
Water supply		
Without CONVOClean system		2 x G 3/4", permanent connection recommended
With CONVOClean system		
Flow pressure		
Without CONVOClean system	[kPa]	200 - 600 (2 - 6 bar)
With CONVOClean system	[kPa]	300 - 600 (3 - 6 bar)
Water drain		
drain version		permanent connection (recommended) or funnel waste trap
Type	DN	40
Water quality		
water quality for general use		drinking water quality (install water treatment unit if necessary)
Hardness for injection		
German degrees of hardness (general hardness: GH)	[°dH]	4 - 7
French degrees of hardness	[TH]	7 - 13
English degrees of hardness	[°e]	5 - 9
International	[ppm]	70 - 125
Chemical	[mmol/l]	0,7 - 1,3
Hardness for condenser, cleaning		
German degrees of hardness (general hardness: GH)	[°dH]	4 - 20
French degrees of hardness	[TH]	7 - 27
English degrees of hardness	[°e]	5 - 19
International	[ppm]	70 - 270
Chemical	[mmol/l]	0,7 - 2,7
Properties		
temperature (T)	[°C]	max. 40
conductivity	[µS/cm]	min. 20
pH		6,5 - 8,5
Cl <sup>-</sup>	[mg/l]	max. 100
SO <sub>4</sub> <sup>2-</sup>	[mg/l]	max. 150
Fe	[mg/l]	max. 0.1
Carbonate hardness (KH)	[°dH]	Low GH
<b>Maximum permissible loading weight</b>		
GN (containers, shelf-grills, baking trays)		
Per combi steamer	[kg]	20
Per shelf	[kg]	5
<b>Capacity</b>		
Quantity / GN container depth		
GN 1/1	[Qty]	6 [mm] 40
GN 1/1	[Qty]	4 [mm] 65
Plate up to Ø 26 cm	[Qty]	8
<b>Appliance technical standards</b>		
Degree of protection		IPX4
Approval mark according to national regulations		TÜV/GS, DIN GOST TÜV, SVGW
Noise emission		
Measured	[dBA]	max. 60

Appliance with standard controls



Appliance with easyTOUCH controls

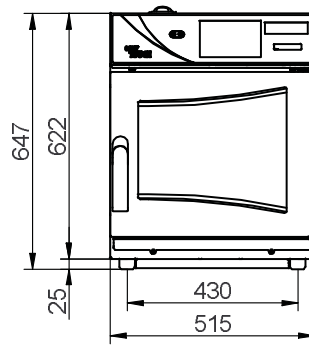

Side view

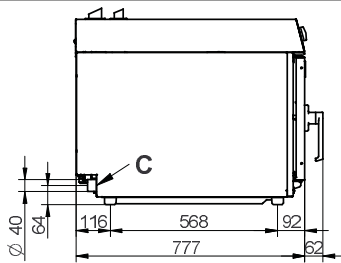

View from above with wall clearances

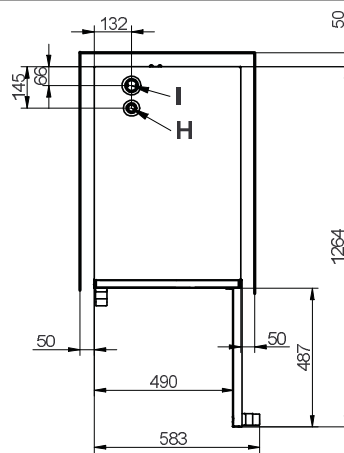

Connections on the underside

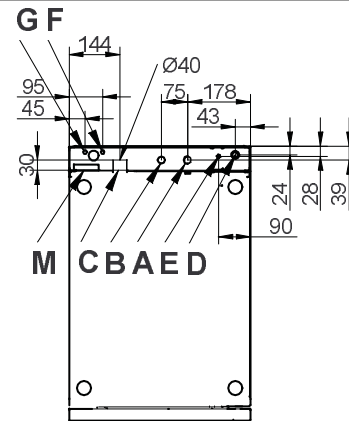

**Meaning of labeled elements**

- A Soft water connection G3/4"
- S Cold water connection G3/4"
- C Drain connection DN 40
- D Electrical supply
- E Equipotential bonding
- F Nozzle detergent connection (Neutralizer)
- G Cleaning agent connection (Cleaner)
- H Air vent
- I Ventilation pipe
- M Overflow 60x20

This document is to be used solely for planning purposes. Please refer to the Installation manual for instructions on installation and setup.

