

## 1/2" AIR CONTROL INSTRUCTIONS

The correct hole size for the 1/2" air control is 1-1/8".

1. Before drilling hole to install the air control, make sure mounting surface is flat. This will help assure the best seal.
2. Drill one 1-1/8" hole for the air control.
3. Remove nut (#4) and gasket (#3) from air control.
4. Place silicone on backside of flange of air control body (#2) and install air control through hole in spa/bathtub.
5. Place gasket (#3) onto body (#2) on the outside of the spa/bathtub.
6. Hand tighten nut (#4) onto body (#2).
7. Remove excess silicone from around flange of air control and surface of spa/bathtub.
8. Glue 1/2" pipe to bottom of air control.

**DO NOT USE ANY TYPE OF PETROLEUM BASED LUBRICANTS ...  
THEY WILL DAMAGE THE PRODUCT**

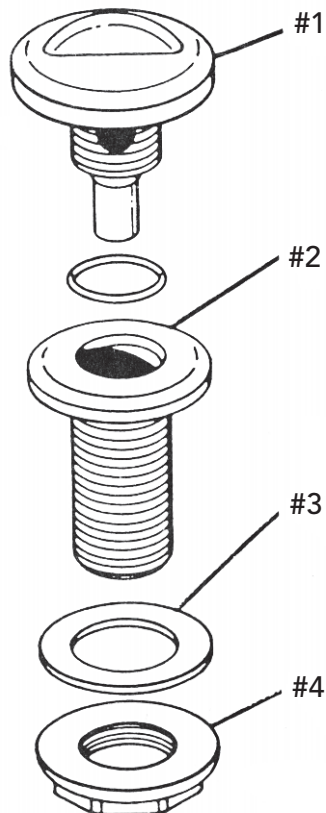

|    | <b>DESCRIPTION</b>     | <b>PART NO.</b> |
|----|------------------------|-----------------|
| #1 | 1/2" AIR STEM ASSEMBLY | 30-2208         |
| #2 | 1/2" AIR BODY ASSEMBLY | 30-2207         |
| #3 | 1/2" GASKET            | 30-2204         |
| #4 | 1/2" NUT               | 30-2205         |