

1" AIR CONTROL INSTRUCTIONS

The correct hole size for the 1" air control is 1-3/4"

1. Before drilling hole to install the air control, make sure mounting surface is flat. This will help assure the best seal.
2. Drill one 1-3/4" hole for the air control.
3. Remove nut (#4) and gasket (#3) from air control.
4. Place silicone on backside of flange of air control body (#2) and install air control through hole in spa/bathtub.
5. Place gasket (#3) onto body (#2) on the outside of spa/bathtub.
6. Hand tighten nut (#4) onto body (#2).
7. Remove excess silicone from around flange of air control and surface of spa/bathtub.
8. Glue 1" pipe to bottom of air control.

DO NOT USE ANY TYPE OF PETROLEUM BASED LUBRICANTS ... THEY WILL DAMAGE THE PRODUCT.

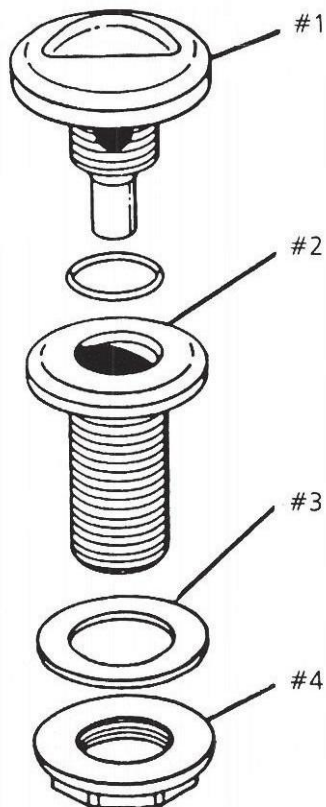

#1	1" AIR STEM ASSEMBLY	30-2108
#2	1" AIR BODY ASSEMBLY	30-2107
#3	1" GASKET	30-3705
#4	1" NUT	30-3706