

F100C Faucet

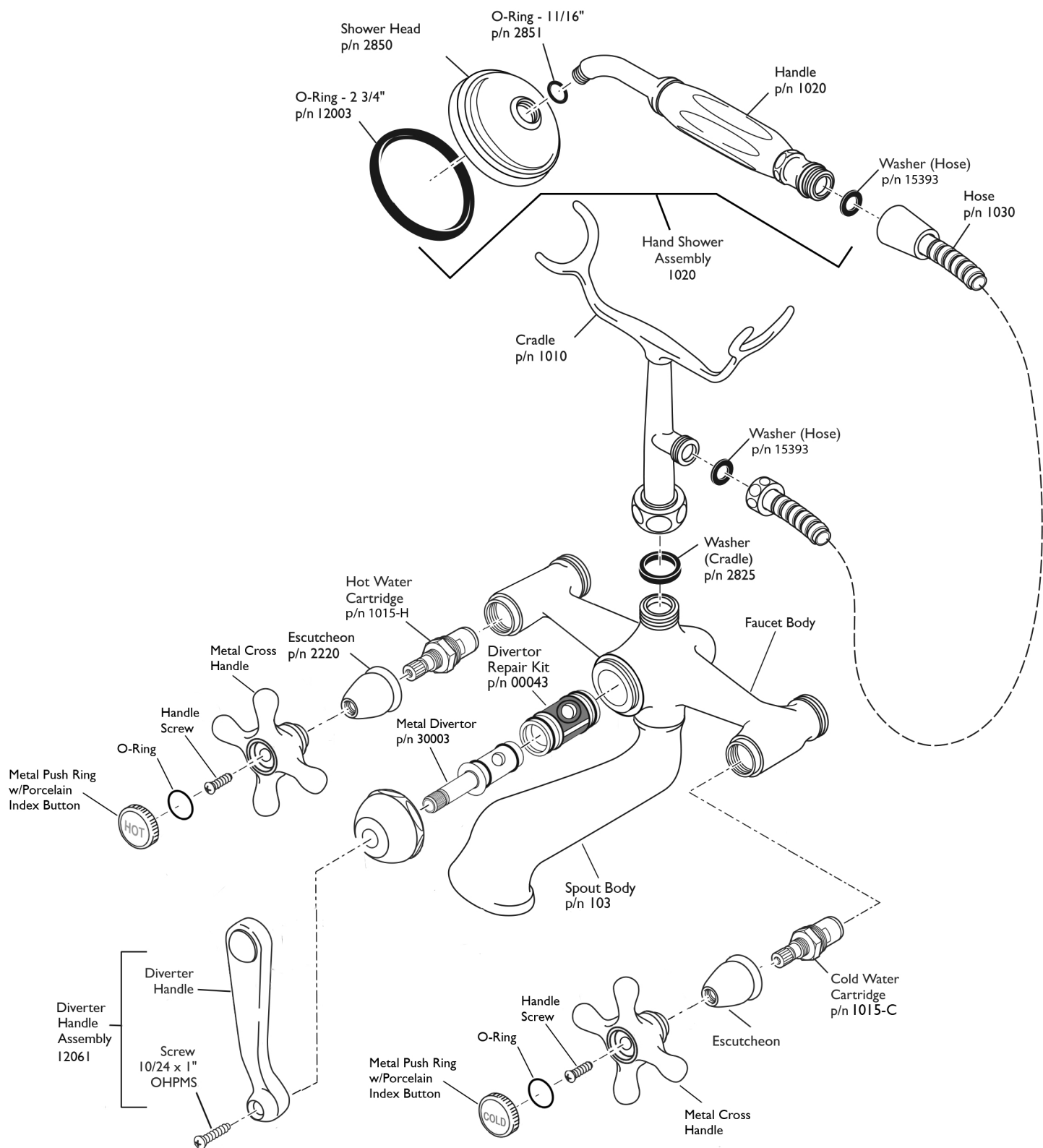

American Bath Factory
DECADES OF DEPENDABILITY

ASSEMBLY DIAGRAM



F100C Faucet



American Bath Factory
DECADES OF DEPENDABILITY

ASSEMBLY DIAGRAM

Connector: Assembly Sequence

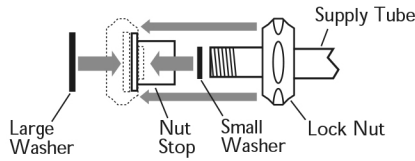

Connector:
Assembled
Cross Section

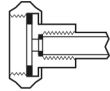

*Optional mounting brackets included for mounting to the vertical overflow pipe if no wall is close enough to use for support. Place overflow support brackets as high as possible for most secure mount and cut support rods to length at unthreaded end. Interlock overflow support mounting brackets as shown and mount opposite supply line and rod. Use set screw to secure support rod to bracket and do not overtighten.

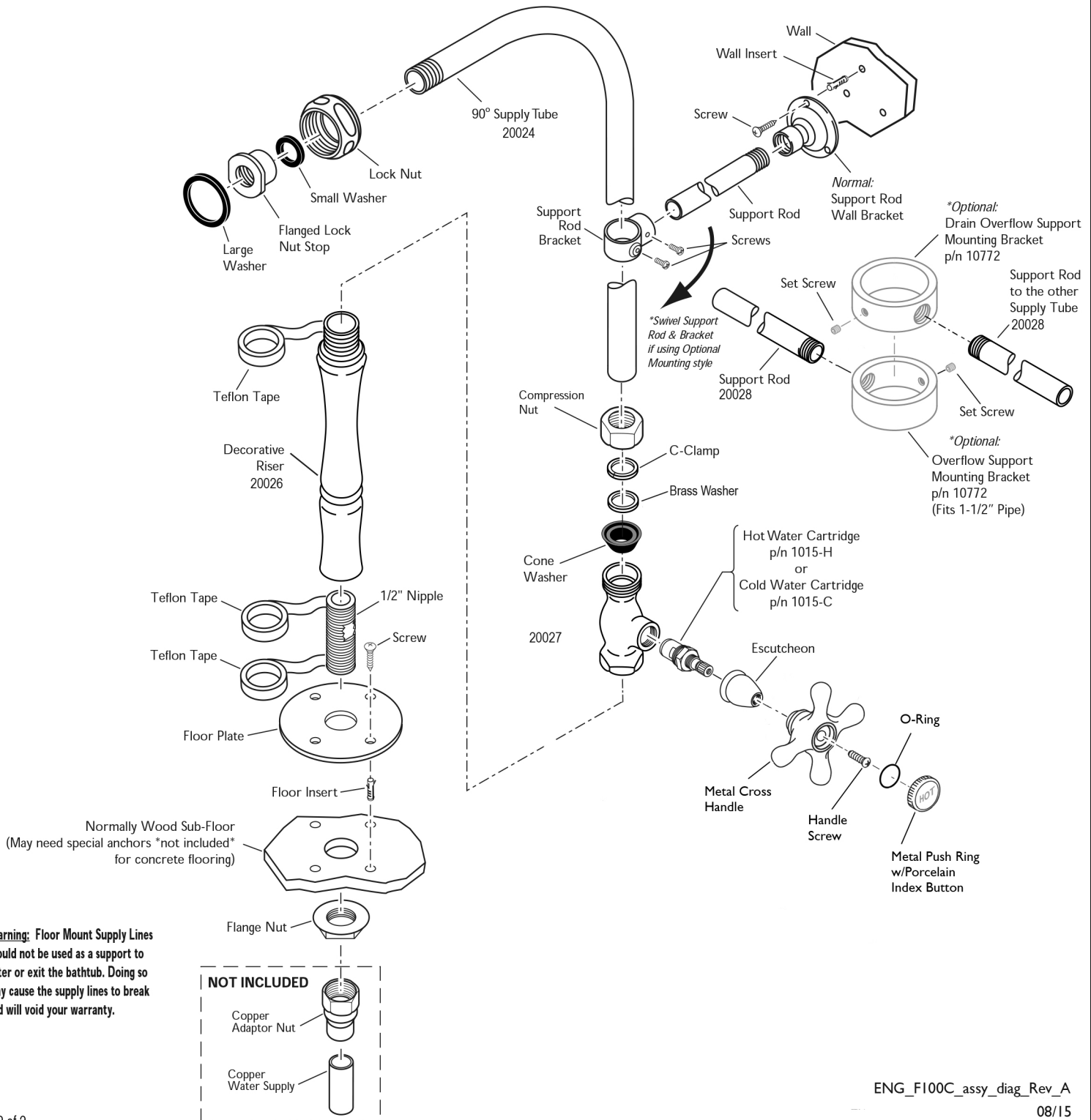

Warning: Floor Mount Supply Lines should not be used as a support to enter or exit the bathtub. Doing so may cause the supply lines to break and will void your warranty.