

**T** • User manual  
TROUBLE SHOOTING

Please follow the below instruction in case of any defect.

DEFAULT	REASON	SOLUTION
The power indicator light does not flash	The power adapter or plug line defective	Repair or replace the power adapter
	Motherboard defective	Repair or replace the motherboard
	Socket lead off	Solder the socket
No filament come out from nozzle	Nozzle blocked	Replace the nozzle set
	Temperature is not high enough	Replace the nozzle set or adjust the temperature
	No working temperature	Replace the nozzle set or check the motherboard
	Gear slips	Move out filament, clean gear, cut off the damaged filament, then reload it
	Fail to load filament	Unload filament and cut the end of filament well
Motherboard defective	Repair or replace the motherboard	
No working temperature	Heating part defective	Replace the nozzle set

**F** • User manual  
FILAMENT CUT

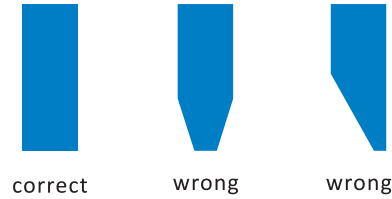

**S** • User manual  
SPECIFICATIONS AND PARAMETERS

Discharging mode: hot melt extrusion molding  
Molding: three-dimensional molding  
Print range: Unlimited  
Feeding speed: adjustable  
Printing material: PLA, ABS  
Electric parameter: DC5V 2A 10W  
Nozzle diameter: 0.7mm  
Filament diameter: 1.75mm  
Filament temperature: ABS220°C, PLA190°C  
Power adapter electric parameter: 100-240V 50/60HZ 0.35A  
Equipment dimension: 175mm\*17mm\*20mm  
Equipment Net weight: 46g

THANKS FOR READING  
HAVE FUN WITH OUR PRODUCT

USER MANUAL  
FOR RP800A



3D Drawing your dream  
PRINTING PEN

**F** • User manual  
FUNCTIONS ILLUSTRATION

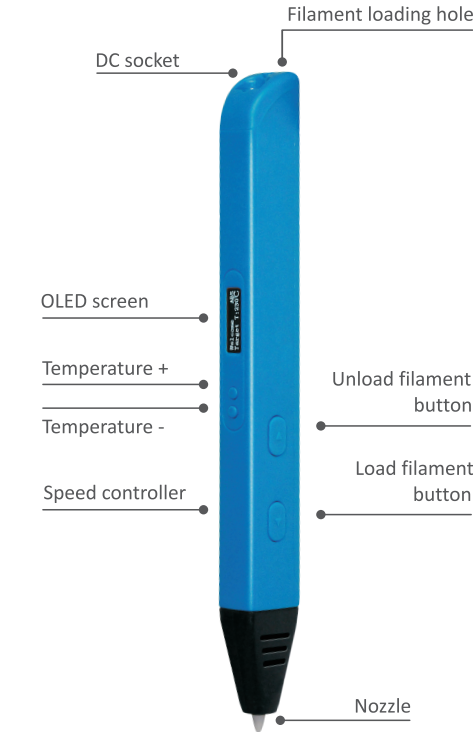

**O** • User manual  
OPERATION INSTRUCTIONS



Plug in the AC adapter or to a power bank which has an output of 2A or above.

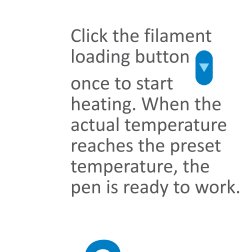

Click the filament loading button once to start heating. When the actual temperature reaches the preset temperature, the pen is ready to work.



Put the filament in through the filament loading hole. Keep pressing or double click the filament loading button to load the filament.

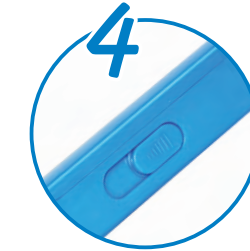

The buttons marked as "+" and "-" are used for temperature adjustment. The scope is 130°C to 230°C. The slide button is used for speed adjustment. Up is faster in speed and down is lower.

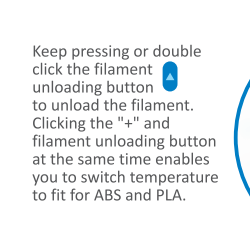

Keep pressing or double click the filament unloading button to unload the filament. Clicking the "+" and filament unloading button at the same time enables you to switch temperature to fit for ABS and PLA.



The pen will enter the standby mode after 2 minutes of no operation. Click the filament loading button to start heating the pen. Please don't touch the tip of the pen.

**W** • User manual  
WARNING

1. This equipment is suitable for children over 8 years old and adult. Children is only allowed to use under adult guardianship.
2. The nozzle is with high temperature, do not touch it by hand.
3. It is strictly prohibited to input any other material into the filament loading hole.
4. Prohibited to use the power adapter provided by other company.
5. Prohibited to use the filament provided by other company, cause different parameter of filament.
6. Keep the pen away from water.
7. Keep the pen in a safe place, where the children can not reach.

**P** • User manual  
PARTS IN PACKAGE

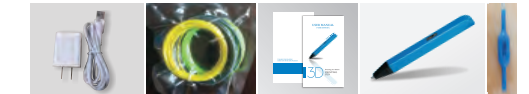

1. AC/DC adapter
2. Filament
3. user manual
4. 3D pen
5. plastic screw driver (for adjust temperature and open back cover)