

## SONAKI Sediment Showerhead

Installation & Operation Manual

Applied to all SONAKI Sediment showerheads

Note: Drawings may not match your product.

### Installation Notes

- This manual will give you the proper information to make installation easy and quick.
- Connect to 1/2" water pipes
- This product was manufactured under strict quality control.
- This product is covered by a 1 year limited warranty.

Thank you for choosing this product. Please read this manual before installing and using the product.

### INSTALLATION (Refer to Fig. 1)

1. Unpack and prepare contents
  - SONAKI Sediment shower head and Sediment cartridge (pre-assembled).
2. Remove your existing shower head from the hose.
3. Install the showerhead to the hose. (Fig. 1)
4. If leaks appear, tighten or reinstall.

**Now you are ready to enjoy the benefits of showering in healthy & clean water!**

### FILTER REPLACEMENT (Refer to Fig. 2)

1. Unscrew the shower filter case.
2. Remove the used filter from the shower filter case and Insert a new Sediment filter into the filter case.
3. Reassemble shower filter case with a new Sediment filter to the shower head.

Fig. 1

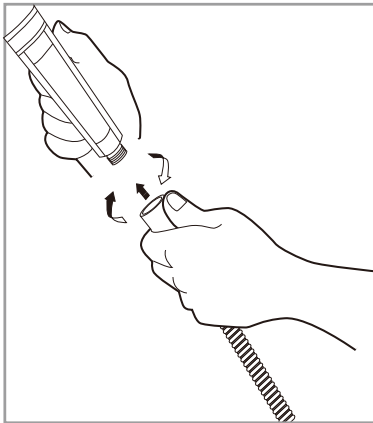
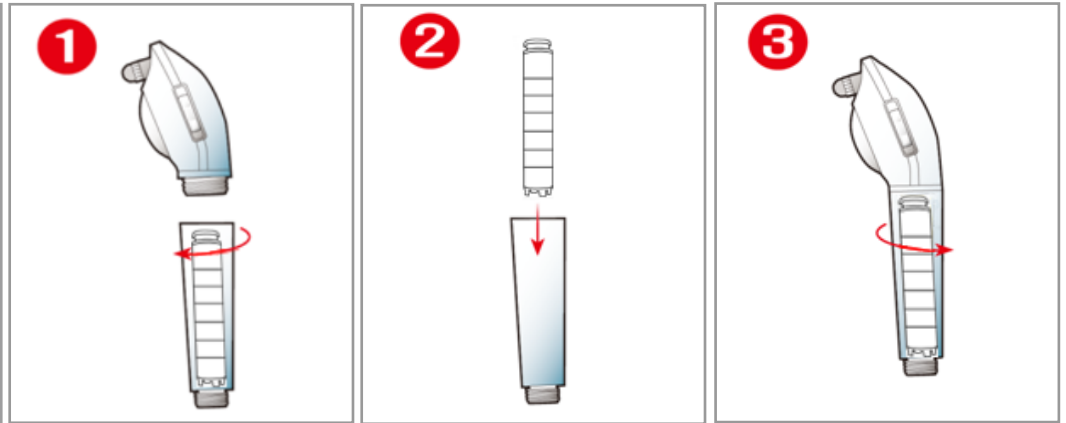

Fig. 2



**Attention:** Check the right direction to insert before loading the filter.

### Note

The filter will accumulate foreign matters or pollutants from water. This is a natural to filter out impurities so there might be contamination on the filter surface. However, even if it looks clean by the naked eye, it must be replaced after six months.

If the water pressure drops significantly, even though it is invisible to the eye, the contaminants are accumulated in the filter. Therefore you will need to replace the filter. And when the colors change severely, it is necessary to change it to use clean water.