



Drawer Cabinets

- Floating Island Cabinets
- FCAB-01L (Left Side)
 - FCAB-01R (Right Side)
 - FCAB-01M (Middle)
 - 20" W x 24" D x 36" H
 - Black Stone Countertop
 - Includes Trash Can
- Deep Wall Island Cabinets
- FCAB-03L (Left Side)
 - FCAB-03M (Middle)
 - 20" W x 30" D x 36" H
 - Black Stone Countertop
 - Includes Trash Can
 - Non Combustible Walls



Door Cabinets

- Floating Island Cabinets
- FCAB-02L (Left Side)
 - FCAB-02R (Right Side)
 - 20" W x 24" D x 36" H
 - Black Stone Countertop
- Deep Wall Island Cabinets
- FCAB04R (Right Side)
 - 20" W x 30" D x 36" H
 - Non Combustible Walls



Corner Cabinet

- Floating Island Cabinets
- FCAB-05
 - 38" W x 38" D x 36" H
 - Black Stone Countertop
 - Includes Trash Can
 - Optional Cooler



Pizza Cabinet

- Floating Island Cabinets
- FCAB-06
 - 36" W x 24" D x 36" H
 - Black Stone Countertop
 - Fits Fuego Pizza Oven
 - Recessed Side Shelves
 - Optional Foot Pegs

FLOATING ISLAND OPTIONS

NOTE: All Configurations Not Shown. Please contact Fuego for customized island configurations.

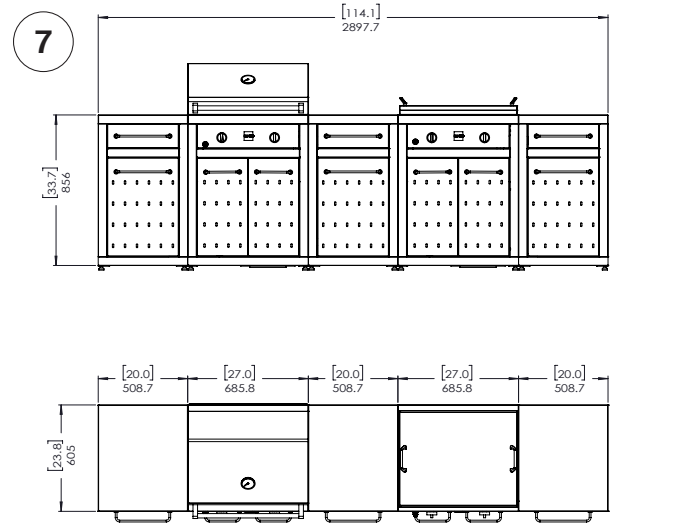
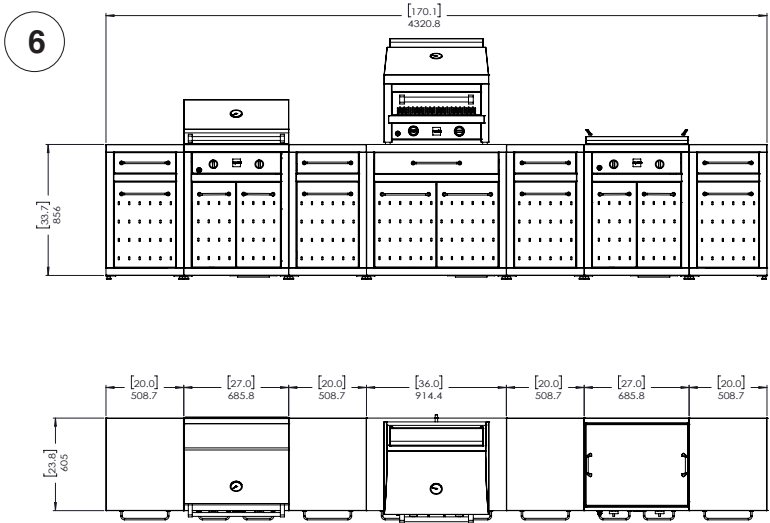
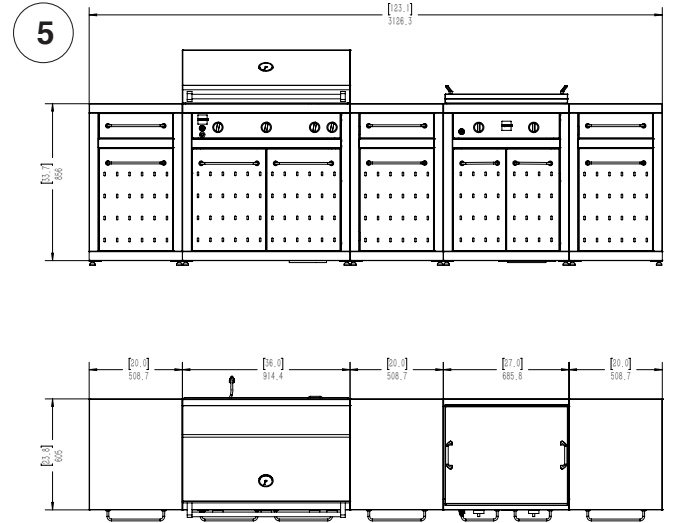
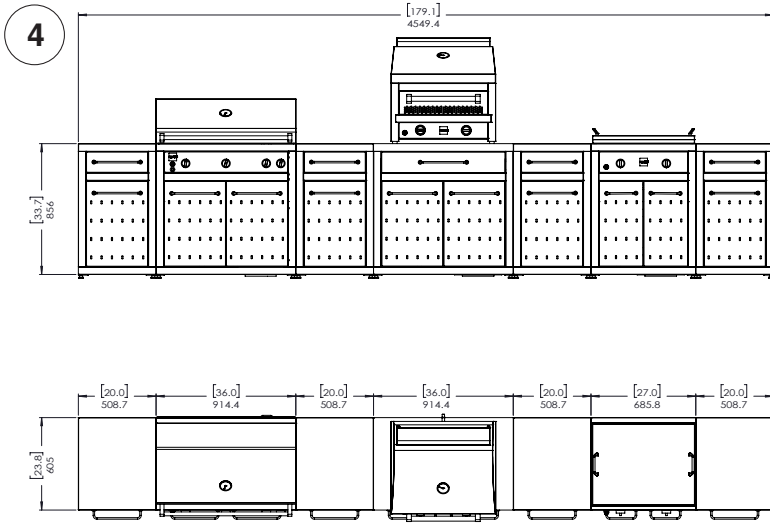
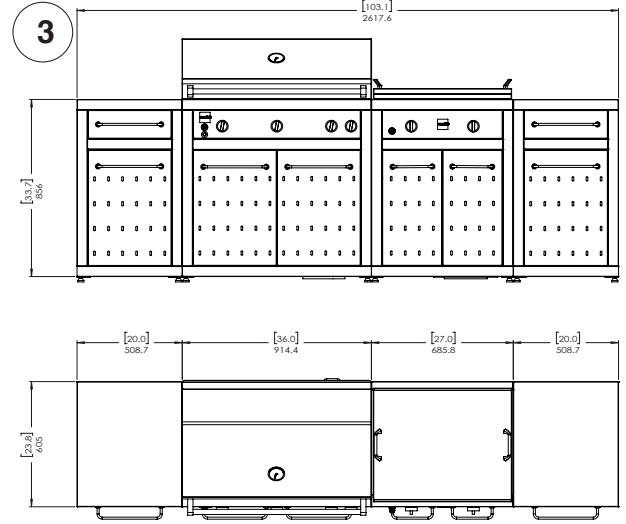
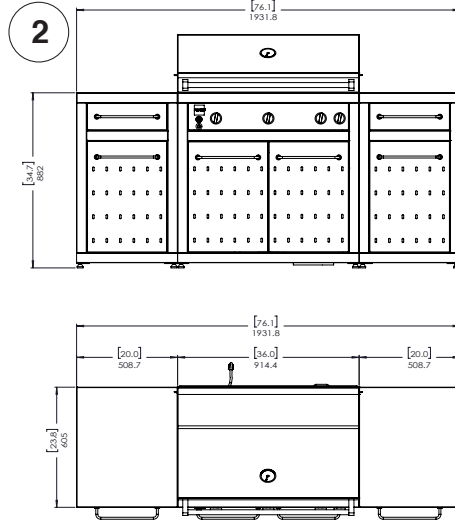
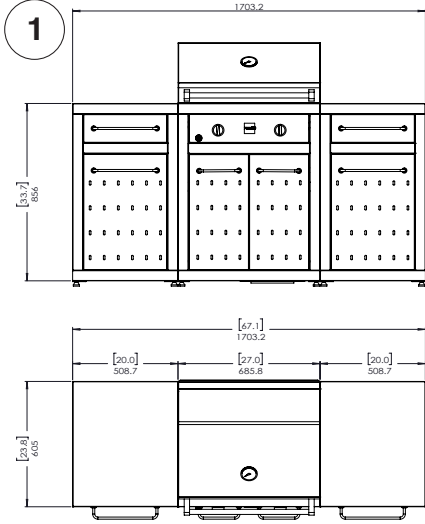

CORNER ISLAND OPTIONS

NOTE: All Configurations Not Shown. Please contact Fuego for customized island configurations.

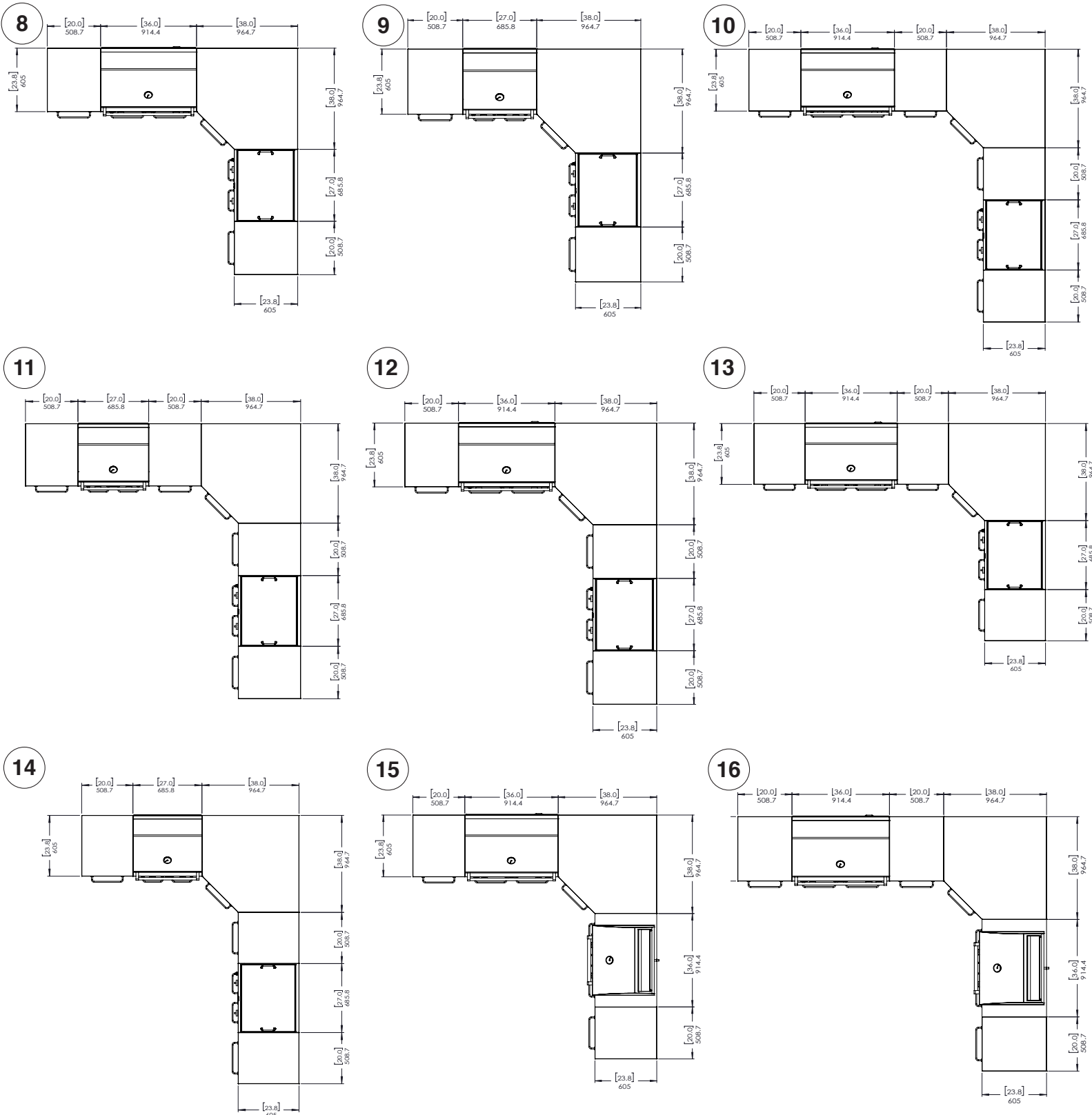

NON-COMBUSTIBLE WALL

NOTE: All Configurations Not Shown. Please contact Fuego for customized island configurations.

