

# QUADRA-FIRE®

## FEED MOTOR SPRING REPLACEMENT INSTRUCTIONS

PARTS:

SRV7027-024

FOR PELLET APPLIANCES:

CLASSIC BAY 1200 STOVE

CLASSIC BAY 1200 INSERT

### Included in Kit:

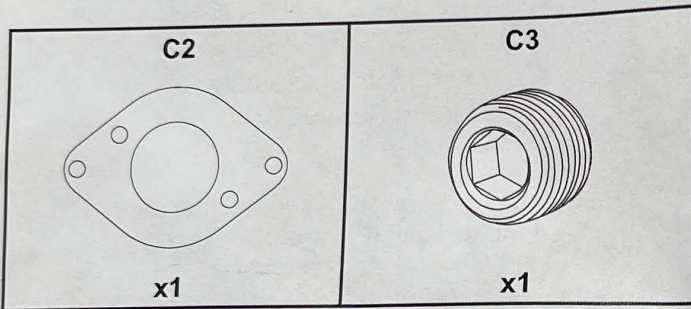
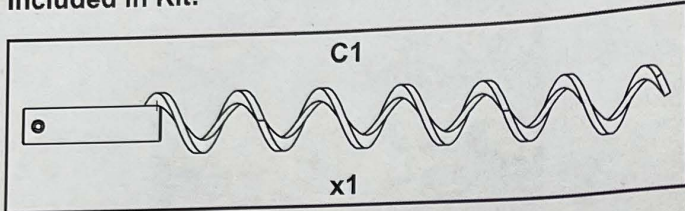

### Tools Required:

5/12 inch Allen wrench

### Included in kit:

Quantity one (1) Feed Spring (C1), quantity one (1) Feed Motor Gasket (C2), and quantity one (1) 5/16-18 x 1/4 inch Set Screw (C3)

### Proper Shutdown Procedure for Quadra-Fire Original Energy (OE) Appliances



### CAUTION

#### Shock and Smoke Hazard

- Turn down thermostat, let appliance completely cool and exhaust blower must be off. Now you can unplug appliance for servicing.
- Smoke spillage into room can occur if appliance is not cool before unplugging.
- Risk of shock if appliance not unplugged before servicing appliance.



### Classic Bay 1200 Stove

1. Open right side curtain and remove hopper side heat shield to access wiring and disconnect Molex wire connections (Figure 1).

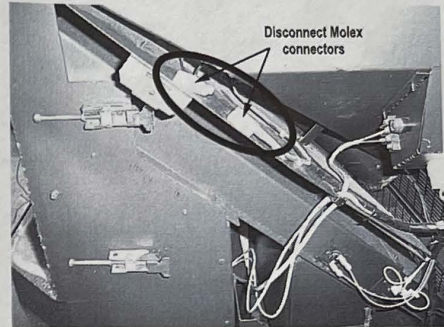

Figure 1

**NOTE:** If there is no Molex connector then disconnect spade connectors under feed motor cover.

2. Either lift up and support the stove's top while you work or remove it from the stove by loosening the five (5) screws that attach the hinge to the hopper.
3. Mark the feed adjustment rod position on feed motor cover for future reference.

**NOTE:** This will eliminate the need to re-set the feed rate when you are done.

4. Remove the cover and the front access plate from the hopper.
5. Using a 7/16" wrench remove the two nuts holding down the motor mount (Figure 2).
6. Remove feed motor/auger assembly by pulling out towards face of stove.
7. Follow steps under **Disassemble and Assemble Feed Motor Assembly** on page 2.

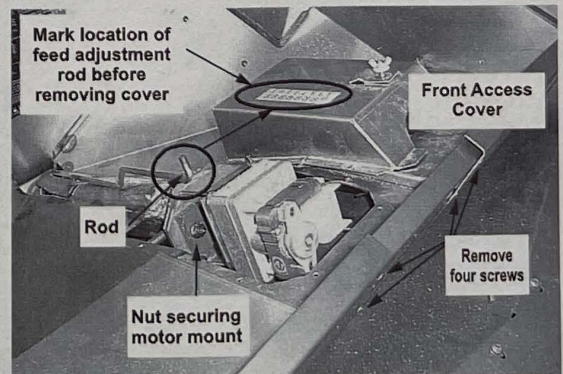

Figure 2

### Classic Bay 1200 Insert

1. Open the hopper lid.

**NOTE:** Place a reference mark on the feed adjustment rod in relation to its position on feed motor cover (Figure 3). This will eliminate the need to re-set the feed rate when you are done.

2. Remove two (2) screws from heat shield and then remove the heat shield; set aside (Figure 3).
3. Slide feed motor cover toward front of appliance and remove; set aside.
4. Disconnect the Molex connectors.

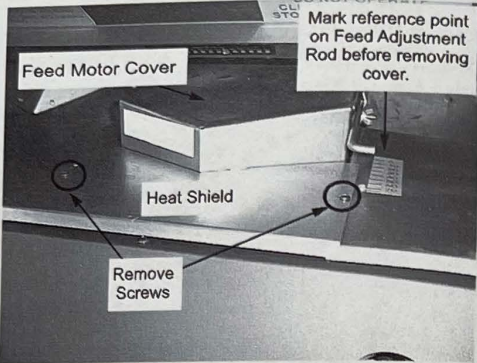

Figure 3

**NOTE:** If there is no Molex connector then disconnect spade connectors under feed motor cover.

5. Slide snap disc bracket assembly out of the way.
6. Using a 7/16 inch wrench remove the two (2) nuts on each side of the feed motor.
7. Follow steps under **Disassemble and Assemble Feed Motor Assembly** to the right.

### Disassemble and Assemble Feed Motor Assembly

Locate your feed motor in the appliance by opening the right side to expose the feed motor.

- **Inserts:** requires the removal of right side panel.
  - **Stoves:** require the removal of right side curtain.
1. Disconnect the molex connector.

**NOTE:** If there is no Molex connector then disconnect spade connectors under feed motor cover.

2. Remove the two (2) screws/bolts from the feed motor mount (Figure 4).

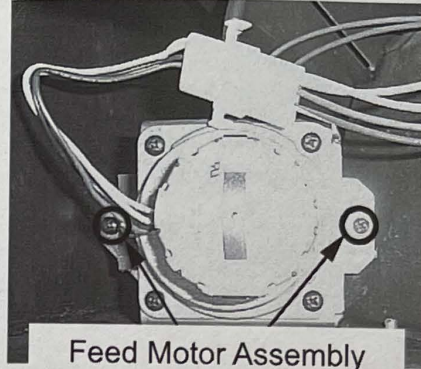

Figure 4

3. Loosen the set screw that secures the auger shaft to the feed motor shaft (Figure 5).



Figure 5

4. Loosen the set screw that secures the feed collar that hold the bearing in place (Figure 6).



Figure 6

5. Slide feed collar and bearing up off of feed motor spring.
6. Remove the old feed motor spring from the shaft of the feed motor by sliding down through the bracket.
7. Using a 5/32 inch Allen wrench and back out the 5/16-18 x 1/4 inch Set Screw (C3) until the top of the set screw is flush with the outside of the shaft of the Feed Motor Spring (C1) (Figure 7).

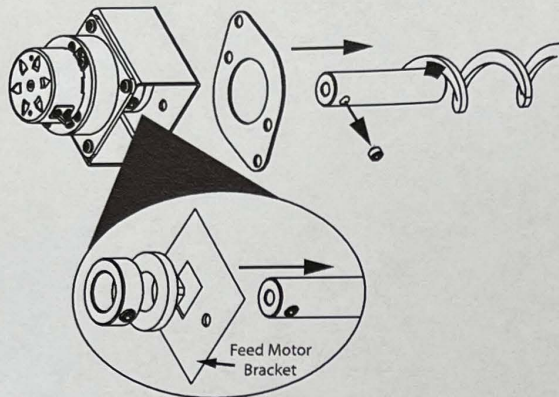

Figure 7

8. Slide new Feed Motor Spring (C1) through the Feed Motor Gasket (C2), feed motor bracket, feed motor plastic bearing, feed motor collar and onto the shaft of the feed motor (Figure 8).

**NOTE:** Ensure the 5/16-18 x 1/4 inch Set Screw (C3) aligns with flat side of feed motor shaft.

9. Verify measurement of spring length from the bottom of the feed motor bracket to the end of the spring as shown in Figure 9. For the measurement reference Table 1 to the right.
10. Slide feed motor bearing down into bracket along with feed motor collar exposing the 5/16-18 x 1/4 inch Set Screw (C3); tighten set screw (Figure 8).

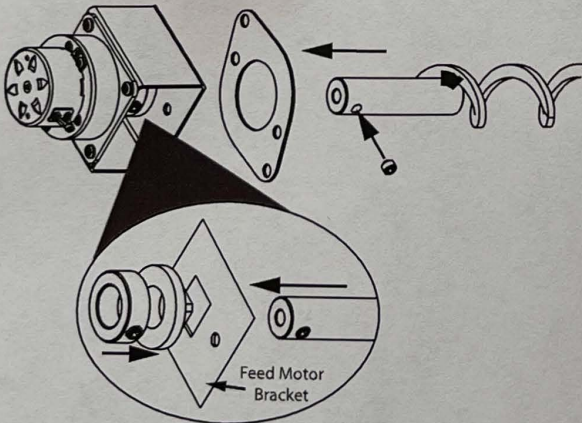

Figure 8

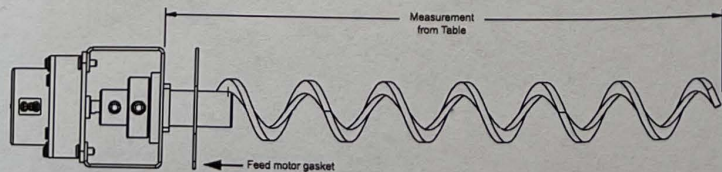

Figure 9

APPLIANCE	LENGTH
CB 1200 STOVE	14-3/8 inches (365 mm)
CB 1200 INSERT	

Table 1

11. Verify that the feed motor bearing is recessed into the feed motor bracket and then tighten feed motor collar set screw.
12. Re-assemble the appliance in the reverse order.