



### 1. PRODUCT NAME

**MILE HIGH FOAM®**

### 2. MANUFACTURER

Backer Rod Mfg. Inc.  
4244 N. Broadway  
Denver, CO 80216

Phone: (800) 595-2950  
(303) 308-0363

Fax: (303) 308-0393

Web: [www.backerrod.com](http://www.backerrod.com)

### 3. PRODUCT DESCRIPTION

**Basic Use:** MILE HIGH FOAM® is a backer rod used as a backing for elastomeric and other applied sealants. MILE HIGH FOAM® controls the depth of sealant required.

**Specific Uses:** MILE HIGH FOAM® is a soft, resilient, polyethylene backer rod used as a backup material for construction joints and applications that require sealants. MILE HIGH FOAM® performs as a depth control for most known cold applied sealants. Sealants will not adhere to MILE HIGH FOAM®; no bond breaker is required.

#### **Composition and Materials:**

MILE HIGH FOAM® is a round, black, resilient, extruded closed cell polyethylene backer rod with a water resistant outer skin. It is compatible with most known cold applied sealants such as urethane, silicone, acrylic, butyl, polysulfides, latex, and chinking sealants.

#### **Specific Uses Include:**

- Expansion joints
- Highway joints
- Glazing
- Log home chinking
- Parking Decks
- Curtain Walls
- Coping joints
- Isolation joints
- Temporary joint seal

**Limitations:** MILE HIGH FOAM® should be installed with a roller or blunt, flat-sided tool. Please follow sealant manufacturer specifications for recommended sealant width and depth ratio. For best results, do not puncture, fold or overly stretch the product. MILE HIGH FOAM® is made with a water-resistant outer skin. Where moisture resistance is important, care should be taken not to puncture this outer surface skin.

#### **Packaging:** MILE HIGH FOAM®

is available in a wide variety of diameters in 3 carton sizes:

Mini Carton 18" x 18" x 13"

Standard Carton 18" x 18" x 30"

Super Carton 13½" x 13½" x 73"

All cartons are UPS-able. For quantity per carton and rod size per joint, see charts on reverse side.

### 4. TECHNICAL DATA

MILE HIGH FOAM® is chemically inert and will resist gasoline, oil, and most solvents. Product will not stain or adhere to sealants.

#### **Physical Properties:**

Density: 1.25-2lbs./cu. ft.

Moisture Absorption: Less than 1% by volume

Temperature Range: -40°F to 200°F

### 5. INSTALLATION

Joint or opening must be free of all contaminants, loose materials, dry and free of frost. Select correct rod size for joint width. With a blunt instrument or roller, seat rod to depth recommended by sealant manufacturer.

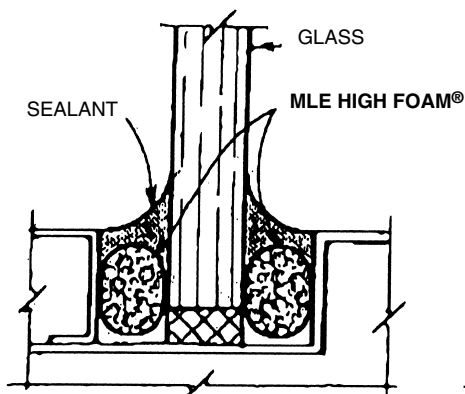

GLAZING

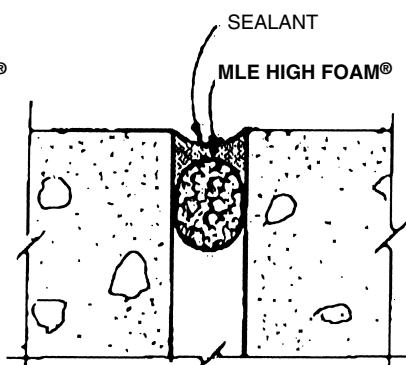

EXPANSION JOINTS

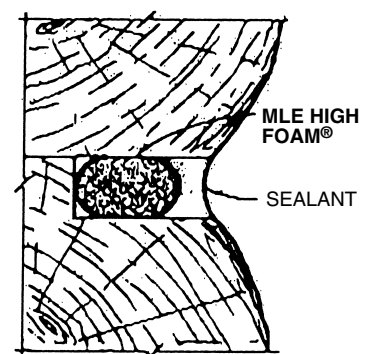

LOG CONSTRUCTION

**6. AVAILABILITY AND COST**

MILE HIGH FOAM® is marketed nationally and internationally by our distributors. For name, address, and telephone number of your nearest distributor please contact us at:

**Backer Rod Mfg. Inc.**  
 4244 N Broadway  
 Denver, CO 80216  
 Phone: (800) 595-2950  
 (303) 308-0363  
 Fax: (303) 308-0393  
 Web: www.backerrod.com

MILE HIGH FOAM® is available in other sizes, shapes, and colors. Please contact Backer Rod Mfg. Inc. for availability on custom made items.

**7. WARRANTY**

Unless otherwise agreed to in writing, product is sold without warranty. In no case will Backer Rod Mfg. Inc. be liable for incidental or consequential damages on any product.

**8. MAINTENANCE**

No maintenance is needed.

**9. TECHNICAL SERVICES**

Contact Backer Rod Mfg. Inc. for technical guidance or special project engineering designs and drawings.

**MILE HIGH FOAM® – PACKAGING**

Rod Size	Mini Carton 18" x 18" x 13"	Standard Carton 18" x 18" x 30"	Super Carton 13 1/2" x 13 1/2" x 73"	
1/4"	2500 LF/Ctn	6400 LF/Ctn	MFG'D in 6' lengths	
3/8"	1400	3600		
1/2"	800	2500		
5/8"	550	1550		
3/4"	400	1100		
1"	→	550		
1-1/4"	→	400		
1-1/2"	→			420 LF 70 pcs
2"	→			252 LF 42 pcs
2-1/2"	→			156 LF 26 pcs
3"	→			102 LF 17 pcs
4"	→			54 LF 9 pcs

**MILE HIGH FOAM® – JOINT WIDTH TO ROD SIZE**

Joint Width	Rod Diameter	Joint Width	Rod Diameter
3/16" →	1/4"	1" →	1-1/4"
1/4" →	3/8"	1-1/8" →	1-1/2"
3/8" →	1/2"	1-5/8" →	2"
1/2" →	5/8"	2" →	2-1/2"
5/8" →	3/4"	2-1/2" →	3"
3/4" →	1"	3 1/2" →	4"

**Backer Rod Mfg. Inc.**

4244 N Broadway  
 Denver, CO 80216  
 Phone: (800) 595-2950  
 Phone: (303) 308-0363  
 Fax: (303) 308-0393  
 Web: www.backerrod.com