

RAPTOR LIGHTS

Installation Guide

2017 Ford Raptor Brackets

FordRaptorLights.com

Please use proper tools and safety equipment when installing lights and bezel kit. Safety glasses or goggles are mandatory. Note that the Ford Raptor bumper cutouts can have slight variations in size from truck to truck and from one side to the other.

1 Prep

- Slide clip-on nuts over the two holes at the top of the bracket, keeping the threaded portion of the clip on nut facing the front of the bracket.
- Press the gasket around the opening of the bumper. Grease the top two upper corners that face the bezel to help it slide.

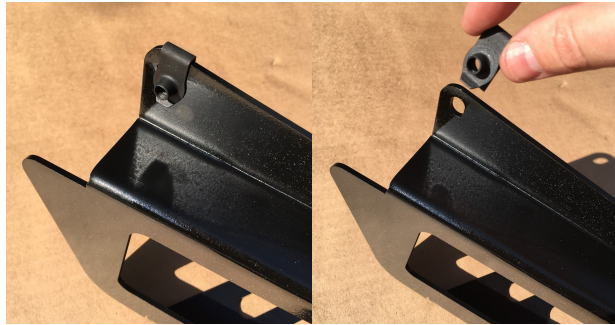

2 Fit the Metal Bracket

- Orient the bracket (the bracket should be at a 45 degree angle with a large space at the bottom of the bracket). Loosely fit both bolts with star lock washers. It is easiest to thread in the inner bolt (bolt closer to the grill) first then fit the outer bolt. The bracket will not sit flush until the bolts are torqued, don't tighten the bolts until both bolts are in place, one bolt hole is smaller but you can thread into it without drilling it out. As you tighten the bolts gently position the bracket without moving the



gasket. Before fully tightening be sure the bezel is aligned in the bumper hole and the gasket is seated evenly all around.



3 Insert the Plastic

- The plastic fairings **MIGHT** have excess flashing from the molding process behind the two snaps. Carefully trim it away with a razor. Dont fold it down or the the plastic might not fit into place.
- Snap the driver and passenger side plastic shrouds into place.

Note: 'Made in the USA' should be right side up when mounted in the bracket, also the 'D' and 'P' following USA stand for Driver and Passenger side.

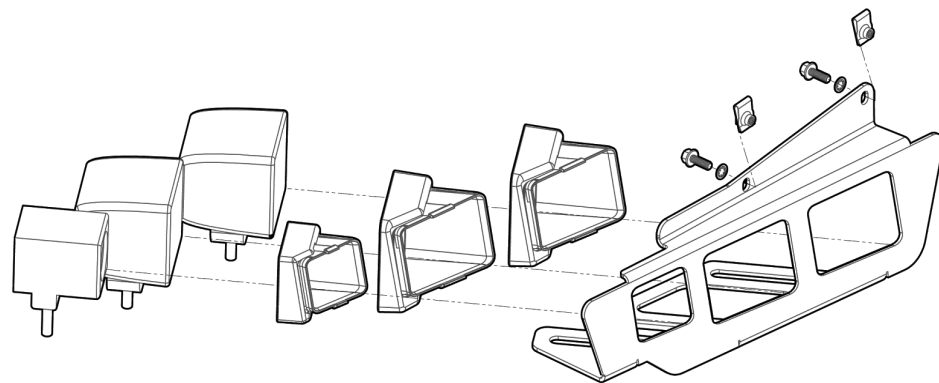

4 Position the Lights

- Position the lights. Use the spacing chart below to center your lights vertically in the plastic shrouds. Add spacers between the brackets on the lights themselves and the powder coated bracket we've supplied. We suggest leaving the Up/Down angle adjustability of your lights loose while positioning, tighten everything up when the light is pointing where you want it. If using Rigid lights, the brackets are 'C' shaped, be sure the opening of the 'C' faces the back of the light.
- 8 Stainless steel screws are included if using amber filter for the KC HiLites Flex.

Light Brand	Spacers
Rigid (Dually, Radiance, Midnight, D2, D-series Pro)	Thick washer Spacer Thin washer
Baja (Pro, Sport)	Thick washer Spacer Thin washer
Vison X (Optimus, Halo)	None
KC C-series	Thick Washer Thin Washer
KC Flex	Thick washer

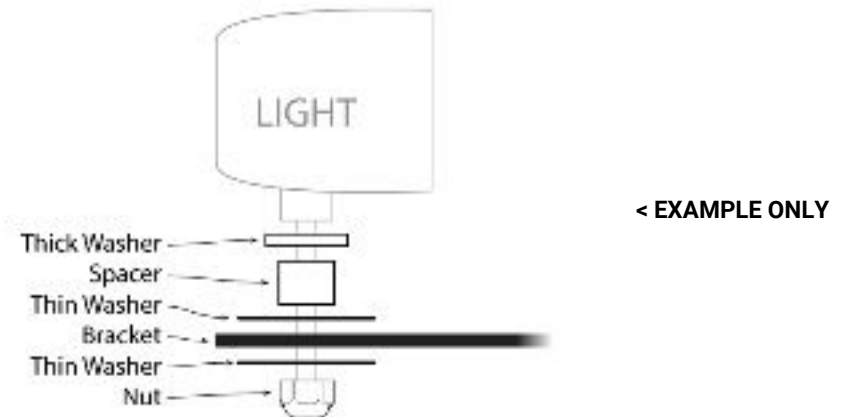

5 Wiring

- The pass through wires for the switches are taped to the wire bundles. **2017 trucks are taped to the outer bundle and 2018+ are taped to the inside bundle on the passenger's side.**

The Purple Wire: If you have a light with a halo (Rigid Radiance, Vision X Halo, etc) connect the purple wires at the whips to power the halo; **otherwise, ignore the purple wire on the wiring harness it is only for backlighting.**

Rigid Radiance lights: When using rigid radiance lights you may add DT connectors to the lights red and black wire. The white wire for the halo can be connected to the purple wire in the Raptor Lights harness.

Baja Design lights: When using the custom wire harness with Baja Designs you must cut the DT connectors off the harness and use the supplied Weather Pack connectors that mate with the Baja Designs Lights.

Wiring amperage capabilities in the truck are as follows:

Auxiliary Switch	Under Hood Wire (Amp) 2017 only	Under Hood Wire (Amp) 2018+
Aux 1	Green/Blue (15)	Green/White (15)
Aux 2	Gray/Yellow (15)	Brown/Blue (15)
Aux 3	Violet/Orange (10)	Gray/Yellow (10)
Aux 4	Brown/Blue (10)	Green/Yellow (10)
Aux 5	Gray/Orange (5)	Brown/White (5)
Aux 6	Yellow/Violet (5)	Green/Orange(5)
Ground	Black	Black

DISCLAIMER:

It is extremely important to ensure that all light bracket and mounting plate hardware is completely tight, especially for those owners who off-road their Raptor. With proper installation, the hardware kit supplied with each bezel kit is robust enough to withstand moderate off-roading. It is necessary to completely tighten the brackets on the lights themselves, and we recommend the use of thread locker to prevent the factory supplied light brackets loosening from the light due to extreme vibration. It is also recommended that you check all bolts and retighten from time to time especially when off roading. For extreme/abusive off-roading environments, we recommend removing the bezels prior to aggressive off road driving to prevent potential damage or loss to the bezels. Like anything else on your truck, the Ford Raptor Lights brackets and bezels are not impervious to abuse. Questions? Feel free to contact Esko for support at Esko@fordraptorlights.com or call 781-603-8182 for further assistance.

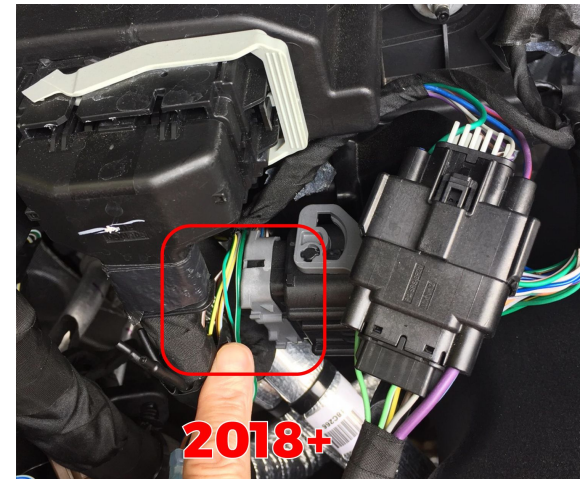

Hardware	Quantity
Thick Washer	6
Spacer	4
Fender Washer	10
Nut	4
Light Bolts	4
Bracket Bolt	4
Bracket Lock Washers	4
Bracket Snap on Nuts	4
Gasket	2
Left Bracket	1
Right Bracket	1
Drivers LG Fairing	2
Pass LG Fairing	2
Drivers SM Fairing	1
Pass SM Fairing	1
Wire Harness	1
Flex Lights	2
Radiance Whips	4 **RADIANCE ONLY
Amber Covers	2 ** If Ordered
Amber Cover Screws	8 ** If Ordered

