

-J04865

2009-06-25

FRONT ISOLATOR KIT

GENERAL

Kit Number

L1501.T

Models

This kit fits 2000 and later Blast models.

Additional Parts Required

Separate purchase of locknut (DA0700.13CZ) is required for proper installation of this instruction sheet.

⚠ WARNING

The rider's safety depends upon the correct installation of this kit. Use the appropriate service manual procedures. If the procedure is not within your capabilities or you do not have the correct tools, have a Buell dealer perform the installation. Improper installation of this kit could result in death or serious injury. (00334a)

NOTE

This instruction sheet references service manual information. A service manual for your model motorcycle is required for this installation and is available from a Buell dealer.

Kit Contents

See Figure 3 and Table 1.

REMOVAL

NOTE

Refer to the service manual for more information on these generalized steps.

1. Remove the seat.
2. Remove the fuel tank.

NOTE

When the isolator is removed, powertrain may move.

If using a platform-style jack, such as a Fat Jack, the muffler does not need to be removed.

3. Raise the motorcycle until front suspension is unloaded.
4. Remove the muffler then support engine with an appropriate jack.
5. Remove and discard horn cable strap.
6. Loosen the front ground strap bolt to gain clearance.
7. Remove the two outboard isolator bolts.

8. See Figure 1. Remove the main isolator bolt (4), spacer (5) and locknut (2). Discard the locknut.
9. Remove the isolator (6), snubber (3) and standoffs (7). Discard isolator and standoffs.

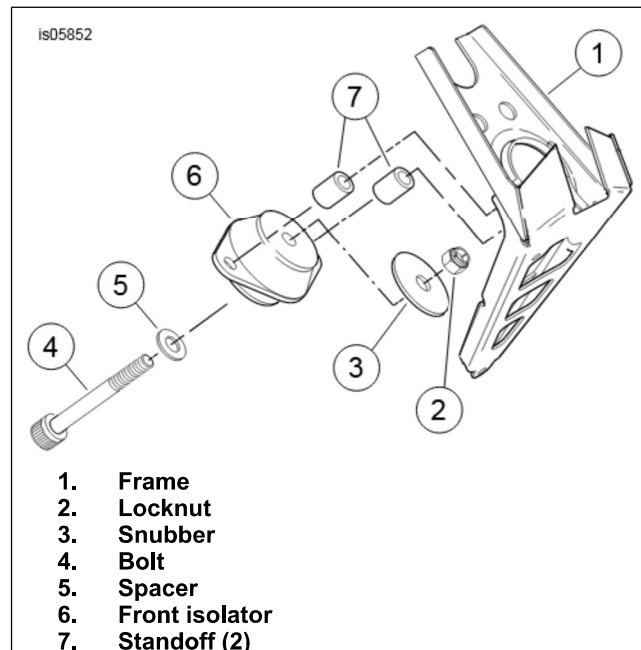

Figure 1. Remove Front Isolator

INSTALLATION

NOTE

See Figure 2. The flat side of the isolator is the top (1). Install next to the standoffs.

NOTE

See the service manual for information on these generalized steps.

1. See Figure 3. Install two standoffs (1), snubber (B), main isolator (3) and new snubber (2) with the main isolator bolt (D), spacer (C) and locknut (E).
2. Install two outboard isolator bolts. Tighten to 41–45 N·m (30–33 ft-lbs).
3. Tighten the main isolator bolt to 85–95 N·m (63–70 ft-lbs).
4. Tighten the front ground strap bolt to 41–45 N·m (30–33 ft-lbs).
5. Install the clutch cable to clip.
6. Install the new horn cable strap (purchased separately).

7. Install the fuel tank.

▲ WARNING

After installing seat, pull upward on seat to be sure it is locked in position. While riding, a loose seat can shift causing loss of control, which could result in death or serious injury. (00070b)

8. Install the seat.

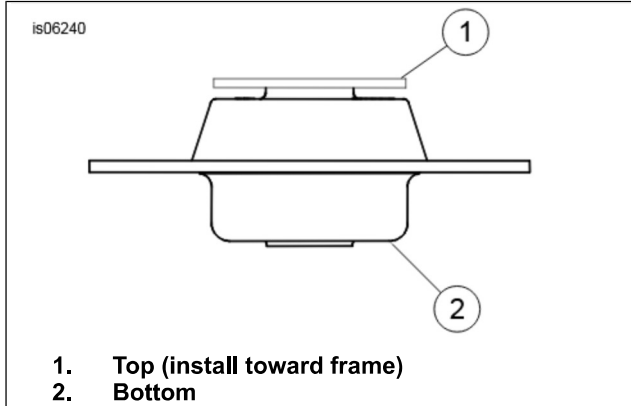

Figure 2. Front Isolator

SERVICE PARTS

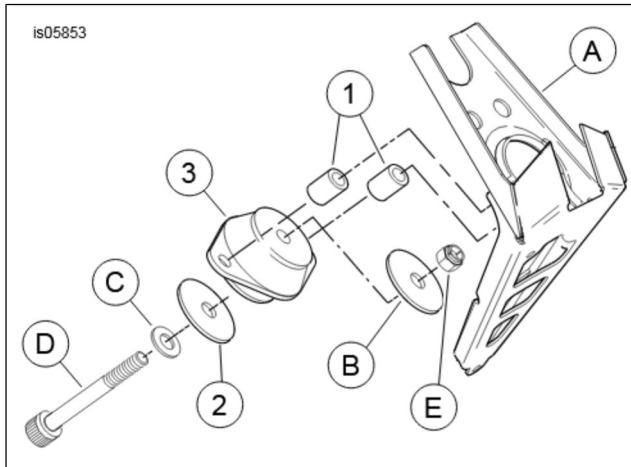

Figure 3. Service Parts: Front Isolator

Table 1. Service Parts

Item	Description (Quantity)	Part Number
1	Standoff (2)	L0150.1A7
2	Snubber	L0503.T
3	Isolator, front	L0501.TA
Items referenced in text, but not included in kit.		
A	Frame	
B	Snubber	
C	Spacer	
D	Bolt	
E	Locknut (purchased separately)	