

# INSTRUCTION SHEET

**Buell**  
AMERICAN MOTORCYCLES

-J00986

Kit Numbers 58889-97Y, 58889-99Y, 59440-97Y and 59440-99Y  
(See NOTE preceding Kit Contents.)

REV.2-10-99

## S3 FAIRING LOWERS

### General

These fairing lowers fit on S3 model motorcycles.

#### NOTE

Kit Part Nos. given above are for primed fairing lowers. Refer to Accessory Catalog or your Dealer for available colors and model fitment.

#### 59440-97Y & 58889-97Y Kit Contents:

QTY	DESCRIPTION	PART NUMBER
1	Right Fairing Lower (primed)	58742-97Y
1	Left Fairing Lower (primed)	58741-97Y
1	Right lower mount bracket	91247-97Y
1	Left lower bottom bracket	91246-97Y
1	Left lower fairing bolt, 1/4-20x3/4	2505Y
1	Left lower fairing clamp	62740-95Y
1	Left lower fairing flexlock nut	7528Y
3	Well nuts	7622Y
4	Nylon washers, 1/4-9/16	6035Y
1	Lower mounting bracket truss Torx screw 1/4-20x3/4	2609Y
2	Lower airbox mounting bolts, 1/4-20x3/4, black	3794Y

#### 59440-99Y & 58889-99Y Kit Contents:

QTY	DESCRIPTION	PART NUMBER
1	Right Fairing Lower (primed)	59444-99Y
1	Left Fairing Lower (primed)	59445-99Y
1	Right lower mount bracket	91365-99Y
1	Right upper mount bracket	91363-99Y
1	Left lower bottom bracket	91246-97Y
1	Left lower fairing bolt, 1/4-20x3/4	2505Y
1	Left lower fairing clamp	62740-95Y
1	Left lower fairing flexlock nut	7528Y
5	Nylon washers, 1/4-9/16	6135Y
3	Upper & Lower mounting bracket truss Torx screw 1/4-20x3/4	2609Y
3	Locknuts	7524Y

### Installation

#### NOTE

Follow the installation procedure that applies to kit Part No. being installed.

#### RIGHT SIDE (Part No. 59440-97Y & 58889-97Y)

1. See Figure 1. Place right fairing lower in position and install screw (2) and washer (3) to hold bottom of fairing lower on lower bracket. Place top of right fairing lower in position on air cleaner cover and mark outline around top of fairing lower.

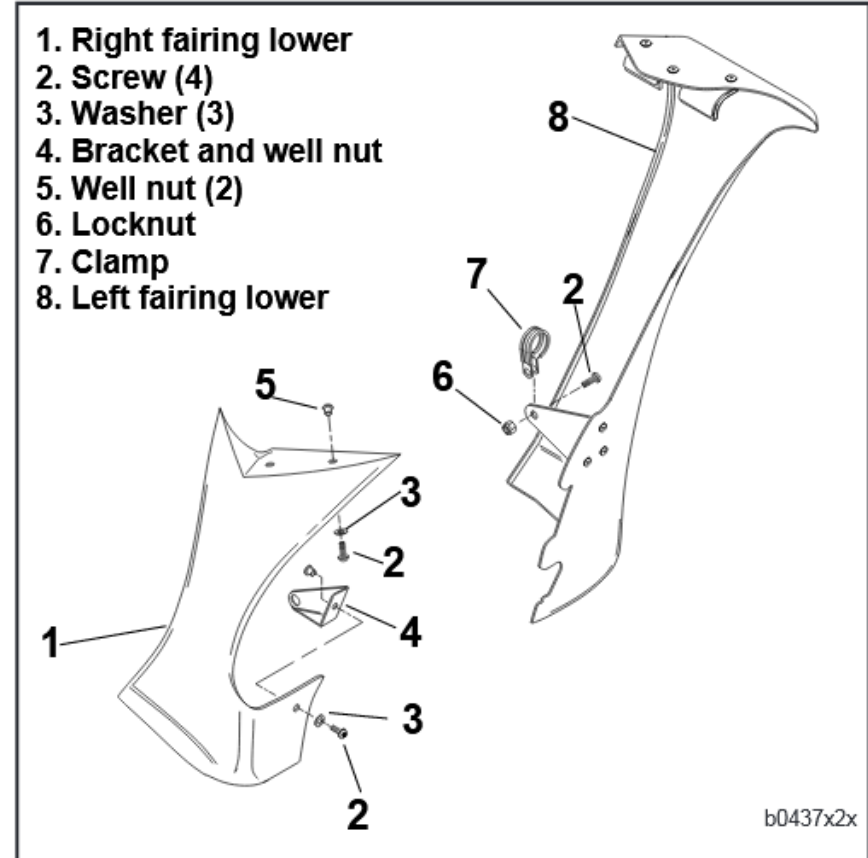

Figure 1. Fairing Lower

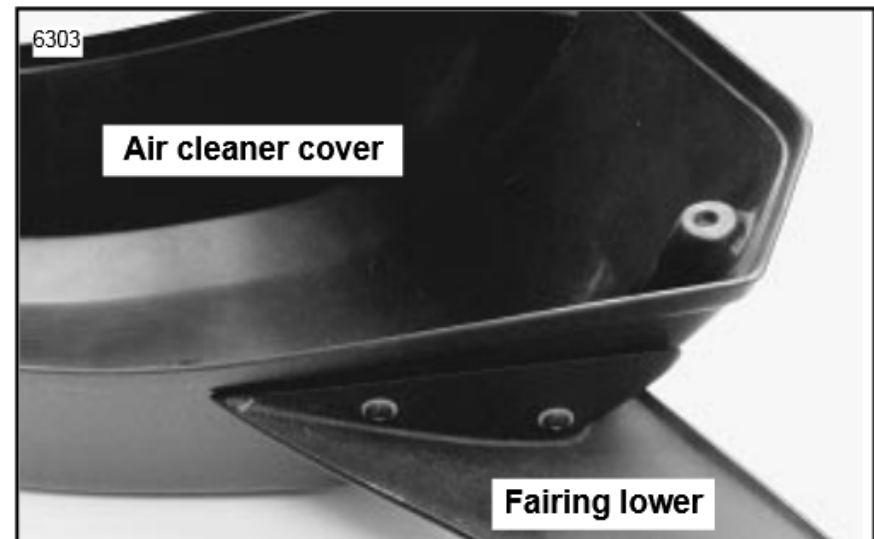

Figure 2. Right Fairing Lower Attachment

2. Remove right fairing lower and air cleaner cover. Match right fairing lower to air cleaner cover using outline marked in Step 1. While holding fairing lower and air cleaner cover together, use the two mounting holes in right fairing lower as a template and mark the two hole locations onto air cleaner cover. Carefully drill two 1/2 inch diameter holes at locations marked.
3. See Figure 2. Attach right fairing lower to air cleaner cover with well nuts, washers, and screws as shown.
4. Install air cleaner cover.
  - a. Place cover and fairing lower assembly over backplate. Hold with one hand.

- b. Install both rear screws and nylon washers.
  - c. Install both front screws and nylon washers.
5. See Figure 1 and 3. Install bottom screw (2) and washer (3).

#### LEFT SIDE (Part No. 59440-97Y & 58889-97Y)

1. Refer to applicable Service Manual and remove fuel tank mounting screw. See Figure 1. Gently lift fuel tank and insert left fairing lower (8) lip over frame tube.
2. See Figure 4. Align clamp with metal bracket on fairing lower. Insert screw through clamp, metal bracket and opposite side of clamp. Fasten with locknut.
3. Tighten fuel tank screw to 9-11 ft-lbs (12.2-14.9 Nm).

#### **⚠WARNING**

After installing seat, pull upward on front of seat to be sure it is locked in position. If seat is loose, it could result in shifting during vehicle operation, loss of control of vehicle, death or serious injury.

4. Install seat.

#### RIGHT SIDE (Part No. 59440-99Y & 58889-99Y)

#### **CAUTION**

To avoid stressing the right fairing lower, loosely assemble all components and then tighten in the sequence given in the following procedure. Not following the tightening sequence could cause cracking/failure of the fairing lower.

1. Remove the two 1/4-20 x 3/4 in. button head hex socket screws from bottom of air cleaner cover. (Well nuts and screws are installed at factory.)
2. See Figure 5. Locate proper holes in upper bracket (1) depending on vehicle configuration. Install upper bracket (1) on air cleaner cover with screws (8) that were removed in step 1. Tighten screws (8) securely.
3. See Figure 5. Loosely attach right fairing lower (2) to upper bracket (1) with screws (3), plastic washers (4) and locknuts (5)
4. See Figure 5. Loosely attach lower bracket (6) to right fairing lower (2) with screw (3), plastic washer (4) and locknut (5).
5. See Figure 3. Remove large nut and flat washer. Discard flat washer. Slide bracket (6, Figure 5) on stud. Install nut "finger-tight".
6. Gently wiggle right fairing lower so it will be positioned properly without any stress on the plastic.
7. Tighten fasteners in the following sequence:
  - a. Tighten screws (3) and locknuts (5) that secure right fairing lower to upper bracket (1).
  - b. Tighten screw (3) and locknut (5) that secure right fairing lower to lower bracket (6).

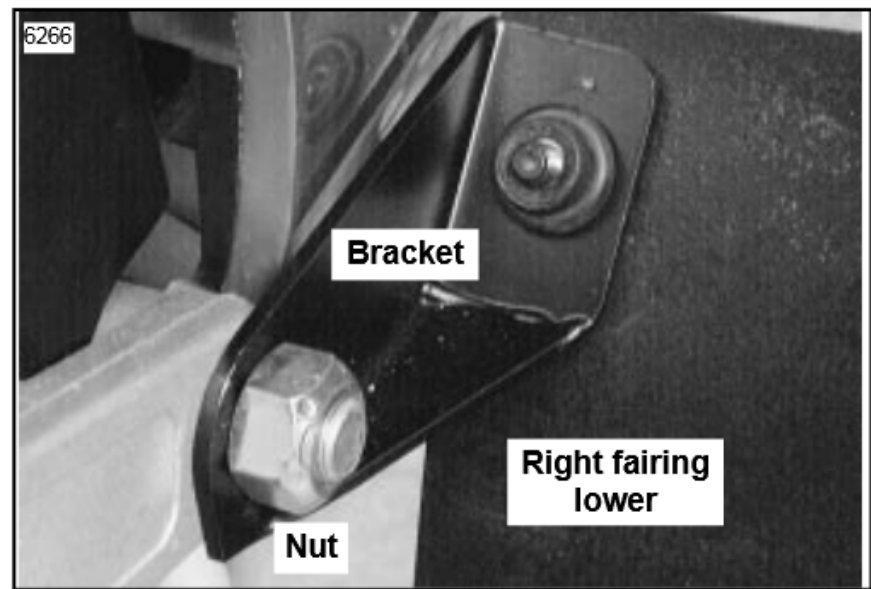

**Figure 3. Right Fairing Lower Mount**



**Figure 4. Left Fairing Lower Clamp**

- c. See Figure 3. Tighten nut to 30-35 ft-lbs (40.7-47.4 Nm).

#### LEFT SIDE (Part No. 59440-99Y & 58889-99Y)

1. Refer to applicable Service Manual and remove fuel tank mounting screw. See Figure 5. Gently lift fuel tank and insert left fairing lower (12) lip over frame tube.
2. See Figure 5. Install clamp (9) on small frame tube joining lower frame tube to front tie-bar mount tubes.
3. Align clamp (9) with metal bracket on fairing lower. Insert screw (10) through metal bracket, plastic washer (4) and clamp (9). Install locknut (11), but, don't tighten now.
4. Align left fairing with fuel tank. Tighten fuel tank screw to 9-11 ft-lbs (12.2-14.9 Nm).
5. Tighten screw (10) and locknut (11).

#### **⚠WARNING**

After installing seat, pull upward on front of seat to be sure it is locked in position. If seat is loose, it could result in shifting during vehicle operation, loss of control of vehicle, death or serious injury.

6. Install seat.

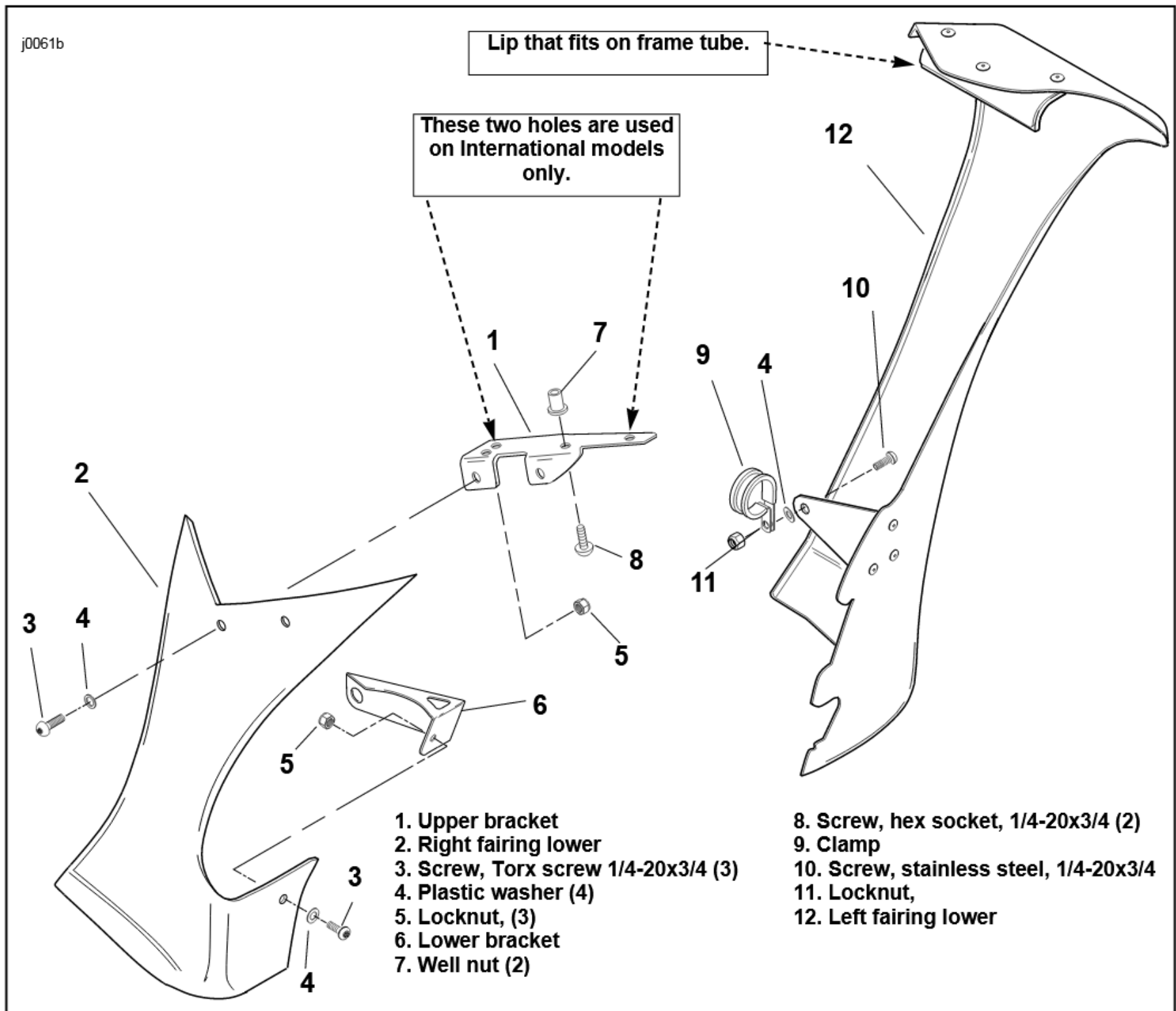

Figure 5. Fairing Lowers