

INSTRUCTION SHEET

Buell
AMERICAN MOTORCYCLES

-J02966

Kit Number 56144-04Y

REV. 12-09-2004

TORQUE GRIP

General

The Torque Grip kit fits 1996 and later Buell® S1, M2, S3, S3T, S1W, X1, P3 Blast® and XB models **except** for the XB9SX.

See the Service Parts illustration for kit contents.

WARNING

The rider's safety depends upon the correct installation of this kit. If the procedure is not within your capabilities or you do not have the correct tools, have a Buell dealer perform the installation. Improper installation of this kit could result in death or serious injury. (00309a)

NOTE

This instruction sheet references Service Manual information. A Service Manual for your model motorcycle is available for purchase at your Buell® dealer.

Installation

WARNING

Do not lubricate the left handlebar grip in any way before installation. This could allow the grip to come off while riding, which could result in loss of control and death or serious injury.

1. Follow Service Manual instructions to remove the right throttle sleeve and handgrip.
2. Remove existing left handgrip by carefully cutting it away from the handlebar using a sharp blade or knife.
3. If present, pop the black plastic end caps out of the handlebar.
4. Clean and smooth left and right handlebar ends.

NOTE

Make sure surfaces to be glued are clean, dry and free from oil, or new application may not adhere as desired.

5. See Service Parts illustration. Follow Service Manual instructions to maintain the routing of the throttle and idle cables and assemble the kit throttle sleeve handgrip (2) to the handlebar.

NOTE

Please observe the warnings and cautions included with the adhesive contained in this kit.

6. Liberally apply a coat of the adhesive (Part No. 99839-95) from the kit to the inside of the left handgrip (1) using the cotton swab. Make sure adhesive fully covers all inside surfaces of the handgrip. Then apply a coat of adhesive to the left handlebar end.

NOTE

Do not hesitate when installing the left grip, or the adhesive will dry before installation is complete. Allow 8 hours at 70°F to cure the adhesive.

7. See Figure 1. Position the BUELL® logo on the end of the left handgrip to match the BUELL® logo on the right handgrip and immediately push the new left handgrip onto the handlebar until the handgrip stops against the handlebar end.
8. Rotate forks lock to lock and check the throttle and idle return before riding motorcycle.

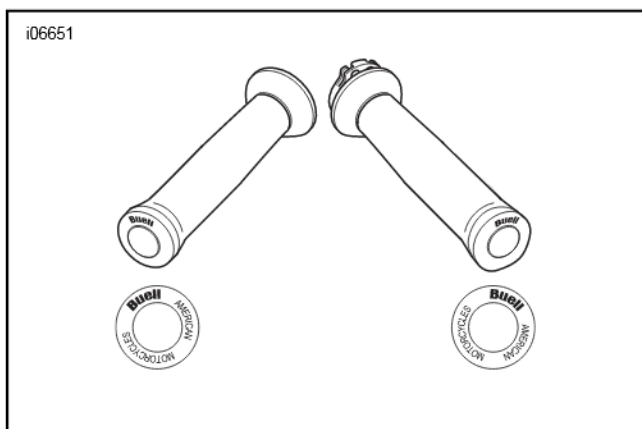

Figure 1. Matching Handgrip Logo Positions

Part No. 56144-04Y | Date 12/04

Torque Grip

Service Parts

Buell
AMERICAN MOTORCYCLES

i06656

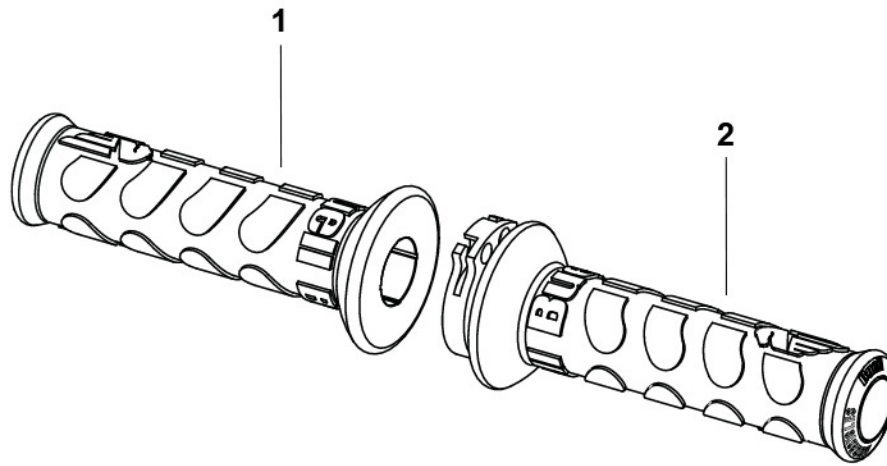

Item	Description	Part No.
1	Handgrip, left	56147-04Y
2	Handgrip, right (throttle sleeve)	56145-04Y
	Cotton swab (not shown)	Not sold separately
	Adhesive, 10 gram tube (not shown)	99839-95