

J03713

2005-03-23

## AMBER HAND LEVER KIT

### GENERAL

#### Kit Number

46387-05Y

#### Models

This kit is designed to fit all 2003 and later Buell XB model motorcycles.

#### Additional Parts Required

##### ▲ WARNING

The rider's safety depends upon the correct installation of this kit. Use the appropriate service manual procedures. If the procedure is not within your capabilities or you do not have the correct tools, have a Buell dealer perform the installation. Improper installation of this kit could result in death or serious injury. (00334a)

##### NOTE

This instruction sheet references Service Manual information. A Service Manual for your model motorcycle is required for this installation and is available from any Buell Dealer.

Loctite<sup>®</sup> Anti-Seize lubricant (Part Number 98960-97) is available from any Buell Dealer

#### Kit Contents

This kit consists of a amber clutch hand lever (part number 46391-05Y) and brake hand lever (part number 46395-05Y).

There are no Service Parts available with this kit.

### INSTALLATION

#### Brake Lever

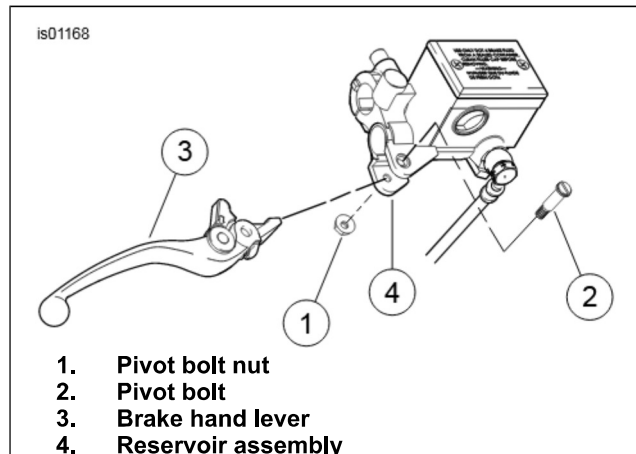

Figure 1. Brake Lever Components

1. See Figure 1. At the brake lever, remove pivot bolt nut (1) (metric) and pivot bolt (2) from brake hand lever (3). Remove brake hand lever from reservoir assembly (4).

2. Lubricate pivot bolt (2) with Loctite<sup>®</sup> Anti-Seize.

3. From the kit, install the new brake lever into the reservoir assembly (4) and install pivot bolt (2) through reservoir assembly and brake lever (3). Install pivot bolt nut (1) onto pivot bolt. Tighten to 9–14 N·m (80–120 in-lbs).

##### ▲ WARNING

After repairing the brake system, test brakes at low speed. If brakes are not operating properly, testing at high speeds can cause loss of control, which could result in death or serious injury. (00289a)

##### ▲ WARNING

Be sure that all lights and switches operate properly before operating motorcycle. Low visibility of rider can result in death or serious injury. (00316a)

4. After completing brake hand lever installation, check for proper operation of rear brake lamp.

#### Clutch Lever

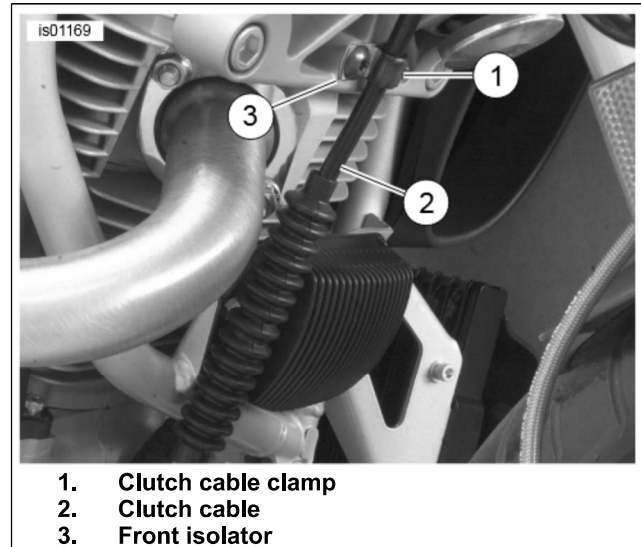
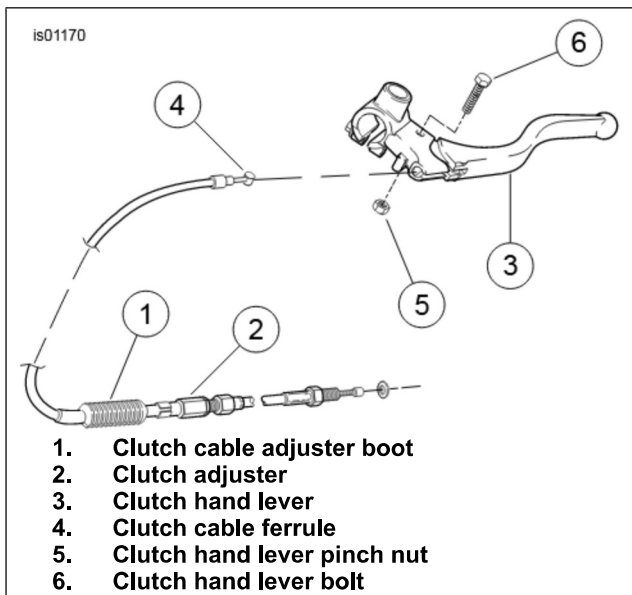

Figure 2. Clutch Cable Clamp

1. See Figure 2. Remove the clutch cable clamp (1) and cable (2) from the front isolator (3).



**Figure 3. Clutch Lever Components**

2. See Figure 3. Slide the clutch cable adjuster boot (1) up to access clutch adjuster (2).
3. Loosen clutch adjuster (2) to release tension from clutch hand lever (3).
4. Remove clutch cable ferrule (4) from clutch hand lever.
5. Remove clutch hand lever pinch nut (5) and bolt (6). Retain nut and bolt for future use. Remove clutch hand lever.
6. Lubricate clutch hand lever bolt (6) with Loctite<sup>®</sup> Anti-Seize.

**NOTE**

*Refer to your model motorcycle service manual for clutch cable adjustment procedures.*

7. Insert **new** clutch hand lever and saved bolt, and nut. Tighten nut (metric) to 4–5 N·m (39–48 **in-lbs**).
8. See Figure 3. Slide the clutch cable adjuster boot (1) down and over clutch cable adjuster (2).
9. See Figure 2. After proper clutch cable adjustment has been completed, install clutch cable clamp (1).