

Tools required for installing

Recessed Deck Lighting:

- Power Drill
- 1¼ forstner drill bit (comes with kit)
- Measuring tape
- “C” clips
- * Care must be taken not to crush wire insulation



Wall Lighting/Down Lighting:

- Measuring tape
- Trowel or shovel to bury wire/tuck wire



Landscape Lighting:

- Measuring tape
- Rubber Hammer
- Shovel and/or trowel

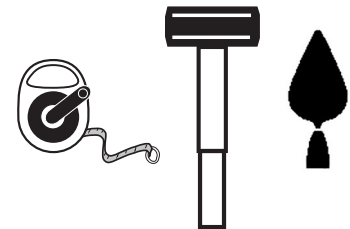

General Instructions

Recessed Deck /Pathway Lighting and Hardscape Wall Lighting

- 1) Plan your project out by measuring where you want each light to go and determine where you will place the transformer and timer (must be easily accessible).
- 2) Add up wattage of desired lighting and choose the correct transformer (36, 60, 100 watt).
- 3) After measuring, determine which wire splitters or harnesses you will be using for your project (See diagrams of plug and play connector cables and extension cables).
- 4) Follow Building /Electrical codes in your area. Consult your local municipality for height regulations for where to place outdoor timer. (Usually no less than 31 cm/12.5” from ground level).
- 5) Timer Photo Eye must be in view of sun when using dusk/dawn feature.
- 6) Each circuit should only have 1 dedicated transformer running at a time.
- 7) If Transformer and timer are being installed outdoors GroundFault Circuit Interrupter, (AC GFI or GFCI) are required.
- 8) If installing in **DECKS OR PAVERS**: Prior to Drilling, test the ambiance/ brightness and spacing of the lights (at night) to your satisfaction.
- 9) If you are using the plug and play system, determine what type/length of plug and play cables you need. Always allow for a bit of slack in the wire for fine tuning on a deck.
(Detailed/pictures instructions, see Installation Instructions)
- 10) Make sure any unused connections are capped off with our End Caps.
- 11) During installation, test lights as you go by powering up the transformer.
- 12) We recommend Cable runs no longer than 175 feet or voltage drop will occur (lights furthest from transformer will be more dim).
- 13) For **DECKS**, wiring should be run under deck and behind risers and stringers. Wires should not be run between joists and deck boards.
 - Ideally, wiring should be installed before decking and railing have been installed.
- 14) For **WALL LIGHTING AND LANDSCAPE LIGHTING**, allow for more slack in the wire for tucking behind the wall and for burying the wire.

Installation Instructions When using 8 lights (kit) or more than 8 lights

For LEDEZE Plug and Play LED Lighting system. Works with Recessed Lights, Wall Lights & Landscape Lights.

5 and 4 Wire SPLITTER System

Completely versatile, interchangeable and can be used in any imaginable combination

All lights have to tap into either the 5 or 4 Wire "SPLITTER" System *OR* 8 or 4 Outwire "HARNESS" System *directly or with an extension cable* from the transformer

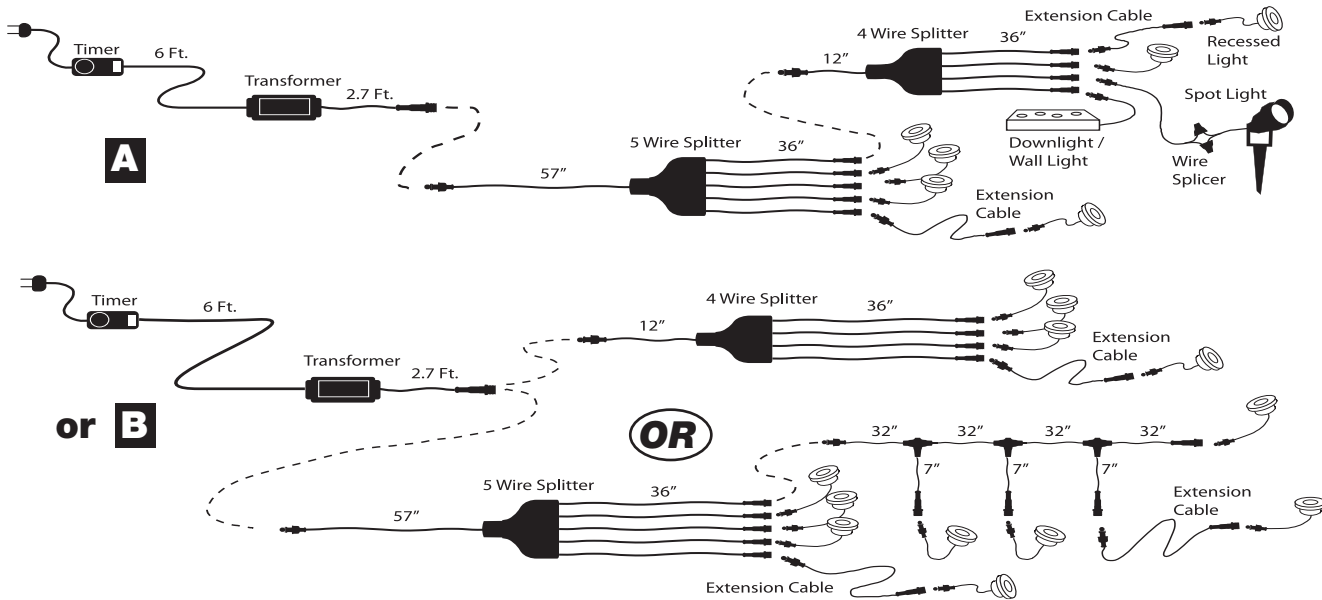

5 or 4 Wire "SPLITTER" can be plugged into the transformer with combinations of Splitters and Extensions to follow or **Outwire HARNESS Systems** and Extensions to follow

- Step 1 - Space out the number of lights as desired
- Step 2 - Plug in Timer (Follow building codes in your area)
- Step 3 - Plug Transformer into Timer
- Step 4 - From the Female end of Transformer, plug in Male end of 5 Wire Splitter
- Step 5 - From the 5 Wire Splitter plug in the 4 Wire Splitter to one of the open Female ends

- Step 6 - From the Splitters determine the distance needed to reach each light
- Step 7 - You will have 8 Female ends to plug in your 8 lights
- Step 8 - Add extension cables to reach lights if necessary
- Step 9 - Use end cap connectors or silicone to seal any unused Female ends to prevent moisture from getting in

8 and 4 Outwire HARNESS System

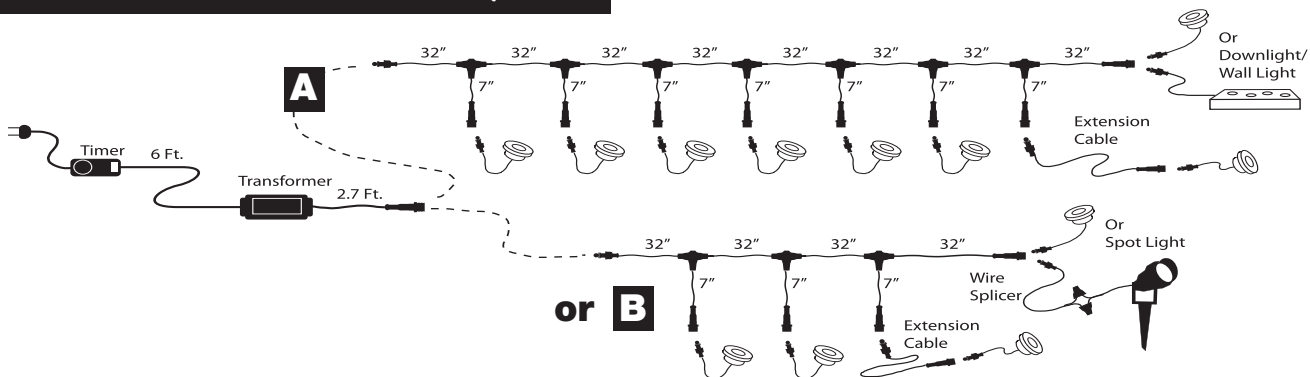

- Step 1 - Space out the number of lights as desired
- Step 2 - Plug in Timer (Follow building codes in your area)
- Step 3 - Plug Transformer into Timer
- Step 4 - From the Female end of transformer, plug in Male end of 8 or 4 Outwire System

- Step 5 - You can attach another 4 or 8 Outwire system (Male end) to an open Female end or use any combination of 4 or 5 male end Wire Splitters for more lights
- Step 6 - Add Extension Cables to reach lights OR add Splitters and extensions to connect ONE light to another
- Step 7 - Use end cap connectors or silicone to seal any unused Female ends to prevent moisture from getting in

T Shape Harness Splitter & Plug and Play Extension Cables

- T Shape Harness immediately from the transformer or anywhere in the application.
(Used for when going on either side of walkway/driveway/path/deck)

*Every job is custom and this system allows you to create your own plug and play systems with the various attachments listed here.

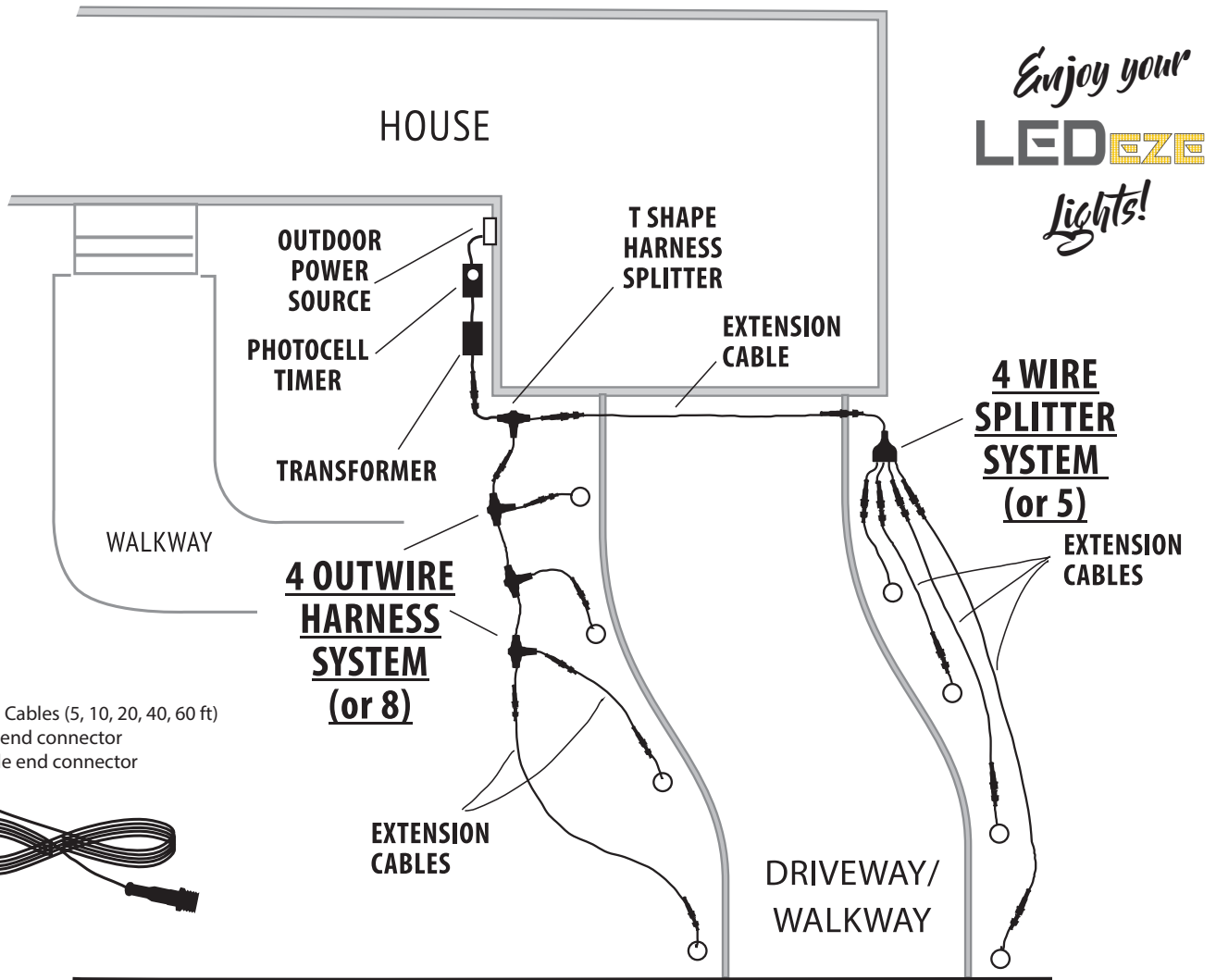
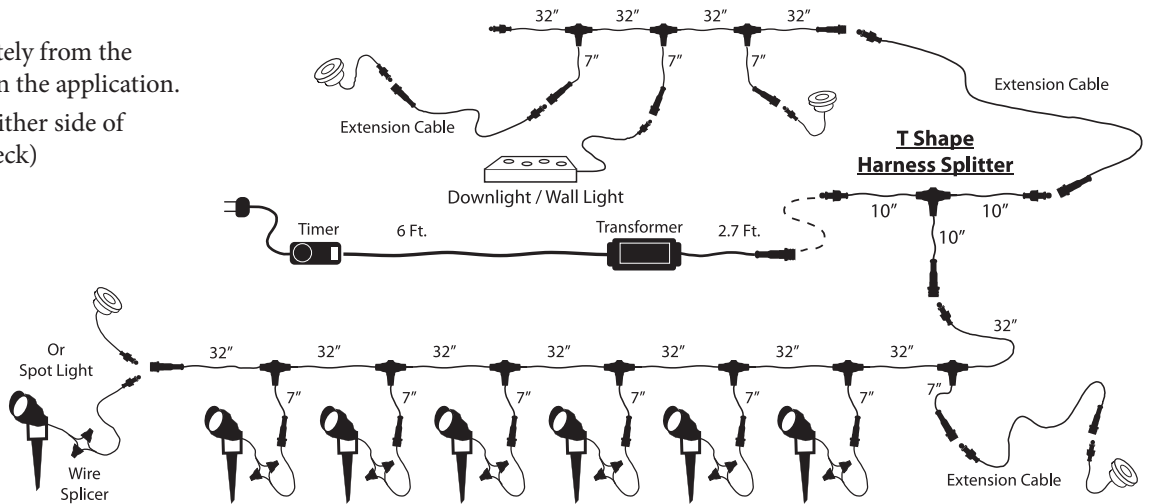

Extension Cables (5, 10, 20, 40, 60 ft)
one male end connector
one female end connector

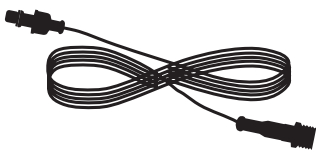

Wire Splicer

Converts 16 or 18 gauge hardwire system to LEDEZE Plug and Play

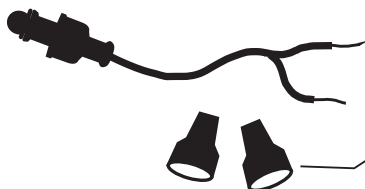

Make sure connections are waterproof.

*Use Gel filled wire nuts (Available in accessories).

