

## Overview

---

Tabletop array microphone provides a comfortable conference sound environment with no configuration needed.



## Features

---

- Supports network audio standard, “Dante”.
- Auto Voice Tracking allows flexibility of table layout in meeting room and position of participants.
- 6 types of microphone directivity to choose from, depending on the number of participants and meeting style.
- Achieves comfortable sound quality by making full use of adaptive echo canceller, auto gain control, noise reduction, and dereverberation.
- When using Auto Voice tracking, RM-CR automatically selects the microphone that is the nearest to talker to pick up voice.
- Dante audio, control reception and PoE power are connected through a single network cable.
- With included mounting adaptor, the microphone can be fixed on the table.

## Specifications

### General Specifications

Description	Boundary Microphone	
Colour	Black, White	
Dimensions (W x D x H)	140mm x 140mm x 41.5mm	
Weight	310g	
Power Requirements	PoE (IEEE 802.3af)	
Maximum Power Consumption	4.5W	
In Operation	Temperature	0°C - 40°C
	Humidity	30% - 90% (No condensation)
Storage	Temperature	-20°C - 60°C
	Humidity	20% - 90% (No condensation)
Indicator	<ul style="list-style-type: none"> <li>• Mute Indicator (Mute/Unmute)</li> <li>• Status Indicator (Ring)</li> <li>• Network Port Indicator</li> </ul>	
Maximum Device Number with RM-CR	8 (Connection with other than RM-CR is not limited to this device)	
Accessories	Installation Manual, Table-top mounting adapter, 3 x Screw for mounting, 3 x Spacer	

### Ethernet

Ethernet	Dante Audio/Dante Control, Remote Control, Web UI, PoE
Cable Requirements	CAT5e or higher (STP)

### Audio I/O

Frequency Response	160Hz - 16kHz (-10dB)	
Sampling Rate	48kHz	
Bit Depth	24bit	
Latency	57ms (including signal processing)	
Audio I/O	Dante	1in x 2out
		In1=AEC reference signal/Out1=output of beam mix, Out2= output of beam mix (simple processed)
Maximum Input Level of SPL (0dBFS)	106.8dB SPL	
Self Noise	6.3dBA SPL	
SNR (Ref. 94dB SPL at 1kHz)	87.7dBA	
Sensitivity	-12.8dBFS/Pa	
Dynamic Range	100.5dBA	
Signal Processing	<ul style="list-style-type: none"> <li>• Auto Voice Tracking</li> <li>• Selectable Polar Pattern: Cardioid, Hyper Cardioid, Super Cardioid, Omni, Bi-Directional, Troid</li> <li>• AEC, NR, Dereverberation, Auto Mixer, AGC, User PEQ, Output Gain</li> </ul>	

## Dimensions

Unit: mm (inch)

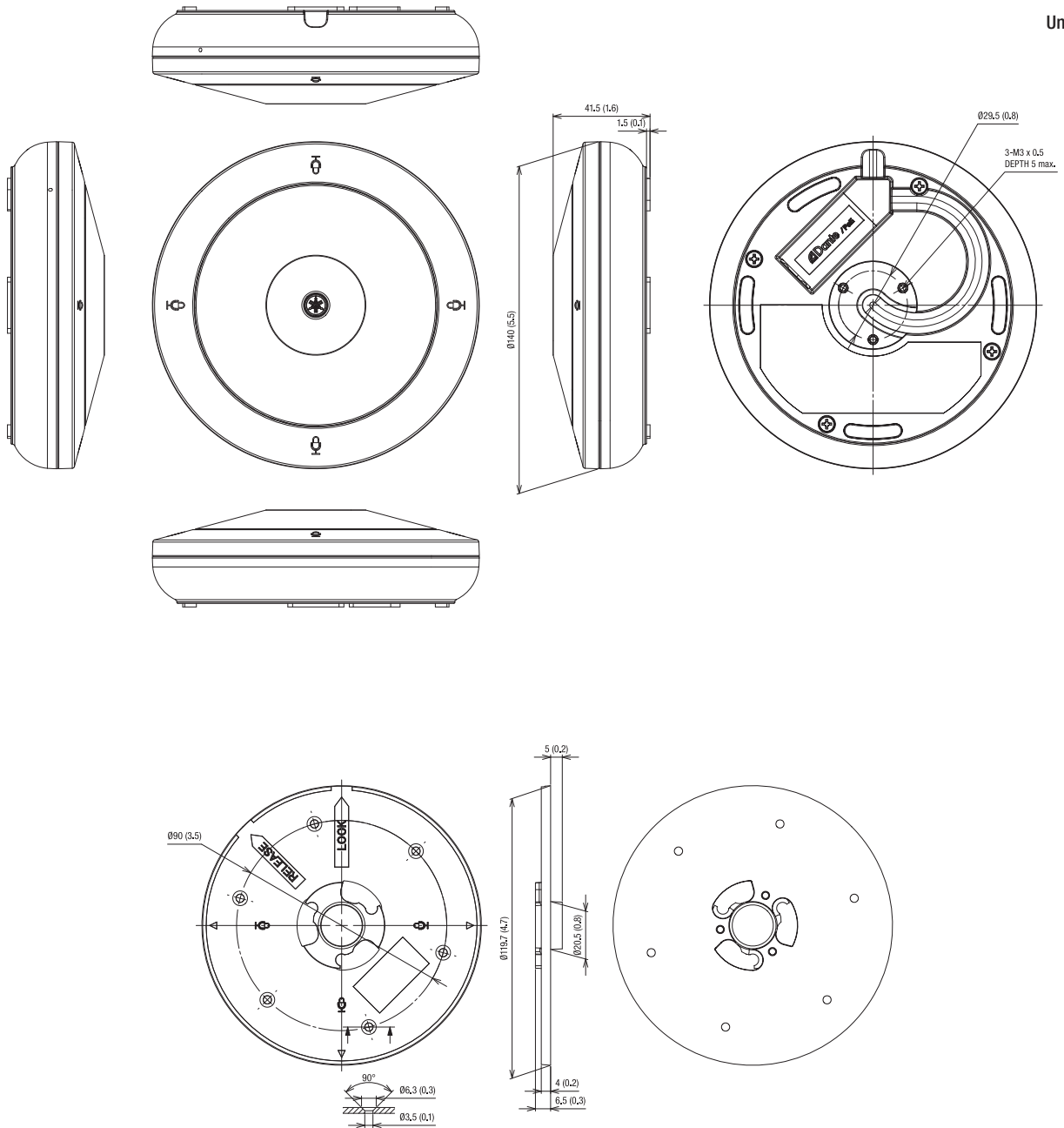

## Software

- ProVisionaire Touch
- ProVisionaire Control

## Frequency Response

### LINEAR

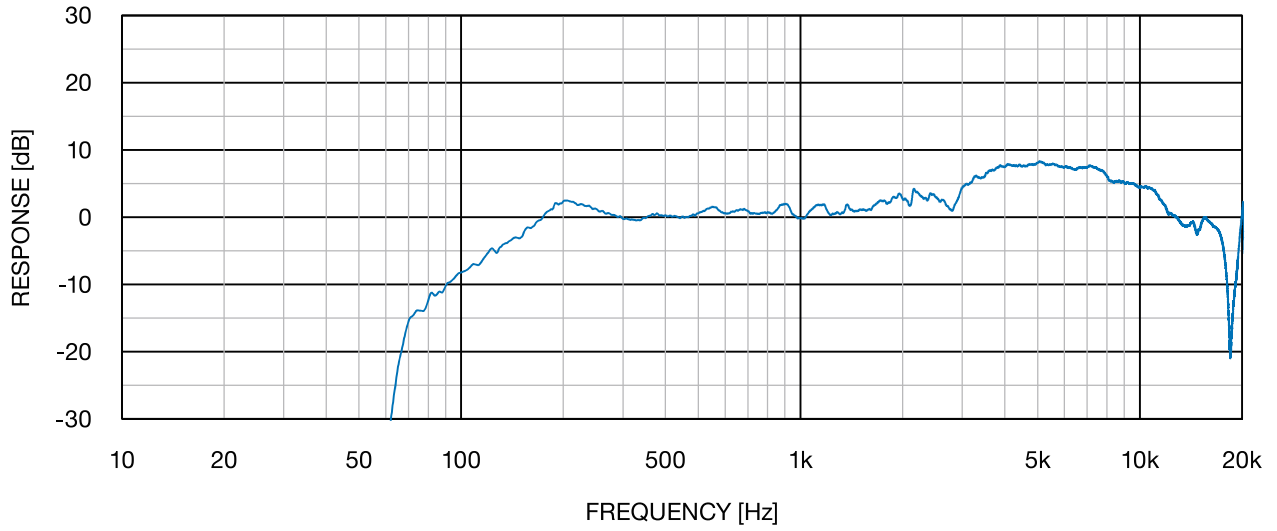

### 1/3 octave band

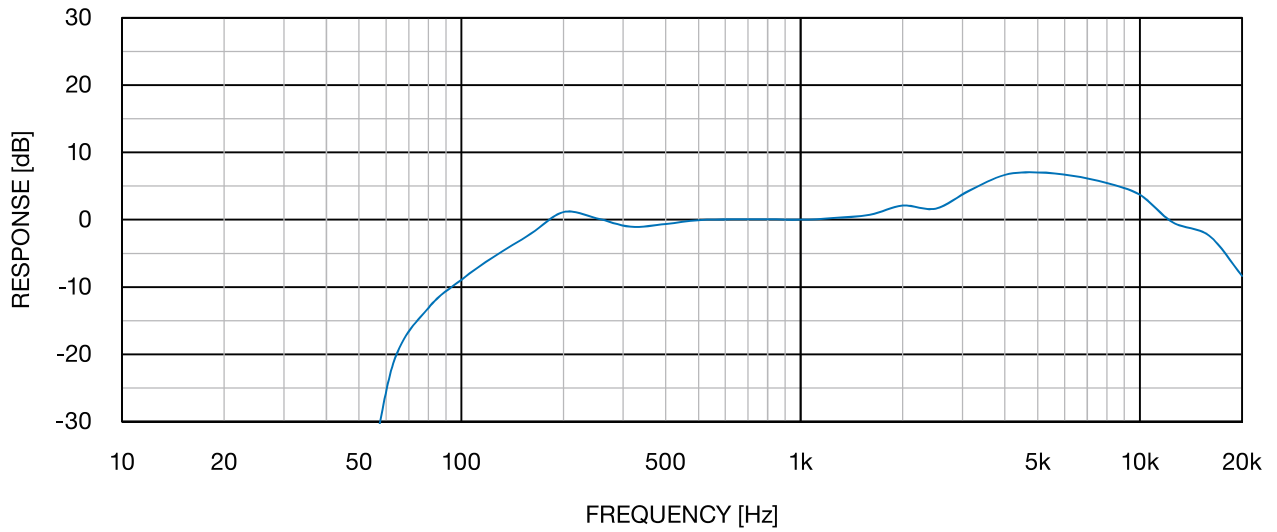

## Directional Characteristics

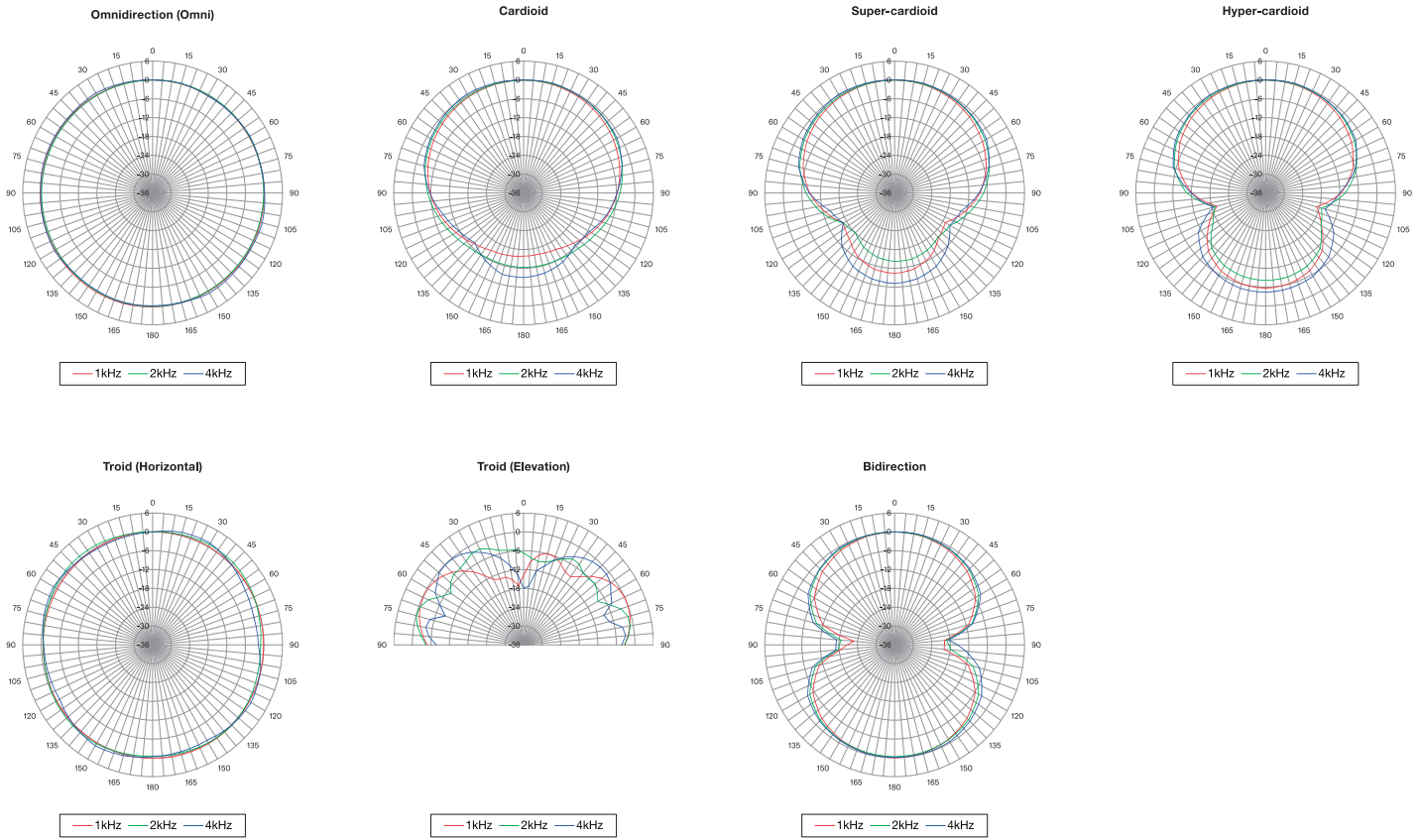

\*All information subject to change without notice.

\*All trademarks and registered trademarks are property of their respective owners.

Created in February, 2021