



Ankle Ultra Cuffs

ASP Ankle Cuffs are the first forged aluminum frame leg restraints. They incorporate innovative design advances that were pioneered by ASP. Lightweight, round smooth edges, interchangeable Lock Sets, conical bows, double sided keyways. Added to these revolutionary design elements is a frame that is forged from 7075 T6 ordnance grade aluminum and permanently joined by 4140 heat treated spiral locking pins. A hand welded stainless steel connecting chain incorporates a centered transport ring. The result is an ankle restraint that has been called the most significant advance in restraint technology of this century.

This is a leg restraint that was designed in the field. Input came from officers and instructors in over 100 nations where ASP currently conducts training. As a result, this ASP design incorporates the practical features most requested by officers on the street.

A flat contact bow improves application. Steel bows are highly radiused to prevent injury. There is a keyway and double lock slot on each side of each restraint. A double lock warning bar is readily visible. Both double and single locks are released by turning the key in a single direction. The lock assemblies are unitized and replaceable. The frame geometry, deep set teeth and precision smooth action eliminates the need for back loading.

Ankle Cuffs employ innovative technologies that are available only from ASP. These are full featured restraints that were specifically designed to "Lighten the Load" of the officer or agent. They provide exclusive features that increase both performance and safety.

- Forged Alloy Frame
- 7075 T6 Aluminum
- Hardcoat Anodized
- Double Sided Keyway
- Replaceable Lock Set



Ankle Ultra Cuffs . . . Integrated Safety

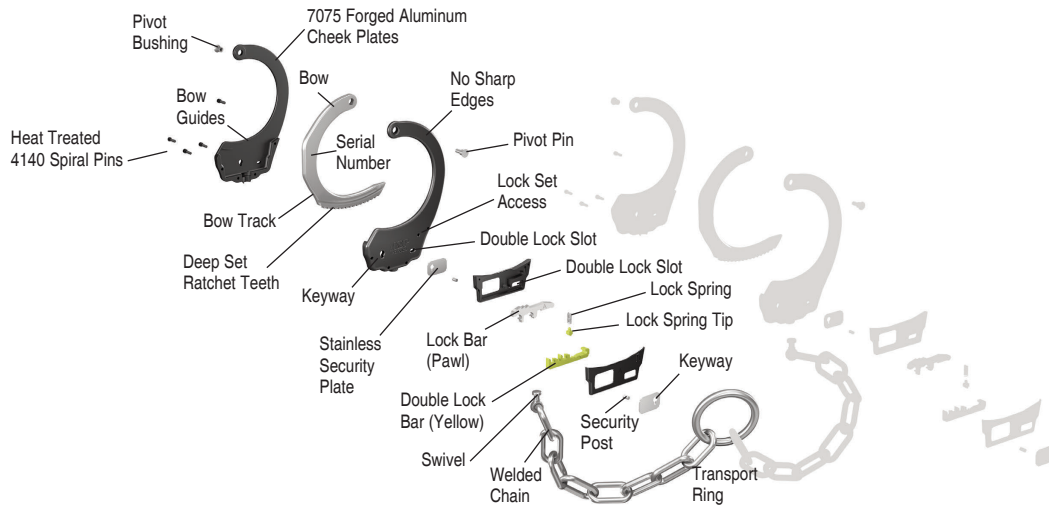

Background

- Precision forged
- High contact face
- No sharp edges
- Lightweight
- Interchangeable Lock Sets
- Recessed keyway
- Two-sided double lock
- Double lock indicator (colored)
- Two-sided lock release
- One-direction single and double lock release

Specifications

Length	26"	660.4 mm
Width	3.8"	98.4 mm
Weight	14.7 ounces	417.3 grams
System	Replaceable Lock Set	
Construction	Forged aluminum	
Edge Radius	.035" minimum (1 mm)	

Frame

- Computer designed
- Precision forged
- Bow guides
- Beveled keyways
- Hardcoat anodized

Chain Link

- Stainless steel chain
- Free rotating swivel

Lock Set

- Replaceable
- Dual keyways
- Stainless security block
- Stainless security posts
- Dual double lock slots
- Color coded double lock indicator
- Dual release lock bar (pawl)
 - One pawl (Yellow)
 - Two pawl (Blue)
 - Three pawl (Green)
 - Slip pawl (Red)

- Single spring double lock bar
- Hardened keyways

Bow

- Conical geometry
- Integral frame track
- Deep set teeth
- High contact face
- Serial numbered
- Stainless pivot pin

Warranty

- Limited Lifetime



Rigid Ultra Cuffs provide linear and lateral security.



TRANSPORT PLUS (CHAIN)



TRANSPORT PLUS (BELT)



ANKLE CHAIN



ANKLE BELT



Kwik Key® handcuff keys are back set, precision machined and heat treated.



"Protecting Those Who Protect"