

MG-3, Ram Mount Milling Machine Guard Installation

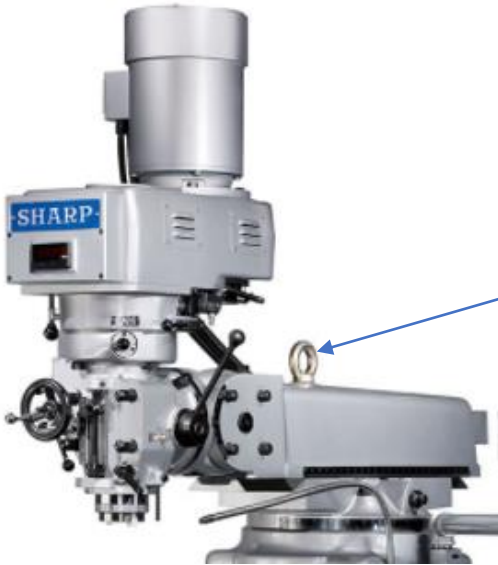
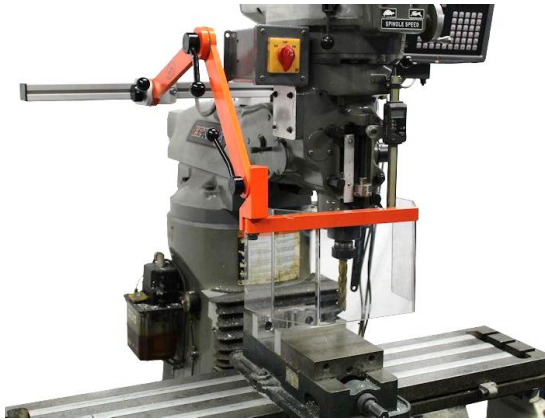

Step 1: The guard will install where the lifting eye bolt is on the top of the ram. If there is still an eye bolt in there, remove it.

Step 2: Install the horizontal ram mount assembly exactly as shown. **THE UPPER SPACER PLATE ALWAYS NEEDS TO BE INSTALLED, EVEN IF NOT RUNNING A DIGITAL READOUT.** Tighten, but do not fully torque the large bolt until the guard is installed.

Note: The lower curved/contoured block is not always supplied. In the case of machines that have a flat top ram such as LAGUN, this is not supplied.

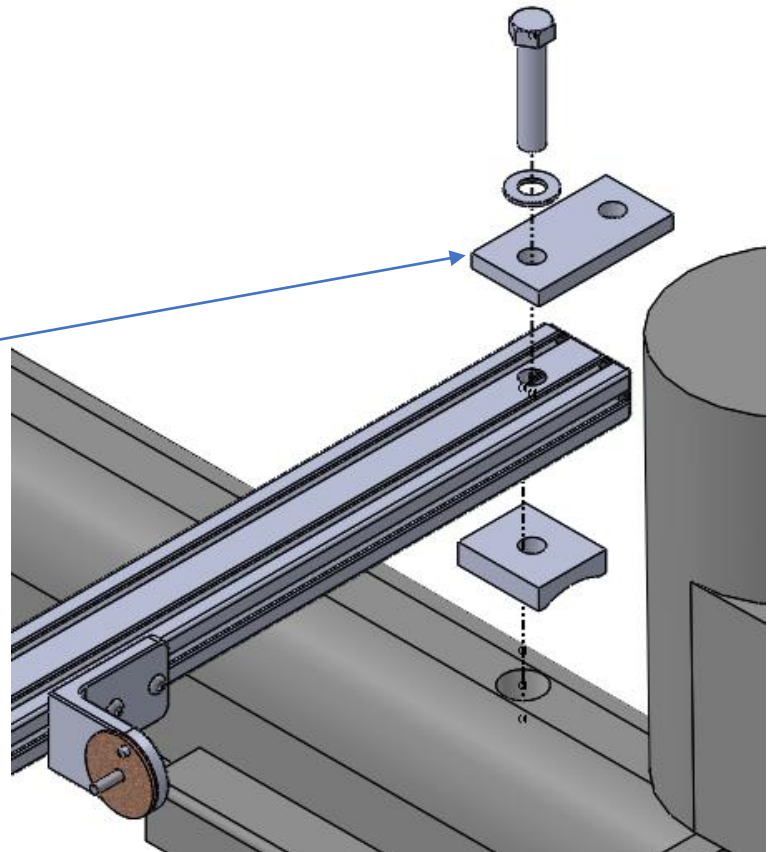

Step 3: Use a 13mm wrench or socket to loosen the angle mounting bracket and slide it to the end of the rail.

Step 4: Install the entire guard assembly as shown, over the leather washer. Install the metal washer on the outside of the orange arm, and then spin the handle on clock-wise until tight.

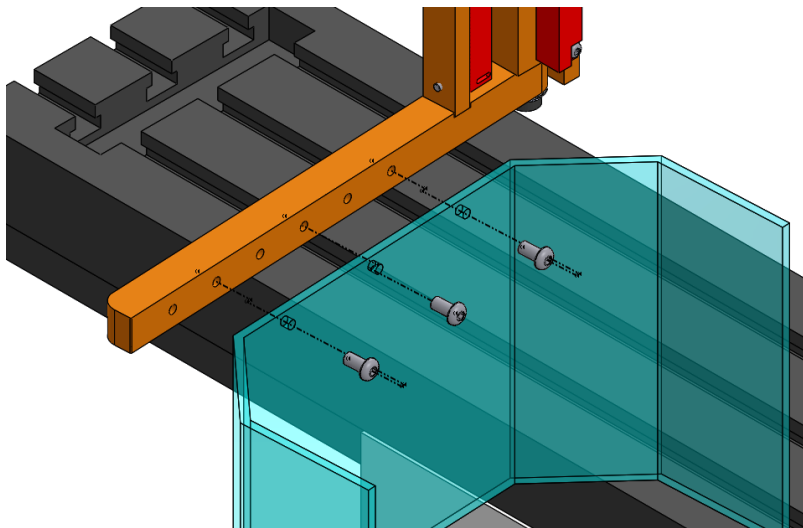
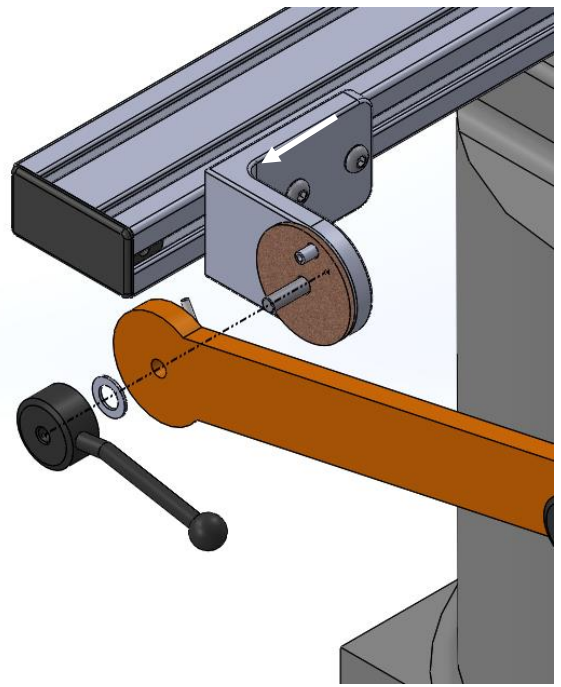

Step 5: Remove the protective film and install the shield using a 3/16" allen wrench. Note there are 2 sets of hole patterns to choose from.

Step 6: Slide the angle bracket from step 3 so that the guard's shield is now centered over the spindle and has adequate handle clearance. When satisfied, tighten the (2) hex head bolts with a 13mm wrench.

ATS
MACHINE SAFETY
SOLUTIONS

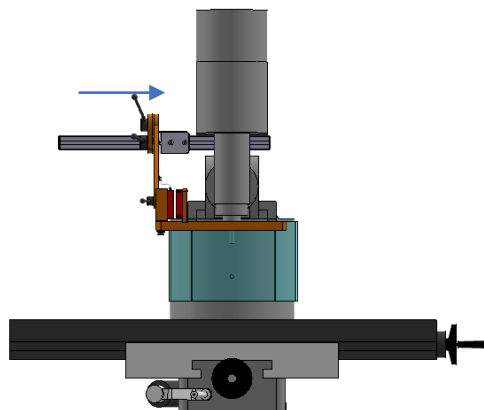

Step 7: With the guard closed, rotate the entire ram mount assembly until the orange front shield arm is square to the table of the machine.

Step 8: Torque down the large mounting bolt.

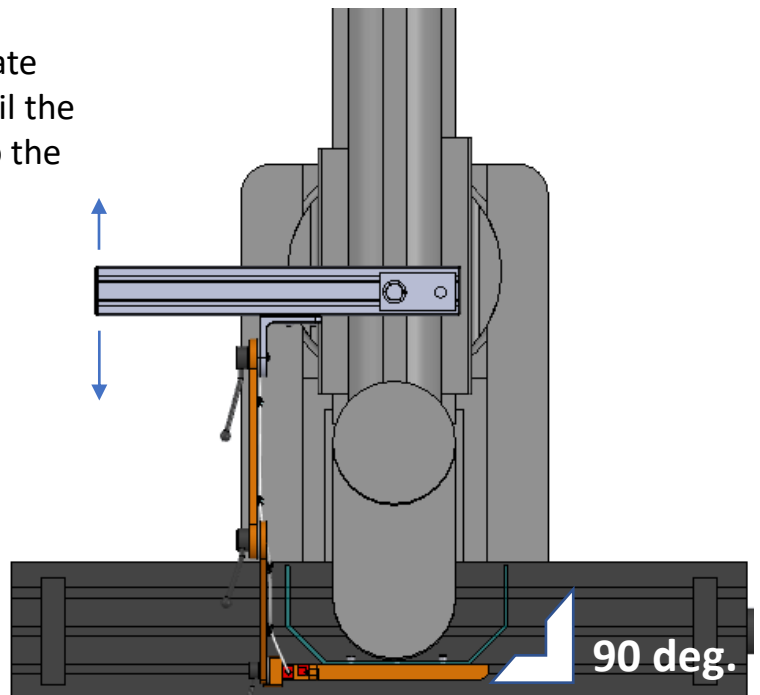

Step 9: Use the hole on the upper spacer bracket to install a digital readout or other accessory such as a light.

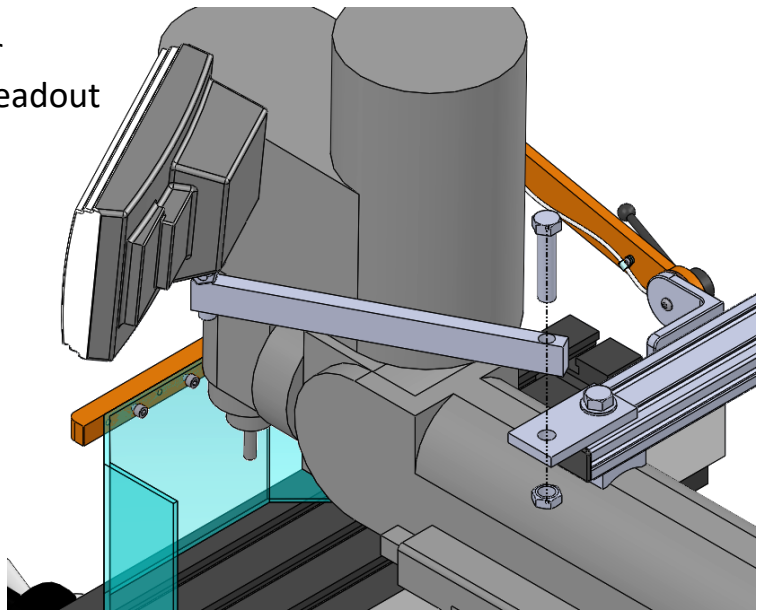

Shield Use

The shield with curved sides should be used whenever possible.

Adjust so the bottom is just above the vise, allowing the guard to swing open without hitting the vise or any obstruction.

If tilting the head left or right, or using an indexer on the table, then the flat shield must be used.

Positioning the shield

Never adjust guard while spindle is on!

If the table is raised up or down, a large part is on the table, etc, you will need to adjust the guard. Adjust so that the front arm is level in both planes.

Hold the pivot block with one hand, and loosen all three handles. Position guard, and tighten handles. You may need to follow the step below and re-torque.

Handle Adjustment

Each steel handle can be rotated on splines while tight. This allows you to re-position them for easiest use (leverage). To do this, pull outward on them, and rotate 360 degrees.

