

Part Number: U1X-MFXX-CON-FP-X-MPCX

Effective Date: 7/15/2020

Product Description: Mating set of Type U Miniature Male and Female Thermocouple Connectors - Thermoplastic Design rated to 400°F (200°C)

Type U Male and Female Thermocouple Connectors

Pair of Miniature Flat Pin Design Thermoplastic Body Temperature Range -40 to 400°F (-40 to 200°C)

Washer Terminal Contacts accept Bare Wire from Fine 40 Gage to Rugged 20 Gage Diameter



ANSI - IEC Color CodE

Includes Silicone Rubber Wire Grommet with Hole and Slit for Ease of Use. Captive Style Connector Cap Screws

Stainless Steel Screws with Combination Head



evolution Sensors and Controls, LLC.

Thermocouple Connector Miniature Plastic Male Dimensions

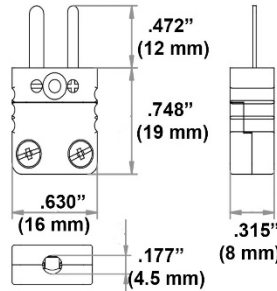

EvoSensors Part Number U1X-MALE-CON-FP-X-MPCX

evolution Sensors and Controls, LLC.

Thermocouple Connector Miniature Plastic Female Dimensions - Flat Pin Design

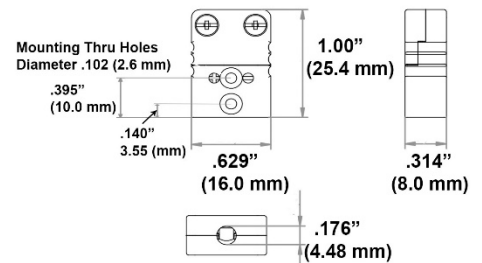

EvoSensors Part Number U1X-FEMX-CON-FP-X-MPCF

evolution Sensors and Controls, LLC.

Thermocouple Connector Type	U Calibration (positive + Copper and negative – Copper)
Connector Configuration	Miniature Size Male Plug and Female Jack/Socket with Flat Pins
Temperature Operating Range	-40 to 400°F (-40 to 200°C)
Connector Body Material	Glass Filled Engineered Thermoplastic
Maximum Wire Diameter	.032" (20 Gage Solid AWG or 0.8 mm) Diameter
Thermocouple Terminal Connections	
Terminal Connections Design	Clamp Washers with Stainless-Steel Screw design with Combination Head accepting Straight Slot or Phillips Head Screwdriver
Maximum Cable Entrance Diameter	.180" (4.5 mm) Diameter
Connector Cap Screw Design	Stainless-Steel Screws <i>Captive</i> design with Combination Head accepting Straight Slot or Phillips Head Screwdriver
Included Accessories	Silicone Rubber Wire Grommet for Cable Entrance
Weight	As set 0.5 ounces (14 grams)
Color Coding	ANSI and IEC - White
RoHS Status	Compliant to RoHS 2 and 3 directives