



STUMP GRINDER ASSEMBLY GUIDE
MODEL: OPG888E
14IN 12 TEETH 14HP ELEC START



DETAIL K2 INC.

DK2 POWER USA
4301 S Valley View Blvd STE 10-11
Las Vegas, NV 89103
1-702-331-5353

DETAIL K2, INC.
1080 Clay Avenue Unit 2
Burlington, Ontario, Canada L7L0A1

DK2 USA EAST
6245 Industrial Parkway
Whitehouse, OH 43571

PARTS AND SERVICE 702-331-5353 OR WWW.DK2POWER.COM CONTACT US

14HP 12 TEETH

1 SEC RAM SPEED
ATV TOWABLE
KOHLER ENGINE



OPG888E 14HP 12 TEETH ELECTRIC START STUMP GRINDER

STEP 1:

Open and unpack all items. Leave lots of working space.
Inspect all parts.
The STUMP GRINDER is shipped in a crate. Remove all sides
before you begin.



NOTE: UPON INSPECTION OF PARTS IF YOU FIND ANY DAMAGE OR MISSING PARTS PLEASE CALL DK2 POWER AT **702-331-5353** OR CONTACT US VIA OUR WEBSITE WWW.DK2POWER.COM
WE WILL REPLACE ANY MISSING PARTS TO YOU FREE

PLEASE DO NOT RETURN TO THE STORE

STEP 2:

1. Install both wheels on the axel and secure semi tight with lock nut. Allow wheel to spin freely.
2. The wheel with the large brake disk mounts on the same side as the belt drive.

BRAKE WHEEL MOUNTS ON THIS SIDE OF GRINDER



STEP 3:

1. Install the TOW BAR and LOCK PIN.
2. UNIVERSAL TOW BAR WITH TROLLEY WHEEL
3. TROLLEY WHEEL DOWN OR REVERSE WITH HITCH DOWN FOR TOWING.



STEP 4:

1. Install the handle base
2. Use the 4 bolts and hardware provided



STEP 5:

1. Install the BOW HANDLE
2. Use the long bolt and the spin handle provided
3. Align the teeth and tighten



READ THE KOHLER ENGINE MANUAL SUPPLIED WITH YOUR UNIT FOR FULL ENGINE OPERATION, SAFETY, AND MAINTENANCE.



YOUR UNIT HAS A COMMERCIAL KOHLER ENGINE WITH A 3YR PARTS AND SERVICE WARRANTY. FOR WARRANTY IN YOUR AREA CONTACT THE NEAREST KOHLER DEALER.

VISIT WWW.KOHLERENGINES.COM FOR PARTS, SERVICE, MANUALS, AND DEALER LOCATIONS.

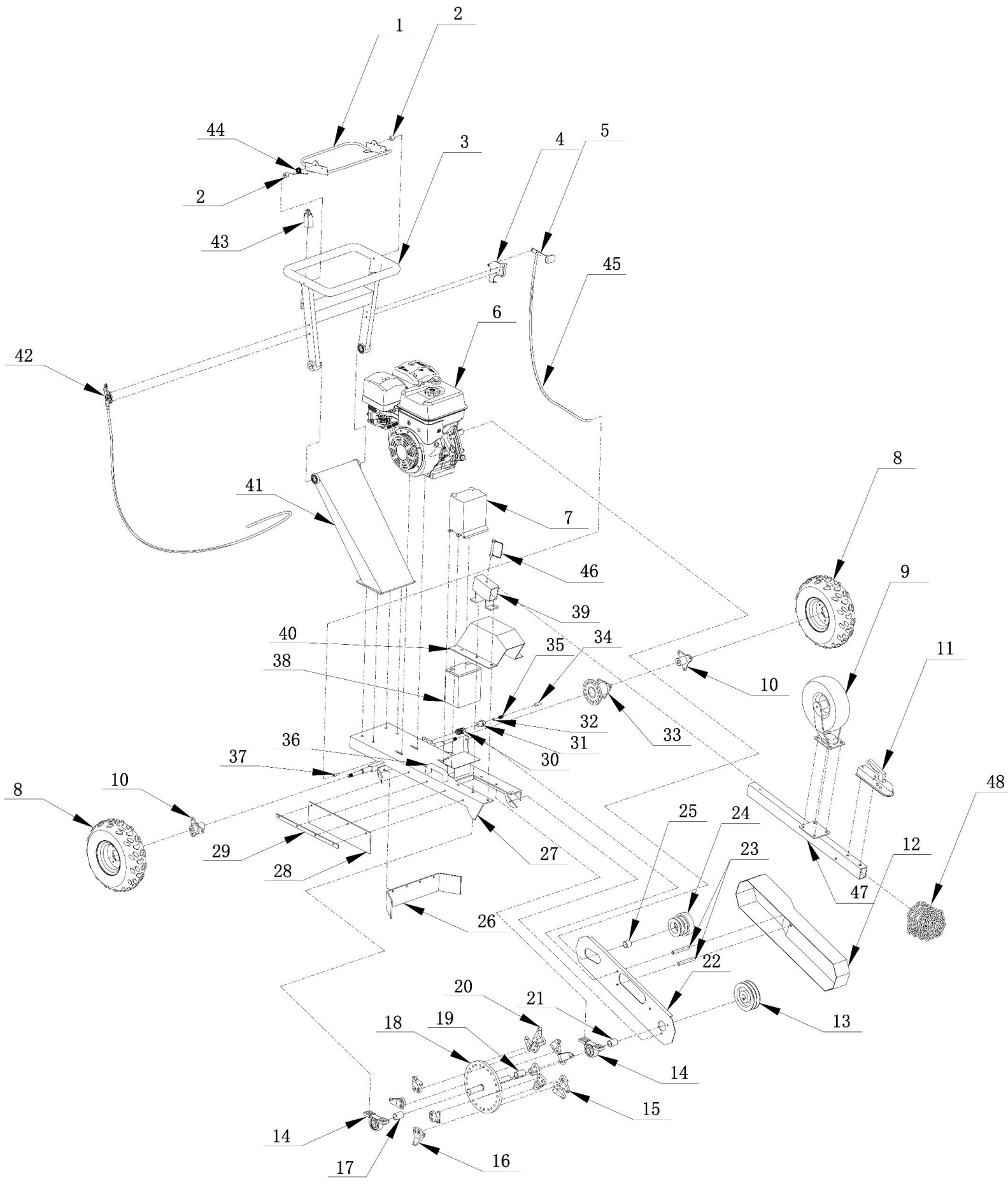

Ref	Description	Ref	Description
1	Stop frame	25	Clutch spacer
2	Spacer bush	26	8 holes rubber
3	Top handrail	27	Main frame
4	Brake line fixed block	28	4 holes rubber
5	Brake line fixing piece, plastic handle	29	4 holes rubber fix
6	Engine	30	External compression spring
7	Plastic battery box	31	Pin retaining sleeve
8	Tire	32	Brake cable limit plate
9	Universal wheel	33	The brake chuck
10	Flange	34	The brake pin
11	Tow hitch	35	Internal compression spring
12	Belt cover	36	Main frame handle
13	Cutter belt wheel	37	Brake line adjusting bolt
14	Bearing	38	Battery
15	Stright blade	39	Trailer rod holder
16	Right blade	40	The knife cover
17	Plate spacer right	41	Bottom handrail
18	Plate	42	Throttle cable
19	Plate spacer right	43	Stop switch
20	Left blade	44	Torsion Spring
21	Plate pulley spacer	45	Brake cable
22	Inner belt cover	46	Tow bar Pin
23	Belt cover spacer	47	Tow bar
24	Clutch	48	Chain

OPERATION – BEFORE TURNING KEY AND PULL STARTING ENGINE

CLEAR AREA OF ALL PEOPLE AND PROPERTY THAT COULD BE DAMAGED. THINK SAFETY. CHIPS ARE FLYING PROJECTILES AND CAN CAUSE INJURY.

WEAR SAFETY GLASSES, HEARING PROTECTION, AND GLOVES

DO NOT WEAR LOOSE FITTING CLOTHES THAT COULD GET STUCK IN THE MACHINE MOVING PARTS, ONLY CHIP WOOD, CHILDREN SHOULD NOT RUN THIS EQUIPMENT, STAY ALERT OF YOUR SURROUNDING AND PERSONS THAT COULD APPEAR IN THE CHIP PATH WHILE YOU ARE WORKING.

UNIT IS A DIRECT DUAL BELT DRIVE. NO CLUTCH TO SLIP OR BURN UP BUT YOUR BELTS WILL NEED TIGHTENED AND CHECKED ON A REGULAR BASIS TO MAINTAIN 100% CUTTING POWER.

- Tip the Stump Grinder up with the cutters off the ground when pull starting.

12 CARBIDE CUTTERS 14 IN DIAMETER WHEEL FOR COMMERCIAL PERFORMANCE

SET THE BRAKE TO PIVOT ON WHEEL WHILE GRINDING. APPROACH STUMP FROM THE TOP, CUTTING STRAIGHT DOWN INTO THE STUMP WITH THE 3.5 INCH WIDE CUTTING TEETH. RAISE UP OUT OF THE CUT, MOVE OVER, PLUNGE AGAIN. REPEAT ACROSS ENTIRE STUMP. MOVE SIDE TO SIDE TO FACE OFF THE STUMP. ADJUST YOUR BOW HANDLE FOR COMFORT.

TIGHTEN ALL BOLTS AND TEETH BEFORE EACH USE. TEETH ARE NOT COVERED UNDER WARRANTY. CLEAN ALL STONES AND ROCKS AWAYS FROM CUTTING STUMP AREA, CHECK FOR METAL STAKES AND OR NAILS IN THE TREE STUMP BEFORE CUTTING.

KOHLER ENGINES HAVE A LOW OIL SHUTOFF TO PROTECT THE ENGINE, TILTING THE GRINDER MORE THAN 29 DEGREES ANGLE CAN CAUSE THE OIL TO ROLL BACK AND THE LOW OIL SENSOR WILL SHUT THE ENGINE OFF. CUT YOUR STUMP 9 TO 10 INCHES OFF THE GROUND SO YOU DON'T TRIP THE SENSOR ON THE ENGINE. READ AND OBEY ALL WARNING LABELS ON THIS MACHINE.

REMOVE THE UNIVERSAL TOW BAR WITH TROLLEY WHEEL WHEN GRINDING.



PLEASE DO NOT RETURN TO THE STORE

YOU HAVE A 1 YEAR WARRANTY AND DK2 WILL REPLACE A DEFECTIVE PART FOR FREE

CALL US AT 702-331-5353 FOR FAST WARRANTY PARTS AND QUESTIONS

WHAT IS COVERED

DK2 Inc. warrants to the original purchaser of any DK2 product that it will be free and clear of manufacturing defects in workmanship and materials under normal use and service for a period of one (1) year from the date of the original purchase.

If within one (1) year from the original date of purchase this product fails due to defect in material or workmanship. DK2 POWER outdoor power equipment is 1-year parts only warranty no labor.

Upon expiry of one (1) year, Detail K2 will have no further liability related to the product. Detail K2 does not authorize any party, including its authorized distributors or dealers, to offer any other warranty on behalf of Detail K2 Inc.

KOHLER ENGINES – KOHLER CH SERIES ENGINES COMMERCIAL 3 YR PARTS AND LABOR WARRANTY

see your Kohler manual for specific warranty.

DIESEL TRACTORS – Chassis component parts only, no labor, ENGINES – 1 YR KOHLER WARRANTY

DK2 POWER OUTDOOR EQUIPMENT – 1-Year parts only, no labor.

THIS WARRANTY DOES NOT COVER OR APPLY TO:

Damage to the product due to misuse, mishandling and abuse

(b) Improper installation, maintenance and storage

(c) Expendable parts such as nuts and bolts, pins and springs, wiring and switch components, hydraulic hoses and fittings, cutting teeth, cutting chains, cutting blades, throttles, belts and tires.

(d) Normal wear and tear

(e) Consequential damage & incidental damages such as damage to persons or property

PROCEDURE FOR OBTAINING AN RETURN AUTHORIZATION

Within the one (1) year warranty period, the purchaser of the product must notify DK2 of the claimed defect and provide proof of original purchase. At this time the validity of the claim will be determined, and if approved replacement parts will be issued.

No returned product will be accepted under warranty unless accompanied by an RGA# issued by Detail K2 Inc.

RESOLUTION FOR A DEFECTIVE PRODUCT

DK2 POWER – Tractors, Chippers, Stump Grinders, Log Splitters, and Outdoor Power Equipment.

Call DK2 at **702-331-5353** in Las Vegas between 8am-4pm M-F Pacific Time.