

3.5L Humidifier User Manual

READ AND SAVE THESE INSTRUCTIONS

Inspect Unit Before Use.

Contact support@upperechelonproducts.com
immediately for any damaged or defective units.

IMPORTANT

DO NOT leave the humidifier plugged in for prolonged periods (i.e. several days or more) without use.

This causes premature failure of the circuitry.

When the humidifier is not in use, turn the control knob until the light goes off, then UNPLUG it.

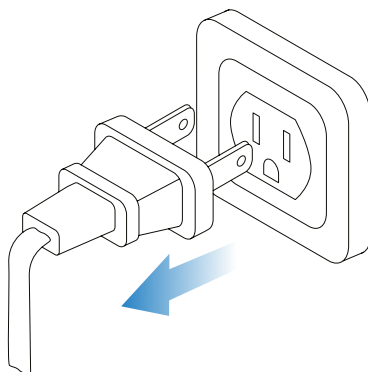
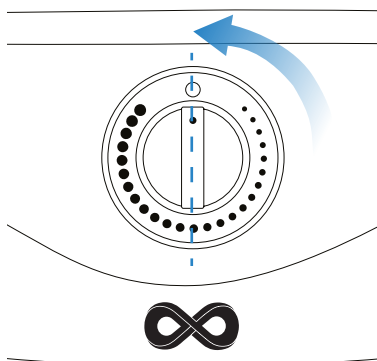

TABLE OF CONTENTS

1 COMPONENTS

2 SAFETY

3 OPERATING ENVIRONMENT

4 OPERATION

5 MAINTENANCE

6 TROUBLESHOOTING

7 SPECIFICATIONS

1. COMPONENTS

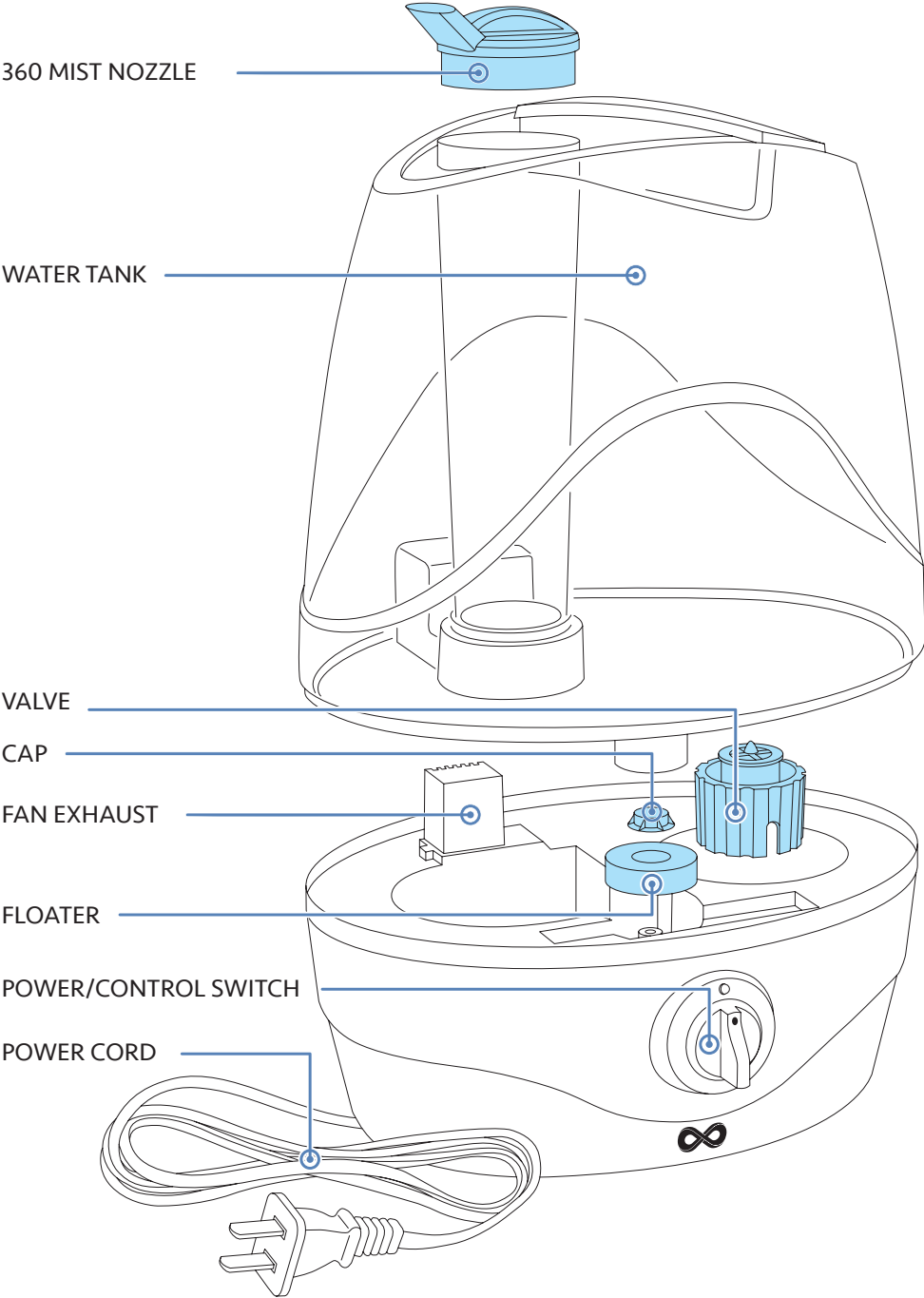

2. SAFETY

IMPORTANT

DO NOT leave the humidifier plugged in for prolonged periods (i.e. several days or more) without use. This causes premature failure of the circuitry.

When the humidifier is not in use, turn the control knob until the light goes off, then UNPLUG it.

- 1** Thoroughly inspect the unit in its entirety for any cracks, chips, or damage which could cause the unit to leak.
DO NOT USE if damage is found.
- 2** Do not plug the unit into any type of power source with wet hands to avoid the risk of electric shock. Connect only the electric plug to a secure wall socket.
- 3** If the unit has an abnormal sound or odor while in operation, please shut it down immediately and disconnect the power plug.
Any repairs must be done by a professional repairman.
- 4** Please hold the water tank using two hands when adding water to avoid dropping the water tank.
- 5** Take the Nozzle out of the plastic bag and put it on the unit before use. Avoid using Humidifier without the Nozzle.
- 6** Only a professional or authorized repairman should repair this appliance. If the power supply cord is damaged, it must be replaced by the manufacturer, a certified service agent or a similarly qualified person to avoid hazards and electrocution.
- 7** DO NOT operate the unit when the water tank is empty. Do not add any chemical agents to the base or water tank. Before cleaning or moving the unit, turn off and disconnect the plug from its power source. When in operation, never place your hand inside the base or near the atomizer as it is dangerous and may cause electrocution.
- 8** Never pour out the remaining water from the water base without unplugging and powering down the unit, otherwise, the atomizer will burn out causing risk of fire.
- 9** When the unit is on, DO NOT remove the water tank.

IMPORTANT

Using tap water with a high mineral content (aka "hard water") with any humidifier can cause a fine white dust to be emitted. To avoid this, use distilled or demineralized water. Do not place any metals, chemicals or detergents into the water tank or base; it may cause poor atomization.

Never pour out the remaining water from the water base without unplugging and powering down the unit, otherwise, the atomizer will burn out causing risk of fire.

3. OPERATING ENVIRONMENT

- 1 This humidifier is intended for indoor use only.
- 2 Ideal operating environment: Temperature: 41-104°F, Humidity: <65% RH.
- 3 Place the unit on a firm, flat and dry surface. Avoid any inclination.

Place the unit away from electronics appliances such as TVs, computers and audio equipment.

- 4 Keep the humidifier away from children and infants.
- 5 DO NOT use this appliance in any kind of inflammable environment.
- 6 Keep the unit away from any heat source, i.e. heaters, furnaces, and avoid direct sunlight.
- 7 Keep the unit in normal room temperatures. Do not operate the unit in freezing temperatures.
- 8 Direct nozzle to spray mist away from furniture and electric appliances, as they may become damp or be left with a white powder-like residue.

- 1 Place the unit on a firm, steady, flat and dry surface. Avoid any inclination.

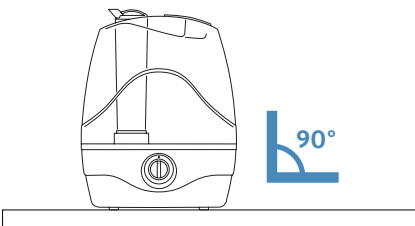

- 2 Place the unit away from electronics appliances such as TVs, computers and audio equipment.

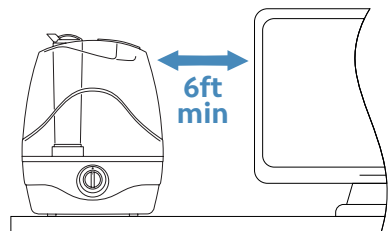

- 3** Keep the unit away from any heat source, i.e. heaters, furnaces, and avoid direct sunlight.

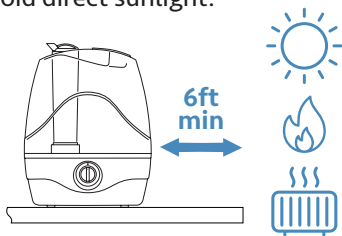

- 4** Do not place the unit near curtains.

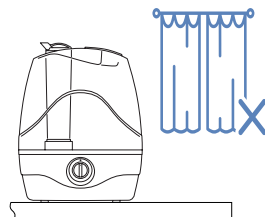

- 5** Unit must be placed at maximum of 12 inches from the surface on the side in which the nozzle is turned to, in order to avoid water pooling on the surface.

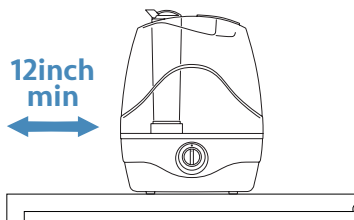

Please follow the recommendations in the illustrations on the next page to properly operate your humidifier in your home.

IMPORTANT

Using tap water with high mineral content (AKA "hard water") with any humidifier can cause a fine white dust to be emitted. To avoid this, use distilled or demineralized water in unit.

4. OPERATION

- 1** Set the unit to the off position by ensuring knob is turned completely off and take off the Nozzle.

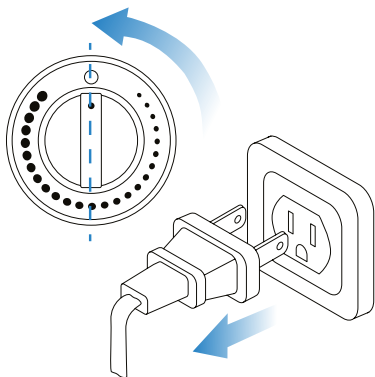

- 2** With both hands, lift the top of the unit off of the bottom base and flip it over, ensuring water does not drip from the bottom of the water tank.

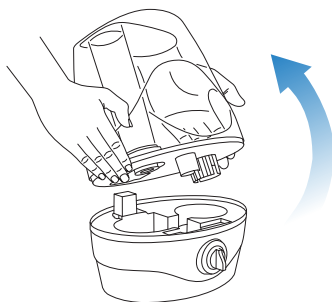

- 3** Twist open the water tank valve cover.

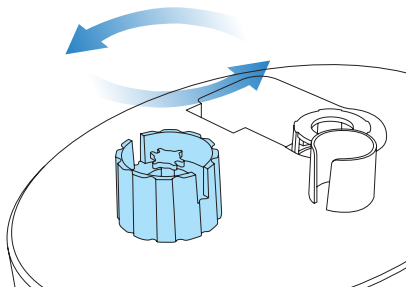

- 4** Fill the water tank with tap or distilled/demineralized water.

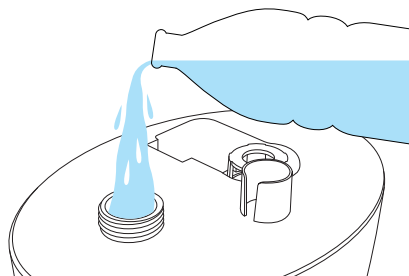

- 5** Reattach the water tank valve cover by twisting it on tightly and reposition the water tank over the humidifier base ensuring the base and top align correctly.

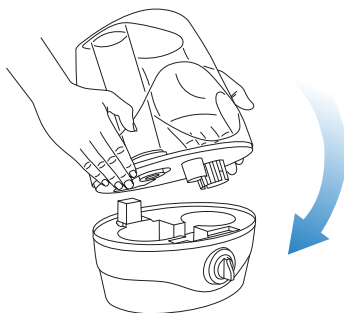
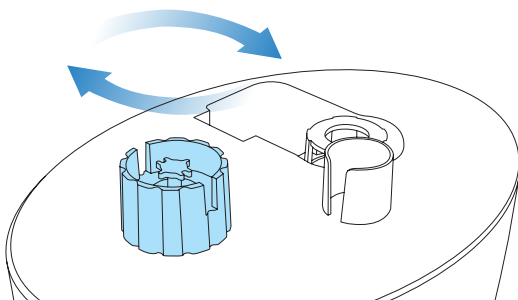

5. MAINTENANCE

IMPORTANT

DO NOT leave the humidifier plugged in for prolonged periods (i.e. several days or more) without use. This causes premature failure of the circuitry.

When the humidifier is not in use, turn the control knob until the light goes off, then UNPLUG it.

WARNING

Before performing any type of maintenance and cleaning, be sure to unplug the unit from its power source.

CLEAN THE WATER TANK (ONCE EVERY 2-3 WEEKS)

Turn unit OFF and unplug from the wall socket.

WARNING

Use both hands to lift entire base and tilt to one side to pour water out.

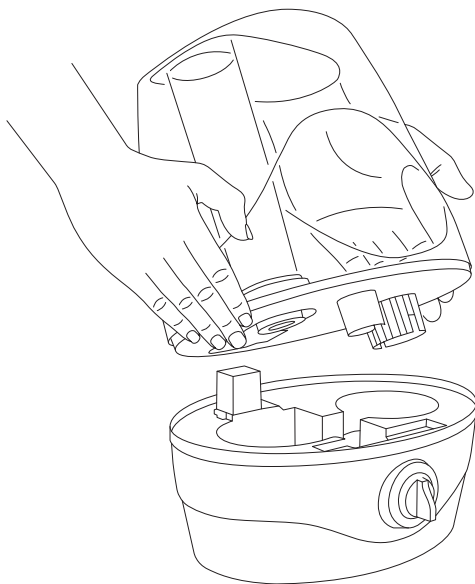

Drain any remaining water from the base and let it dry. Use mild dish soap and water to clean the base. Only pour water into the base using a cup, never directly from a faucet. Never place the base under running water as this could cause water flow to reach the motor located at the bottom of the base or the air outlet. Stains on the base should be wiped with a brush after soaking in warm water and then gently wiped with a dry cloth. Use cotton swabs when cleaning air outlet. Never place the base under running water as this could cause water flow to reach the motor located at the bottom of the base.

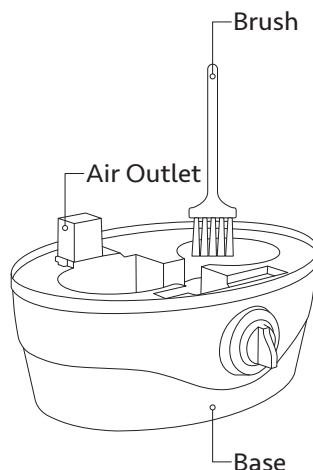

EXTERNAL CLEANING OF HUMIDIFIER

Rinse soft cloth in warm water below 104°F, add a small amount of mild dish soap to soft cloth, and wipe off any surface stains.

6. TROUBLESHOOTING

IMPORTANT

DO NOT leave the humidifier plugged in for prolonged periods (i.e. several days or more) without use. This causes premature failure of the circuitry.

When the humidifier is not in use, turn the control knob until the light goes off, then UNPLUG it.

PROBLEM	PRIMARY CAUSE	SOLUTION
Indicator light not illuminated with no mist.	Power supply cord is not properly plugged into wall socket. Power switch is not turned on.	Plug the power supply cord into a wall socket. Rotate knob clockwise to power on.
Indicator light is red with no mist.	A. There is no water in the tank. B. Atomizer is dirty or floater is missing or stuck to the bottom. C. Unit was turned on too quickly when tank was attached to the base. D. Unit reset needed.	A. Add water to tank. B. Clean base, atomizer, and floater according to section 6 Maintenance. Check to make sure floater is not stuck to the bottom. With the unit UNPLUGGED, add enough water directly to the base and make sure the floater floats. C. Turn the control knob to the OFF position and wait 10 seconds before turning back on. D. Turn the control knob to OFF position. Unplug the unit from the wall and wait 2 mins. Plug the unit back into the wall, fill the water tank with water, and turn the control knob to the ON position.

	E. Too much moisture/humidity in circuit board.	E. Unplug unit from the wall. Empty base of all water, dry with a towel, turn upside down, and let dry for 24 hours.
Indicator light is working (yellow, blue, or green lights) with little or no mist.	Atomizer is dirty.	Clean the base and atomizer according to the Maintenance section.
Mist has a bad odor.	The water, tank, or base is not clean.	Clean the base and atomizer according to the Maintenance section.
Humidifier is emitting a white dust/residue.	Use of tap water with a high mineral content, aka "hard water."	Clean tank and base and use only demineralized or distilled water.

7. SPECIFICATIONS

Model No.	XS-HUM
Voltage	120V 60Hz 24W
Capacity	3.5L
Material	ABS
Noise	< 35db
Maximum Mist output	250ml/H
Certification	CSA STD. C22.2 No. 104

HAVE AN ISSUE WITH YOUR 3.5L HUMIDIFIER?

Enjoy hassle-free replacements: if your 3.5L Humidifier is defective or damaged, we will ship you a new one ABSOLUTELY FREE.

For fast and knowledgeable service, get in touch with one of our customer service experts right now!



everlastingcomfort.net



+1 787-270-7661



support@upperechelonproducts.com

WRITE A MESSAGE
TO SUPPORT

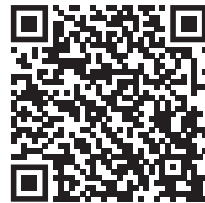

To check out more of the products we offer visit:

everlastingcomfort.net



Intertek

4003798

