

EFFECTIVE:
06-MAR-13

SUPERSEDES:
28-JUN-11

HORIZONTAL MOTORS

TEFC

FRAME: 56C
BASIC TYPE: UTF

PRINT:
07-1842

SHEET:
1 OF 1

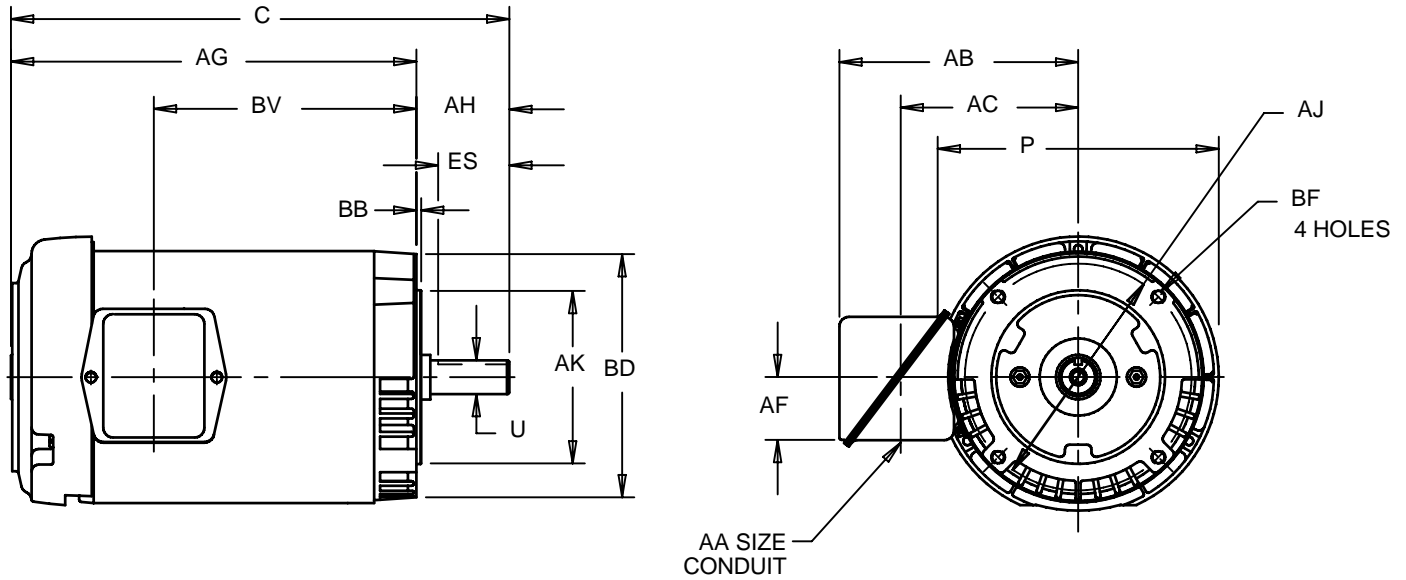

ALL DIMENSIONS ARE IN INCHES AND MILLIMETERS

UNITS	C	P ²	U	AA	AB	AC	AF	AG	AH	AJ
IN	12.06	7.31	.6250	.75	6.09	4.47	1.59	10.00	2.06	5.875
MM	306	186	15.875		155	114	40	254	52	149.23

UNITS	AK	BB	BD	BF ³	BV	ES	SQ
	-.003	MIN	MAX			MIN	KEY
IN	4.500	.13	6.50	3/8-16 X .75	6.16	1.53	.188
MM	114.30	3	165		156	39	4.78

- 1: ALL ROUGH DIMENSIONS MAY VARY BY .25" DUE TO CASTING AND/OR FABRICATION VARIATIONS.
- 2: LARGEST MOTOR WIDTH.
- 3: TAP SIZE AND BOLT PENETRATION ALLOWANCE.
- 4: ALL TAPPED HOLES ARE UNIFIED NATIONAL COARSE, RIGHT HAND THREAD.
- 5: CONDUIT BOX MAY BE LOCATED ON EITHER SIDE OF MOTOR. CONDUIT OPENINGS MAY BE LOCATED IN STEPS OF 180° REGARDLESS OF LOCATION. STANDARD AS SHOWN WITH CONDUIT OPENING DOWN.
- 6: TOLERANCES SHOWN ARE IN INCHES ONLY.
- 7: FRAME REFERENCE: 6.750"/56

07-1842/E

Nidec Motor Corporation
St. Louis, Missouri

INFORMATION DISCLOSED ON THIS DOCUMENT IS CONSIDERED PROPRIETARY AND SHALL NOT BE REPRODUCED OR DISCLOSED WITHOUT WRITTEN CONSENT OF NIDEC MOTOR CORPORATION



ISSUED BY
R. KING
APPROVED BY
J. O'BRIEN

IHP_DP_NMCA (MAR-2011) SOLIDEDGE