

EFFECTIVE:
17-OCT-14

DIMENSION PRINT

TEFC

PRINT:
07-2135-16

SUPERSEDES:
NEW

FRAME: 360T
BASIC TYPE: CT

SHEET:
1 OF 1

F-2 ASSEMBLY POSITION

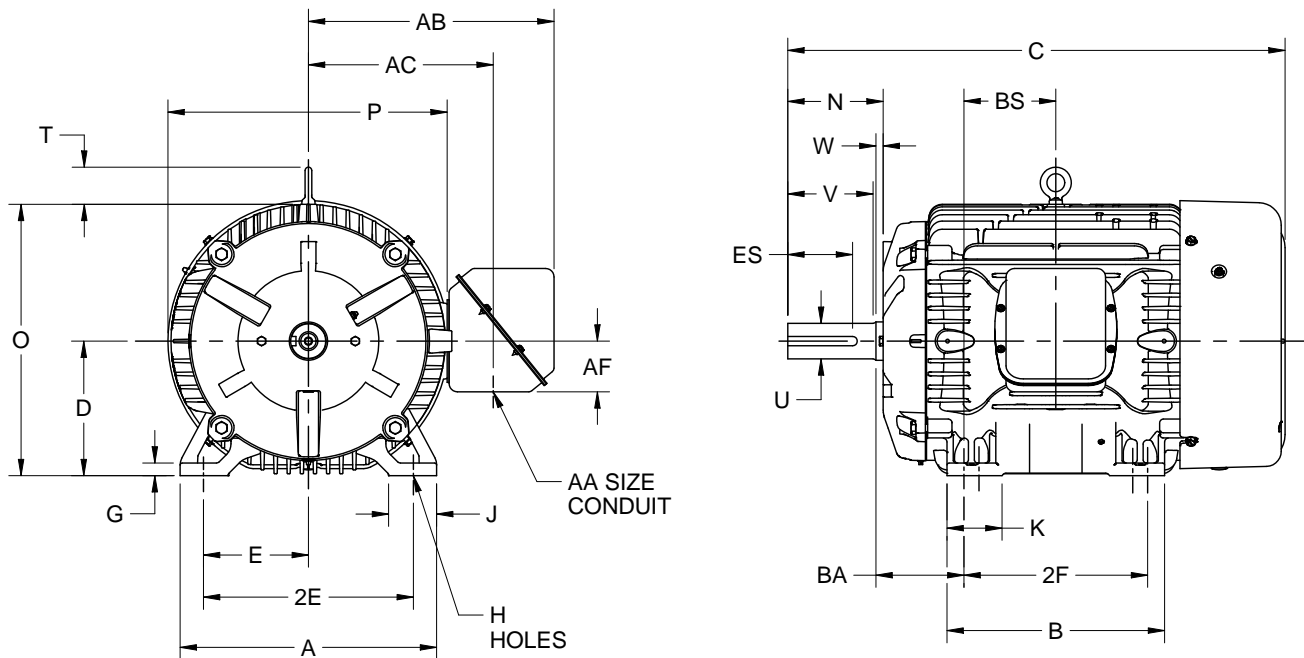

ALL DIMENSIONS ARE IN INCHES AND MILLIMETERS

UNITS	A	B	C	D -.06	E	2E ±.03	G	H +.05	J	K	N
IN	17.13	14.50	32.94	9.00	7.00	14.00	.81	.66	3.25	3.63	6.38
MM	435	368	837	229	178	356	21	17	83	92	162

UNITS	O	P ²	T	U -.001	V MIN	W	AA	AB	AC	AF	BA ±.09
IN	18.13	18.75	2.50	2.375	5.62	.50	3.00	16.38	12.19	3.38	5.88
MM	460	476	64	60.33	143	13		416	310	86	149

UNITS	BS	ES MIN	SQ KEY
IN	6.13	4.28	.625
MM	156	109	15.88

FRAME	UNITS	2F ±.03
364T	IN	11.25
	MM	286
365T	IN	12.25
	MM	311

1. DIMENSIONS MAY VARY .25" DUE TO CASTING AND/OR FABRICATION VARIATIONS.
2. LARGEST MOTOR WIDTH
3. TOLERANCES ARE SHOWN IN INCHES.
4. CONDUIT BOX MAY BE LOCATED ON EITHER SIDE OF MOTOR. CONDUIT OPENINGS MAY BE LOCATED IN STEPS OF 90 DEGREES REGARDLESS OF LOCATION. STANDARD AS SHOWN WITH CONDUIT OPENING DOWN.

Nidec Motor Corporation
St. Louis, Missouri

INFORMATION DISCLOSED ON THIS DOCUMENT
IS CONSIDERED PROPRIETARY AND SHALL NOT BE
REPRODUCED OR DISCLOSED WITHOUT WRITTEN
CONSENT OF NIDEC MOTOR CORPORATION



ISSUED BY
M. YRISSON
APPROVED BY
F. LARA