

EFFECTIVE:
29-JAN-14

DIMENSION PRINT

PRINT:
07-2832-08

SUPERSEDES:
NEW

TEFC
FRAME: 254T, 256T
BASIC TYPE: CT

SHEET:
1 OF 1

F-2 ASSEMBLY POSITION

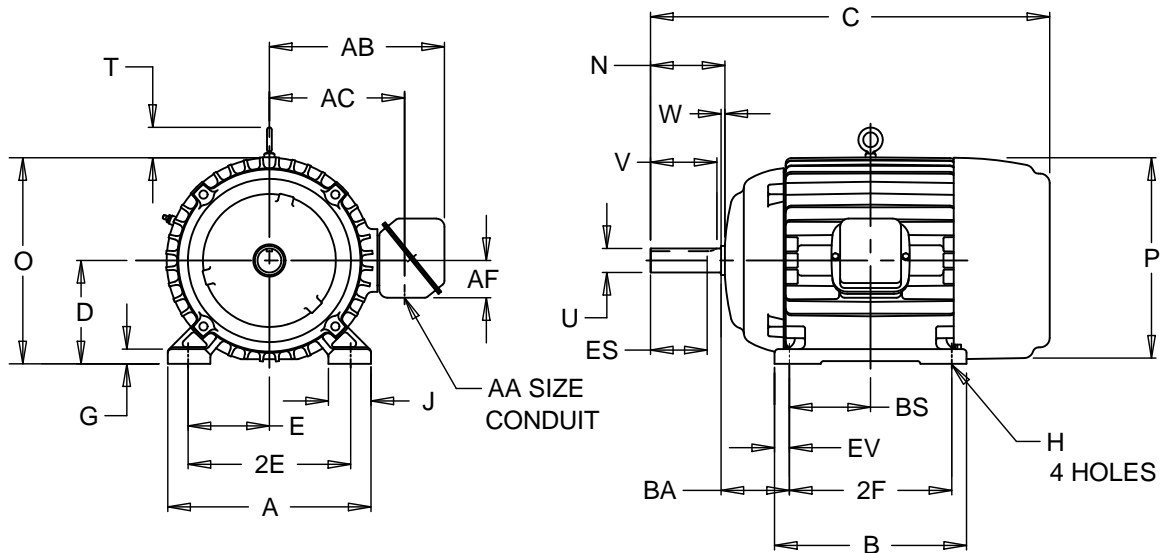

ALL DIMENSIONS ARE IN INCHES AND MILLIMETERS

UNITS	A	B	C	D -.06	E	2E ±.03	G	H +.05	J	N	O
IN	12.13	12.00	25.25	6.25	5.00	10.00	.88	.53	2.25	4.38	12.91
MM	308	305	641	159	127	254	22	14	57	111	328

UNITS	P ²	T	U -.001	V MIN	W	AA	AB	AC	AF	BA	BS
IN	14.22	2.03	1.625	3.75	.38	1.50	11.12	8.53	2.53	4.25	5.00
MM	361	52	41.28	95	10		282	217	64	108	127

UNITS	ES MIN	EV	SQ KEY
IN	2.91	1.00	.375
MM	74	25	10

FRAME	UNITS	2F ±.03
254T	IN	8.25
	MM	210
256T	IN	10.00
	MM	254

1: ALL ROUGH CASTING DIMENSIONS MAY VARY BY .25"
DUE TO CASTING AND/OR FABRICATION VARIATIONS.
2: LARGEST MOTOR WIDTH.
3: TOLERANCES SHOWN ARE IN INCHES ONLY.

4: STANDARD ASSEMBLY POSITION F-1 IS SHOWN F-2 IS PROVIDED
WHEN SPECIFIED. CONDUIT OPENINGS MAY BE LOCATED IN
STEPS OF 90 DEGREES REGARDLESS OF LOCATION.
STANDARD AS SHOWN WITH CONDUIT OPENING DOWN.

07-2832/A

Nidec Motor Corporation
St. Louis, Missouri

INFORMATION DISCLOSED ON THIS DOCUMENT
IS CONSIDERED PROPRIETARY AND SHALL NOT BE
REPRODUCED OR DISCLOSED WITHOUT WRITTEN
CONSENT OF NIDEC MOTOR CORPORATION



ISSUED BY
R. KING
APPROVED BY
J. HAGENE

IHP_DP_NMCA (MAR-2011) SOLIDEDGE