

VAR	MODEL	CATALOG NO.	A	FACTORY WIRED FOR	BASE REQUIREMENT
001	T63CXCMJ-1413	EU2002	12.874	HIGH VOLTAGE	NO
002	T63XCML-1415	EU3002	13.374	HIGH VOLTAGE	NO
003	T63XCMP-1418	EU2002B	12.874	HIGH VOLTAGE	REMOVABLE N56H
004	T63XCMP-1419	EU3002B	13.374	HIGH VOLTAGE	REMOVABLE N56H
005	T63ZCMMW-1422	EU1504	12.124	HIGH VOLTAGE	REMOVABLE STD N56

MODEL	REF	CUSTOMER	HP	VOLTS	AMPS	HZ	RPM	ROTATION	CUSTOMER PN		
REVISION RECORD FOR: C5177-20											
UPDATED BACKGROUND TO NIDEC.											
INFORMATION DISCLOSED ON THIS DOCUMENT IS CONSIDERED PROPRIETARY AND SHALL NOT BE REPRODUCED OR DISCLOSED WITHOUT WRITTEN CONSENT OF NIDEC MOTOR CORPORATION											
ALL DIMENSIONS ARE FOR REFERENCE ONLY UNLESS TOLERANCE IS GIVEN											
TITLE								CODE		ITEM NO.	
ASSEMBLED VIEW								V01		743808	
ISSUED BY								REVIEWED BY		ENGINEER APPROVED	
B. ANDRADE								J. I. SALAZAR		J. I. SALAZAR	
NIDEC MOTOR CORPORATION											
SIZE											
B											

NIDEC MOTOR CORPORATION 27-Mar-12

VAR	MODEL	CATALOG NO.	A	FACTORY WIRED FOR	BASE REQUIREMENT
006	T63CXCMY-1423	EU2004	13.624	HIGH VOLTAGE	REMOVABLE N56H
007	T63CXDPT-1885	-----	12.874	HIGH VOLTAGE	RIGID N56H

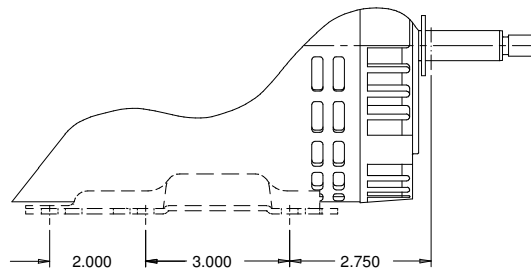

PARTIAL VIEW
SHOWING N56H BASE

MODEL	REF	CUSTOMER	HP	VOLTS	AMPS	HZ	RPM	ROTATION	CUSTOMER PN
REVISION RECORD FOR: C5177-20			INFORMATION DISCLOSED ON THIS DOCUMENT IS CONSIDERED PROPRIETARY AND SHALL NOT BE REPRODUCED OR DISCLOSED WITHOUT WRITTEN CONSENT OF NIDEC MOTOR CORPORATION						
SHEET NUMBER 2 of 2	REV C	UPDATED BACKGROUND TO NIDEC.		ALL DIMENSIONS ARE FOR REFERENCE ONLY UNLESS TOLERANCE IS GIVEN				NIDEC MOTOR CORPORATION	
REVISION DATE 27-MAR-12	ISSUED BY B. ANDRADE		REVIEWED BY J. I. SALAZAR	ENGINEER APPROVED J. I. SALAZAR		TITLE ASSEMBLED VIEW		CODE V01	ITEM NO. 743808
								SIZE B	

