

VAR	MODEL	CATALOG NO.	A	BASE REQUIREMENT
001	T63CXCPK-1454	EU11	13.347	REMOVABLE N56
002	T63MWCPL-1455	EU12	13.847	REMOVABLE N56H
003	T63CXCRA-1465	EU10	12.847	REMOVABLE N56
004	T63MWCTH-1518	—	13.847	REMOVABLE N56H

SHEET NUMBER	REVISION RECORD FOR: C5177-21		
1 OF 2	C	UPDATED BACKGROUND TO NIDEC.	
REVISION DATE			
27-MAR-12			
ISSUED BY	REVIEWED BY	ENGINEER APPROVED	
B. ANDRADE	J. I. SALAZAR	J. I. SALAZAR	

INFORMATION DISCLOSED ON THIS DOCUMENT IS CONSIDERED PROPRIETARY AND SHALL NOT BE REPRODUCED OR DISCLOSED WITHOUT WRITTEN CONSENT OF NIDEC MOTOR CORPORATION

NIDEC MOTOR CORPORATION

ALL DIMENSIONS ARE FOR REFERENCE ONLY UNLESS TOLERANCE IS GIVEN

TITLE

ASSEMBLED VIEW

CODE

V01

ITEM NO.

746888

SIZE

B

VAR	MODEL	CATALOG NO.	A	BASE REQUIREMENT

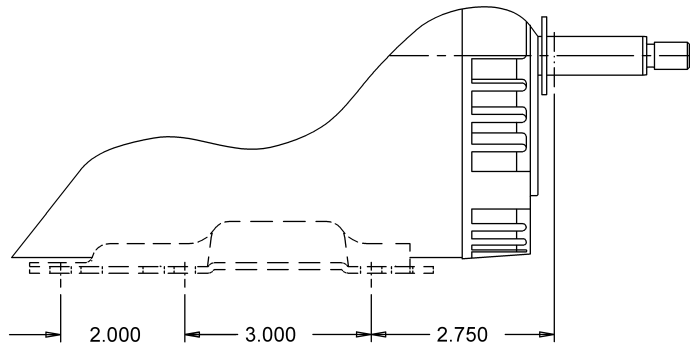

PARTIAL VIEW
SHOWING N56H BASE

SHEET NUMBER		REVISION RECORD FOR: C5177-21		
2 OF 2	C	UPDATED BACKGROUND TO NIDEC.		
REVISION DATE				
27-MAR-12				
ISSUED BY	REVIEWED BY	ENGINEER APPROVED		
B. ANDRADE	J. I. SALAZAR	J. I. SALAZAR		

INFORMATION DISCLOSED ON THIS DOCUMENT IS CONSIDERED PROPRIETARY AND SHALL NOT BE REPRODUCED OR DISCLOSED WITHOUT WRITTEN CONSENT OF NIDEC MOTOR CORPORATION

NIDEC MOTOR CORPORATION

ALL DIMENSIONS ARE FOR REFERENCE ONLY UNLESS TOLERANCE IS GIVEN

TITLE
ASSEMBLED VIEW

CODE
V01

ITEM NO.
746888

SIZE
B

