

VAR	MODEL	CATALOG NO.	A	FACTORY WIREWORK	BASE REQUIREMENT
001	C63CXHL-5000	EC1004B	11.623	HIGH VOLTAGE	STD N56
002	C63CXHLA-5010	EC1002B	11.873	HIGH VOLTAGE	STD N56
003	C63CXHLB-5011	EC0752B	11.623	HIGH VOLTAGE	STD N56
004	C63CXHLC-5012	EC0502B	11.123	LOW VOLTAGE	STD N56
005	C63CXHLF-5015	EC1004	11.623	HIGH VOLTAGE	NO
006	C63CXHKK-4999	EC0754B	10.873	HIGH VOLTAGE	STD N56

MODEL	REF	CUSTOMER	HP	VOLTS	AMPS	HZ	RPM	ROTATION	CUSTOMER PN	
REVISION RECORD FOR: C5177-20										
SHEET NUMBER 1 OF 2	REV C	UPDATED BACKGROUND TO NIDEC.			INFORMATION DISCLOSED ON THIS DOCUMENT IS CONSIDERED PROPRIETARY AND SHALL NOT BE REPRODUCED OR DISCLOSED WITHOUT WRITTEN CONSENT OF NIDEC MOTOR CORPORATION				NIDEC MOTOR CORPORATION	
REVISION DATE 27-MAR-12										
ISSUED BY B. ANDRADE				REVIEWED BY J. I. SALAZAR		ENGINEER APPROVED J. I. SALAZAR		TITLE ASSEMBLED VIEW		
ALL DIMENSIONS ARE FOR REFERENCE ONLY UNLESS TOLERANCE IS GIVEN							CODE V01	ITEM NO. 743616	SIZE B	



NIDEC MOTOR CORPORATION 27-Mar-12

VAR	MODEL	CATALOG NO.	A	FACTORY WIRED FOR	BASE REQUIREMENT
007	C63CXHLH-5017	EC0754	10.873	HIGH VOLTAGE	NO
008	C63CXHLG-5016	EC1502	12.373	HIGH VOLTAGE	NO
009	C63CXHLJ-5018	EC1502B	12.373	HIGH VOLTAGE	N56H
010	C63JXHKJ-4998	EC0504B	10.373	LOW VOLTAGE	STD N56
011	C63JXHLP-5023	EC0504	10.373	LOW VOLTAGE	NO

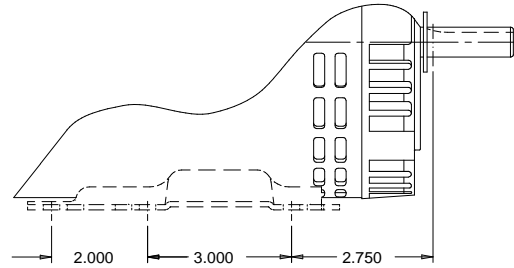

PARTIAL VIEW
SHOWING N56H BASE

MODEL	REF	CUSTOMER	HP	VOLTS	AMPS	HZ	RPM	ROTATION	CUSTOMER PN																																																								
<table border="1" style="width:100%; border-collapse: collapse;"> <tr> <td style="width:10%; text-align: center;">SHEET NUMBER</td> <td style="width:10%; text-align: center;">REV</td> <td colspan="4" style="text-align: center;">REVISION RECORD FOR: C5177-20</td> <td colspan="3" rowspan="3" style="text-align: center; vertical-align: middle;"> INFORMATION DISCLOSED ON THIS DOCUMENT IS CONSIDERED PROPRIETARY AND SHALL NOT BE REPRODUCED OR DISCLOSED WITHOUT WRITTEN CONSENT OF NIDEC MOTOR CORPORATION </td> <td colspan="2" style="text-align: center; vertical-align: middle;">NIDEC MOTOR CORPORATION</td> </tr> <tr> <td style="text-align: center;">2 OF 2</td> <td style="text-align: center;">C</td> <td colspan="4"></td> </tr> <tr> <td colspan="2">REVISION DATE</td> <td colspan="4"></td> </tr> <tr> <td colspan="2">27-MAR-12</td> <td colspan="4"></td> <td colspan="5" style="text-align: center; font-size: small;">ALL DIMENSIONS ARE FOR REFERENCE ONLY UNLESS TOLERANCE IS GIVEN</td> </tr> <tr> <td colspan="2">ISSUED BY</td> <td colspan="2">REVIEWED BY</td> <td colspan="2">ENGINEER APPROVED</td> <td colspan="2" style="text-align: center;">TITLE</td> <td style="text-align: center;">CODE</td> <td style="text-align: center;">ITEM NO.</td> <td style="text-align: center;">SIZE</td> </tr> <tr> <td colspan="2">B. ANDRADE</td> <td colspan="2">J. I. SALAZAR</td> <td colspan="2">J. I. SALAZAR</td> <td colspan="2" style="text-align: center;">ASSEMBLED VIEW</td> <td style="text-align: center;">V01</td> <td style="text-align: center;">743616</td> <td style="text-align: center;">B</td> </tr> </table>										SHEET NUMBER	REV	REVISION RECORD FOR: C5177-20				INFORMATION DISCLOSED ON THIS DOCUMENT IS CONSIDERED PROPRIETARY AND SHALL NOT BE REPRODUCED OR DISCLOSED WITHOUT WRITTEN CONSENT OF NIDEC MOTOR CORPORATION			NIDEC MOTOR CORPORATION		2 OF 2	C					REVISION DATE						27-MAR-12						ALL DIMENSIONS ARE FOR REFERENCE ONLY UNLESS TOLERANCE IS GIVEN					ISSUED BY		REVIEWED BY		ENGINEER APPROVED		TITLE		CODE	ITEM NO.	SIZE	B. ANDRADE		J. I. SALAZAR		J. I. SALAZAR		ASSEMBLED VIEW		V01	743616	B
SHEET NUMBER	REV	REVISION RECORD FOR: C5177-20				INFORMATION DISCLOSED ON THIS DOCUMENT IS CONSIDERED PROPRIETARY AND SHALL NOT BE REPRODUCED OR DISCLOSED WITHOUT WRITTEN CONSENT OF NIDEC MOTOR CORPORATION			NIDEC MOTOR CORPORATION																																																								
2 OF 2	C																																																																
REVISION DATE																																																																	
27-MAR-12						ALL DIMENSIONS ARE FOR REFERENCE ONLY UNLESS TOLERANCE IS GIVEN																																																											
ISSUED BY		REVIEWED BY		ENGINEER APPROVED		TITLE		CODE	ITEM NO.	SIZE																																																							
B. ANDRADE		J. I. SALAZAR		J. I. SALAZAR		ASSEMBLED VIEW		V01	743616	B																																																							

