

EFFECTIVE:
10-MAY-11

HORIZONTAL MOTORS

PRINT:
07-2202

SUPERSEDES:
23-MAR-11

OPEN DRIP PROOF

FRAME: 250T

SHEET:
1 OF 1

BASIC TYPE: D

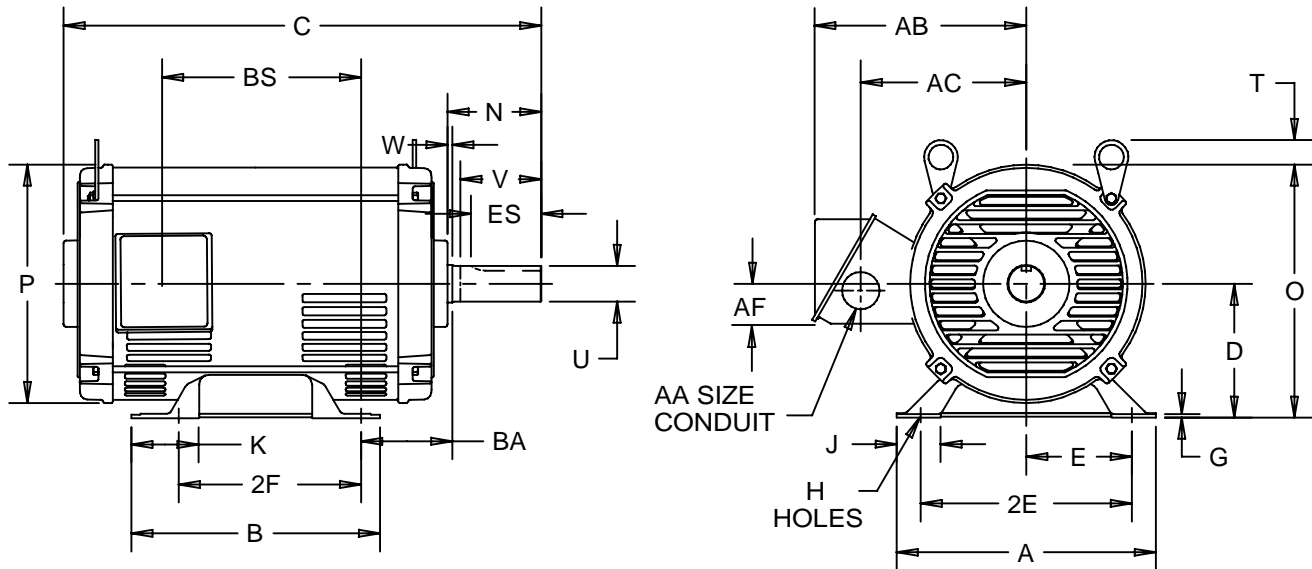

ALL DIMENSIONS ARE IN INCHES AND MILLIMETERS

UNITS	A	E	G	J	K	N	O	P ²
IN	11.25	5.00	.19	1.44	1.38	4.44	11.75	11.10
MM	286	127	5	37	35	113	298	282

UNITS	T	V MIN	W	AA	AB	AC	AF	BA	ES MIN	SQ KEY
IN	2.06	3.75	.44	1.25 NPT	9.75	7.44	1.81	4.25	2.91	.38
MM	52	95	11	1.25 NPT	248	189	46	108	74	10

UNITS	D ³	2E ³	H ³	U ³
IN	-.06	±.03	+.05	-.001
MM	6.25	10.00	.53	1.625
	158.8	254.0	13.5	41.28

FRAME	UNITS	B	C	BS	2F ³ ±.03
254T	IN	9.50	22.56	7.63	8.25
	MM	241	573	194	209.6
256T	IN	11.25	23.19	8.25	10.00
	MM	286	589	210	254.0

1: ALL ROUGH DIMENSIONS MAY VARY BY .25"
DUE TO CASTING AND/OR FABRICATION VARIATIONS.
2: LARGEST MOTOR WIDTH.
3: TOLERANCE UNITS ARE IN INCHES ONLY.

4: STANDARD ASSEMBLY POSITION F-1 IS SHOWN.
F-2 IS PROVIDED WHEN SPECIFIED. CONDUIT OPENINGS
MAY BE LOCATED IN STEPS OF 90° REGARDLESS OF LOCATION.
STANDARD AS SHOWN WITH CONDUIT OPENING DOWN.
5: FRAME REFERENCE: 11.125/254 AND 11.750/256

07-2202/B

Nidec Motor Corporation
St. Louis, Missouri

INFORMATION DISCLOSED ON THIS DOCUMENT
IS CONSIDERED PROPRIETARY AND SHALL NOT BE
REPRODUCED OR DISCLOSED WITHOUT WRITTEN
CONSENT OF NIDEC MOTOR CORPORATION



ISSUED BY
L. CUESTA
APPROVED BY
J. MAGALLANES

IHP_DP_NMCA (MAR-2011) SOLIDEDGE