

EFFECTIVE:
12-FEB-16

DIMENSION PRINT

TEFC

PRINT:
07-2280-01

SUPERSEDES:
09-OCT-01

FRAME: 143, 145TC
BASIC TYPE: TC

SHEET:
1 OF 1

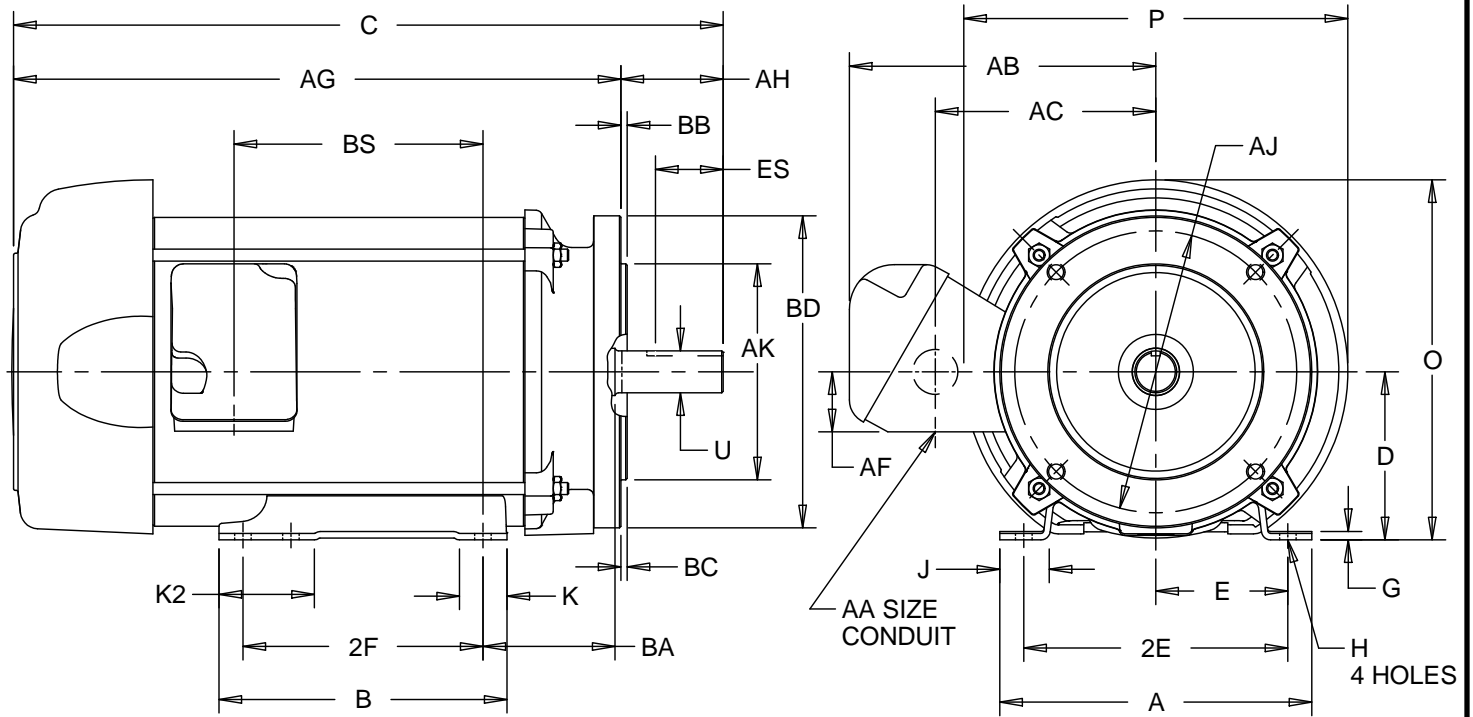

ALL DIMENSIONS ARE IN INCHES AND MILLIMETERS

UNITS	A	B	C	D	E	2E	G	H	J	K	K2
IN	6.50	6.00	14.81	3.50	2.75	5.50	.13	.34	1.00	1.00	2.00
MM	165	152	376	89	70	140	3	9	25	25	51

UNITS	O	P ²	U	AA	AB	AC	AF	AG	AH	AJ	AK
IN	7.50	8.00	.8750	3/4 NPT	6.38	4.59	1.25	12.63	2.13	5.875	4.500
MM	191	203	22.225		162	117	32	321	54	149.23	114.30

UNITS	BA	BB	BC	BD	BF ⁴	BS	ES	SQ
IN	2.75	.16	.13	6.50	3/8-16 X .56	5.31	1.41	.188
MM	70	4	3	156		135	35	4.78

FRAME	UNITS	2F
143TC	IN	4.00
	MM	102
145TC	IN	5.00
	MM	127

- 1: ALL ROUGH DIMENSIONS MAY VARY BY .25" DUE TO CASTING AND/OR FABRICATION VARIATIONS.
- 2: LARGEST MOTOR WIDTH.
- 3: CONDUIT BOX MAY BE LOCATED ON EITHER SIDE OF MOTOR. CONDUIT OPENINGS MAY BE LOCATED IN STEPS OF 90 DEGREES REGARDLESS OF LOCATION. STANDARD AS SHOWN WITH CONDUIT OPENING DOWN.
- 4: TAP SIZE AND BOLT PENETRATION ALLOWANCE.
- 5: ALL TAPPED HOLES ARE UNIFIED NATIONAL COARSE, RIGHT HAND THREAD.
- 6: TOLERANCES SHOWN ARE IN INCHES ONLY.
- 7: FRAME REFERENCE: 7.750"/143/145

07-2280/E

Nidec Motor Corporation
St. Louis, Missouri

INFORMATION DISCLOSED ON THIS DOCUMENT
IS CONSIDERED PROPRIETARY AND SHALL NOT BE
REPRODUCED OR DISCLOSED WITHOUT WRITTEN
CONSENT OF NIDEC MOTOR CORPORATION



ISSUED BY	R. KING
APPROVED BY	J. O'BRIEN

IHP_DP_NMCA (MAR-2011) SOLIDEDGE