

EFFECTIVE:
09-DEC-16

DIMENSION PRINT
TEBC (AXIAL)
FRAME: 449
BASIC TYPE: JB, JCB

PRINT:
07-3283

SUPERSEDES:
NEW

SHEET:
1 OF 1

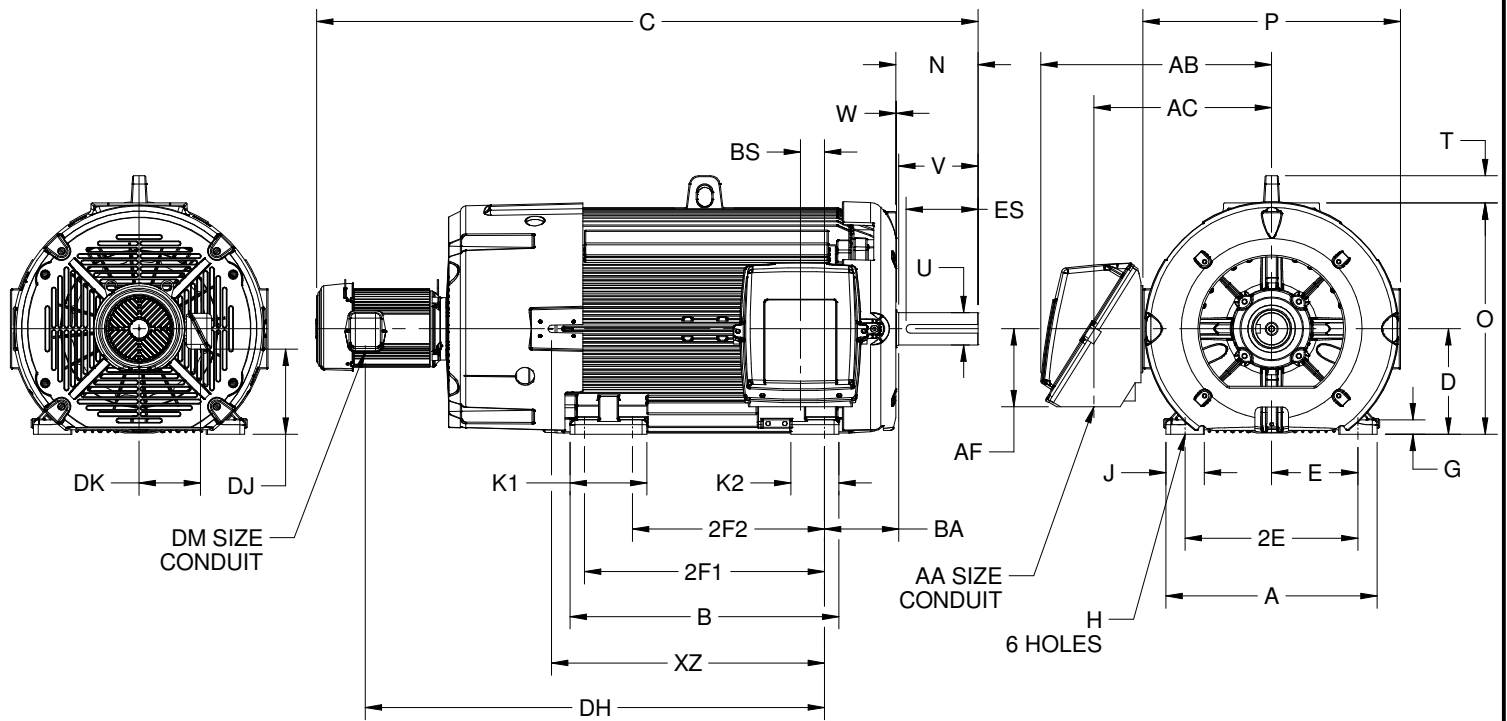

ALL DIMENSIONS ARE IN INCHES AND MILLIMETERS

| UNITS | A | B | D -.06 | E | 2E ±.03 | 2F1 ±.03 | 2F2 ±.03 | G | H +.05 | J | K1 |
|-------|-------|-------|-----------|------|------------|-------------|-------------|------|-----------|------|------|
| IN | 22.00 | 28.00 | 11.00 | 9.00 | 18.00 | 25.00 | 20.00 | 1.50 | .81 | 4.00 | 8.00 |
| MM | 559 | 711 | 279 | 229 | 457 | 635 | 508 | 38 | 21 | 102 | 203 |

| UNITS | K2 | O | P ² | T | AB | AC | AF | BA | BS | DH | DJ |
|-------|------|-------|----------------|------|-------|-------|------|------|------|-------|------|
| IN | 5.00 | 24.06 | 26.50 | 2.88 | 24.25 | 18.53 | 8.06 | 7.50 | 2.50 | 47.81 | 8.63 |
| MM | 127 | 611 | 673 | 73 | 616 | 471 | 205 | 191 | 64 | 1214 | 219 |

| UNITS | DK | DM | XZ |
|-------|------|-----|-------|
| IN | 6.38 | .75 | 44.44 |
| MM | 162 | | 1129 |

| FRAME | UNITS | C | N | U -.001 | V MIN | W | ES MIN | SQ KEY |
|-------|-------|-------|-------|------------|----------|-----|-----------|-----------|
| 449T | IN | 69.00 | 8.94 | 3.375 | 8.25 | .44 | 7.00 | .875 |
| | MM | 1753 | 227 | 85.73 | 210 | 11 | 178 | 22.23 |
| 449TL | IN | 71.00 | 10.63 | 4.375 | 10.25 | .12 | 8.50 | 1.000 |
| | MM | 1803 | 270 | 111.13 | 260 | 3 | 216 | 25.40 |
| 449TM | IN | 66.25 | 5.19 | 2.875 | 4.50 | .44 | 3.63 | .750 |
| | MM | 1683 | 132 | 73.03 | 114 | 11 | 92 | 19.05 |
| 449TS | IN | 66.25 | 5.19 | 2.375 | 4.50 | .44 | 3.13 | .625 |
| | MM | 1683 | 132 | 60.33 | 114 | 11 | 80 | 15.88 |

| AA |
|-----------|
| 2 NPT |
| 2 1/2 NPT |
| 3 NPT |
| 3 1/2 NPT |
| 4 NPT |

1. DIMENSIONS MAY VARY .25" DUE TO CASTING AND/OR FABRICATION VARIATIONS.
2. LARGEST MOTOR WIDTH.
3. TOLERANCES ARE SHOWN IN INCHES.
4. CONDUIT BOX MAY BE LOCATED ON EITHER SIDE OF MOTOR. CONDUIT OPENING MAY BE LOCATED IN STEPS OF 90 DEGREES REGARDLESS OF LOCATION. STANDARD AS SHOWN WITH CONDUIT OPENING DOWN.

Nidec Motor Corporation
St. Louis, Missouri

INFORMATION DISCLOSED ON THIS DOCUMENT IS CONSIDERED PROPRIETARY AND SHALL NOT BE REPRODUCED OR DISCLOSED WITHOUT WRITTEN CONSENT OF NIDEC MOTOR CORPORATION



ISSUED BY
O. RODRIGUEZ
APPROVED BY
T. PALLETT

IHP_DP_NMCA (MAR-2011) SOLIDEDGE