

RBC PROPRIETARY AND CONFIDENTIAL INFORMATION
 This document is the property of REGAL-BELOIT CORPORATION ("RBC") including its subsidiaries and divisions and contains proprietary information of RBC. This document is loaned on the express condition that neither it nor the information contained therein shall be disclosed to others without the express written consent of RBC and that the information shall be used by the recipient only as approved expressly by RBC. This document shall be returned to RBC upon its request. This document may be subject to certain restrictions under the U.S. export control laws and regulations.

STOCK #3081

| REVISIONS | |
|-------------------------------|-----------------------------------|
| REV | DESCRIPTION |
| 1 | TO ELECTRONIC FORMAT JAN 12/29/98 |
| 2 LOGO MODIFIED IS 05:1777 JS | |

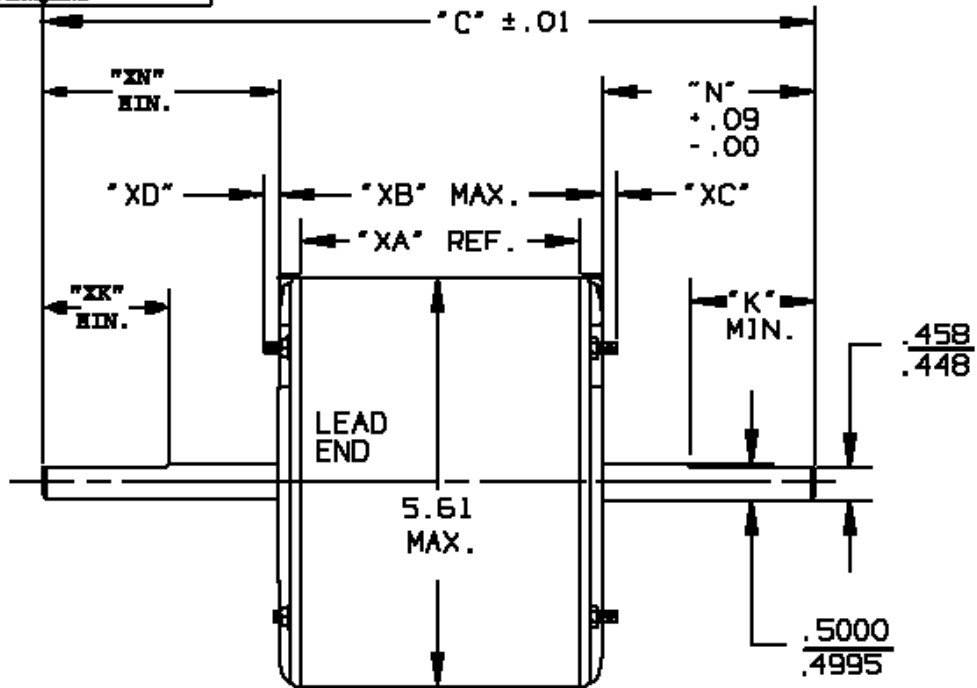

#8-32 THREAD
 THESE SCREWS FIT A GAGE
 HAVING (4) HOLES .1910 DIA.
 LOCATED ON BASIC POSITION

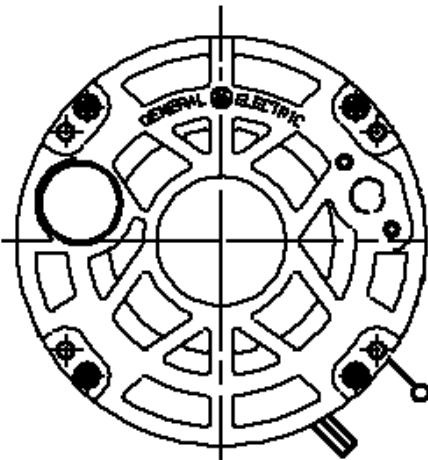

ADDITIONAL DETAILS (VIEWING LEAD END)

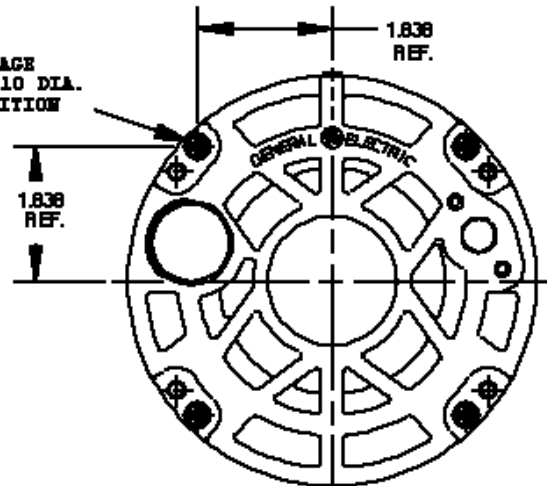

CLAMPSCREW POSITION
 WHEN "XC" OR "XD" EXCEED .14

IF "XC" OR "XD" = .14, IT IS A MAX. DIMENSION, BUT IF GREATER THAN .14, VALUE GIVEN IS -.00/+.14. IF EXTRA NUTS ARE FURNISHED FOR SPACING, DIMENSION IS FROM NUT NEXT TO SHIELD.

| | | | | | | | | | | | |
|-------|------|------|------|------|--|------|------|----|-----|--|--|
| 11.00 | 4.75 | 2.45 | 4.00 | 2.00 | | 3.07 | 3.73 | - | .50 | | |
| C | N | XN | K | XK | | XA | XB | XC | XD | | |

Rotation CCW viewed in direction of arrow.

Ventilation System:

Shell vents - 2 ROWS BOT.160°

End shield (opp. lead end) - OPEN

End shield (lead end) - OPEN

Leads exit thru SHELL 160 degrees from top of motor viewed in direction of arrow.



REGAL-BELOIT CORPORATION
 FORT WAYNE, INDIANA

MOTOR OUTLINE

| | | |
|---------------|--------------|-------|
| MODEL | ISSUED | SCALE |
| 5KCP39DGA931T | CAS-10-13-78 | NO |

CAD. NO. RR1N

(OLE42)