

NAME: 100020344 OBJECT: 5KCP39MGAA08CS DATE: 26-May-11 20:40:36

VENTILATION SYSTEM	
SHELL VENTS	OPEN
ENDSHIELD (OPP. LEAD END)	OPEN
ENDSHIELD (LEAD END)	OPEN

RBC PROPRIETARY AND CONFIDENTIAL INFORMATION
 This document is the property of REGAL BELOIT CORPORATION ("RBC") including its subsidiaries and divisions and contains proprietary information of RBC. This document is loaned on the express condition that neither it nor the information contained therein shall be disclosed to others without the express written consent of RBC, and that the information shall be used by the recipient only as approved expressly by RBC. This document shall be returned to RBC upon its request. This document may be subject to certain restrictions under U.S. export control laws and regulations.

REVISIONS			
REV.	DESCRIPTION	DATE	APPROVED
1	REL TO PROD PER IS:11-2171	05/26/11	PRANEETH

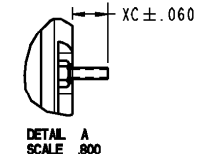
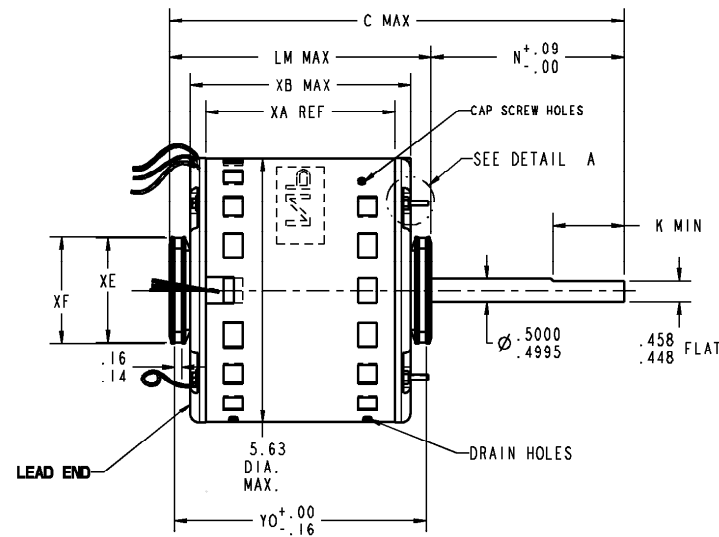
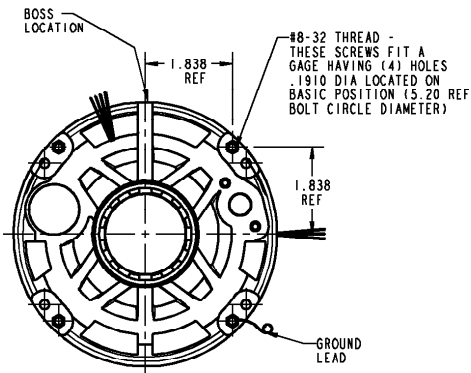

NOTE:
 1. DIMENSIONS SHOWN ARE NOMINAL UNLESS OTHERWISE SPECIFIED.

	2.22	2.25	.58	N/A	5.89
	XE	XF	XC	XD	YO
10.14	4.00	3.62	N/A	N/A	6.09
C	N	K	XN	XK	LM
			XA		XB

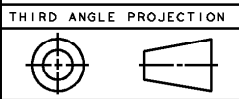

NO.	CONNECTION	COLOR	ENT TYPE	ENT LOC (FROM LR)	QTY	MATERIAL	WALL THK	LENGTH	TERMINATION
1	COMMON LEAD	YELLOW	SHELL NOTCH	3:00	18	THERMOPLASTIC	4/64	26.00	.50 BWS
2	REV LEAD	BROWN	E/S VENT	11:20	18	THERMOPLASTIC	4/64	4.00	.25 STRT OC/INS
3	CAPACITOR LEAD	BRN/WHI	SHELL NOTCH	3:00	18	THERMOPLASTIC	4/64	26.00	.25 STRT OC
4	REV LEAD	YELLOW	E/S VENT	11:20	18	THERMOPLASTIC	4/64	4.00	.25 STRT OC/INS
5	CAPACITOR LEAD	BROWN	SHELL NOTCH	3:00	18	THERMOPLASTIC	4/64	26.00	.25 STRT OC
6	REV LEAD	ORANGE	E/S VENT	11:20	18	THERMOPLASTIC	4/64	4.00	.25 STRT OC/INS
7	HIGH SPEED LEAD	BLACK	SHELL NOTCH	3:00	18	THERMOPLASTIC	4/64	26.00	.50 BWS
8	LOW SPEED LEAD	RED	SHELL NOTCH	3:00	18	THERMOPLASTIC	4/64	26.00	.50 BWS
9	REV LEAD	PURPLE	E/S VENT	11:20	18	THERMOPLASTIC	4/64	4.00	.25 STRT OC/INS
10	GROUND	GREEN	CLAMPSCREW	4:30	18	THERMOPLASTIC	2/64	12.0	#10 EYELET

NAMEPLATE DATA	
MODEL	5KCP39MGAA08CS
CUST P/N	STOCK NO 3388
HP	1/2
RPM	1075
VOLTS	208-230
HZ	60/50
# SPEEDS	2
AMPS	4.30
CAP REQ'D-1	5.00µfd/370Volts
CAP REQ'D-2	N/R
CONN DRW	NP24X327115
ROTATION	CCW/CW (VIEWED FROM LE)

REGAL BELOIT REGAL-BELOIT CORPORATION FORTWAYNE, INDIANA

TITLE **MOTOR OUTLINE**
 (CUSTOMER NAME : DEF PUR)

SIZE B DRAWING 5KCP39MGAA08CS REV 1

SCALE: NO ISSUED: 05/26/11 SHEET 1 of 1