

LEAD MATERIAL
18 GA. 90°C 3/64 INS.
HPN, (2) CONDUCTOR
PARALLEL BLK.

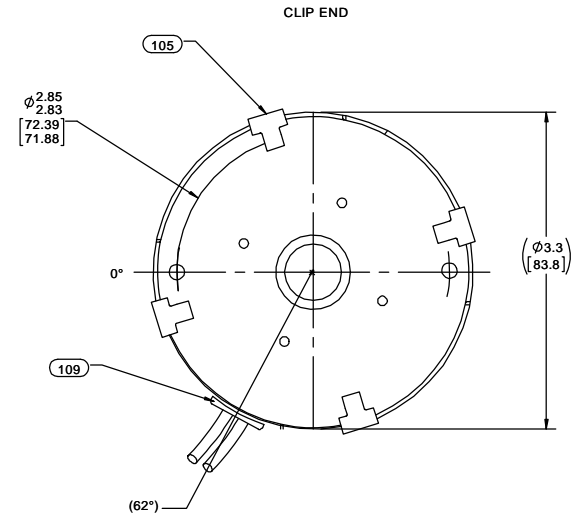

6130 5568

SAFETY WARNING
This motor must be grounded in accordance with local or national electrical codes to prevent possible injury due to electrical shock

AVERTISSEMENT DE SÉCURITÉ
Ce moteur doit être fondée sur conformément à la réglementation locale ou national électrique codes pour prévenir d'éventuelles blessures en raison de choc électrique

APPLY IN A CONVENIENT LOCATION TO READ FROM CLIP END

0046 4668

FASCO Fasco Industries, Inc.
Motor Division

ASSEMBLED IN MEXICO

No. 71732211 TYPE U73B1 T.P. AO

115 V 60 Hz Class B

.5 A 1550 RPM

Model D637 E40513

Reference 1/75 HP

Max Amb 40°C

6129 9553

NOTES:

1. MOTOR HAS #416 S.S. SHAFING.
2. NO PACKAGING TAPE OVER CARTON LABEL.

CUSTOMER: FASCO DIST		APPLICATION: COUNTER SALES	
CUSTOMER PN: D637		MOTOR WEIGHT:	
UP		ENVIRONMENT: WET	
HORIZONTAL	MOTOR TYPE		REFERENCE SAMPLE
	SHADED POLE		X-0006586-2
DOWN	B	LA	FR
	00	73	30
		A	S
		T	01
	C	E	B
	DS	5	1
		A	0
TYPICAL PERFORMANCE AT 115 VOLTS 60 Hz			
IDLE		LOADED	
MOTOR SPEED		LOCKED	
RPM	AMP	WATT	BREAK
1764	0.45	28	IN OZ
			RPM
			AMP
			WATT
			IN OZ
			AMP
			WATT
			IN OZ

DRAWING REVISION D	REVISION BY HANNA ZOU	DATE 05-18-2018	TOLERANCES UNLESS OTHERWISE SPECIFIED: DEC. INCH mm ANGLE	DRAWN BY M.GU	REGAL™ Regal Beloit America, Inc.
ECO-0143936	APPROVED BY CHENG.LUO	DATE 05-18-2018	.X ±0.1 [±2.5] \$0.5° .XX ±0.01 [±0.25] .XXX ±0.005 [±0.127] .XXXX ±0.0005 [±0.0127]	DATE 07-10-2014	
ECO DESCRIPTION CONVERT TO SW AND UPDATE NOTE 1 FOR SHEET 2			REMOVE BURRS & BREAK SHARP EDGES. .0031 .015 [076/381] X 45° CORNER FILLETS: R.02 [51]	APPROVED BY A.SUN	DESCRIPTION MODEL-SFHP-3.3
PROPRIETARY AND CONFIDENTIAL INFORMATION. THIS DOCUMENT IS THE PROPERTY OF REGAL BELOIT AMERICA, INC. FORNERY AND CONTAINS OWNERS PROPRIETARY INFORMATION. ANY PERSON, CORPORATION OR OTHER FIRM RECEIVING IT IS DEEMED TO HAVE AGREED IN ADVANCE BY OWNER. THIS DOCUMENT SHALL BE RETURNED TO OWNER UPON REQUEST. IT MAY BE SUBJECT TO CERTAIN RESTRICTIONS UNDER APPLICABLE EXPORT CONTROL LAWS AND REGULATIONS.			MACHINED SURFACES: .125/ 3.2 INCH/ mm SHOWN IN [BRACKETS]	DATE 07-10-2014	OUTLINE
			THIRD ANGLE PROJECTION	REFERENCE	MATERIAL
			SIZE	DRAWING NUMBER	PROCESS/FINISH
			C	71732211M	BLACK PAINT
					SHEET 1 OF 2

NOTES:

1. STAKE STATOR TO SLEEVE PER 8883 0264
2. MAXIMUM TORQUE REQUIRED TO TURN MOTOR SHAFT IS 1/4 INCH-OUNCE.
3. MAKE-UP WASHERS ARE TO BE ADDED OR DELETED TO ACHIEVE REQUIRED ENDPLAY.
4. SEE ROTOR AND SHAFT DRAWING FOR WASHER SET-UP.

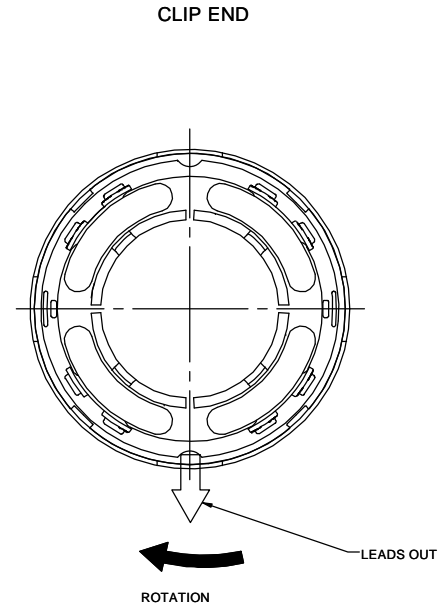
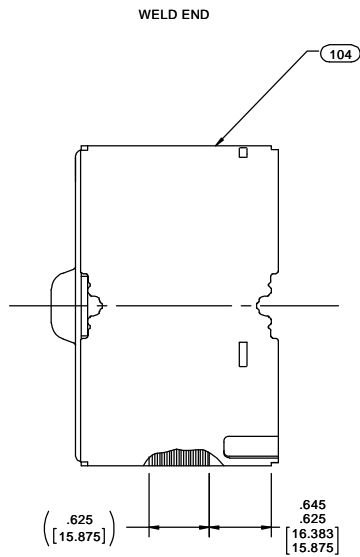

PACKING SPECIFICATIONS

NOTES:

1. PACK PER 88834200 , (1) MOTOR PER CONTAINER, (45) CONTAINER PER LAYER, (5) LAYER PER PALLET, (225) MOTORS MAX. PER PALLET.
2. PLACE (1) FILLER TUBE OVER EACH SHAFT EXTENSION. PLACE MOTOR IN CARTON LEADS DOWN CLOSE FLAPS AND TAPE. PLACE LABEL ON END OF CARTON.
3. CARTON LABELS MUST ALL FACE ONE DIRECTION TOWARD THE OPEN END OF THE PALLET. SEE 88834408.
4. PLACE (1) FLAT PAD ON PALLET, (1) BETWEEN EACH LAYER, & (1) ON TOP LAYER OF CARTON,

DRAWING REVISION D		REVISION BY HANNA ZOU	DATE 05-18-2018	TOLERANCES UNLESS OTHERWISE SPECIFIED:		DRAWN BY M.GU		Regal Beloit America, Inc.
ECO-0143936		APPROVED BY CHENG.LUO	DATE 05-18-2018	DEC.	INCH	mm	ANGLE	
ECO DESCRIPTION CONVERT TO SW AND UPDATE NOTE 1 FOR SHEET 2		<small>PROPRIETARY AND CONFIDENTIAL INFORMATION. THIS DOCUMENT IS THE PROPERTY OF REGAL BELOIT AMERICA, INC. FORMERLY AND CONTAINS OWNERS PROPRIETARY INFORMATION. ANY PERSON, CORPORATION OR OTHER FIRM RECEIVING IT IS DEEMED BY RECEIVING IT, TO AGREE THAT IT, AND/OR ANY PART OF IT, SHALL NOT BE DISCLOSED TO ANY PERSON, CORPORATION OR OTHER ENTITY, DUPLICATED, AND/OR USED, EXCEPT AS EXPRESSLY APPROVED IN WRITING IN ADVANCE BY OWNER. THIS DOCUMENT SHALL BE RETURNED TO OWNER UPON REQUEST. IT MAY BE SUBJECT TO CERTAIN RESTRICTIONS UNDER APPLICABLE EXPORT CONTROL LAWS AND REGULATIONS.</small>		.X	±0.1	[±2.5]	±0.5°	
				.XX	±0.01	[±0.25]		
				.XXX	±0.005	[±0.127]		DATE 07-10-2014
				.XXXX	±0.0005	[±0.0127]		APPROVED BY A.SUN
				MACHINED SURFACES: .125/ 3.2 INCH/ mky		CORNER FILLETS: R.02 [51]		DATE 07-10-2014
				mm SHOWN IN [BRACKETS]		THIRD ANGLE PROJECTION		DESCRIPTION MODEL-SFHP-3.3
								MATERIAL OUTLINE
								PROCESS/FINISH BLACK PAINT
								SIZE C
								DRAWING NUMBER 71732211M
								SHEET 2 OF 2