

D570 - D577

번	도 번	부 품 명	재 질	치 수	수 량	PAINT	비 고
(PART NO.)	(PART NAME)	(MATERIAL)	(DIMENSION)	(QTY)	(FINISH)	(REMARKS)	
		FC-15		1		PAINT	
구분	A급 B급 C급	제 도	설 계	검 도	확 인	승 인	모 델
0	±0.06 ±0.10 ±0.25						25W, 35W
18	±0.07 ±0.14 ±0.38						도 형
50	±0.10 ±0.20 ±0.50						도 번
120	±0.15 ±0.30 ±0.80	제 3 차 별	확 도				(PART NO.)
-150	±0.20 ±0.60 ±1.00	(3RD LEVEL)	(SCALE)	단 위	mm		
500	±0.30 ±0.80 ±1.50						

지 남 기 전
GEE NAM ELECTRIC CO.,LTD.

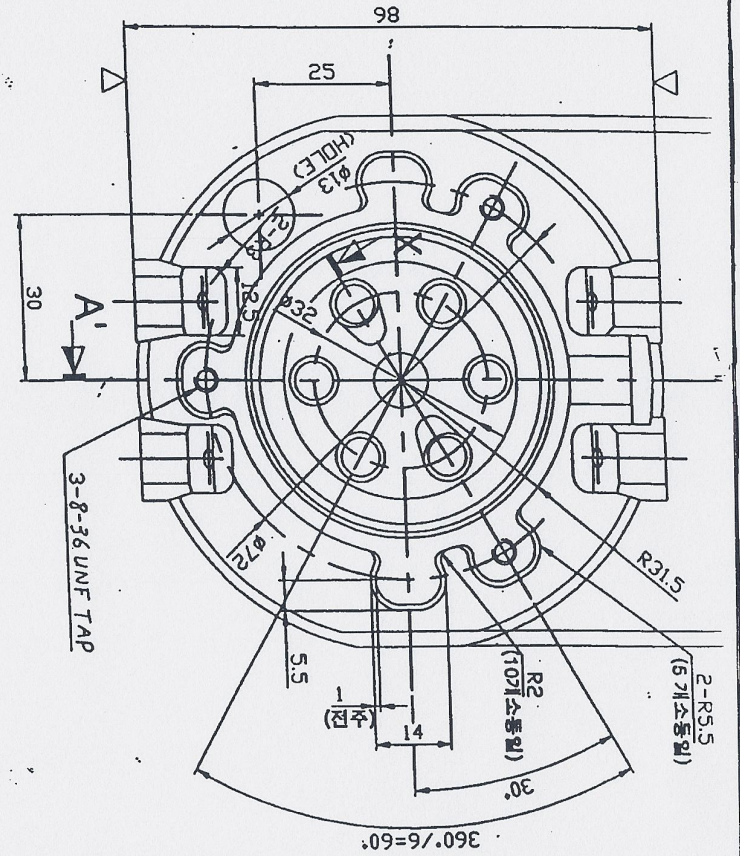
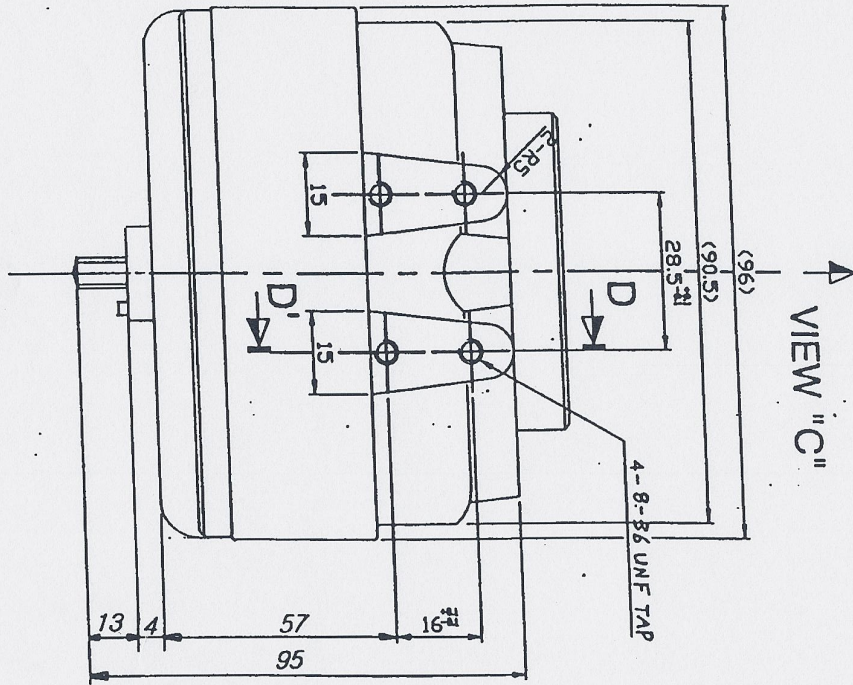

FASCO UNIT BEARING

Fasco Item	Watt rating	Material	Voltage	Hz	Thermal protection	RPM	Rotation facing end opposite shaft	Lead Length	Ulc	Qty per carton	Each motor Weight(lbs.)	Threaded Shaft	Fan Mounting Hub	Speed Nut	Vibration damper	# of rear motor mount holes	Qty. tapped and untapped	# of foot / boss mounts	Qty. tapped and untapped
D550	2	Alum	115	60	Impedence	1550	CW	17.5"	Yes	1	2.0583	1/4 - 20	large	Yes	Yes	4	All Tapped	2	All Tapped
D551	2	Alum	115	60	Impedence	1550	CCW	17.5"	Yes	1	2.0583	1/4 - 20	large	Yes	Yes	4	All Tapped	2	All Tapped
D552	2	Alum	230	60	Impedence	1550	CW	17.5"	Yes	1	2.0583	1/4 - 20	large	Yes	Yes	4	All Tapped	2	All Tapped
D553	2	Alum	230	60	Impedence	1550	CCW	17.5"	Yes	1	2.0583	1/4 - 20	large	Yes	Yes	4	All Tapped	2	All Tapped
D554	4	Alum	115	60	Impedence	1550	CW	25.6"	Yes	1	2.0583	1/4 - 20	large	Yes	Yes	4	All Tapped	2	All Tapped
D555	4	Alum	115	60	Impedence	1550	CCW	25.6"	Yes	1	2.0583	1/4 - 20	large	Yes	Yes	4	All Tapped	2	All Tapped
D556	4	Alum	230	60	Impedence	1550	CW	25.6"	Yes	1	2.0583	1/4 - 20	large	Yes	Yes	4	All Tapped	2	All Tapped
D557	4	Alum	230	60	Impedence	1550	CCW	25.6"	Yes	1	2.0583	1/4 - 20	large	Yes	Yes	4	All Tapped	2	All Tapped
D582	5	Alum	115	60	Impedence	1550	CW	25.6"	Yes	1	2.4083	1/4 - 20	large	Yes	Yes	5	All Tapped	2	All Tapped
D583	5	Alum	115	60	Impedence	1550	CCW	25.6"	Yes	1	2.4083	1/4 - 20	large	Yes	Yes	5	All Tapped	2	All Tapped
D584	5	Alum	230	60	Impedence	1550	CW	25.6"	Yes	1	2.4083	1/4 - 20	large	Yes	Yes	5	All Tapped	2	All Tapped
D585	5	Alum	230	60	Impedence	1550	CCW	25.6"	Yes	1	2.4083	1/4 - 20	large	Yes	Yes	5	All Tapped	2	All Tapped
D558	6	Alum	115	60	Impedence	1550	CW	25.6"	Yes	1	2.4083	1/4 - 20	large	Yes	Yes	5	All Tapped	2	All Tapped
D559	6	Alum	115	60	Impedence	1550	CCW	25.6"	Yes	1	2.4083	1/4 - 20	large	Yes	Yes	5	All Tapped	2	All Tapped
D560	6	Alum	230	60	Impedence	1550	CW	25.6"	Yes	1	2.4083	1/4 - 20	large	Yes	Yes	5	All Tapped	2	All Tapped
D561	6	Alum	230	60	Impedence	1550	CCW	25.6"	Yes	1	2.4083	1/4 - 20	large	Yes	Yes	5	All Tapped	2	All Tapped
D562	9	Alum	115	60	Auto reset	1550	CW	25.6"	Yes	1	2.4083	1/4 - 20	large	Yes	Yes	5	All Tapped	2	All Tapped
D563	9	Alum	115	60	Auto reset	1550	CCW	25.6"	Yes	1	2.4083	1/4 - 20	large	Yes	Yes	5	All Tapped	2	All Tapped
D564	9	Alum	230	60	Auto reset	1550	CW	25.6"	Yes	1	2.4083	1/4 - 20	large	Yes	Yes	5	All Tapped	2	All Tapped
D565	9	Alum	230	60	Auto reset	1550	CCW	25.6"	Yes	1	2.4083	1/4 - 20	large	Yes	Yes	5	All Tapped	2	All Tapped
D566	16	Iron	115	60	Auto reset	1550	CW	25.6"	Yes	1	4.225	1/4 - 20	large	Yes	Yes	3	All Tapped	1	All Tapped
D567	16	Iron	115	60	Auto reset	1550	CCW	25.6"	Yes	1	4.225	1/4 - 20	large	Yes	Yes	3	All Tapped	1	All Tapped
D568	16	Iron	230	60	Auto reset	1550	CW	25.6"	Yes	1	4.225	1/4 - 20	large	Yes	Yes	3	All Tapped	1	All Tapped
D569	16	Iron	230	60	Auto reset	1550	CCW	25.6"	Yes	1	4.225	1/4 - 20	large	Yes	Yes	3	All Tapped	1	All Tapped
D570	25	Iron	115	60	Auto reset	1550	CW	25.6"	Yes	1	5.026	1/4 - 20	small	Yes	Yes	3	All Tapped	2	All Tapped
D571	25	Iron	115	60	Auto reset	1550	CCW	25.6"	Yes	1	5.026	1/4 - 20	small	Yes	Yes	3	All Tapped	2	All Tapped
D572	25	Iron	230	60	Auto reset	1550	CW	25.6"	Yes	1	5.026	1/4 - 20	small	Yes	Yes	3	All Tapped	2	All Tapped
D573	25	Iron	230	60	Auto reset	1550	CCW	25.6"	Yes	1	5.026	1/4 - 20	small	Yes	Yes	3	All Tapped	2	All Tapped
D574	35	Iron	115	60	Auto reset	1550	CW	25.6"	Yes	1	5.037	1/4 - 20	small	Yes	Yes	3	All Tapped	2	All Tapped
D575	35	Iron	115	60	Auto reset	1550	CCW	25.6"	Yes	1	5.037	1/4 - 20	small	Yes	Yes	3	All Tapped	2	All Tapped
D576	35	Iron	230	60	Auto reset	1550	CW	25.6"	Yes	1	5.037	1/4 - 20	small	Yes	Yes	3	All Tapped	2	All Tapped
D577	35	Iron	230	60	Auto reset	1550	CCW	25.6"	Yes	1	5.037	1/4 - 20	small	Yes	Yes	3	All Tapped	2	All Tapped
D578	50	Iron	115	60	Auto reset	1550	CW	25.6"	Yes	1	6.471	3/8 x 1-1/2	n/a	No	No	3	All Tapped	2	All Tapped
D579	50	Iron	115	60	Auto reset	1550	CCW	25.6"	Yes	1	6.471	3/8 x 1-1/2	n/a	No	No	3	All Tapped	2	All Tapped
D580	50	Iron	230	60	Auto reset	1550	CW	25.6"	Yes	1	6.471	3/8 x 1-1/2	n/a	No	No	3	All Tapped	2	All Tapped
D581	50	Iron	230	60	Auto reset	1550	CCW	25.6"	Yes	1	6.471	3/8 x 1-1/2	n/a	No	No	3	All Tapped	2	All Tapped